

CONTENTS

Warranty	2
Important User Information	2
General	2
Manufacturer	2
Intended Use	2
Safety	3
Operation	4
Adjusting the Shelf Position	4
Accessories	5
Lockable Storage Drawer	5
Pullout Surface	5
Power Strip	5
Storage Bins	5
Storage	6
Maintenance	6
Replacement Parts	6

Please read and understand these Assembly Instructions before working with or using the teacherTAXI.

If you need additional information about the teacherTAXI, contact Wenger Corporation using the information below.

WARRANTY

The teacherTAXI is guaranteed free of defects in materials and workmanship for five full years.

Our guarantee assures you of either a full refund or repair or replacement of the defective materials or workmanship without charge, at the discretion of our Customer Service Department. Just call a Customer Service Representative at 1-800-887-7145 and state the reason you are dissatisfied. If a product return is necessary, your representative will issue a return authorization. This is your sole remedy for breach of this warranty.

Should you have a question or problem with any Wenger product, don't hesitate to call, even if the product is past warranty. It's important to us that all our customers be satisfied.

This is the sole warranty made by Wenger. Wenger disclaims all other warranties, including the warranties of merchantability and fitness for a particular purpose, as well as all liability for incidental, consequential, special, and indirect damage. Wenger liability for direct damages shall be limited to the amount you paid for the product involved. Wenger reserves the right to make product changes without obligation to incorporate such changes into products previously sold.

Some states do not allow the exclusion or limitation of damages or warranties, so the above may not apply to you. This warranty gives you specific legal rights. You may also have other rights which vary from state to state.

IMPORTANT USER INFORMATION

GENERAL

Copyright® 2009 by Wenger Corporation

All rights reserved. No part of the contents of this manual may be reproduced, copied, or transmitted in any form or by any means including graphic, electronic, or mechanical methods or photocopying, recording, or information storage and retrieval systems without the written permission of the publisher, unless it is for the purchaser's personal use.

Printed and bound in the United States of America.

The information in this manual is subject to change without notice and does not represent a commitment on the part of Wenger Corporation. Wenger Corporation does not assume any responsibility for any errors that may appear in this manual.

In no event will Wenger Corporation be liable for technical or editorial omissions made herein, nor for direct, indirect, special, incidental, or consequential damages resulting from the use or defect of this manual.

The information in this document is not intended to cover all possible conditions and situations that might occur. The end user must exercise caution and common sense when assembling or installing Wenger Corporation products. If any questions or problems arise, call Wenger Corporation at 1-800-733-0393.

MANUFACTURER

The teacherTAXI is manufactured by:

Wenger Corporation
555 Park Drive
Owatonna, MN 55060
1-507-455-4100 • 1-800-733-0393
www.wengercorp.com

INTENDED USE

- This product is intended for indoor use in normal ambient temperature and humidity conditions — it must not be exposed to prolonged outside weather conditions.
 - This product is intended to be assembled only as described in these instructions.
-

SAFETY PRECAUTIONS

This manual contains cautions which are defined as follows.

- **CAUTION** means that failure to follow the instruction may result in serious injury or damage to property.

Read all of these safety instructions before setting up the teacherTAXI components.

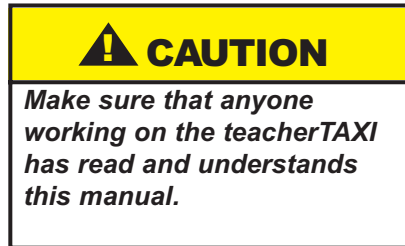

CART LOADING

- The top and bottom shelf may carry up to 100 lbs evenly distributed. The center shelf may carry up to 50 lbs evenly distributed. The total load carried by the teacherTAXI should not exceed 200 lbs.

CART USAGE

- **Caution!** *Never overload the teacherTAXI. Overloading makes the teacherTAXI hard to control and could result in damage to property or injury to people.*
- **Caution!** *Always move the teacherTAXI at a slow speed, no faster than walking. A fast-moving teacherTAXI is hard to control. Moving fast could result in damage to property or injury to people.*
- **Caution!** *Never allow students or anyone to ride on the teacherTAXI. Riding on the teacherTAXI could result in damage to property or injury to people.*
- **Caution!** *Always place heavier items on the lower shelf. A top-heavy teacherTAXI may accidentally tip over, damaging property or injuring people.*

OPERATION

Adjusting the Middle Shelf

1. Using a Phillips screw driver, remove the screw and flat washer located under each end of the shelf. **(Detail A)**
2. Remove the shelf from the shelf wire

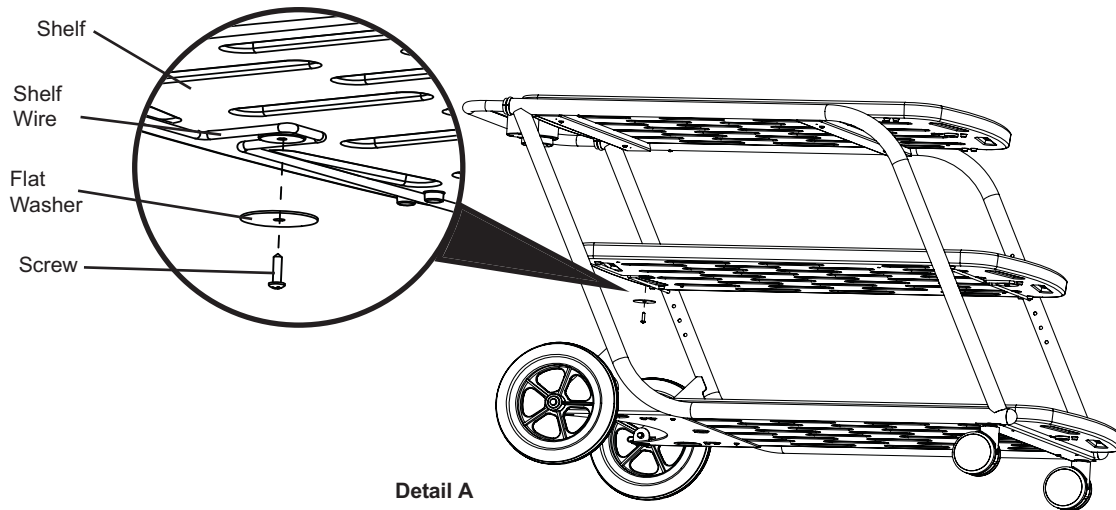

3. Remove the shelf wire by sliding it either direction. **(Detail B)**
Note: It may be necessary to bow the wire slightly.
4. Position the shelf wire in desired position.
5. Secure the shelf wire to the shelf as shown in Detail A.

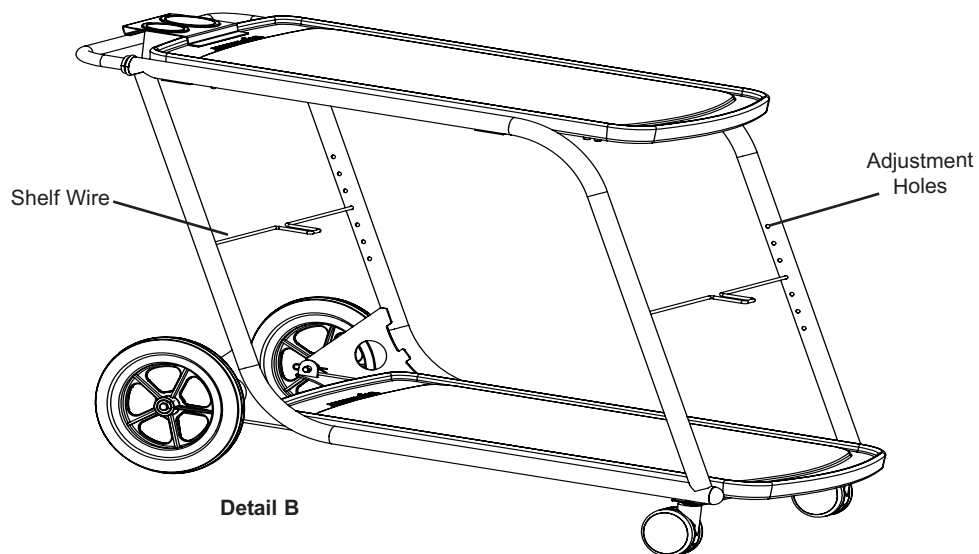

OPTIONAL ACCESSORIES

- Lockable Storage Drawer for laptop computers, purses, etc.
- Pullout Surface for teaching or laptop use
- UL approved Power Strip: 15 amp/6 outlet/10' (3 m) cord
- Storage Bins

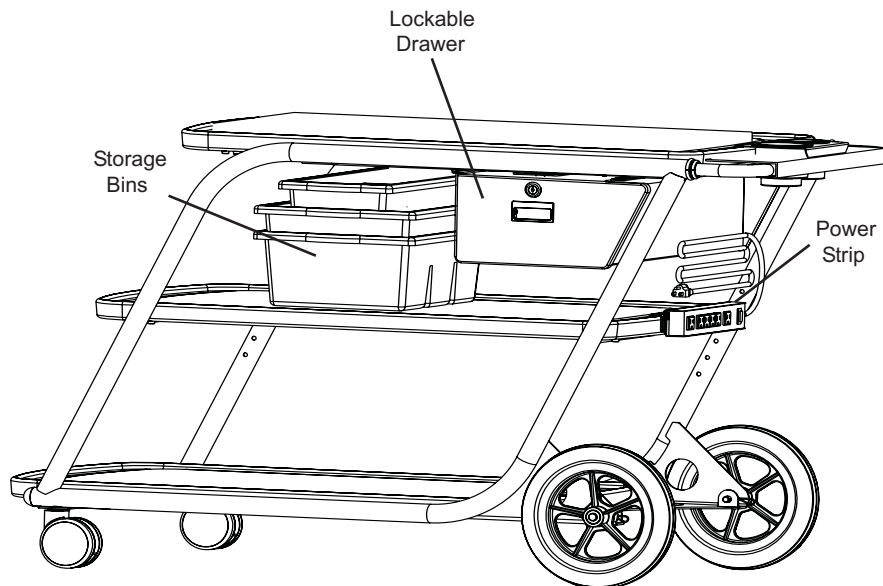

Attaching the Power Strip

1. Using the alcohol pad (provided), clean the surface.
2. Remove backing from foam tape on Power Strip mount and place on shelf in desired location.
Note: Foam tape is difficult to remove once set. Be sure of location before pressing in place.
3. Clean Power Strip back.
4. Remove backing from foam tape and place Power Strip on Power Strip Mount.

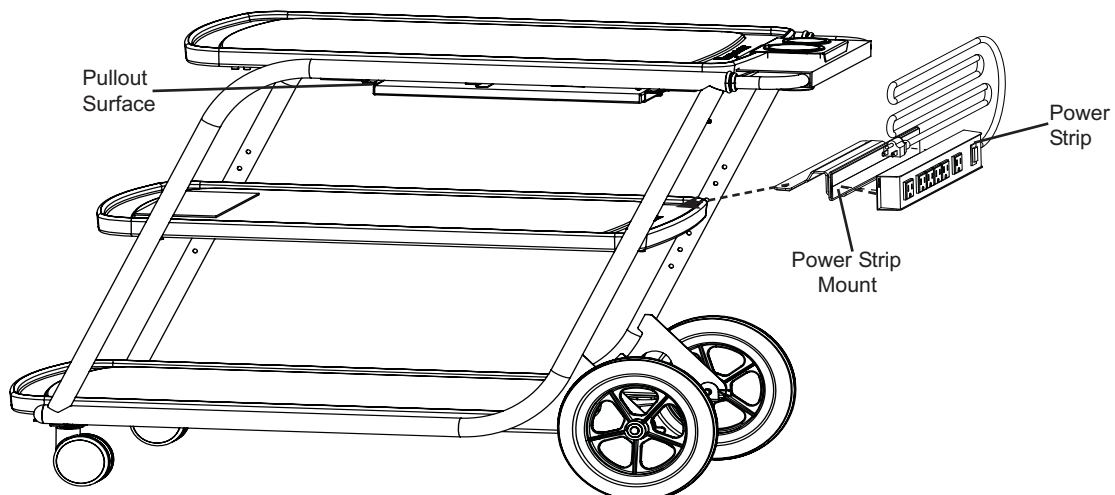

STORAGE

1. When leaving the teacherTAXI in a stationary position or in storage, block or secure casters to prevent the cart from moving and possibly causing damage.

MAINTENANCE

1. Clean the teacherTAXI with a mild detergent and warm water. Avoid using harsh or abrasive cleaning products.
2. Immediately replace any caster wheels that do not rotate or turn freely.
3. Immediately replace or repair any tire that develops a flat area.

REPLACEMENT PARTS

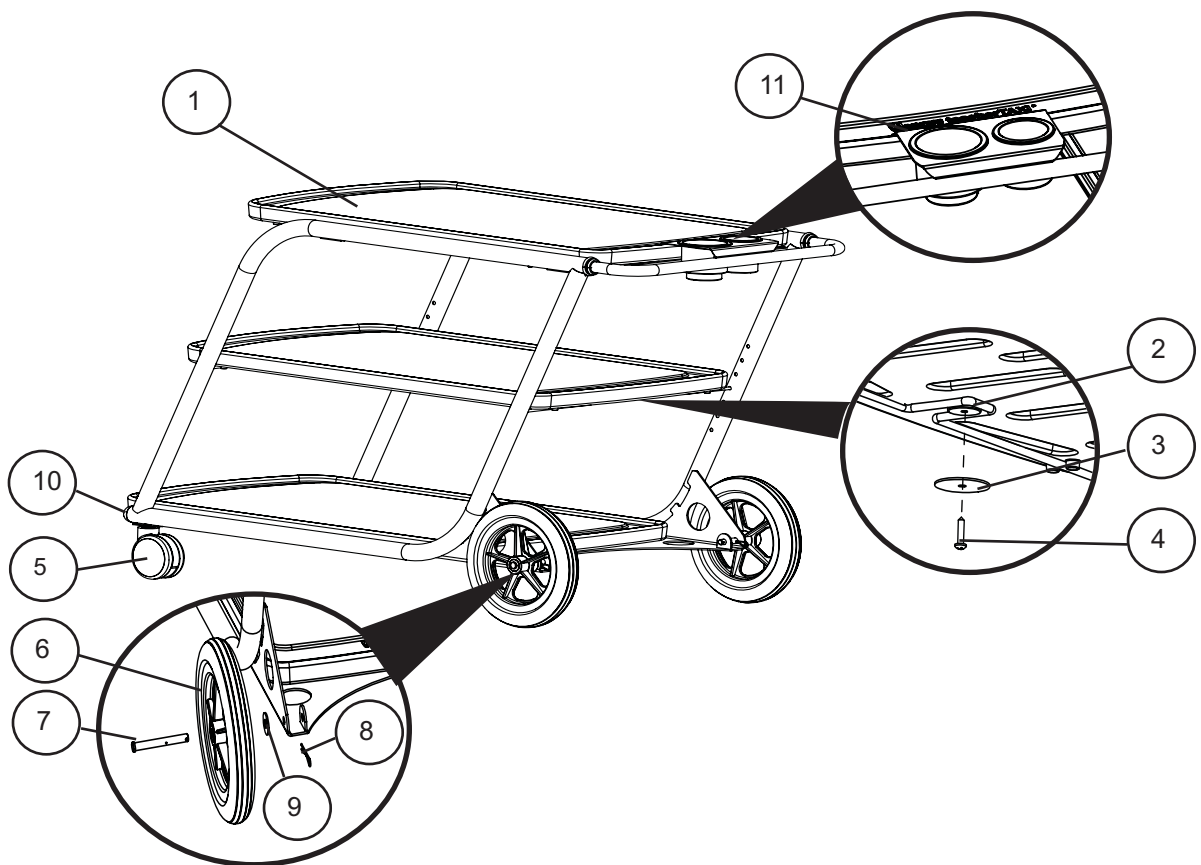

Item #	Description
--------	-------------

- | | |
|---|--------------------------------|
| 1 | Shelf |
| 2 | Shelf Wire |
| 3 | Flat Washer, 284 x 2.00 OD |
| 4 | Small Pan-Head Screw, #12 x 1" |
| 5 | Caster |
| 6 | Wheel |

Item #	Description
--------	-------------

- | | |
|----|------------------------------|
| 7 | Axle Pin, 1/2" |
| 8 | Cotter Pin |
| 9 | Flat Washer, 1/2 x 1 3/8" OD |
| 10 | Dome Plug, 1 1/2" dia. |
| 11 | Drinkholder |