

OnBoard Keyboard Cart

CONTENTS

CONTENTS	1
SAFETY	2
WARRANTY	3
USER INFORMATION	3
TOOLS REQUIRED	4
FASTENER AND PARTS LIST	4
ASSEMBLY	5
OPERATION	8
ACCESSORIES	11
STORAGE	13
MAINTENANCE	13
REPLACEMENT PARTS	14

Note: Please read and understand the OnBoard Keyboard Cart Assembly and Owner's Manual before using the Keyboard Cart.

Note: Remove Keyboard Cart assembly parts from the shipping container. Refer to the illustrations on the following pages. If you need additional information, contact the Wenger Corporation using the information below.

SAFETY PRECAUTIONS

Throughout this manual you will find **CAUTIONS** and **WARNINGS** which are defined as follows:

- **WARNING**; failure to follow the instruction may result in serious injury or death.
- **CAUTION**; failure to follow the instruction may result in serious injury or damage to property.

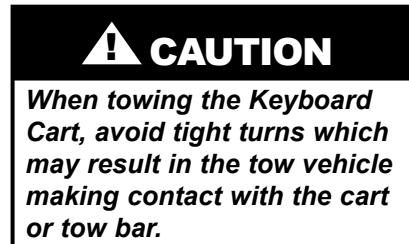
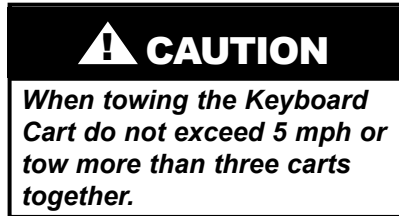

Note: Failure to comply with precautions in this section can result in serious injury.

ASSEMBLY

- Ensure anyone who helps assemble the Keyboard Cart has read and understands this manual.

OPERATION

- Keyboard Cart maximum total load capacity is 40 lbs uniformly distributed on the keyboard shelf, 120 lbs uniformly distributed on the lower shelf and 40 lbs on each shelf extension.
- The keyboard shelf, clamp and pads are only intended to hold the keyboard during performances or while moving to and from performance areas at a reasonable speed. Speed not to exceed 5 mph.
- When the Keyboard Cart is left unattended, it must be placed in a secure position so that it does not move or roll into vehicles, structures or people.
- All four casters must be in contact with the floor or ground at all times.
- Always distribute the load evenly on the cart. Avoid top-heavy loading.
- Avoid ramps steeper than a one-foot rise or drop in a 12-foot horizontal distance.
- Always move slowly up or down a ramp with the narrow end of the cart in the direction of travel.
- Do not pull or push too high on the cart or sides of the cart which may cause the cart to tip over.
- Avoid off-center loads which may cause the cart to tip over.
- Because swivel casters move in any direction, the operator must move the cart slowly and have a clear view to avoid obstructions and individuals standing in the direction of travel.
- If the Keyboard Cart is heavily loaded, two people are required to move the cart (one pushing at the rear and one guiding at the front).
- When transporting the Keyboard cart in a vehicle it must be braced with tie-downs, chains or cargo straps designed specifically for that purpose so cart will not move.
- Blankets or other padding material may be required to avoid damage to the cart and accessories from vibration and impact during transport.
- When moving the cart, do not ride and do not allow others to ride on the cart.
- Use caution when removing objects from the cart or when placing objects on the cart.
- When towing the Keyboard Cart, avoid tight turns which may result in the tow vehicle making contact with cart or tow bar. Injury or damage may result.

WARRANTY

The Keyboard Cart is guaranteed free of defects in materials and workmanship for five full years.

Our guarantee assures you of either a full refund or repair or replacement of the defective materials or workmanship without charge, at the discretion of our Customer Service Department.

Just call a Customer Service Representative at 1-800-887-7145 and state the reason you are dissatisfied. If a product return is necessary, your representative will issue a return authorization. This is your sole remedy for breach of this warranty.

Should you have a question or problem with any Wenger product, don't hesitate to call, even if the product is past warranty. It's important to us that all our customers be satisfied.

This is the sole warranty made by Wenger. Wenger disclaims all other warranties, including the warranties of merchantability and fitness for a particular purpose, as well as all liability for incidental, consequential, special, and indirect damage. Wenger liability for direct damages shall be limited to the amount you paid for the product involved. Wenger reserves the right to make product changes without obligation to incorporate such changes into products previously sold.

Some states do not allow the exclusion or limitation of damages or warranties, so the above may not apply to you. This warranty gives you specific legal rights. You may also have other rights which vary from state to state.

IMPORTANT USER INFORMATION

GENERAL

Copyright® 2011 by Wenger Corporation

All rights reserved. No part of the contents of this manual may be reproduced, copied, or transmitted in any form or by any means including graphic, electronic, or mechanical methods or photocopying, recording, or information storage and retrieval systems without the written permission of the publisher, unless it is for the purchaser's personal use.

Printed and bound in the United States of America.

The information in this manual is subject to change without notice and does not represent a commitment on the part of Wenger Corporation. Wenger Corporation does not assume any responsibility for any errors that may appear in this manual.

In no event will Wenger Corporation be liable for technical or editorial omissions made herein, nor for direct, indirect, special, incidental, or consequential damages resulting from the use or defect of this manual.

The information in this document is not intended to cover all possible conditions and situations that might occur. The end user must exercise caution and common sense when assembling or installing Wenger Corporation products. If any questions or problems arise, call Wenger Corporation at 1-800-733-0393.

MANUFACTURER

The OnBoard® Keyboard Cart is manufactured by:
Wenger Corporation
555 Park Drive
Owatonna, MN 55060
1-507-455-4100 • 1-800-733-0393
www.wengercorp.com

INTENDED USE





- This product is intended for indoor use in normal ambient temperature and humidity conditions — it must not be exposed to prolonged outside weather conditions.
 - This product is intended to be assembled only as described in these instructions.
-

TOOLS REQUIRED

- 9/16" Wrench or 9/16" Socket with Ratchet
- 7/32" Allen Wrench (provided)

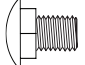
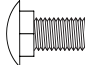
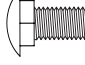
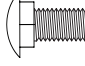
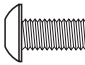
FASTENER LIST

Note: Extra hardware can be discarded.

<p>15  Carriage Bolt, 1/4-20 x 1/2</p> <p>16  Carriage Bolt, 3/8-16 x 1</p> <p>17  Carriage Bolt, 3/8-16 x 2 1/4</p> <p>26  Carriage Bolt, 3/8-16 x 2 1/2</p>	<p>18  Socket Screw, 3/8-16 x 2 3/4</p> <p>19  Lock Nut, 3/8-16</p> <p>20  Washer, 3/8 id x 1 1/4 od</p> <p>25  Jam Lock Nut, 3/8-16</p>	<p>21  Wing Nut, 1/4-20</p>
---	---	--

PARTS LIST

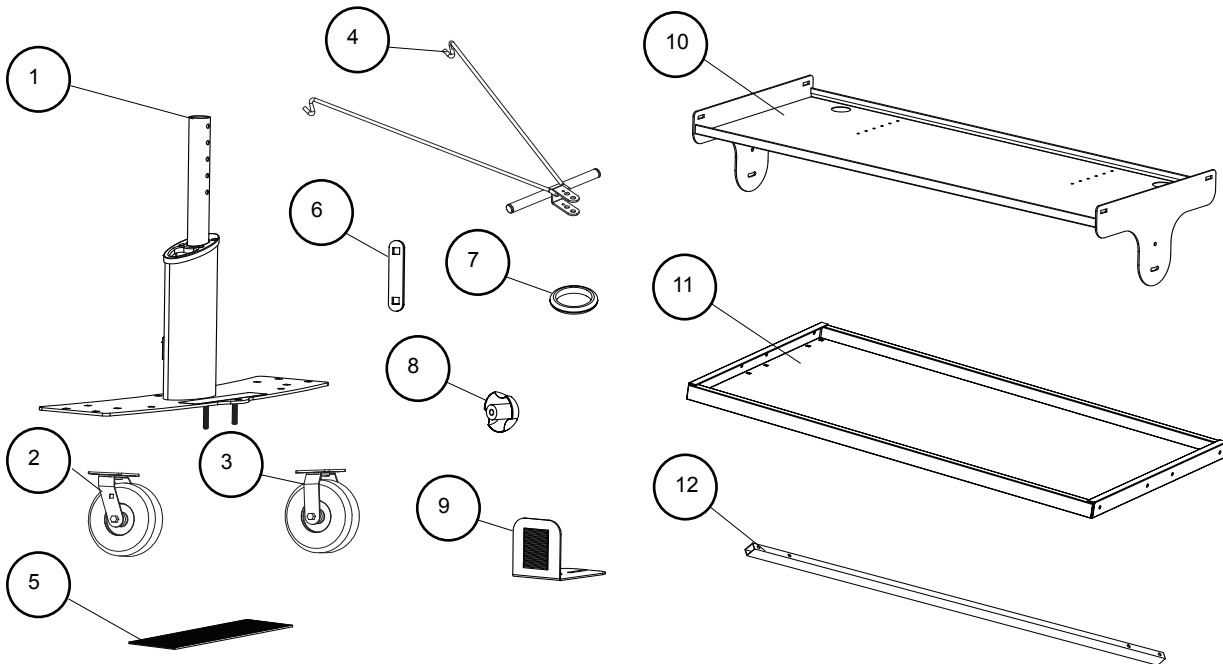

Item # Description

- 1 BASE ASSEMBLY
- 2 SWIVEL CASTER
- 3 RIGID CASTER
- 4 TOW BAR
- 5 BLACK RUBBER PAD, 6 x 21
- 6 KEYBOARD PIVOT LOCK PLATE

Item # Description

- 7 RUBBER GROMMET
- 8 BLACK KNOB, 2.48" DIA
- 9 KEYBOARD CLAMP BRACKET
- 10 KEYBOARD CART TOP SHELF
- 11 KEYBOARD CART BOTTOM SHELF
- 12 CROSS MEMBER

ASSEMBLY

Always observe the precautions listed on page 2 of this document prior to assembly

Failure to comply with the safety precautions on page 2 can result in serious injury.

Assemble casters (#2 and #3) to the base assembly (#1).

1. Align the swivel casters (#2) with the bolt holes on the base assembly (#1).
2. Assemble the casters to the base assembly (#1) using two 3/8-16 x 1 carriage bolts (#16) and lock nuts (#19). At this point, only attach the casters using the outside holes (tow hole side) on the base assembly. Do not fully tighten. **(Detail A)**

Note: The same caster type (swivel or rigid) must be assembled to each base assemblies.

3. Align the rigid casters (#3) with the bolt holes on the remaining base assembly (#1).
4. Repeat step 2.

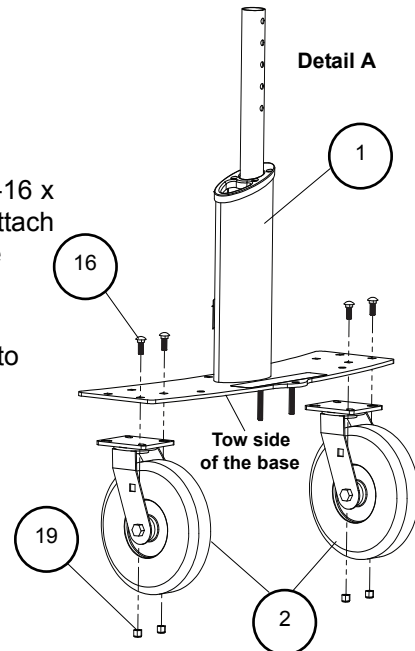

Assemble the cross members (#12) to the base assemblies (#1).

5. Lay the base assemblies on end.
6. Align the cross member (#12) to the bolts located on the bottom of the base assemblies. **(Detail B)**
7. Secure the cross member to the base assemblies using 3/8" washers (#20) and 3/8" lock nuts (#19).

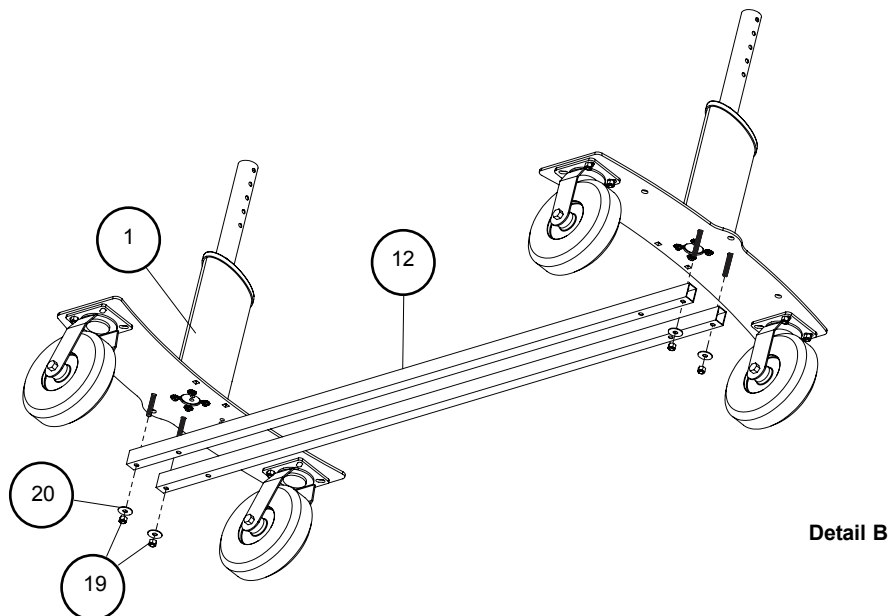

ASSEMBLY (CONTINUED)

Assemble the Keyboard Cart bottom shelf onto the cart base.

CAUTION

Two people are recommended to complete the next steps.

1. Align the Keyboard Cart bottom shelf (#11) on the inside of the base assemblies (#1). **(Detail C)**
2. Secure the bottom shelf, in the corners, to the the base assemblies and casters using eight carriage bolts, 3/8-16 x 1 (#16), and lock nuts, 3/8-16 (#19).
3. Secure the bottom shelf, at the center, through the base assemblies and cross members (#12) using four carriage bolts, 3/8-16 x 2 1/4 (#17), washers (#20) and lock nuts, 3/8-16 (#19).

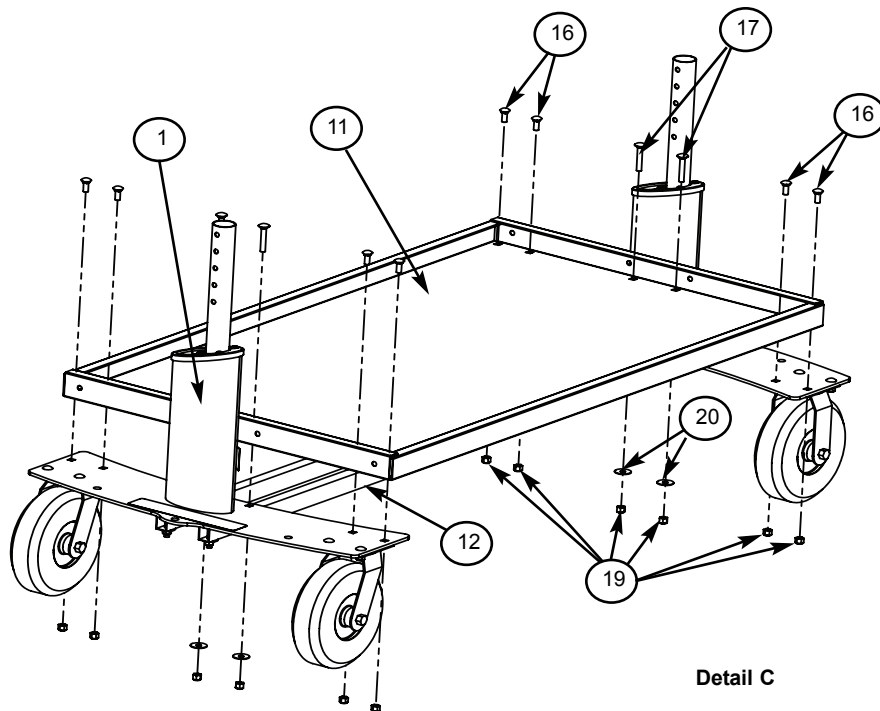

4. Tighten all the lock nuts.

ASSEMBLY (CONTINUED)

Assemble the Keyboard Cart top shelf onto the cart.



Two people are required for the next steps.

Vertically align the Keyboard Cart top shelf (#10) at the top of the base assemblies (#1) at desired location. (**Detail D**)

Note: The vertical height of the shelf on the cart is adjustable.

1. Insert the socket screw, 3/8-16 x 2 3/4 (#18) through the Keyboard Cart top shelf and base assembly.
2. Place the keyboard pivot lock plate (#6) on the socket screw (#18) against the base assembly.
3. Secure the pivot lock plate using jam lock nut, 3/8-16 (#25).
4. Insert carriage bolt, 3/8-16 x 2 1/2 (#26) through the pivot lock plate, base assembly and top shelf.
5. Tighten the black knob (#8) onto the carriage bolt (#26)
6. Repeat 1-5 on the opposite side of the cart.
7. Insert the rubber grommet (#7) into the pre-cut hole on the top surface of the top shelf.

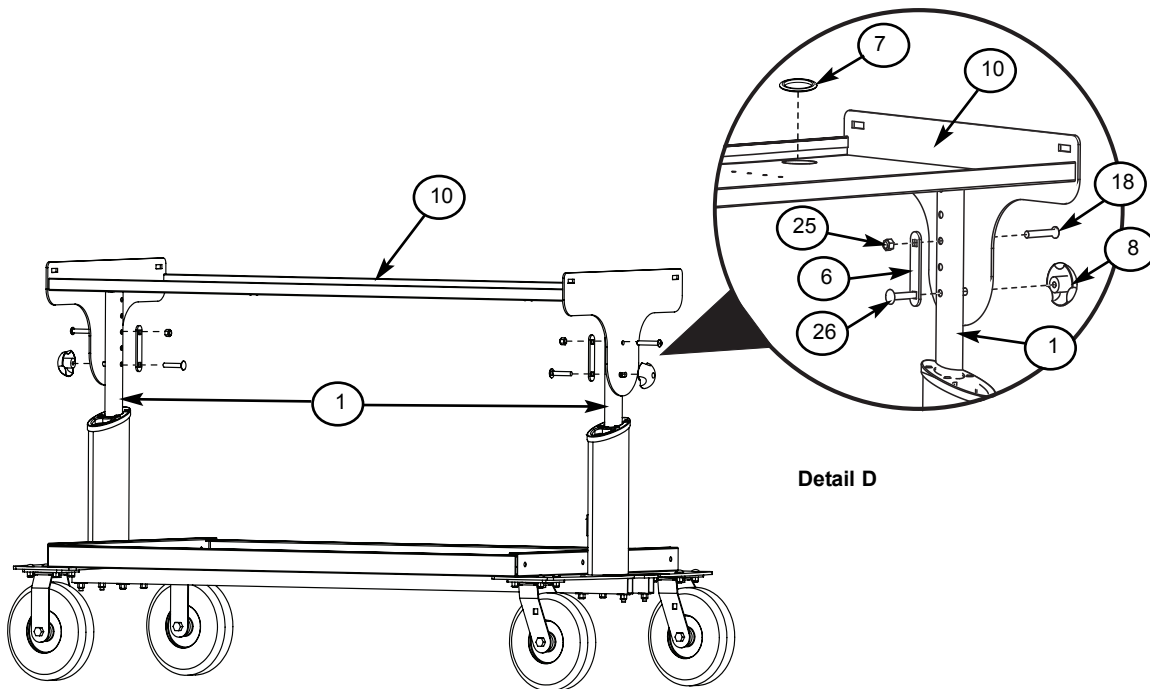

Detail D

OPERATION

Use the Keyboard Cart with care. Always observe the precautions listed on page 2 of this document. **Failure to comply with the safety precautions on page 2 can result in serious injury.**

1. Make sure the Keyboard Cart is secure and does not roll away while loading, unloading, being stored, parked or during a performance.

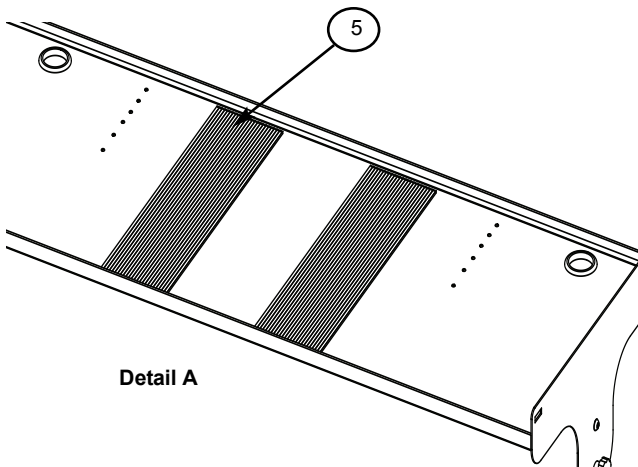

2. Position and adhere the rubber pads (#5) to best suit the contact point of the keyboard being mounted onto the Keyboard Cart. The pads may be cut into smaller pieces as desired and also placed along the inside edge of the front lip where the keyboard may make contact. **(Detail A)**

3. Position the keyboard bracket clamp (#9) on the Keyboard Cart top shelf in the applicable location to secure the keyboard being mounted on the cart. **(Detail B)**
4. Using the carriage bolt, 1/4-20 x 1/2 (#15) and wing nut 1/4-20 (#21), secure the keyboard bracket clamp (#9) with the rubber pad making contact with the keyboard.

Note: The keyboard clamp, pads and top shelf are intended to hold the keyboard during performances or to and from the performance area at reasonable speeds. Speed not to exceed 5 mph. The keyboard must be removed or secured with additional straps, cords, etc. if the cart is being transported in a vehicle or over obstacles.

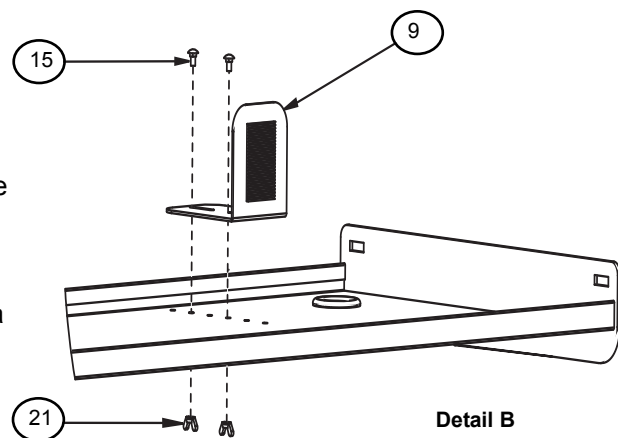

OPERATION (CONTINUED)

ADJUSTING THE KEYBOARD CART

The Keyboard Cart top shelf (#10) is adjustable vertically and also can be tilted up to 10°.

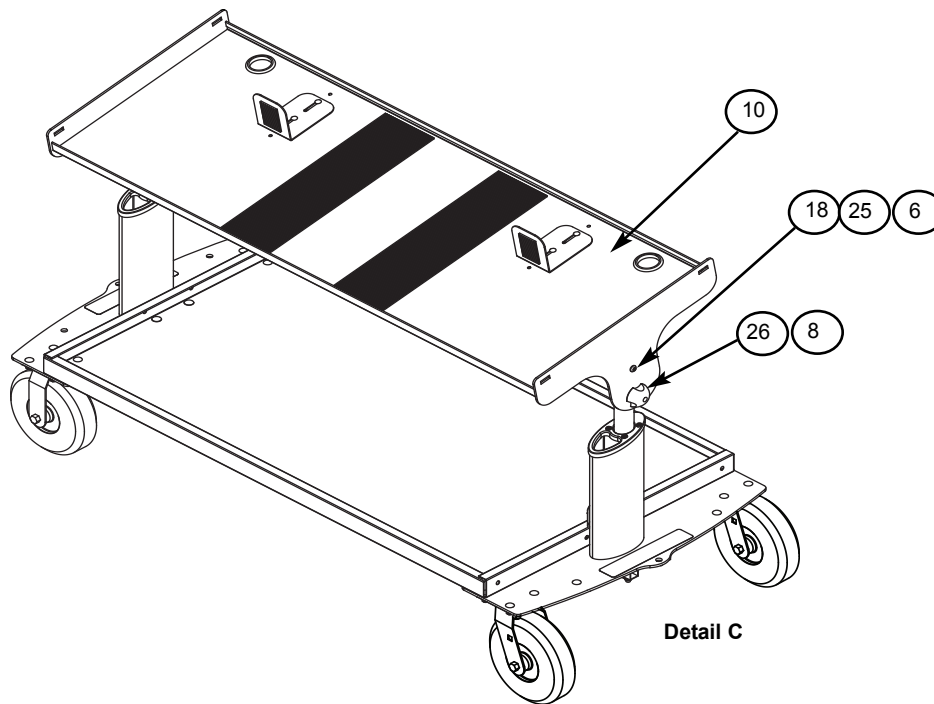

To adjust the Keyboard Cart top shelf vertically: (Detail C)

1. Remove the jam lock nut (#25), carriage bolt (#26), black knob (#8), socket screw (#18) and keyboard pivot lock plate (#6) while holding the Keyboard Cart top (#10) shelf on one end.
2. Place the keyboard shelf (#10) in the desired location.
3. Reinstall the hardware removed in step 1 in the following order:
 - keyboard pivot lock plate (#6)
 - socket screw (#18)
 - black knob (#8)
 - carriage bolt (#26)
 - jam lock nut (#25)
4. Repeat 1-3 on the opposite side of the cart.

To tilt the Keyboard Cart top shelf: (Detail C)

1. Loosen the black knob (#8) located on both ends of the Keyboard Cart.
2. Adjust the Keyboard Cart top shelf to the desired radius (maximum 10°).
3. Tighten the black knob (#8) on both ends of the Keyboard Cart top shelf.

LOADING THE KEYBOARD CART

1. Always distribute loads evenly on the Keyboard Cart.
 - 40 lbs max. on keyboard shelf
 - 120 lbs max. on lower shelf
 - 40 lbs max. on each shelf extension

OPERATION (CONTINUED)

MOVING THE KEYBOARD CART

1. When the cart is left unattended, it must be placed in a secure position so that it doesn't move or roll into vehicles, structures or people.
2. When pulling or pushing the Keyboard Cart, always pull or push at waist level or lower. Pushing above the main support bar can tip the Keyboard Cart over easily. **(Detail D)**
3. If the Keyboard Cart is heavily loaded, two people should work together to move the cart in the direction of travel that the rigid casters can move freely. One person pushing at the rear and one person guiding at the front. Take care to avoid stationary objects or people standing in the path of the Keyboard Cart.

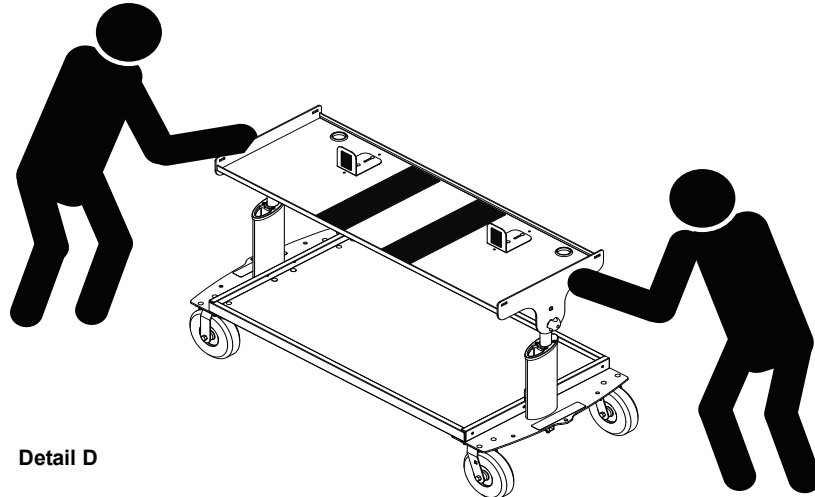

CAUTION

Never transport people or stand on the Keyboard Cart.

4. A separate tow bar (#4) is provided which inserts into two holes in the Keyboard Cart base (#1). The tow bar (#4) may be used as a handle to pull the Keyboard Cart manually or can be attached horizontally to a lawn and garden tractor. **(Detail E)**

CAUTION

When towing the Keyboard Cart, avoid tight turns which may result in the tow vehicle making contact with the cart or tow bar. Injury or damage may result.

Note: Towing speed is not to exceed 5 mph. The number of carts being towed is not to exceed three cart together. Abrupt stops with heavy loads may cause the tow bar to bend. The tow bar may be straightened if this happens.

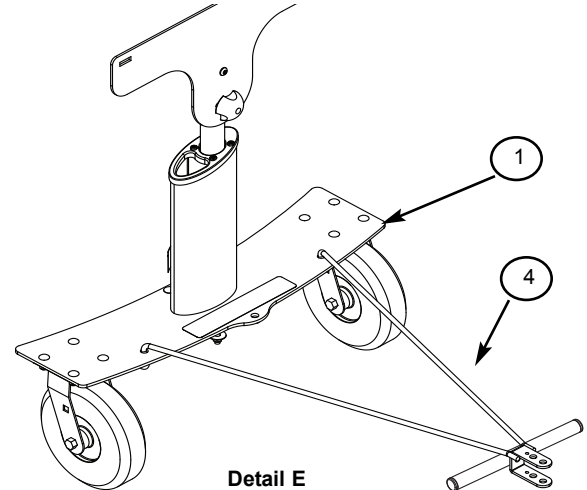

5. When the tow bar is removed, store it out of the way so that it is not an obstruction or hazard.
6. If the Keyboard Cart is transported in a vehicle, it must be braced or strapped to the vehicle so that it will not move. Bracing must use tie-downs or straps specifically designed to prevent the Keyboard Cart from moving in the vehicle. Remove instruments that may be damaged during transport. Secure Keyboard Cart at the lower frame. Pads or other protection against abrasion may be required.

ACCESSORIES

Keyboard Cart Shelf Extension - Part # 210A008

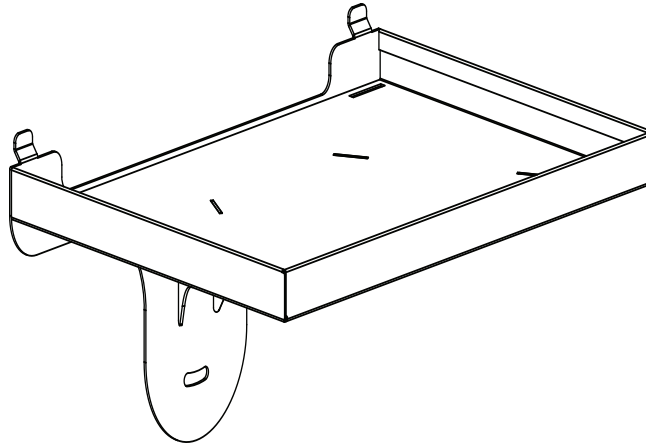

Installation of the shelf extension



Note: Two people are required.

1. Support one end of the Keyboard Cart top shelf (#10). **(Detail F)**
2. Remove black knob (#8) and socket screw (#18). **(Detail F)**

Caution: The Keyboard Cart top shelf (#10) is now loose on one end and must be supported.

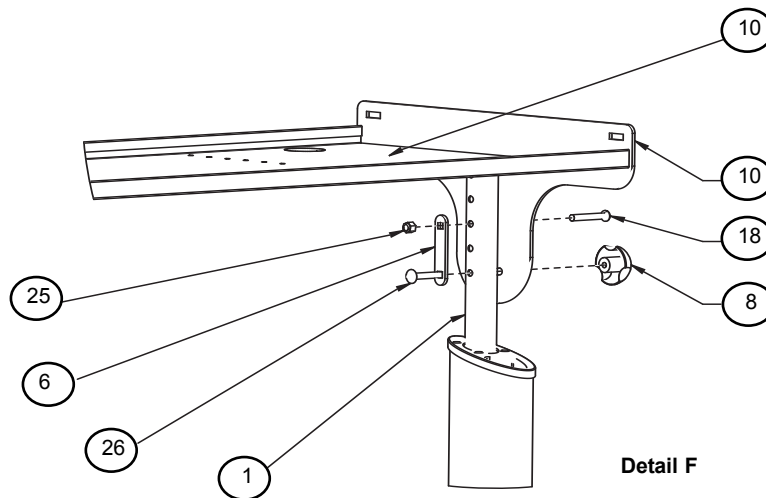

ACCESSORIES (CONTINUED)

Installation of the shelf extension (continued).

3. Tilt the shelf extension up and insert the two tabs into the two slots at the end of the Keyboard Cart top shelf. **(Detail G and H)**

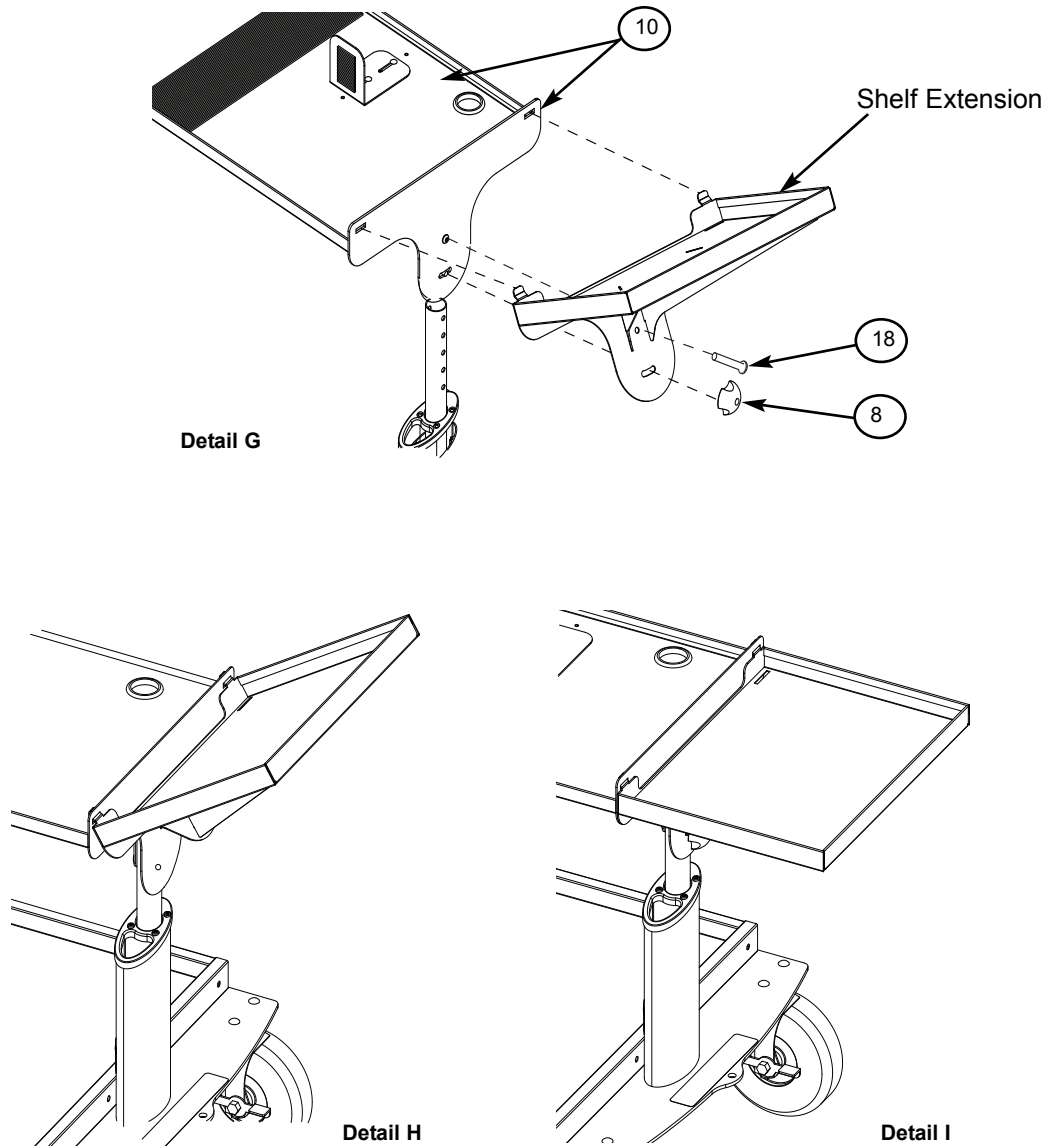

4. Lower the end of the shelf extension **(Detail I)** and re-insert the socket screw (#18) through the shelf extension, Keyboard Cart top shelf (#10), base assembly (#1), pivot lock plate (#6) and jam lock nut (#25). **(Detail F)**
 5. Replace the black knob (#8) and tighten all fasteners. **(Detail F and G)**
 6. Repeat steps 1 - 5 on the opposite side of the cart for the other shelf extension.
-

STORAGE

1. When leaving the Keyboard Cart in a stationary position or in storage, always block or secure the casters to prevent the cart from moving and possibly causing damage.

MAINTENANCE

1. Clean the Keyboard Cart with a mild detergent and warm water. Avoid using harsh or abrasive cleaning products.
2. Immediately replace any Caster wheels that do not rotate or turn freely.
3. Immediately replace or repair any tire that develops a flat area.
4. Recommended tire pressure is 50 psi. Do not exceed the maximum tire pressure shown on the sidewall of the tire.
5. During heavy usage, periodically check and tighten the fasteners.
6. Grease zerks and bushings if required.

