

Storage Configuration

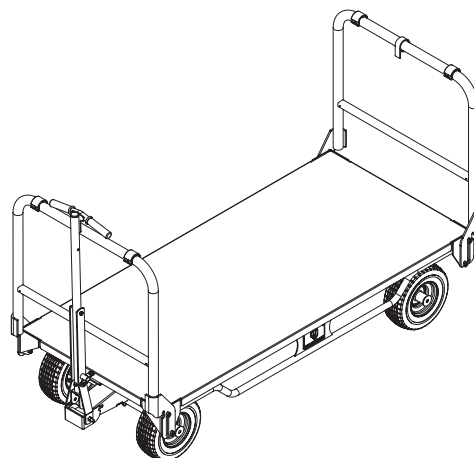

Cart Configuration

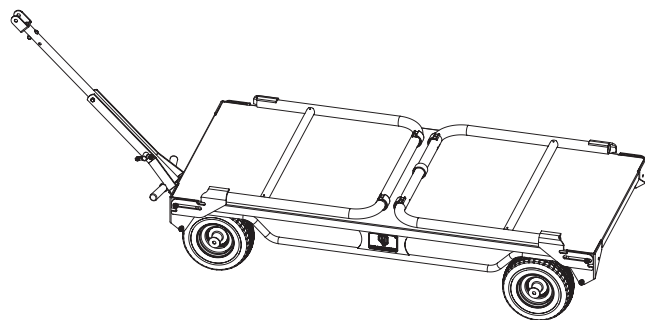

Towing Configuration

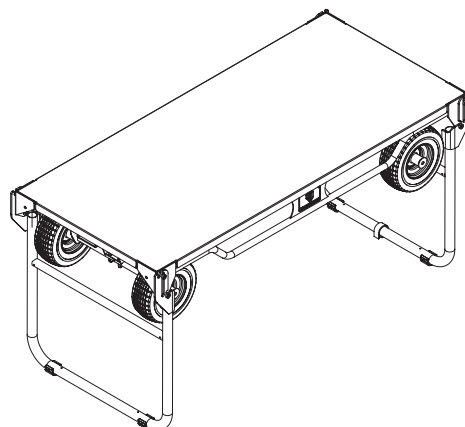

Table Configuration

Contents

Important User Information	2	Cart Configuration to Towing Configuration	5
General	2	Towing Usage	5
Manufacturer	2	Cart Configuration to Table Configuration	6
Intended Use	2	Table Usage	6
Warranty	2	Table Configuration to Storage Configuration	7
Safety Precautions	2	Mesh Wrap	8
Unpacking the Cart	3	Maintenance	9
Storage Configuration to Cart Configuration	4	Transporting the Cart	10
Cart Usage	4	Replacement Parts	12



Visit the GearBoss TranSport Cart web page at wengercorp.com for more information.

Note: Please read and understand these instructions before operating.

Note: If you need additional information, contact Wenger Corporation using the information below.

Important User Information

General

Copyright © 2023 by Wenger Corporation

All rights reserved. No part of the contents of this manual may be reproduced, copied, or transmitted in any form or by any means including graphic, electronic, or mechanical methods or photocopying, recording, or information storage and retrieval systems without the written permission of the publisher, unless it is for the purchaser's personal use.

Printed and bound in the United States of America.

The information in this manual is subject to change without notice and does not represent a commitment on the part of Wenger Corporation. Wenger Corporation does not assume any responsibility for any errors that may appear in this manual.

In no event will Wenger Corporation be liable for technical or editorial omissions made herein, nor for direct, indirect, special, incidental, or consequential damages resulting from the use or defect of this manual.

The information in this document is not intended to cover all possible conditions and situations that might occur. The end user must exercise caution and common sense when assembling or installing Wenger Corporation products. If any questions or problems arise, call Wenger Corporation at 1-800-887-7145.

Manufacturer

The TranSport Cart is manufactured by:

Wenger Corporation
555 Park Drive
Owatonna, MN 55060
(800) 4WENGER (493-6437) • +1 (507) 455-4100
wengercorp.com

Intended Use

- This product is intended for indoor use in normal ambient temperature and humidity conditions — it must not be exposed to prolonged outside weather conditions.
- This product is intended to transport gear within a facility and outdoor and to convert to a table for use as a work surface, sideline table or trainer's table.
- This product is intended for trailering behind slow-moving motorized vehicles such as Gators™, golf carts, ATVs etc.
- This product is intended to be used only as described in these instructions.

Warranty

This product is guaranteed free of defects in materials and workmanship for five full years from date of shipment. A full warranty statement is available upon request.

Safety Precautions

Throughout this document you may find cautions and warnings which are defined as follows:

- **WARNING:** Failure to follow the instruction could result in serious injury or damage to property.
- **CAUTION:** Failure to follow the instruction could result in minor injury or damage to property.

Read all of these safety instructions before installation or use.

CAUTION

Make sure anyone using the TranSport Cart has read and understands these instructions.

CAUTION

Failure to comply with Warnings and Cautions in this document can result in damage to property or serious injury.

Unpacking the Cart

1. Remove the packaging lid.
2. Using two people, lift the cart out of the carton.

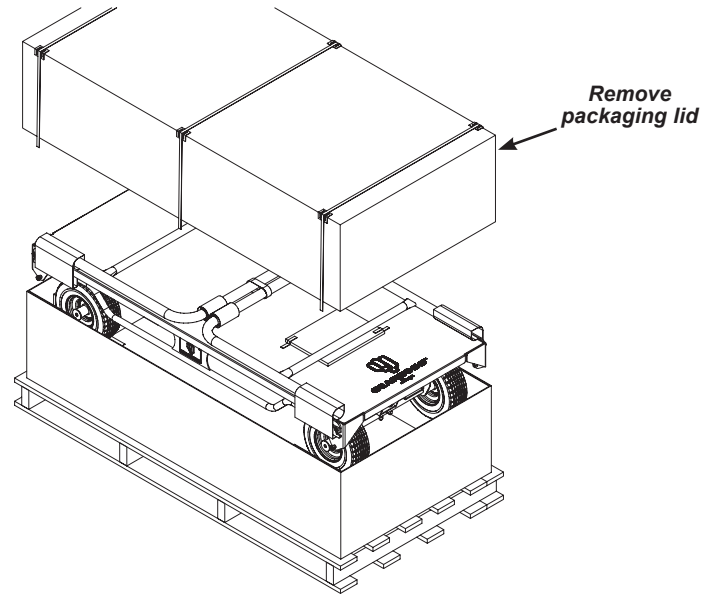

3. Place the cart onto its wheels and cut the nylon tie that secures the handle to the cart frame and rotate it upward.

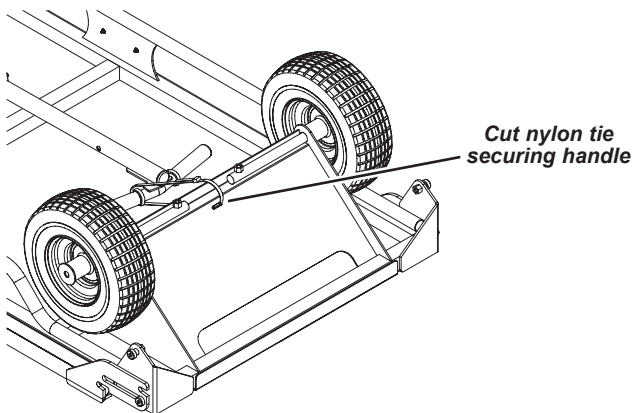

The cart is now in the Storage Configuration.

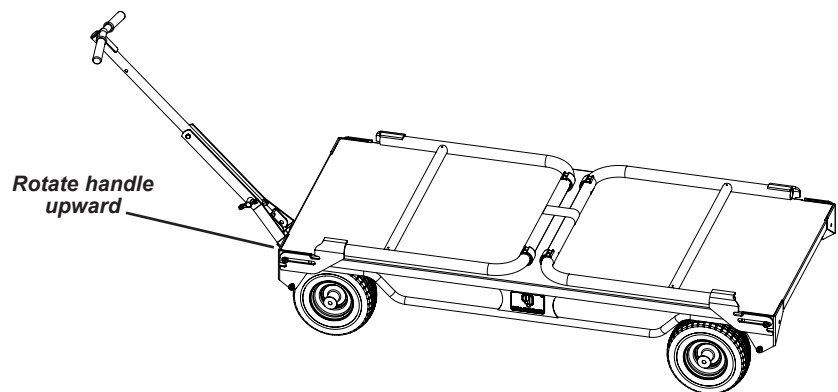

Storage Configuration

Storage Configuration to Cart Configuration

The cart is now in the Storage Configuration, to put the cart in the Cart Configuration:

1. Rotate the handle to a vertical position.
2. Undo the hook and loop strap and wrap around an end brace for storage.
3. Lift and raise each end brace until it is perpendicular to the cart deck surface.
The slots in the end brace should engage with the frame posts.

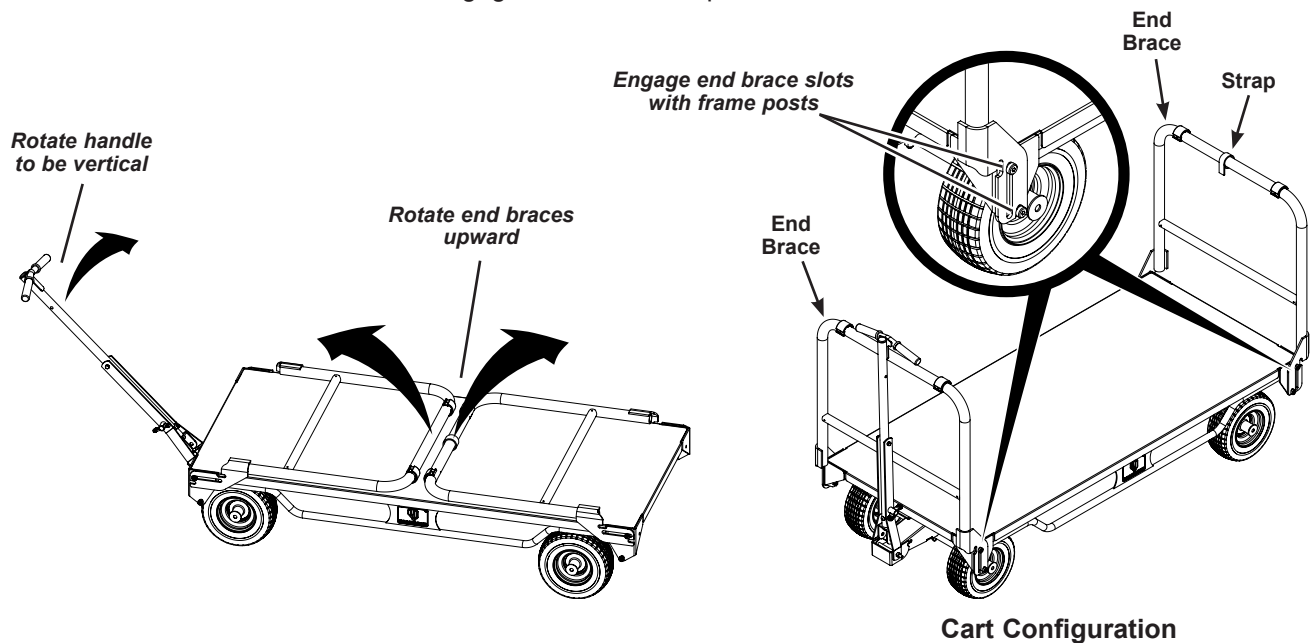

Cart Usage

If the cart is being pulled by hand, be sure to use enough people.
Use two or more people if any of the following conditions exist:

- Heavy loads (over 250 lb [113 kg])
- High loads (stacked above end frames or mesh wrap)
- Rough or soft ground
- Steep inclines

⚠ CAUTION

Pulling a heavy load at high speed could cause a crash that could result in injury or damage to the cart.

Never exceed 10 mph (16 kph). Trying to stop a heavy load could cause a crash.

⚠ CAUTION

Never exceed 5 mph (8 kph) (a fast walk) if the load is more than 500 lb (227 kg) or if the ground is rough.

⚠ CAUTION

Pull the cart slowly if the load is piled high, if turns are tight, or if the route includes ramps or inclines.

Cart Configuration to Towing Configuration

1. Pull out on the handle to release the lock position.
3. Rotate the handle downward.

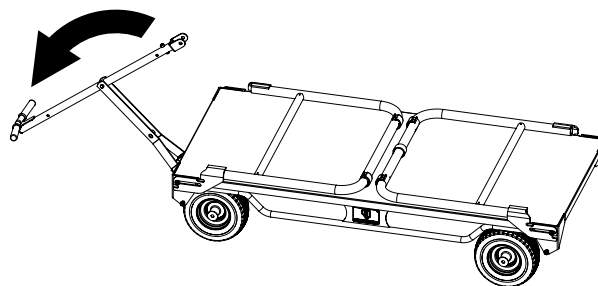
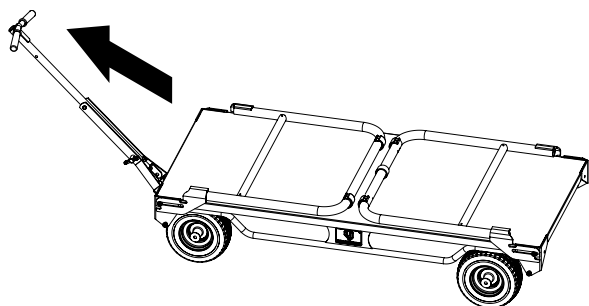

Note: End braces are shown folded down for clarity.

2. Remove the carriage bolt and wing nut from the handle.

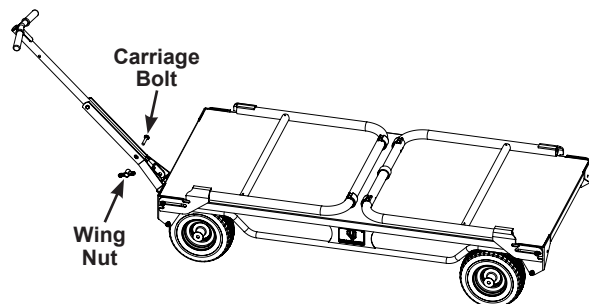

4. Replace the carriage bolt and wing nut. The cart is now ready to be attached to the towing vehicle.

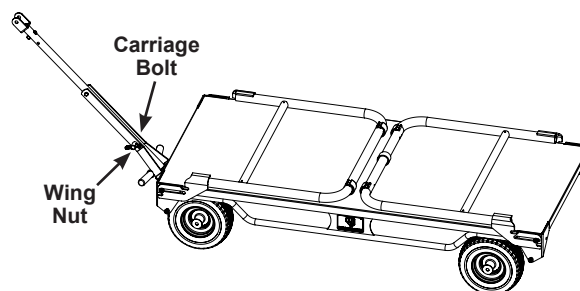

Towing Configuration

Towing Usage

If the cart is being pulled by a tow vehicle (Gators™, golf carts, ATVs etc.), be sure to secure the load and pull the cart at a safe speed.

⚠ CAUTION

Pulling a heavy load at high speed could cause a crash that could result in injury or damage to the cart.

Never exceed 10 mph (16 kph). Trying to stop a heavy load could cause a crash.

⚠ CAUTION

Never exceed 5 mph (8 kph) (a fast walk) if the load is more than 500 lb (227 kg) or if the ground is rough.

⚠ CAUTION

Pull the cart slowly if the load is piled high, if turns are tight, or if the route includes ramps or inclines.

⚠ CAUTION

Never reverse a tow vehicle with the cart connected. Backing a cart into position can easily result in a "jack-knife" and damage to the pull handle or tow vehicle.

Cart Configuration to Table Configuration

It is recommended to use two people when converting the cart to the Table Configuration.

To put the cart in the Table configuration:

1. Rotate the pull handle under the cart deck.
2. Lift the end braces and rotate them down to the ground.
3. Grip side of cart near one end and lift (two people), allowing the end brace to rotate into the “leg” position.
4. Grip side of cart near opposite end and lift until the end brace rotates into position.
5. The slots in the end brace should engage with the posts.

⚠ CAUTION

Keep hands clear of the end braces when they are in motion. Gripping the cart in the wrong place could result in injury to hands or fingers.

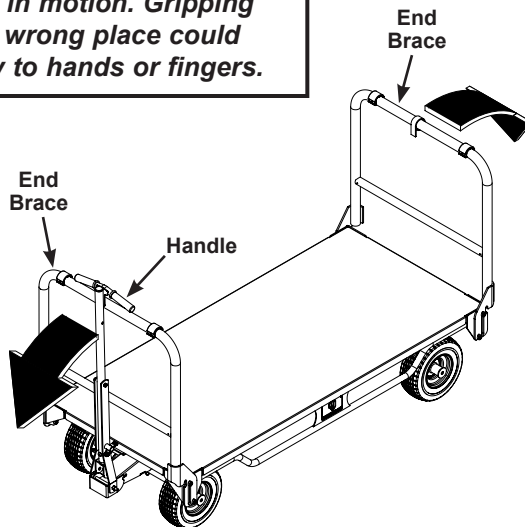

Engage end brace slots with frame posts

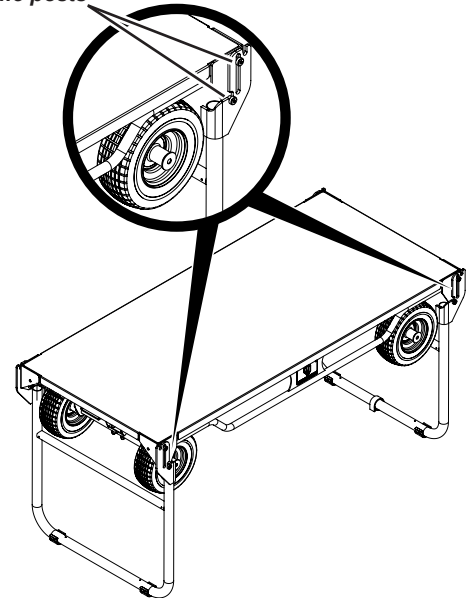

Table Configuration

Table Usage

If the cart is being used in the Table Configuration, make sure that the following conditions exist:

- Do not exceed 1000 lb (454 kg) of weight on table
- Distribute weight evenly on table
- Never try to move a loaded table
- Use caution on rough or soft ground
- Do not use Table Configuration on steep inclines

⚠ CAUTION

Never try to move a loaded table. Lifting the table may release the end braces suddenly, causing an upset and resulting in injury or damage to equipment. Always remove items from the table, convert it back to a cart (using two people) and move it to its new location.

⚠ CAUTION

Never exceed 1000 lb (454 kg) of weight on the table. Be sure that weight is evenly distributed.

⚠ CAUTION

Use caution on rough or soft ground. Do not use Table Configuration on inclines.

Table Configuration to Storage Configuration

It is recommended to use two people when converting the cart to the Storage Configuration.

To put the cart in the Storage Configuration:

1. Grip side of cart near one end and lift (two people), rotating the end brace up to lay on the cart deck.
2. Grip side of cart near opposite end, lift and rotate the end brace up to lay on the cart deck.
3. Secure end braces together using the hook and loop strap.

⚠ CAUTION

Keep hands clear of the end braces when they are in motion. Gripping the cart in the wrong place could result in injury to hands or fingers.

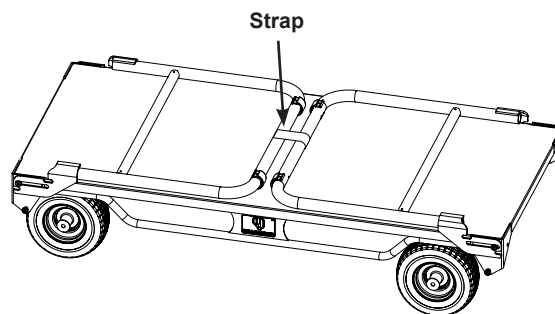
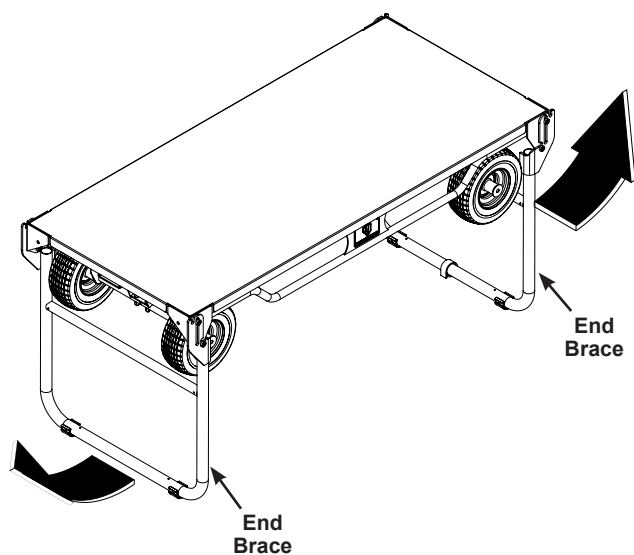

Mesh Wrap

Install the optional mesh wrap to help secure contents while in the Cart Configuration.

1. Slide the mesh wrap over the end braces.
2. Secure the plastic brackets attached to the mesh wrap.

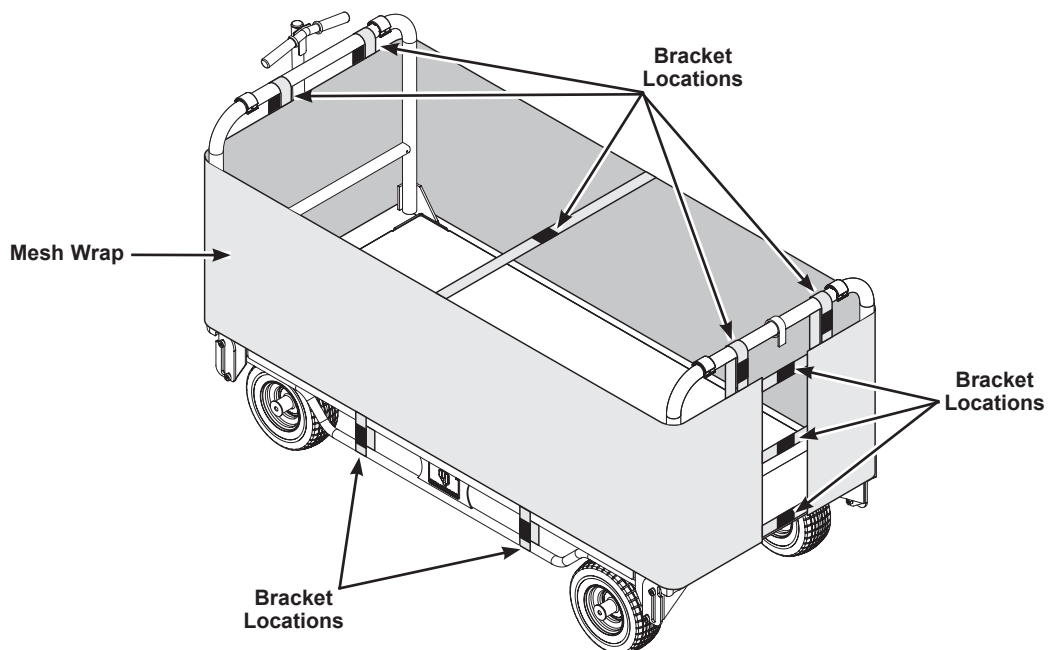

Maintenance

- Keep tires inflated to 15-20 psi (103-138 kPa).
- Once a year, apply light oil to the front axle king pin.

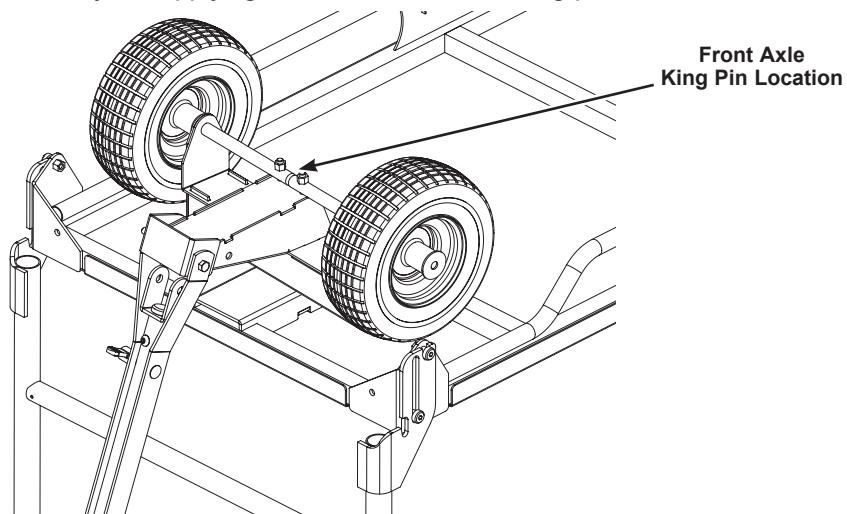

Note: If the cart is often stored outside, it may be necessary to apply oil every 6 months.

- If paint gets chipped or scratched, apply touch-up paint. Call Wenger Customer Service for recommendations.

Note: The deck of the cart is aluminum and will not rust if scratched.

Transporting the Cart

The cart may be loaded onto a truck or trailer if the following recommendations are observed:

- Load and unload the cart from a loading dock if possible.
- If a ramp is used, it should slope no more than 20 degrees (or 36%).
- If a ramp is used, make sure there are enough people to safely push the loaded cart up the ramp.

Example: A cart loaded with 500 lb (227 kg) of gear would require 235 lb (107 kg) of push to roll up a 20 degree ramp. At least three people would be required to do the job safely.

- Secure the cart inside the truck.
- Due to its pneumatic tires, severe road conditions could cause a loaded cart to bounce radically. Blocking and strapping the cart will help prevent damage to the cart or the load.

If the cart is loaded with equipment for a long road trip, the following is recommended:

- Wood blocking from the truck floor the cart frame.
- Heavy duty ratchet strap(s), mounted low on the cart, anchored to the truck wall.
- Padding between the cart and the truck wall to limit damage to paint or fabric wrap.

CAUTION

***A runaway cart could cause injury
or damage to anything in its path.***

Replacement Parts

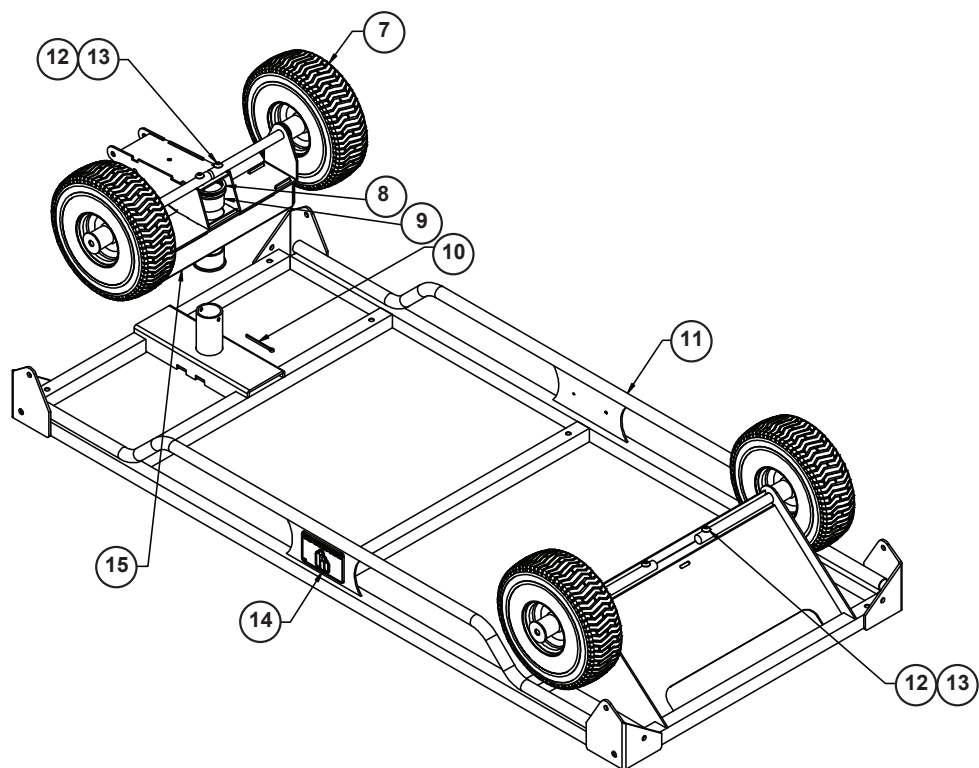
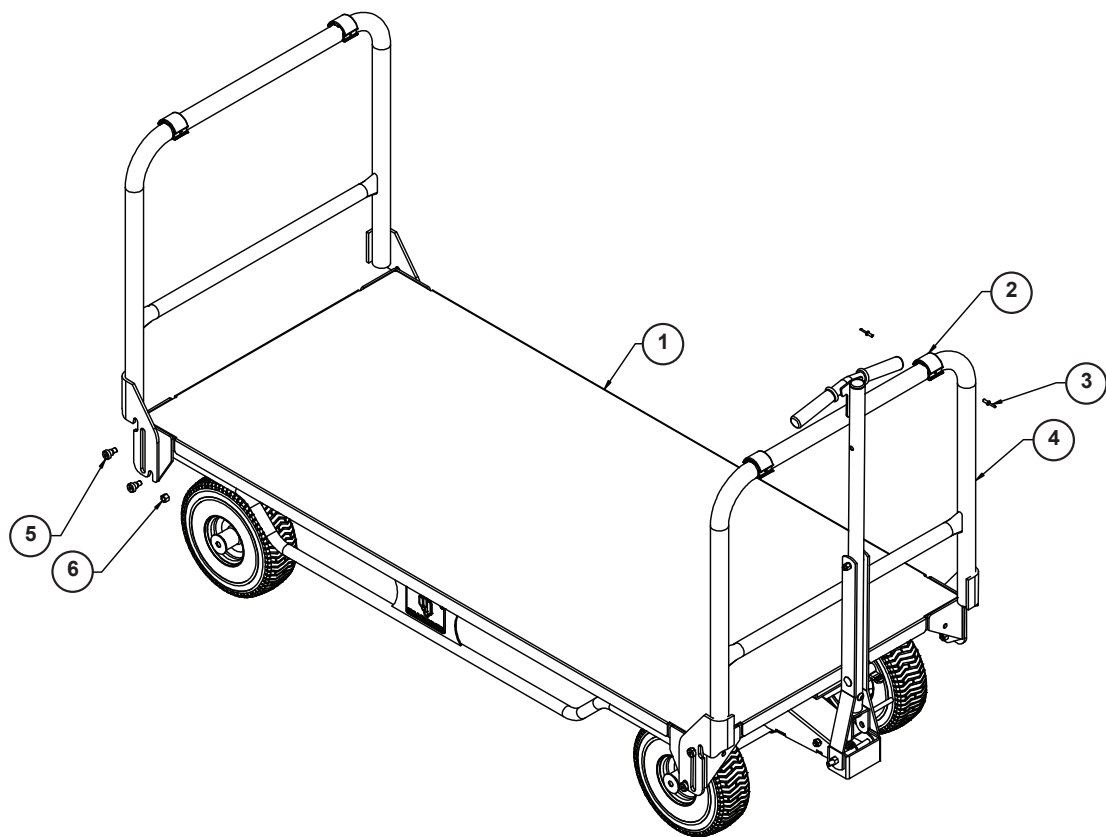

Replacement Parts (continued)

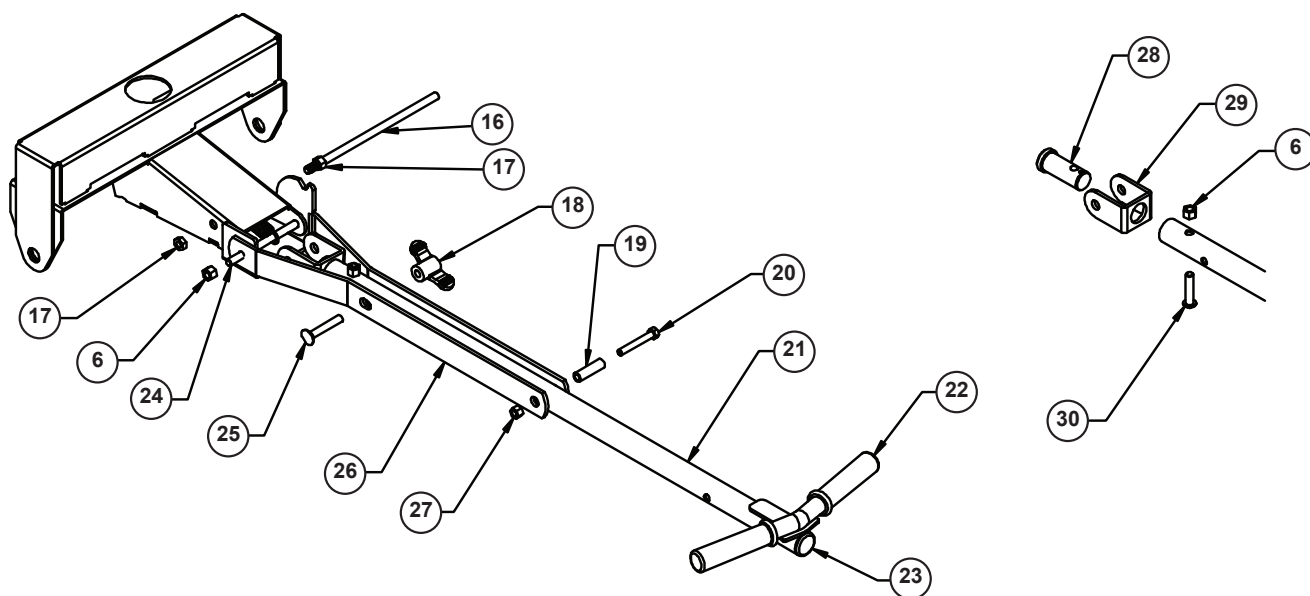

Item	Description	Item	Description
1	Deck	16	Handle Release Rod
2	Bumper	17	Jam Lock Nut, 3/8-16
3	Rivet, 3/6"	18	Plastic Knob
4	Loop Tube Weldment	19	Handle Rotate Tube
5	Shoulder Bolt, 3/8-16 x 3/8"	20	Capscrew, 5/16-18 x 2-1/4"
6	Lock Nut, 3/8-16	21	Upper Handle Weldment
7	Wheel	22	Handle Grip 7/8" ID x 4-1/2"
8	Flat Washer, 2-1/2"	23	Tube Plug, 1-1/4 OD
9	Flange Bearing	24	Capscrew, 3/8-16 x 5-1/4"
10	Cotter Pin, 2-1/2"	25	Carriage Bolt, 3/8-16 x 2"
11	Chassis Weldment	26	Lower Handle Weldment
12	Lock Nut, 5/16-16	27	Lock Nut, 5/16-18
13	Socket Screw, 5/16-16 x 1-1/2"	28	Clevis Pin, 2-5/8"
14	Gearboss Plate	29	Hitch Bracket
15	Front Yoke Weldment	30	Socket Screw, 3/8-16 x 1-3/4"