

# Traditional Acoustic Panel Series: Absorber Panels



## Absorber Panels

Panels are fabric covered utilizing the Guilford of Maine Company's FR701® Style 2100 series of fabric in a variety of colors.

- Manufacturer's standard construction of 2" (51 mm), 3" (76 mm), and 4" (102 mm) thick 6 pcf, glass fiber board, hardened resin edges, covered with fabric. Final assembly meets 2018 IBC requirements for Class A interior finishes.
- Corner brackets to receive mounting hardware
- Environmental attributes for our products can be found at [www.wengercorp.com/green-initiatives.php](http://www.wengercorp.com/green-initiatives.php) or by contacting your Wenger representative
- Five-year warranty

## Wall Absorber Panels

Nominal Dimensions	Actual Dimensions	2" (51 mm) Thick Weight	3" (76 mm) Thick Weight	4" (102 mm) Thick Weight
2' x 2' (610 x 610 mm)	23-3/16" x 23-3/16" (589 x 589 mm)	5 lb (2.27 kg)	7 lb (3.18 kg)	9 lb (4.08 kg)
2' x 3' (610 x 914 mm)	23-3/16" x 35-3/16" (589 x 894 mm)	7 lb (3.18 kg)	10.5 lb (4.76 kg)	13.5 lb (6.12 kg)
2' x 4' (610 x 1219 mm)	23-3/16" x 46-7/8" (589 x 1191 mm)	9.5 lb (4.31 kg)	14 lb (6.35 kg)	18 lb (8.16 kg)
2' x 5' (610 x 1524 mm)	23-3/16" x 58-7/8" (589 x 1495 mm)	12 lb (5.44 kg)	17.5 lb (7.94 kg)	22.5 lb (10.21 kg)
2' x 6' (610 x 1829 mm)	23-3/16" x 70-7/8" (589 x 1800 mm)	14.5 lb (6.58 kg)	21 lb (9.53 kg)	27 lb (12.25 kg)
2' x 8' (610 x 2438 mm)	23-3/16" x 94-7/8" (589 x 2410 mm)	19 lb (8.62 kg)	28 lb (12.70 kg)	36 lb (16.33 kg)
3' x 3' (914 x 914 mm)	35-3/16" x 35-3/16" (894 x 894 mm)	11 lb (4.99 kg)	16 lb (7.26 kg)	20.5 lb (9.30 kg)
3' x 4' (914 x 1219 mm)	35-3/16" x 46-7/8" (894 x 1191 mm)	14.5 lb (6.58 kg)	21 lb (9.53 kg)	27 lb (12.25 kg)
3' x 5' (914 x 1524 mm)	35-3/16" x 58-7/8" (894 x 1495 mm)	18 lb (8.16 kg)	26 lb (11.79 kg)	34 lb (15.42 kg)
3' x 6' (914 x 1829 mm)	35-3/16" x 70-7/8" (894 x 1800 mm)	22 lb (9.98 kg)	31.5 lb (14.29 kg)	41 lb (18.60 kg)
3' x 8' (914 x 2438 mm)	35-3/16" x 94-7/8" (894 x 2410 mm)	29 lb (13.15 kg)	42 lb (19.05 kg)	54.5 lb (24.72 kg)
4' x 4' (1219 x 1219 mm)	46-7/8" x 46-7/8" (1191 x 1191 mm)	19 lb (8.62 kg)	28 lb (12.70 kg)	36 lb (16.33 kg)
4' x 5' (1219 x 1524 mm)	46-7/8" x 58-7/8" (1191 x 1495 mm)	24 lb (10.89 kg)	35 lb (15.88 kg)	45 lb (20.41 kg)
4' x 6' (1219 x 1829 mm)	46-7/8" x 70-7/8" (1191 x 1800 mm)	29 lb (13.15 kg)	42 lb (19.05 kg)	54.5 lb (24.72 kg)
4' x 8' (1219 x 2438 mm)	46-7/8" x 94-7/8" (1191 x 2410 mm)	38.5 lb (17.46 kg)	56 lb (25.40 kg)	72.5 lb (32.89 kg)

**Note:** Custom sizes are available.

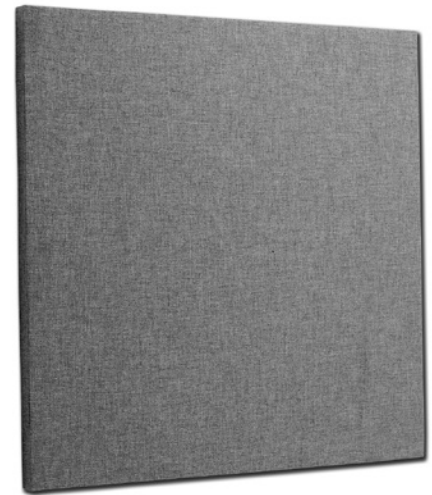

Absorber Panel

## Ceiling Absorber Panels

Nominal Dimensions	Actual Dimensions	2" (51 mm) Thick Weight	3" (76 mm) Thick Weight	4" (102 mm) Thick Weight
2' x 2' (610 x 610 mm)	23-3/16" x 23-3/16" (589 x 589 mm)	5 lb (2.27 kg)	7 lb (3.18 kg)	9 lb (4.08 kg)
2' x 3' (610 x 914 mm)	23-3/16" x 35-3/16" (589 x 894 mm)	7 lb (3.18 kg)	10.5 lb (4.76 kg)	13.5 lb (6.12 kg)
2' x 4' (610 x 1219 mm)	23-3/16" x 46-7/8" (589 x 1191 mm)	9.5 lb (4.31 kg)	14 lb (6.35 kg)	18 lb (8.16 kg)
3' x 3' (914 x 914 mm)	35-3/16" x 35-3/16" (894 x 894 mm)	11 lb (4.99 kg)	16 lb (7.26 kg)	20.5 lb (9.30 kg)
3' x 4' (914 x 1219 mm)	35-3/16" x 46-7/8" (894 x 1191 mm)	14.5 lb (6.58 kg)	21 lb (9.53 kg)	27 lb (12.25 kg)
4' x 4' (1219 x 1219 mm)	46-7/8" x 46-7/8" (1191 x 1191 mm)	19 lb (8.62 kg)	28 lb (12.70 kg)	36 lb (16.33 kg)

**Note:** Ceiling absorber panels mount directly to a permanent ceiling or suspend from wires only.  
No lay-in or clip-in option is available for suspended ceiling grids.

## Installation

- Acoustic panels are designed for easy installation
- Panels are shipped fully assembled with mounting hardware included (fasteners not included) for a secure installation

### Ceiling Absorber Panel Installation

Direct Mount

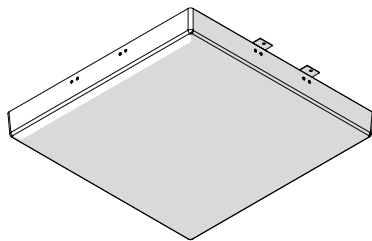

Ceiling Grid Mount Options

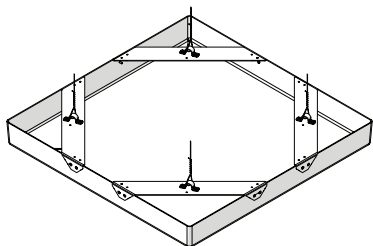
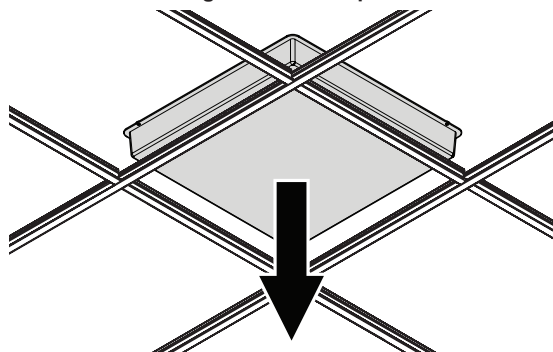

Suspended by wire

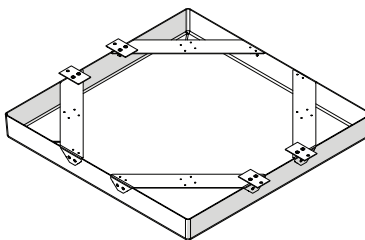

Lay-in Clip

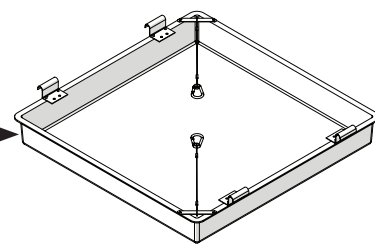

Designer Clip

### Wall Absorber Panel Installation

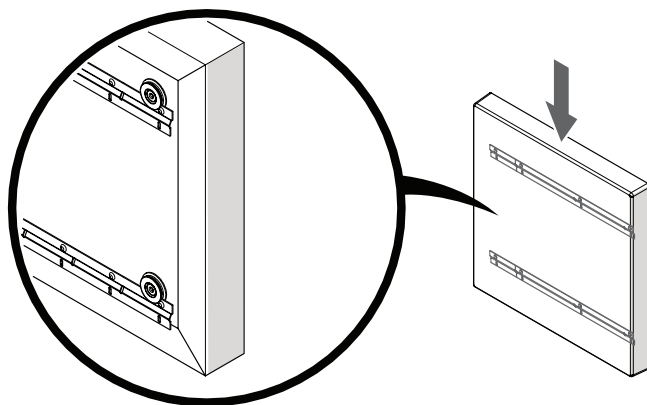

### Acoustical Performance

Sound Absorption Coefficient							
One-Third Octave Band Center Frequency (Hz)							
Mounting Type		125	250	500	1000	2000	4000
Wall and Ceiling Absorbers							
F-6	2" (51 mm)	0.50	0.96	1.27	1.27	1.23	1.18
	3" (76 mm)	0.65	1.10	1.31	1.23	1.20	1.09
	4" (102 mm)	0.84	1.17	1.34	1.32	1.25	1.20
F-6 Mounting 1/4" (6 mm) air space (to simulate typical wall installation).							

Wenger®

JRCLANCY

GEARBOSS®

© 2022 Wenger Corporation  
USA/2022-10

### MUSIC EDUCATION AND PERFORMING ARTS

Owatonna Office: Phone 800.4WENGER (493-6437) Worldwide +1.507.455.4100 | Parts & Service 800.887.7145 | wengercorp.com  
555 Park Drive, PO Box 448 | Owatonna | MN 55060-0448

Syracuse Office: Phone 800.836.1885 Worldwide +1.315.451.3440 | jrclancy.com | 7041 Interstate Island Road | Syracuse | NY 13209-9713

ATHLETICS Phone 800.493.6437 | email gearboss@wengercorp.com | gearboss.com | 555 Park Drive, PO Box 448 | Owatonna | MN 55060-0448