



Your Performance Partner

Owner's Manual Orchestra Pit Filler

CONTENTS

- Safety Precautions 2
 - Pit Filler Stability 2
 - Transport and Storage Carts 2
- Setting Up for the First Time 2
- Warranty 3
- Pit Filler Installation Procedure 4
 - Review Material 4
 - Install First Main Beam 4
 - Assemble First Bay 7
 - Continue Adding Bays 9
- Pit Filler Disassembly Procedure 10
 - Disassemble Accessories 10
 - Disassemble Decks 10
 - Loosen Main Beam Anchors 11
 - Disconnect Cross Beam Diagonal from Columns 11
 - Disassemble the Understructure 12
- Transport and Store Pit Filler 14
 - Deck Transport and Storage Cart 14
 - Column and Beam Storage and Transport Cart 14
- Maintenance 15
 - Decks 15
 - Drapery Closures 15
 - Other Preventive Maintenance 15
- Replacement Parts List 16
 - Deck 16
 - Column Bracket 17
 - Beam Brace Bracket 18
 - Column Foot 19
 - Column Brace Bracket 19
 - Cross Beam 20
 - Cross Beam Socket 20
 - Anchor Bracket, Stage Edge 21
 - Anchor Bracket, Audience Wall 22
 - Optional Cart Assembly 23

Note: Please read and understand the Orchestra Pit Filler Owner's Manual before starting the assembly. Familiarize yourself with the Pit Filler features and installation instructions.

Remove all items from the shipping containers and sort the components by size, length, etc. Refer to the illustrations on the following pages. If you need additional information about your Orchestra Pit Filler, write or telephone Wenger Corporation at the number below.

SAFETY PRECAUTIONS

Throughout this manual you will find **CAUTIONS** and **WARNINGS** which are defined as follows.

- **WARNING** means that failure to follow the instruction may result in serious injury or death.
- **CAUTION** means that failure to follow the instruction may result in serious injury or damage to the pit filler.

SETUP

- Make sure that anyone who helps set up the Pit Filler is familiar with this manual.
- Many steps require that two persons work together in the setup.



PIT FILLER STABILITY

- All Pit Filler Main Beams and Cross Beams must be connected together using the methods described in this manual.
- The assembly must comply with the instructions contained in the Owner's Layout Drawing. For additional copies of the Owner's Layout Drawing, contact Wenger Corporation Customer Service at 1-800-887-7145



TRANSPORT AND STORAGE CARTS

- Before loading pit filler components onto a cart, always lock the casters on the cart.
- Always secure the decks to the cart after loading to prevent the Decks from falling.



SETTING UP FOR THE FIRST TIME

- 1 Remove all parts from their shipping cartons (refer to the packing list enclosed with the shipment). Save all packaging materials until the orchestra pit filler has been set up and assembled for the first time.
2. Sort all orchestra pit filler items by size, length, etc.
3. If the orchestra pit filler is to be stored before the initial set up and assembly, go to the *TRANSPORT AND STORE PIT FILLER* section.
4. If the Orchestra Pit Filler is to be set up immediately, go to *Installation Procedure* section.

NOTE: Read and understand this entire manual before starting the assembly.

WARRANTY

Wenger Orchestra Pit Fillers are guaranteed free of defects in materials and workmanship for five full years.

Our guarantee assures you of either a full refund or repair or replacement of the defective materials or workmanship without charge, at the discretion of our Customer Service Department. Just call a Customer Service Representative at 1-800-887-7145 and state the reason you are dissatisfied. If a product return is necessary, your representative will issue a return authorization. This is your sole remedy for breach of this warranty.

Should you have a question or problem with any Wenger product, don't hesitate to call, even if the product is past warranty. It's important to us that all our customers be satisfied.

This is the sole warranty made by Wenger. Wenger disclaims all other warranties, including the warranties of merchantability and fitness for a particular purpose, as well as all liability for incidental, consequential, special, and indirect damage. Wenger liability for direct damages shall be limited to the amount you paid for the product involved. Wenger reserves the right to make product changes without obligation to incorporate such changes into products previously sold.

Some states do not allow the exclusion or limitation of damages or warranties, so the above may not apply to you. This warranty gives you specific legal rights. You may also have other rights which vary from state to state.

PIT FILLER INSTALLATION PROCEDURE

REVIEW MATERIAL

1. Review the owner's packet that contains a layout drawing with instructions relating to the orchestra pit filler installation.

Note: The numbering scheme on the layout drawing is *letters for support structures* and *numbers for deck components*.

! WARNING

To avoid injury, two persons must always set up the Orchestra Pit Filler.

INSTALL FIRST MAIN BEAM

1. Each end of the Main Beam has a letter designation beginning with the letter A. Refer to the layout drawing to identify which Beam and Column to assemble first and where in the pit the assembly starts.
2. Attach two columns to the first main beam by first matching the letters on the Columns to the letters on the Main Beam, A to A, B to B, and so on. Then, insert a Snap Lock Pin through the hole in each Column and Column Bracket.

! WARNING

Components must be connected as specified in this manual.

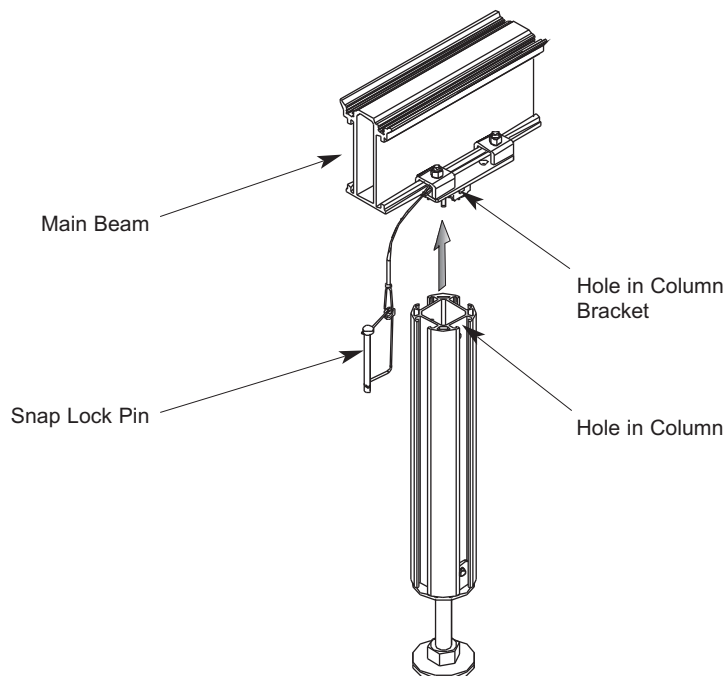

INSTALLATION PROCEDURE (CONTINUED)

INSTALL FIRST MAIN BEAM (CONTINUED)

3. Connect the Main Beam Diagonal Braces to the Columns by inserting a Tab Lock Pin through the hole in each Column Brace Bracket and Diagonal Brace.

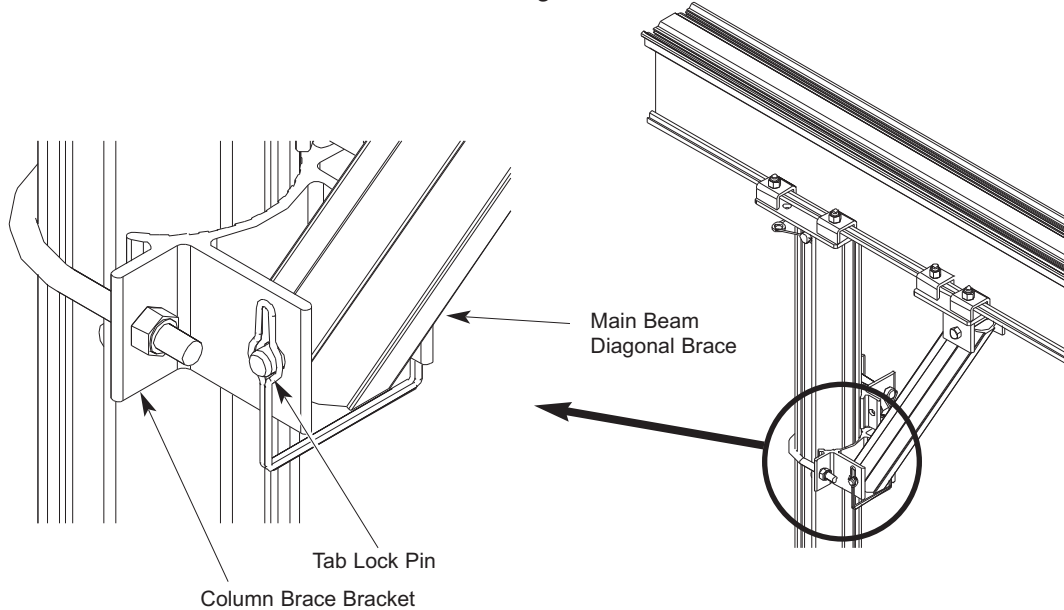

4. With two people working together, tilt the Main Beam and Columns upward. Align the Column feet to the marks on the floor to make sure that the assembly is in the correct position.

Note: The beam should be set to the proper elevation and level after the initial Wenger installation and should not require leveling adjustment.

Note: Make sure that the Stage Edge Anchor Bracket is adjacent to the Stage Edge and that the Audience Wall Anchor Bracket is adjacent to the Audience Wall.

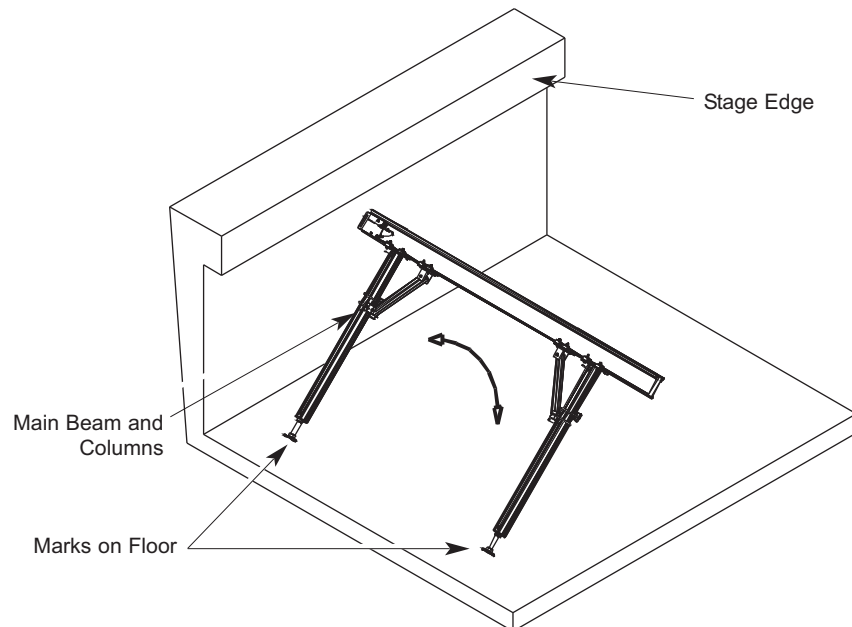

INSTALLATION PROCEDURE (CONTINUED)

INSTALL FIRST MAIN BEAM (CONTINUED)

5. Insert the Anchor Bolt through the Anchor Plate and screw it clockwise into the Stage edge or Audience Wall. **Do not tighten!**

Note: The Anchor Bolt should be tight enough to keep the Main Beam from falling but allow the Beam to shift as other Main Beams and Decks are installed.

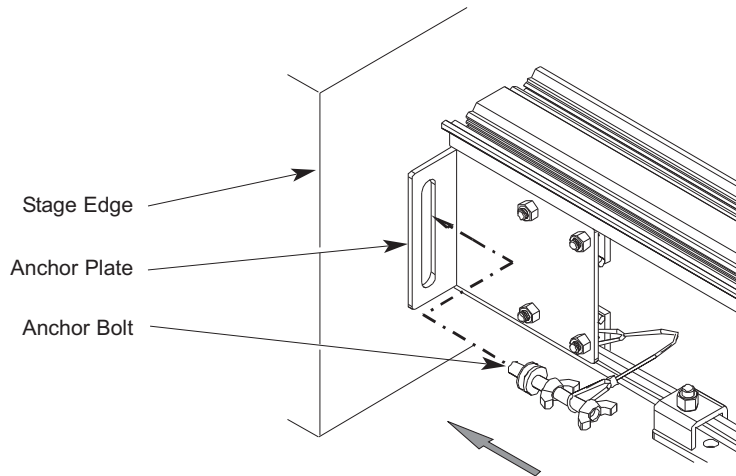

Attaching Main Beam to Stage Edge

! WARNING
Components must be connected as specified in this manual.

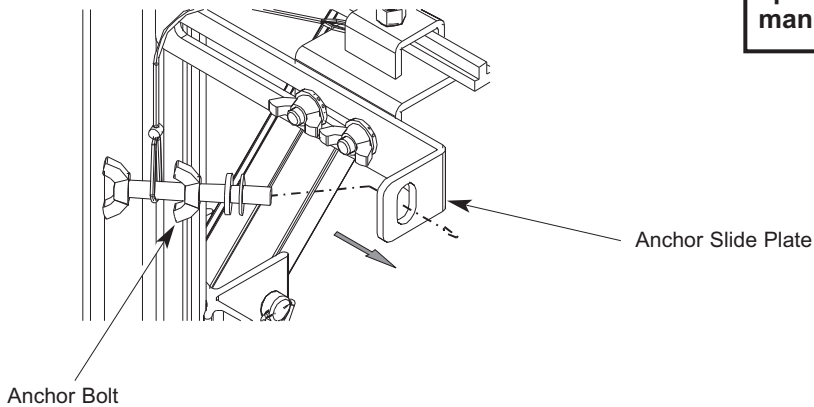

Audience Wall is not shown

Attaching the Main Beam to the Audience Wall

INSTALLATION PROCEDURE (CONTINUED)

ASSEMBLE FIRST BAY

1. Attach columns to the adjacent Main Beam as described in the *Install First Main Beam* sub-section. Make sure that the letters on the Beam and Columns match.
2. Pin the Main Beam Diagonal Braces as described in the *Install First Main Beam* sub-section.
3. Tilt the Column and Beam upward, aligning the Column Feet with the floor markings.
4. Install the Pit Filler Bolts — **do not tighten**.
5. Install the Cross Beams between the two Main Beams by inserting the Cross Beam Pins into the the Cross Beam Sockets.

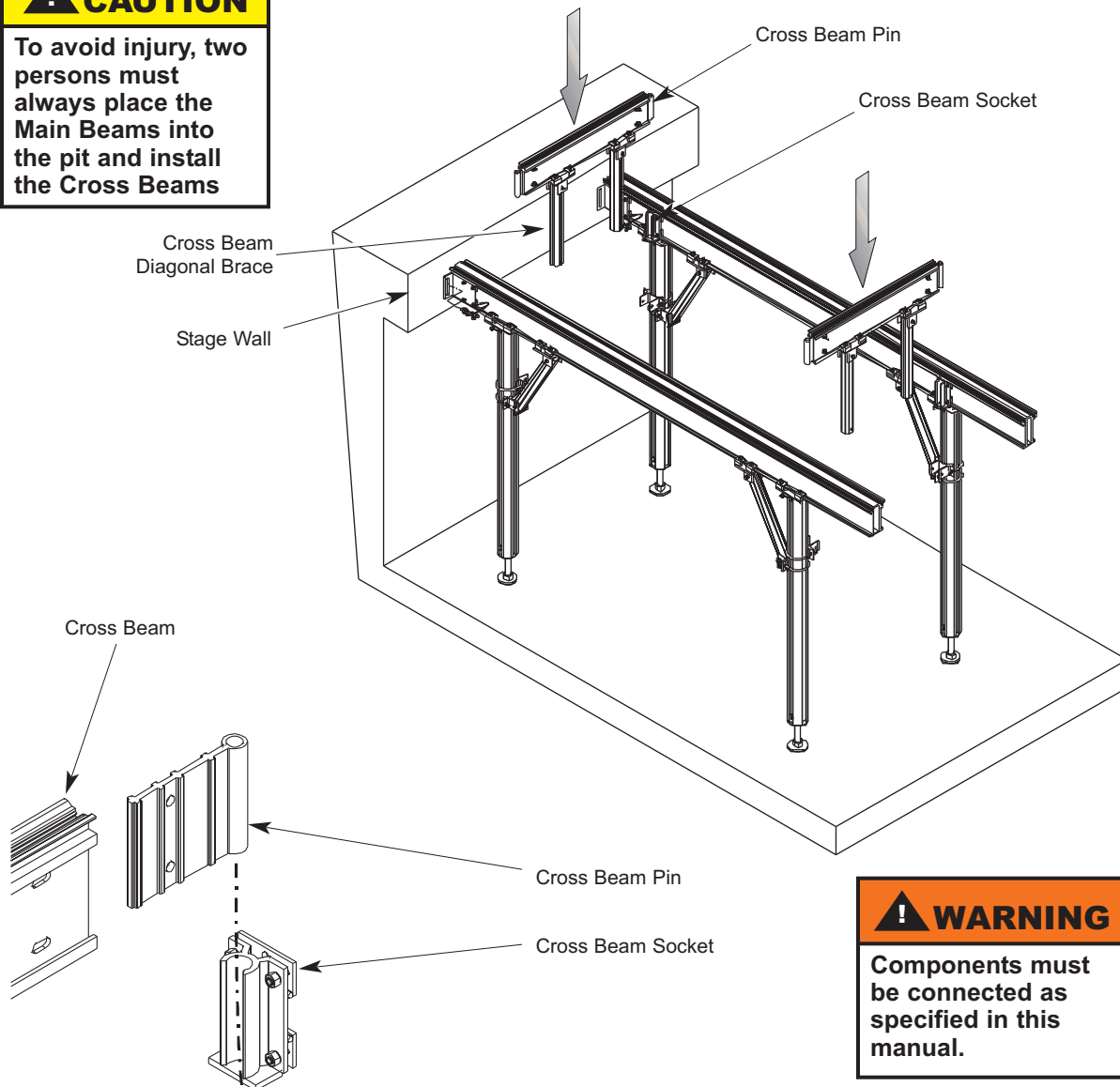

INSTALLATION PROCEDURE (CONTINUED)

ASSEMBLE FIRST BAY (CONTINUED)

6. Assemble the lower end of the Cross Beam Braces to the Columns by inserting the Tab Lock Pin through the hole in the Column Brace Bracket and the Hole in the Cross Brace.

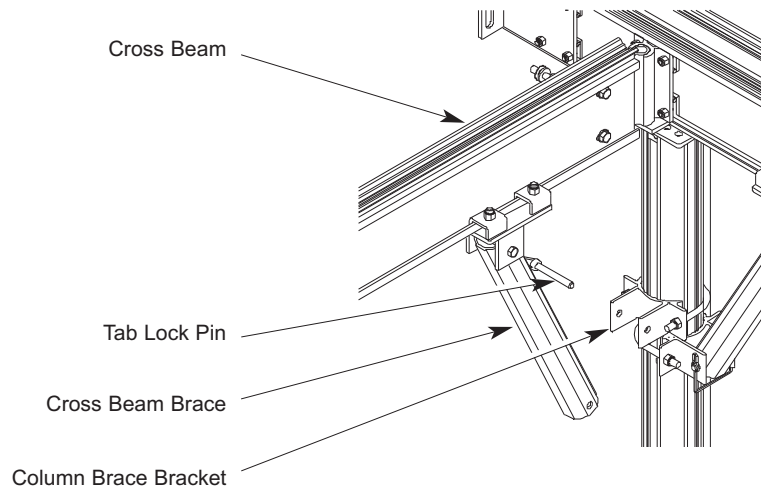

7. Starting at the stage edge, set the Decks onto the Main Beams. Make sure that the Lock Down Nodes on the bottom of the Decks fit into the channels on the Main Beams.

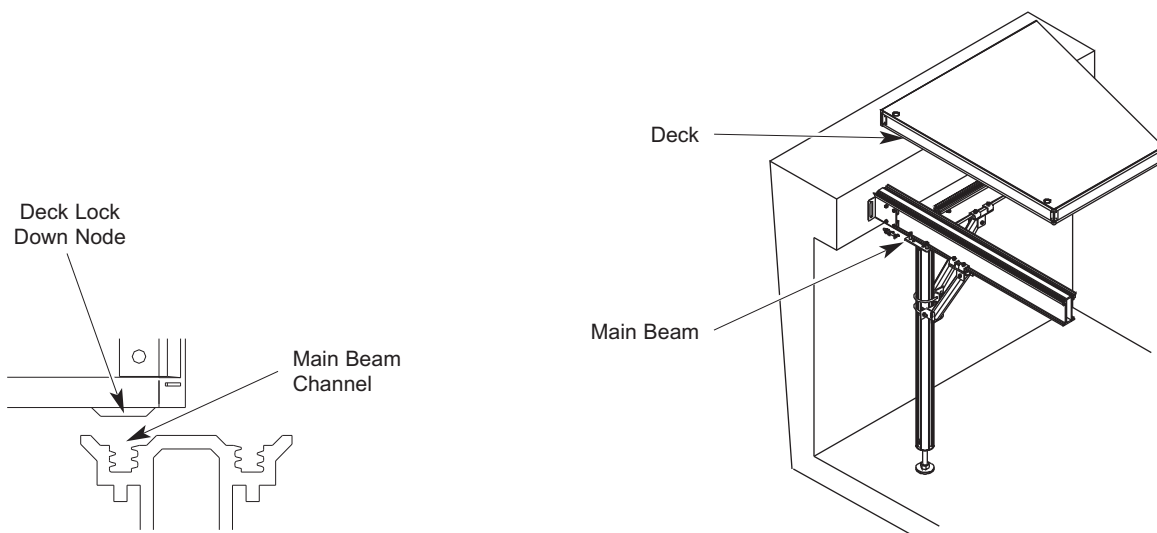

INSTALLATION PROCEDURE (CONTINUED)

ASSEMBLE FIRST BAY (CONTINUED)

8. Lock the Deck to the Main Beam by inserting a Hex Tool into a Lockdown Cap. While pressing the Hex Tool downward, turn the Hex Tool clockwise until the fastener is finger tight.

Note: Each Deck is numbered. Refer to the Owner's Layout Drawing for the proper deck placement.

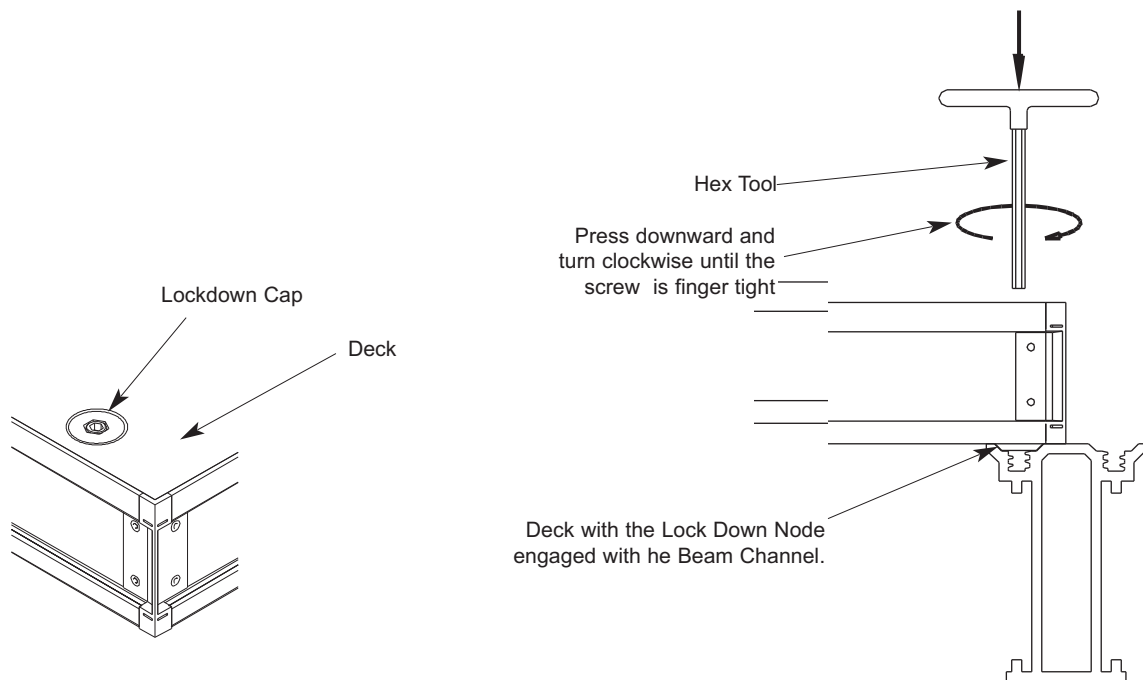

CONTINUE ADDING BAYS

1. Continue adding Bays to the first Bay, following the instructions in the *Assemble First Bay* sub-section.
2. Tighten the Beam Anchors at the Stage Edge and the Audience Wall.

INSTALL ACCESSORIES

1. Refer to the Owner's Drawing Installation Procedure to install any accessories that may be included with your Orchestra Pit Filler.

PIT FILLER DISASSEMBLY PROCEDURE

DISASSEMBLE ACCESSORIES

1. Remove any Accessories, such as back closures, drapery, etc., by reversing their installation procedure.

DISASSEMBLE DECKS

1. Unlock all of the Decks by inserting the Hex Tool into each Lockdown Cap and turning the Hex Tool counterclockwise until the Lockdown Screw pops up.
2. Remove each Deck and store it (on carts, if supplied).

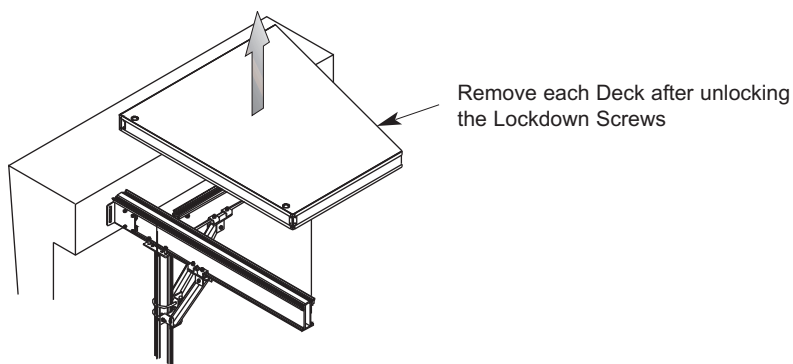
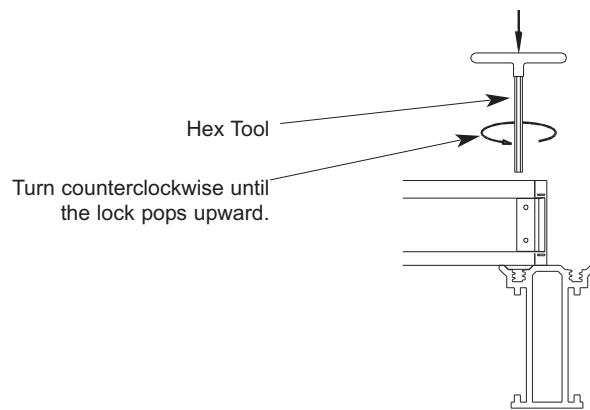

DISASSEMBLY PROCEDURE (CONTINUED)

DISCONNECT CROSS BEAM DIAGONAL FROM COLUMNS

1. Disconnect the lower end of the Cross Beam Diagonal Braces from the Columns by removing the Tab Lock Pin from the hole in the Column Brace Bracket and the Hole in the Diagonal.

Note: Do not remove the bolts that connect the Diagonals to the Cross Beams.

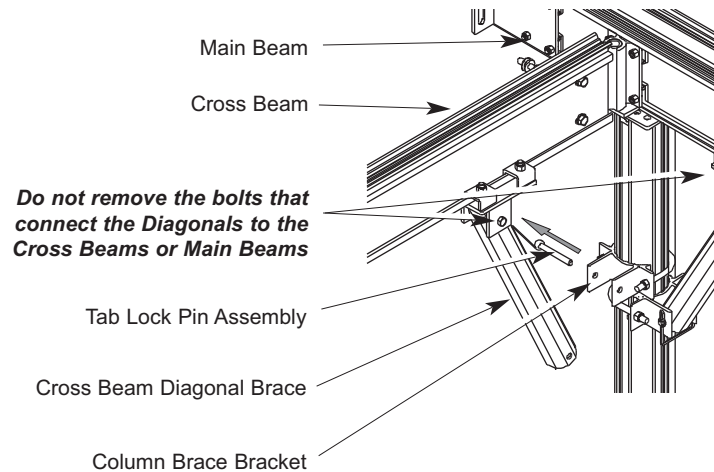

LOOSEN MAIN BEAM ANCHORS

1. Loosen, **but do not remove**, the Main Beam Pit Filler Anchor Bolt from the Stage Edge or Audience Wall. Removal of the Pit Filler Anchor Bolt will cause the Main Beams to fall which may cause serious injury or death.

! WARNING

To avoid injury, do not remove the Pit Filler Anchor Bolts.

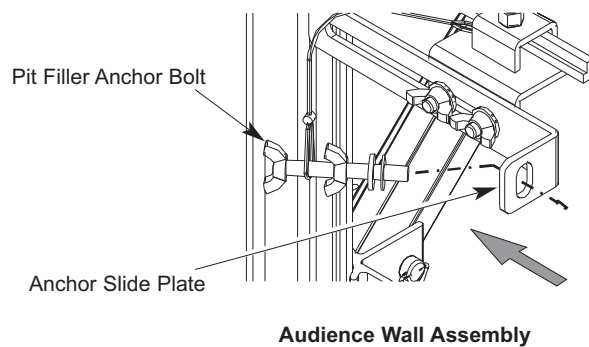
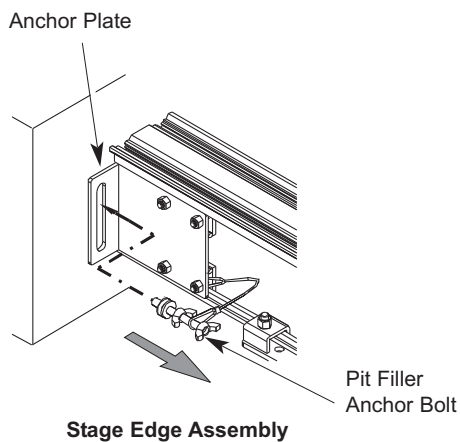

DISASSEMBLY PROCEDURE (CONTINUED)

DISASSEMBLE THE UNDERSTRUCTURE

1. Remove the Cross Beams and store (on storage cart, if supplied).

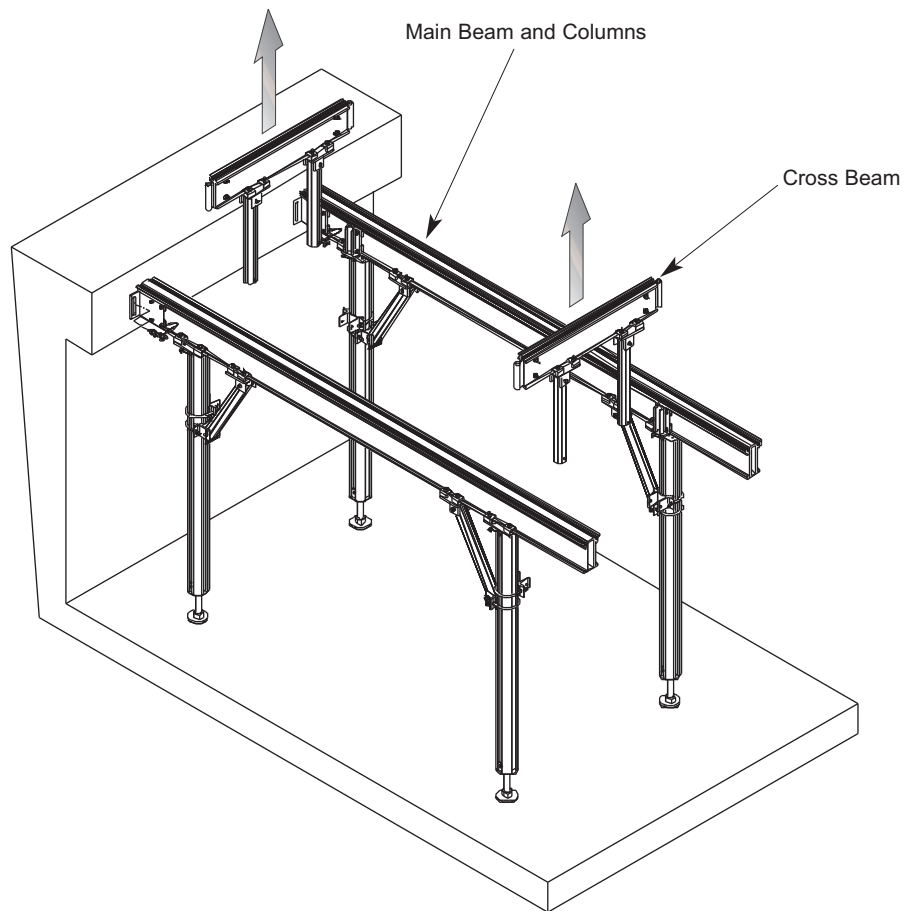

DISASSEMBLY PROCEDURE (CONTINUED)

DISASSEMBLE THE UNDERSTRUCTURE (CONTINUED)

2. With two people working together, hold the Main Beam and Columns in place and remove the Main Beam Anchor Bolts from the stage edge or audience wall.
3. With two people, carefully lay the Main Beam and Columns onto the pit floor.
4. Detach the Main Beam Diagonal Braces from the Columns by removing each Tab Lock Pin from the Column Brace Bracket and Brace. Leave the Main Beam Diagonal Braces bolted to the Main Beam.
5. Unpin each Column from the Main Beam.
6. Store the Main Beam and Columns (on storage cart, if supplied).
7. Continue these steps until the pit filler is completely disassembled.

! WARNING

To avoid injury, two persons must always lower the Column/Beam Assemblies onto the pit floor.

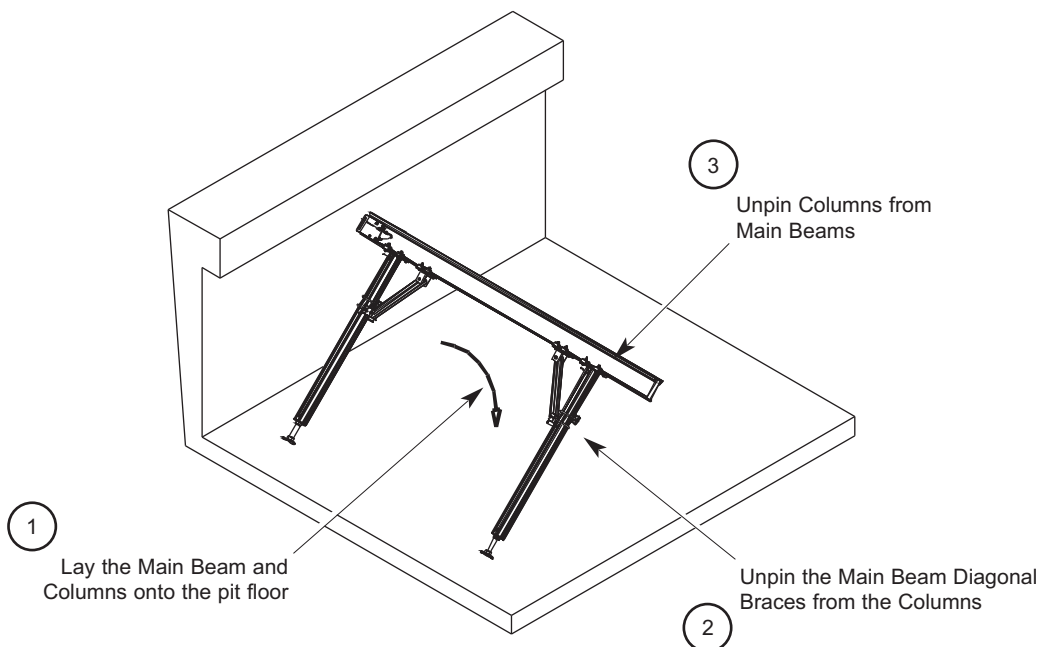

TRANSPORT AND STORE PIT FILLER

COLUMN AND BEAM STORAGE AND TRANSPORT CART

! CAUTION
Load the bottom racks first. Always balance the load on the cart.

! CAUTION
Always lock the casters when loading and unloading the Cart.

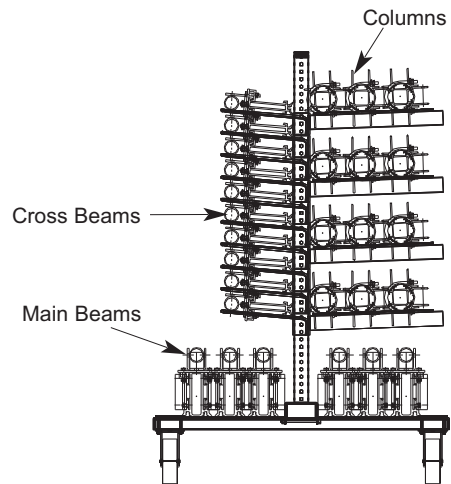
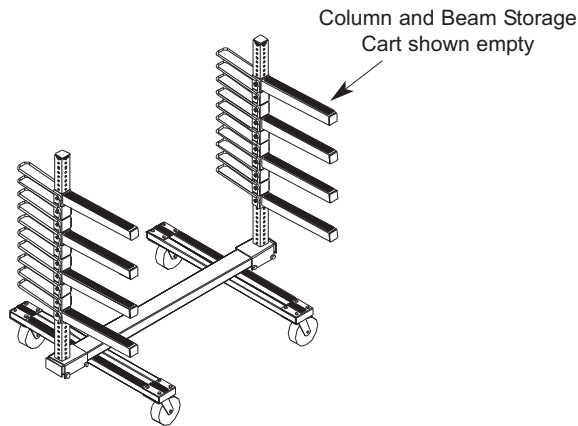

DECK TRANSPORT AND STORAGE CART

! CAUTION
Always lock the casters when loading and unloading the Cart.

! CAUTION
Always secure the Decks to the Cart so that they cannot fall or slide off the Cart

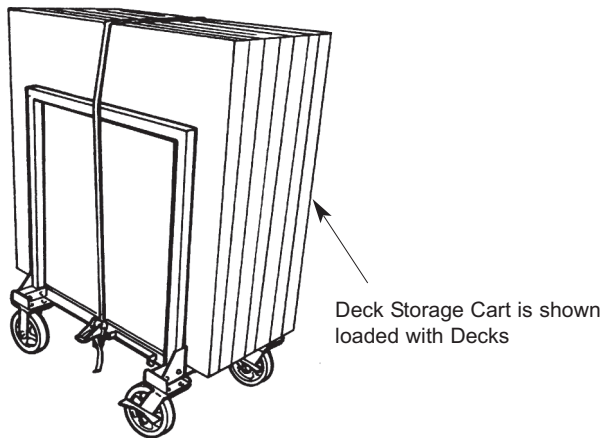

MAINTENANCE

DECKS

1. Keep the deck surfaces clean and dry.
2. Clean with a broom, brush, or damp mop (Never saturate the hardboard surface).
3. The hardboard surface can be painted with any paint suitable for flooring.

Note: The deck edging **cannot be painted**.

4. **Do not** use oil-based cleaning products or stains on the hardboard surface.
5. **Do not** wax or polish the hardboard surface.

DRAPERY CLOSURES

1. Drapery sections may be washed or dry-cleaned.
2. Drapery sections are attached with hook and loop (Velcro®) strips, to allow easy removal for cleaning.
 - Machine-wash at 120°F or lower using a mild detergent. Remove immediately after the wash cycle completes.
 - Tumble-dry at *permanent press* (maximum 120°F or a lower temperature setting) for 20 to 30 minutes. Remove and hang immediately to prevent wrinkling. Excessive heat or drying time will detract from the permanent-press characteristics of the fabric.
 - Little or no ironing is required.
 - Dry-clean using the Stoddard Method only at temperatures not over 120°F. Remove and hang immediately.

OTHER PREVENTIVE MAINTENANCE

1. Inspect and tighten all bolts on the beams, cross beams, and columns every six months.
2. Inspect all Lockdown Assemblies on the decks once every six months for proper function. Replace any Lockdown Assembly immediately if it does not function correctly.
3. Replace any worn, bent, or broken parts promptly to prevent injury. Contact Wenger Corporation's Parts and Product Support Department at 1-800-887-7145 for information regarding replacement parts. Or, contact Wenger Corporation at www.wengercorp.com.

REPLACEMENT PARTS LIST

DECK

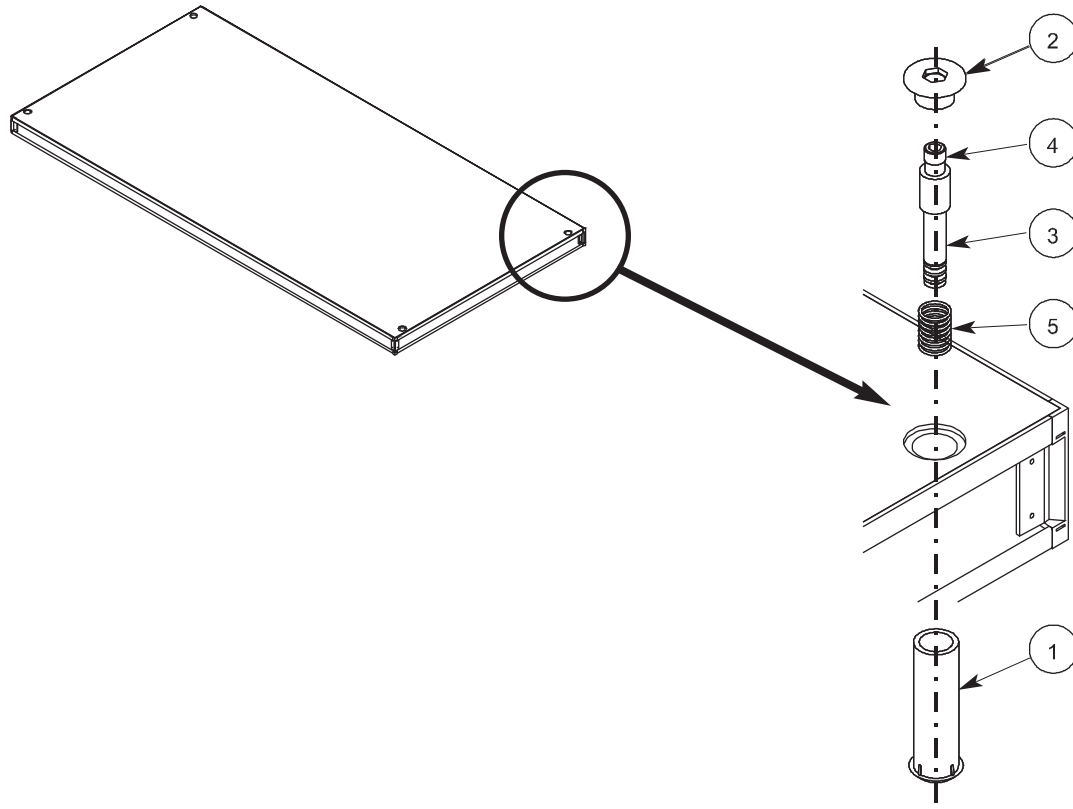

Item	Qty	Description
------	-----	-------------

1	4	Lockdown Sleeve
2	4	Lockdown Cap
3	4	Lockdown Screw
4	4	Capscrew, Socket, 5/16-18x3/4"
5	4	Compression Spring, .720 Diameter x 1 inch

REPLACEMENT PARTS LIST (CONTINUED)

COLUMN BRACKET

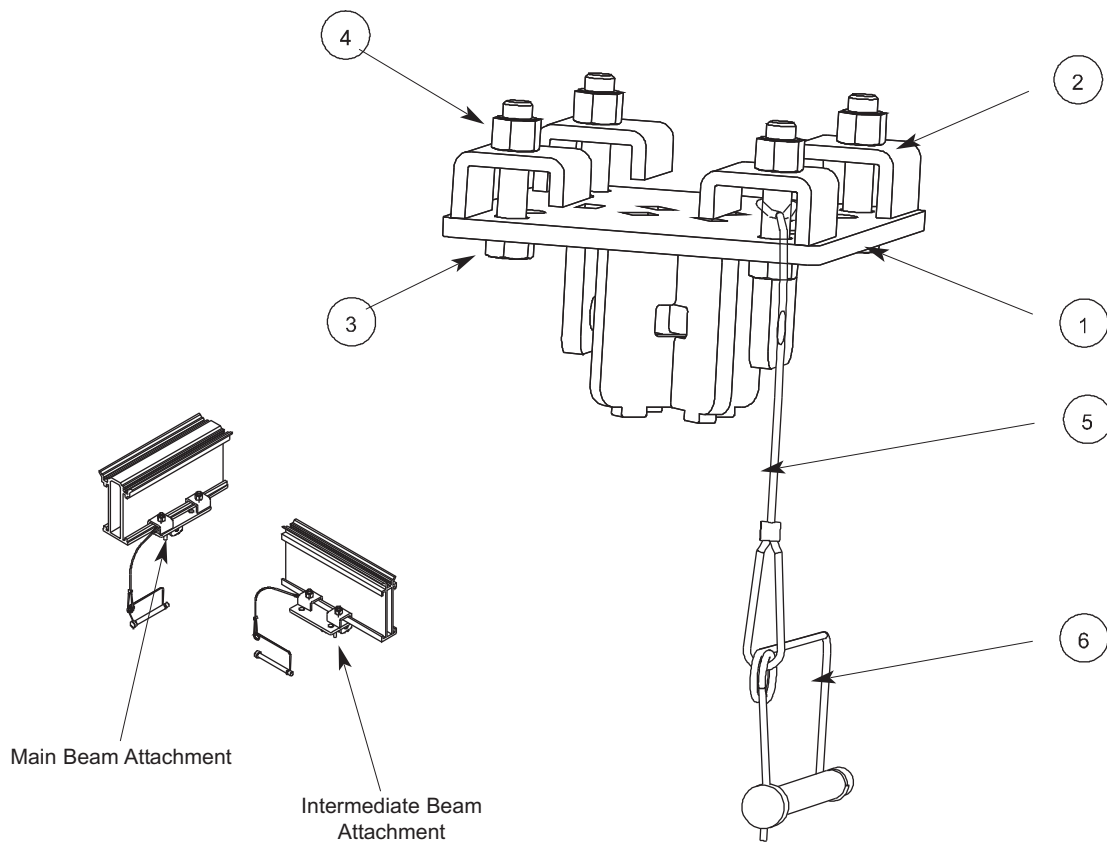

Item	Qty	Description
------	-----	-------------

1	1	Column Bracket Weldment
2	4	Column Bracket Clip
3	4	Capscrew, 3/8-16x1-3/4"
4	4	Lock Nut, 3/8-16
5	1	Lanyard
6	1	Snap Lock Pin, 3/8"x3-1/2"

REPLACEMENT PARTS LIST (CONTINUED)

BEAM BRACE BRACKET

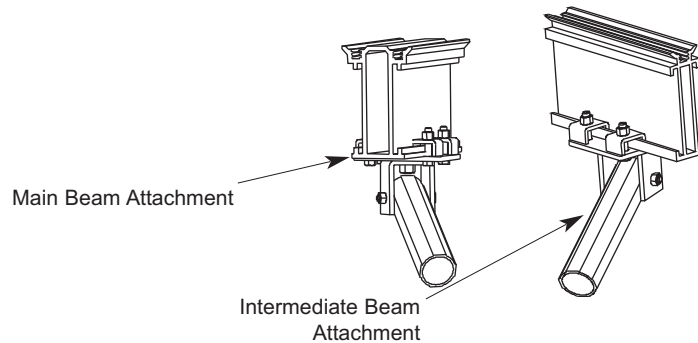
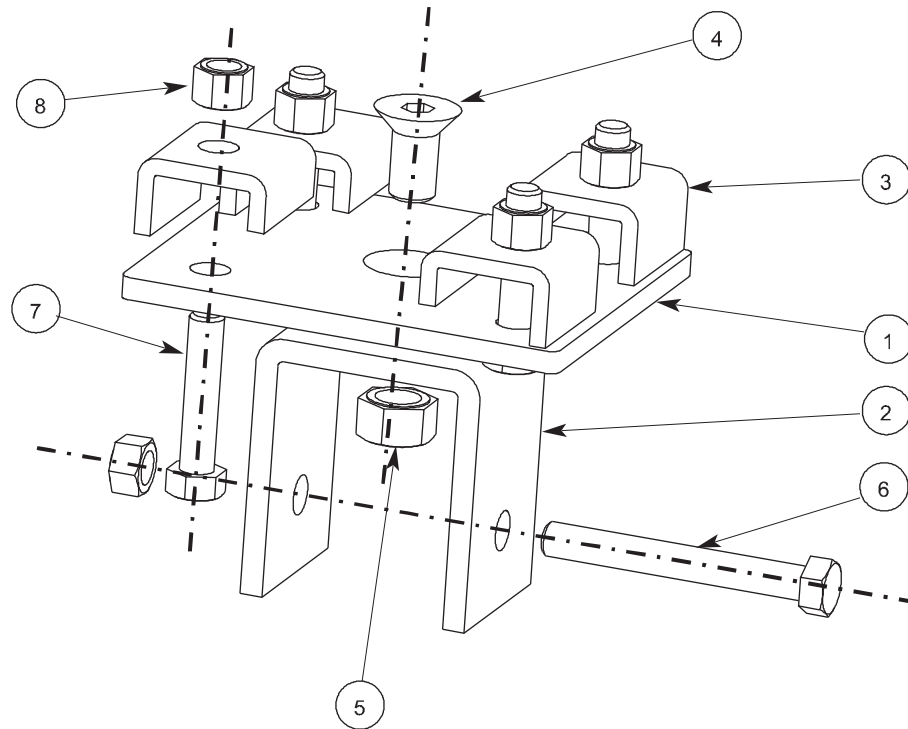

Item	Qty	Description
1	1	Brace Bracket Base Plate
2	1	U-Bracket Base
3	4	Column Bracket Clip
4	1	Flathead Screw, Socket 1/2-13x1"
5	1	Lock Nut, Hex Reversible, 1/2-13
6	1	Cap Screw, 3/8-16x3"
7	4	Cap Screw, 3/8-16x1-3/4"
8	5	Nylon Lock Nut, 3/8-16

REPLACEMENT PARTS LIST (CONTINUED)

COLUMN FOOT

Item	Qty	Description
1	1	Leveling Foot Assembly
2	1	Column Foot Insert Weldment
3	2	Screw, 1/4-20x3/4" Self Tapping

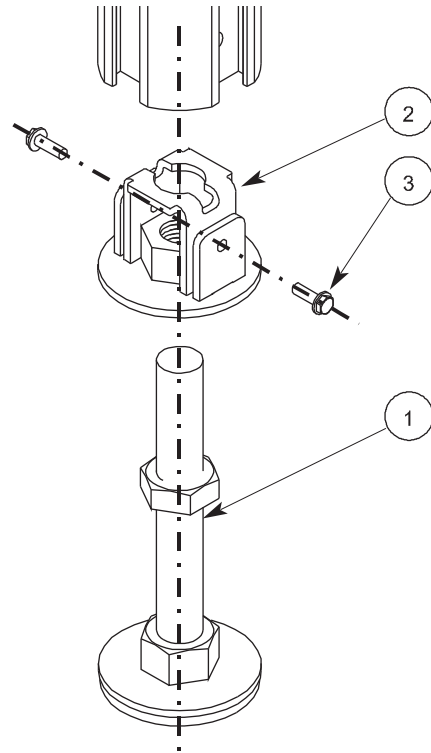

COLUMN BRACE BRACKET

Item	Qty	Description
1	1	Extrusion, Column Brace Bracket
2	1	U-Bolt, 3/8-16x4-1/8"
3	2	Nylon Lock Nut, 3/8-18
4	1	Nylon Lanyard
5	1	Pin, Tab Lock, 3/8 diameter x 2-3/4"

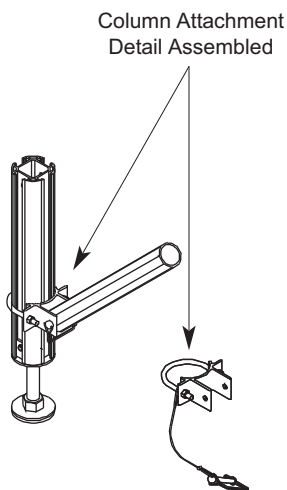
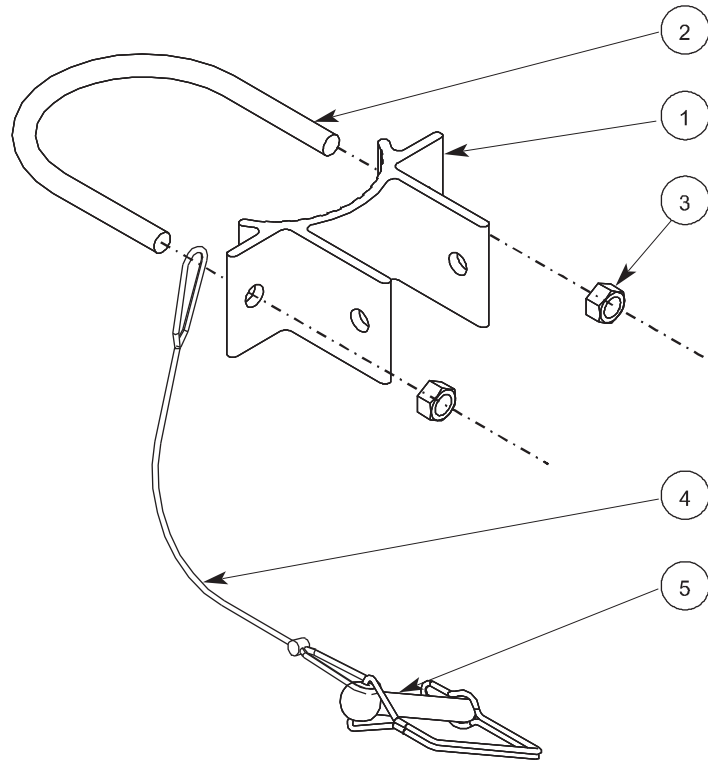

REPLACEMENT PARTS LIST (CONTINUED)

CROSS BEAM

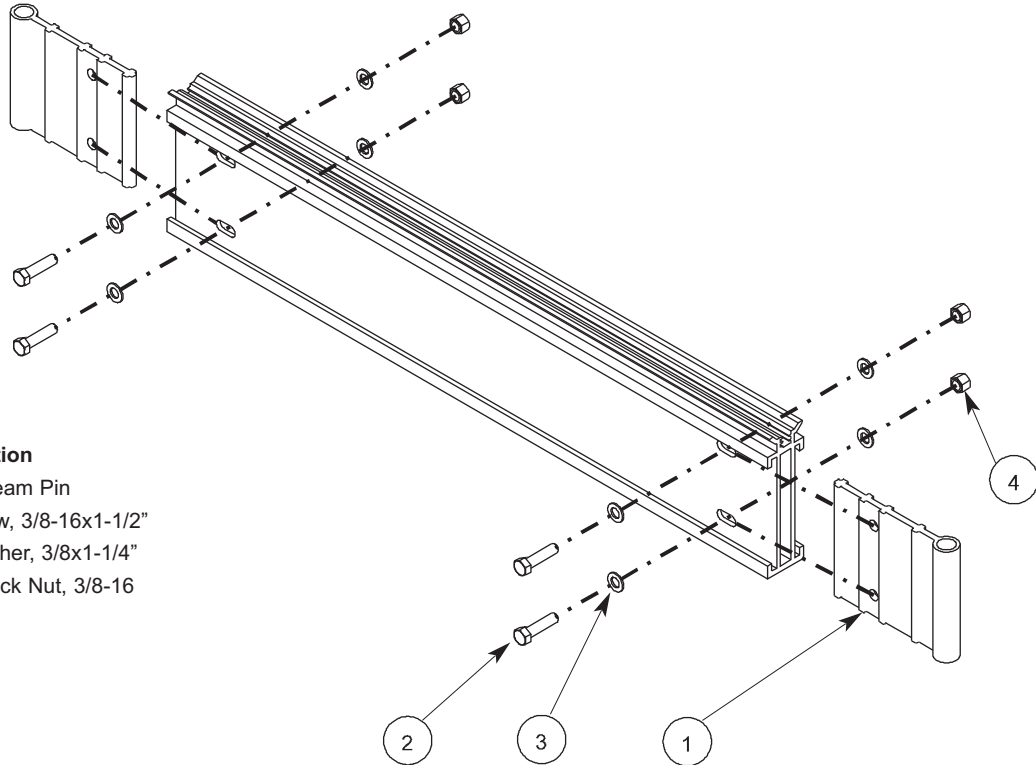

Item Qty Description

- | | | |
|---|---|-------------------------|
| 1 | 2 | Cross Beam Pin |
| 2 | 4 | Capscrew, 3/8-16x1-1/2" |
| 3 | 8 | Flat Washer, 3/8x1-1/4" |
| 4 | 4 | Nylon Lock Nut, 3/8-16 |

CROSS BEAM SOCKET

Item Qty Description

- | | | |
|---|---|-------------------------|
| 1 | 1 | Cross Beam Socket |
| 2 | 2 | Stud Clip |
| 3 | 4 | Nylon Lock Nut, 5/16-18 |

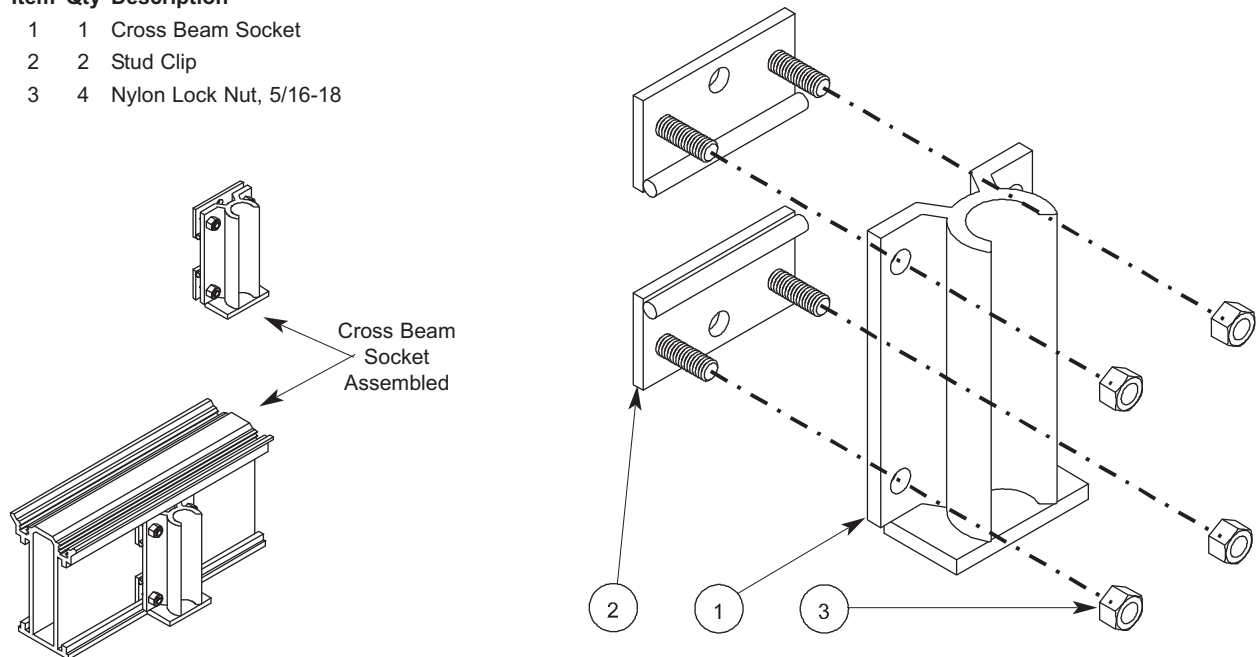

REPLACEMENT PARTS LIST (CONTINUED)

ANCHOR BRACKET, STAGE EDGE

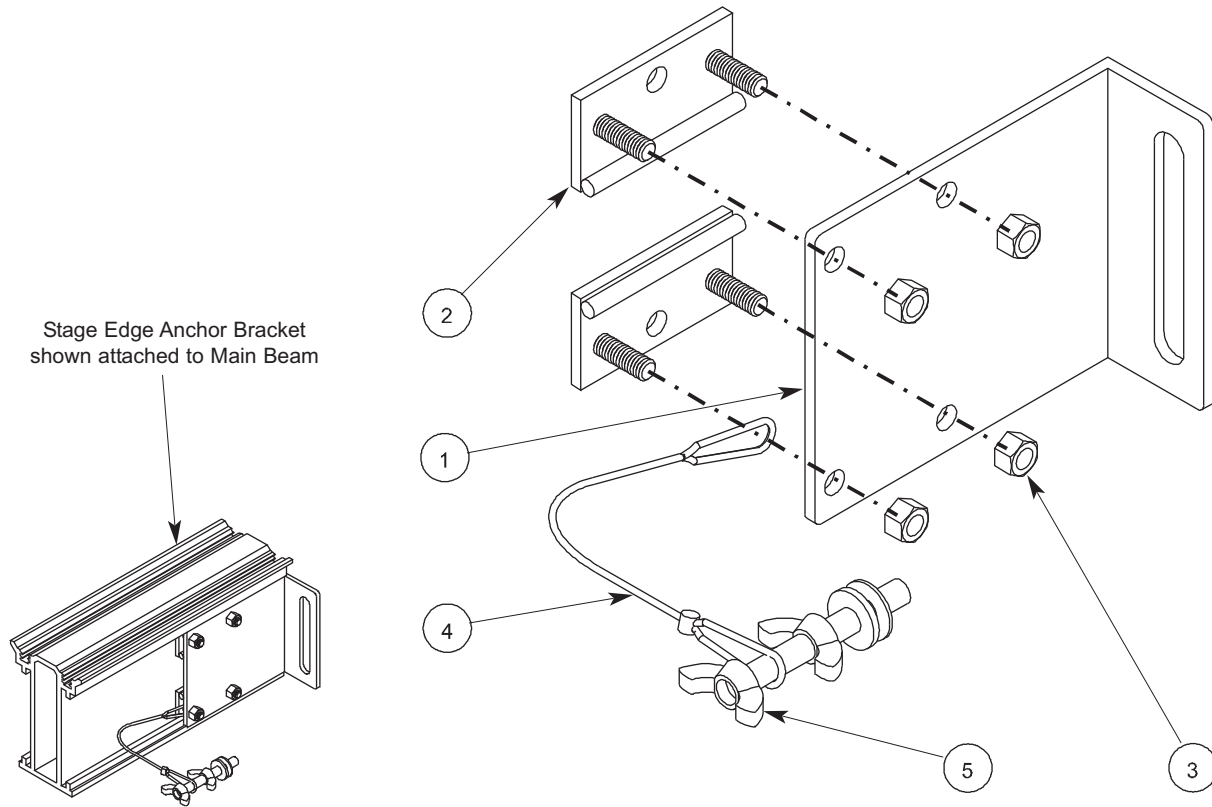

Item	Qty	Description
1	1	Anchor Bracket, Stage Edge
2	2	Stud Clip
3	4	Nylon Lock Nut, 5/16-18
4	1	Nylon Lanyard
5	1	Pit Filler Anchor Bolt

REPLACEMENT PARTS LIST (CONTINUED)

ANCHOR BRACKET, AUDIENCE WALL

Audience Wall Anchor Bracket Assembly shown attached to Main Beam

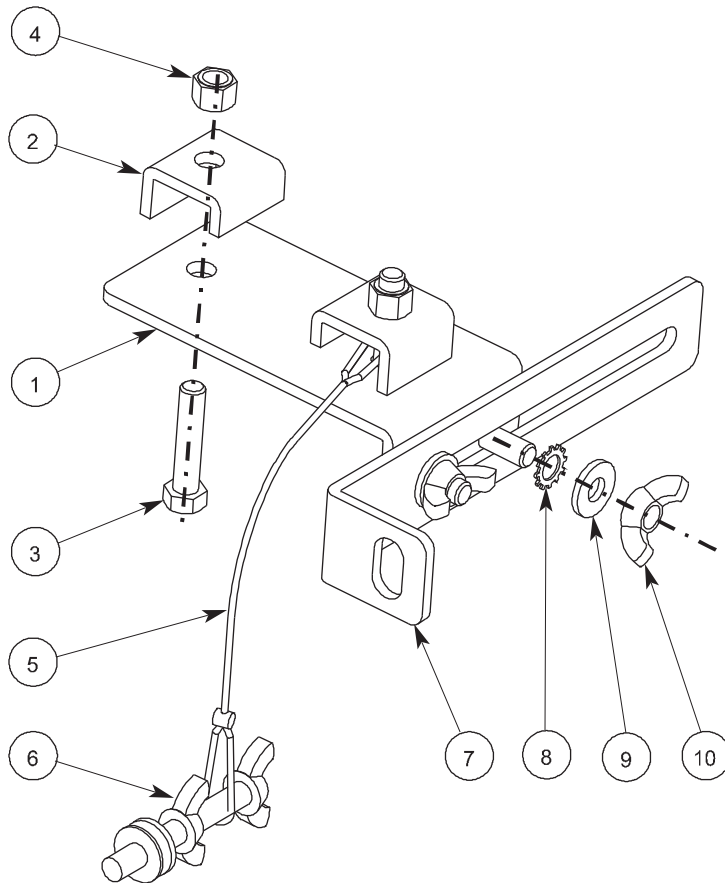
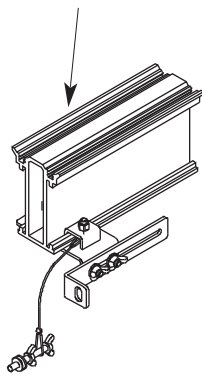

Item Qty Description

1	1	Anchor Bracket, Audience Wall
2	2	Bracket Clips
3	2	Capscrew, 3/8-16x1-3/4"
4	2	Nylon Lock Nut, 3/8-16
5	1	Nylon Lanyard
6	1	Pit Filler Anchor Bolt
7	1	Anchor Slide Bracket
8		Lock Washer, 3/8"
9		Flat Washer, 5/16"
10	2	Wing Nut, 3/8-16

REPLACEMENT PARTS LIST (CONTINUED)

STORAGE/TRANSPORT CART

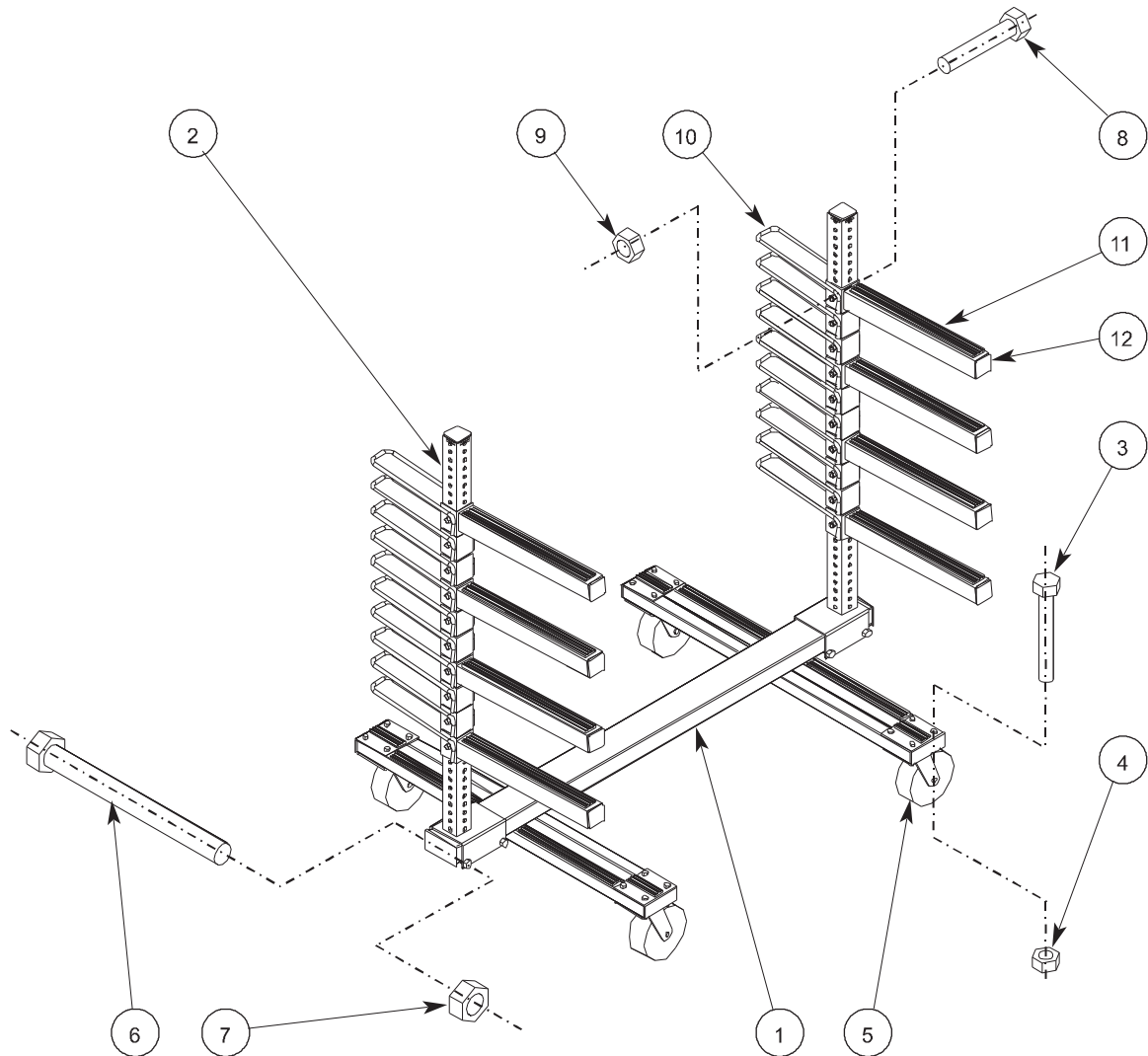

Item Qty Description

Item	Qty	Description
1	1	Base, Cart, Weldment
2	2	Upright, Cart Weldment
3	16	Capscrew, Grade 2, Zinc Plate, 5/16-18x2-1/4"
4	16	Locknut, Nylon Insert, Full, Zinc Plate, 5/16-18
5	4	Caster, Swivel, 6" diameter, 650 lb. capacity
6	4	Capscrew, Grade 5, Zinc Plate, 1/2-13x5"
7	4	Locknut, Nylon Insert, Full, Zinc Plate, 1/2-13
8	20	Capscrew, Grade 5, Zinc Plate, 3/8-16x2-3/4"
9	20	Locknut, Nylon Insert, Full, Zinc Plate, 3/8-16
10	14	Shelf, Inter. Beam, Cart, Weldment
11	6	Shelf, Inter./Column, Cart, Weldment
12	8	Plug, 2.00 inch Square x 14-18 Gauge, Black