

**ADA Grille Door
Accessory**

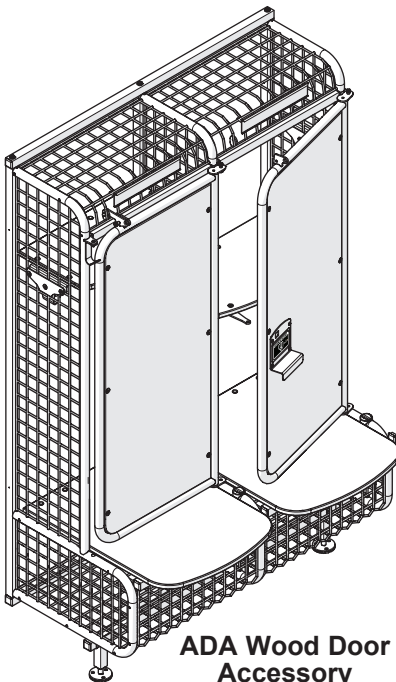

**ADA Wood Door
Accessory**

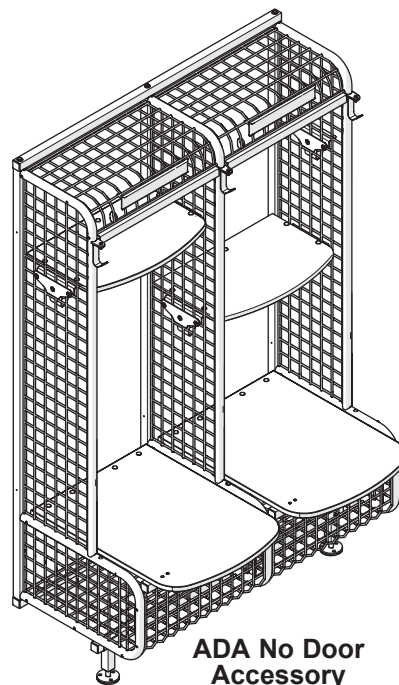

**ADA No Door
Accessory**

Contents

Important User Information	2
Safety Precautions	3
Required Tools	3
Supplied Hardware	3
Grille Door Accessory Components	4
Wood Door Accessory Components	5
No Door Accessory Components	6
ADA Shelf Accessory Components	7
Upper Shelf Adjustment	8
Grille Door Bracket Installation	11
Wood Door Bracket Installation	12
Final Installation for Lockers with Doors	14
ADA Shelf Installation	15

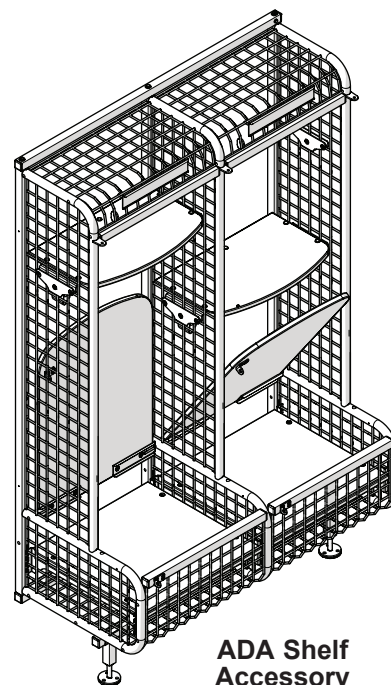

**ADA Shelf
Accessory**



Visit the GearBoss AirPro Locker web page at wengercorp.com for more information.

Note: Please read and understand these instructions before installation, assembly or use.

Note: If you need additional information, contact Wenger Corporation using the information below.

Important User Information

General

Copyright © 2023 by Wenger Corporation

All rights reserved. No part of the contents of this manual may be reproduced, copied, or transmitted in any form or by any means including graphic, electronic, or mechanical methods or photocopying, recording, or information storage and retrieval systems without the written permission of the publisher, unless it is for the purchaser's personal use.

Printed and bound in the United States of America.

The information in this manual is subject to change without notice and does not represent a commitment on the part of Wenger Corporation. Wenger Corporation does not assume any responsibility for any errors that may appear in this manual.

In no event will Wenger Corporation be liable for technical or editorial omissions made herein, nor for direct, indirect, special, incidental, or consequential damages resulting from the use or defect of this manual.

The information in this document is not intended to cover all possible conditions and situations that might occur. The end user must exercise caution and common sense when assembling or installing Wenger Corporation products. If any questions or problems arise, call Wenger Corporation at 1-800-887-7145.

Manufacturer

These ADA Compliant Accessories for GearBoss® AirPro® Lockers are manufactured by:

Wenger Corporation
555 Park Drive
Owatonna, MN 55060
(800) 4WENGER (493-6437) • +1 (507) 455-4100
wengercorp.com

Installation

- These accessories are designed for use with GearBoss® AirPro® Lockers only.

Intended Use

- This product is intended for indoor use in normal ambient temperature and humidity conditions — it must not be exposed to outside weather conditions.
- This product is intended to be permanently installed only as described in these instructions.

Warranty

This product is guaranteed free of defects in materials and workmanship for ten full years from date of shipment. A full warranty statement is available upon request.

Safety Precautions

Throughout this document you may find cautions and warnings which are defined as follows:

- **WARNING:** Failure to follow the instruction could result in serious injury or damage to property.
- **CAUTION:** Failure to follow the instruction could result in minor injury or damage to property.

Read all of these safety instructions before installation or use.

CAUTION

Make sure anyone installing these accessories has read and understands these instructions.

CAUTION

Failure to comply with Warnings and Cautions in this document can result in damage to property or serious injury.

Required Tools

Depending upon which accessory is being installed, a combination of the following tools may be needed:

- Cordless drill
- 3/8" drill bit (for wood shelf)
- 1-1/4" drill bit (for wood door only)
- Phillips drive bit or screwdriver
- 5/32", 3/16" and 1/4" hex wrench or bits
- 1/2" socket or combination wrench

Supplied Hardware

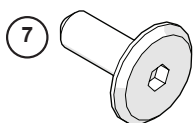

1/4-20 x .708
Machine Screw

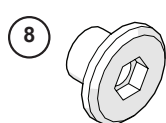

1/4-20 x 3/8"
Hex Cap Nut

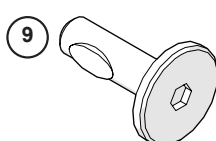

1/4-20 x .875
Machine Screw

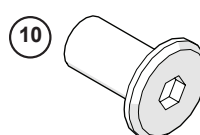

1/4-20 x 3/4"
Hex Cap Nut

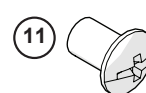

10-24
Phillips Head Cap Nut
(used on grille doors only)



10-24 x 3/8"
Truss Head
Machine Screw
(used on grille doors only)

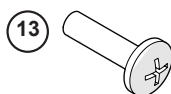

10-24 x 5/8"
Pan Head
Machine Screw
(used on wood doors only)

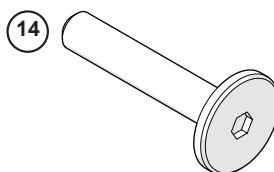

1/4-20 x 1.38"
Hex Head
Machine Screw
(used on ADA shelf only)

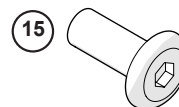

1/4-20 x 5/8"
Hex Cap Nut
(used on wood doors only)

Hardware not shown to scale.

Reference the item description on the packaging as item numbers may vary.

Grille Door Accessory Components

Item	Qty	Description
1	2	Hook Plate Cover
2	2	Shim
3	1	Lock Tab
4	1	Inner Door Plate
5	1	Outer Door Bracket
6	1	GearBoss Decal
7	6	1/4-20 x 0.708 Machine Screw
8	6	1/4-20 x 3/8" Hex Cap Nut
9	2	1/4-20 x 0.875 Machine Screw
10	2	1/4-20 x 3/4" Hex Cap Nut
11	4	10-24 Phillips Head Cap Nut (used on grille doors only)
12	4	#10-24 x 3/8" Truss Head Machine Screw (used on grille doors only)

For the Grille Door Accessory Installation procedure, go to page 11.

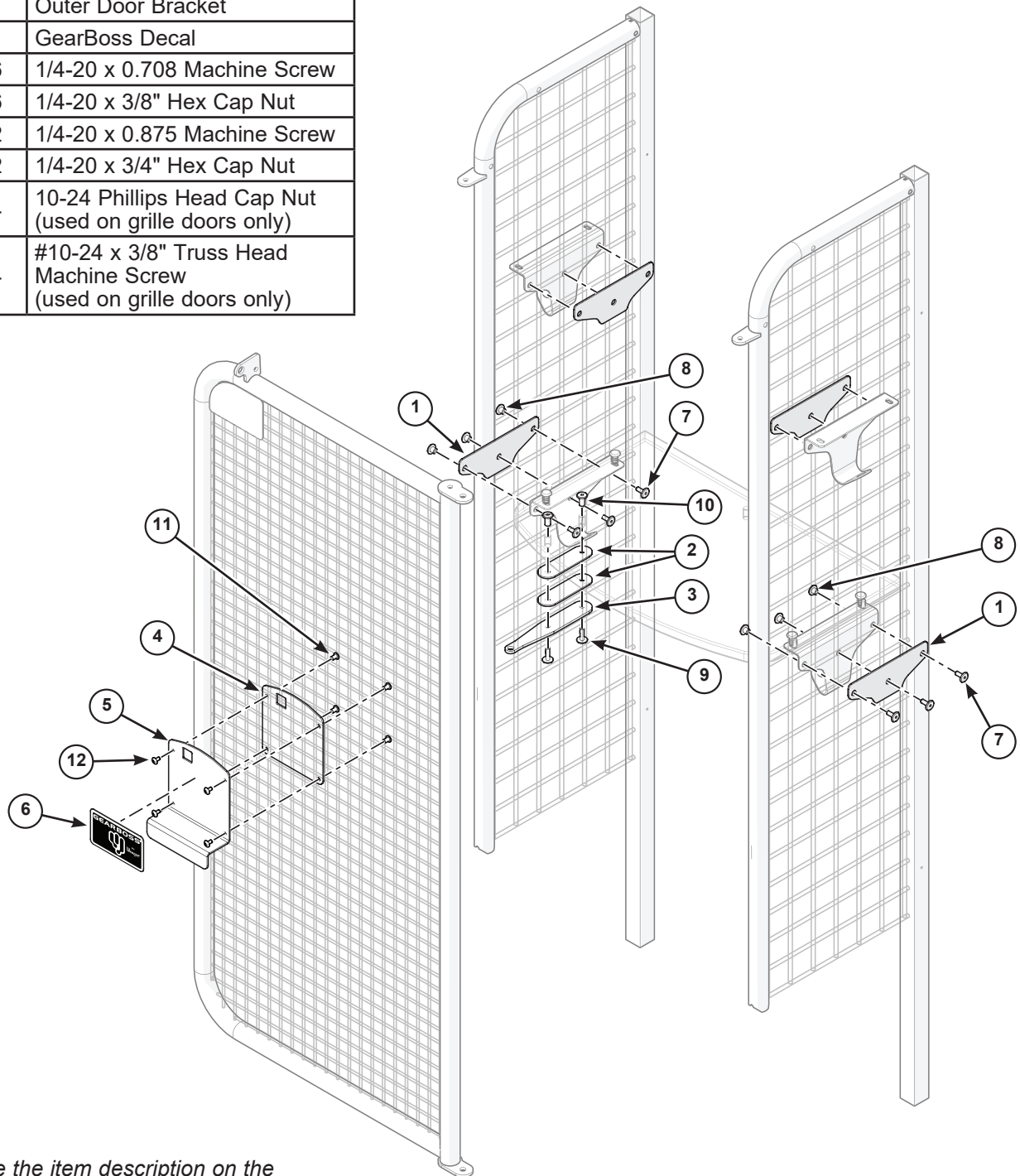

Reference the item description on the packaging as item numbers may vary.

Wood Door Accessory Components

Item	Qty	Description
1	2	Hook Plate Cover
2	2	Shim
3	1	Lock Tab
4	1	Inner Door Plate
5	1	Outer Door Bracket
6	1	GearBoss Decal
7	6	1/4-20 x 0.708 Machine Screw
8	6	1/4-20 x 3/8" Hex Cap Nut
9	2	1/4-20 x 0.875 Machine Screw
10	2	1/4-20 x 3/4" Hex Cap Nut
13	4	#10-24 x 5/8" Pan Head Machine Screw (used on wood doors only)
15	4	1/4-20 x 5/8" Hex Cap Nut (used on wood doors only)

For the Wood Door Accessory Installation procedure, go to page 12.

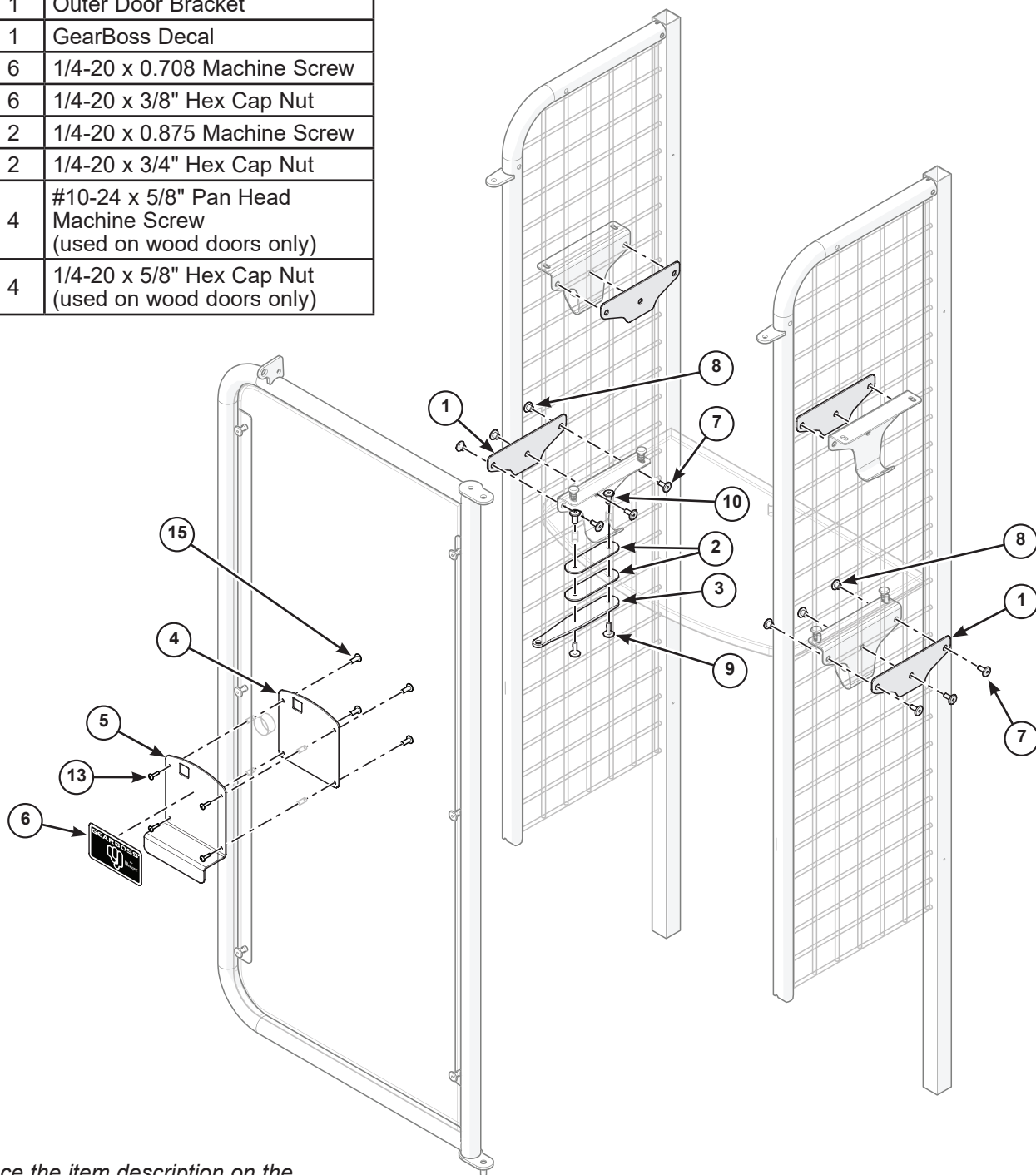

Reference the item description on the packaging as item numbers may vary.

No Door Accessory Components

Item	Qty	Description
1	2	Hook Plate Cover
7	6	1/4-20 x 0.708 Machine Screw
8	6	1/4-20 x 3/8" Hex Cap Nut

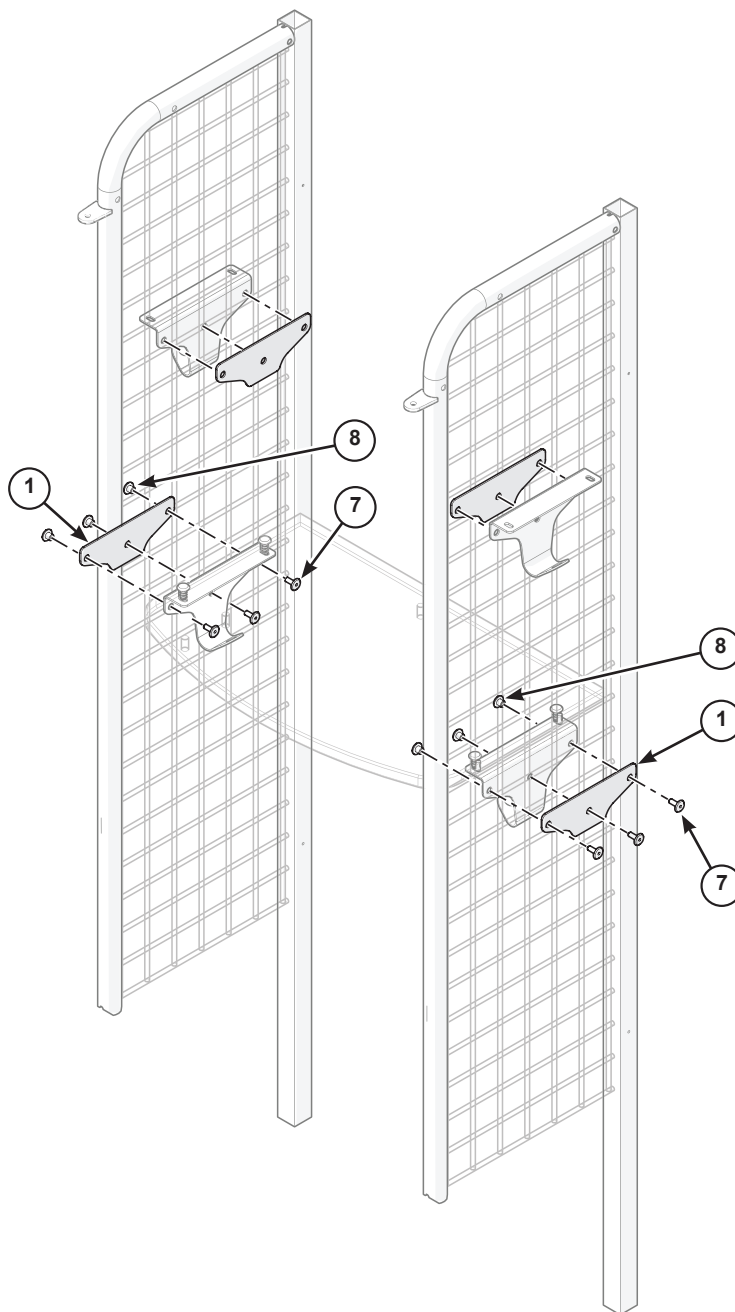

Reference the item description on the packaging as item numbers may vary.

ADA Shelf Accessory Components

Item	Qty	Description
14	4	1/4-20 x 1.38" Hex Head Machine Screw
15	1	ADA Shelf
16	2	ADA Shelf Bracket Assembly

For the ADA Shelf Accessory Installation procedure, go to page 15.

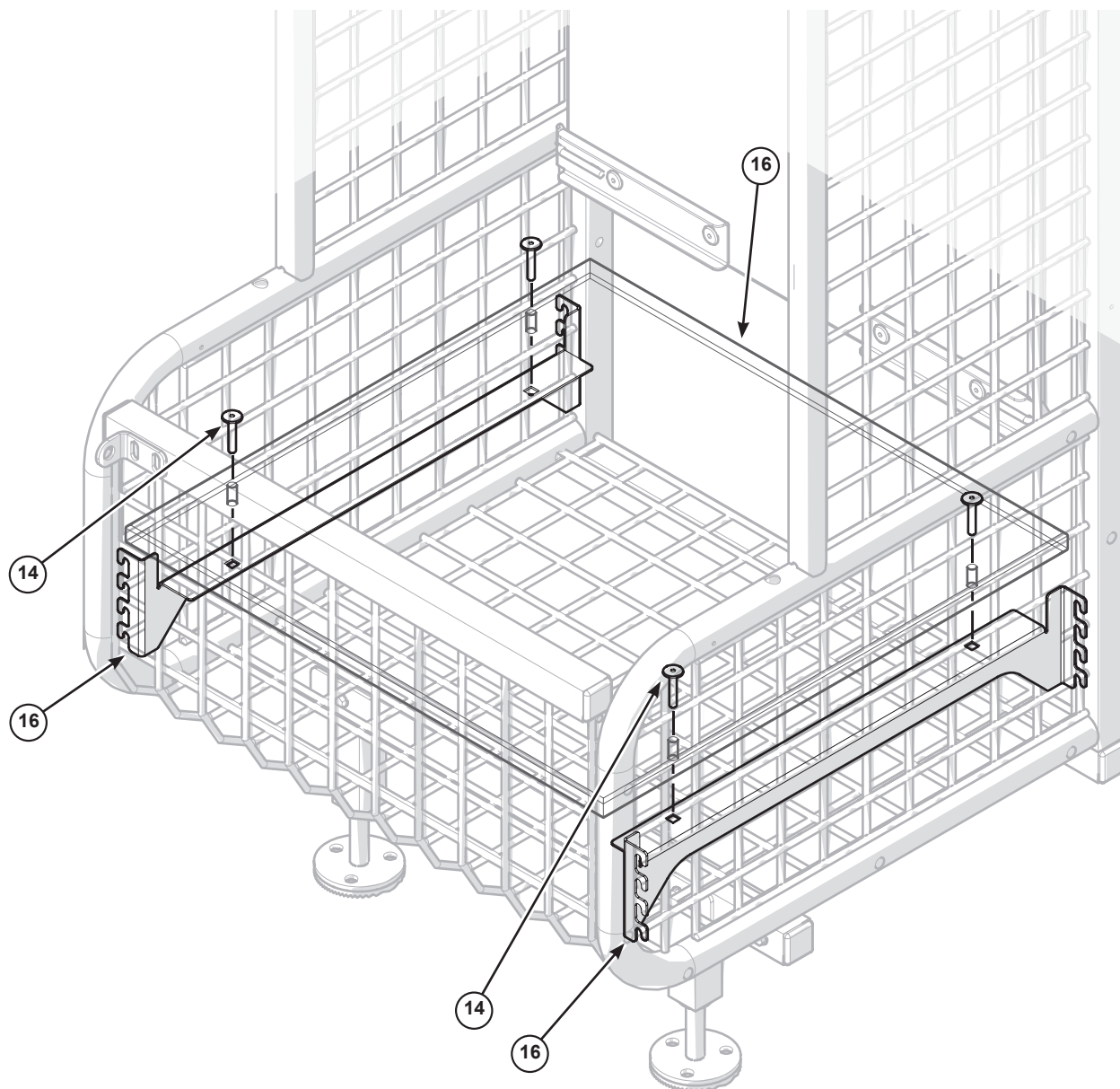

Reference the item description on the packaging as item numbers may vary.

Upper Shelf Adjustment

1. Remove the top shelf.
 - a. Remove the fasteners that attach the top shelf to the adjacent brackets or cover plates.
Save these fasteners!
 - b. Carefully remove the top shelf.

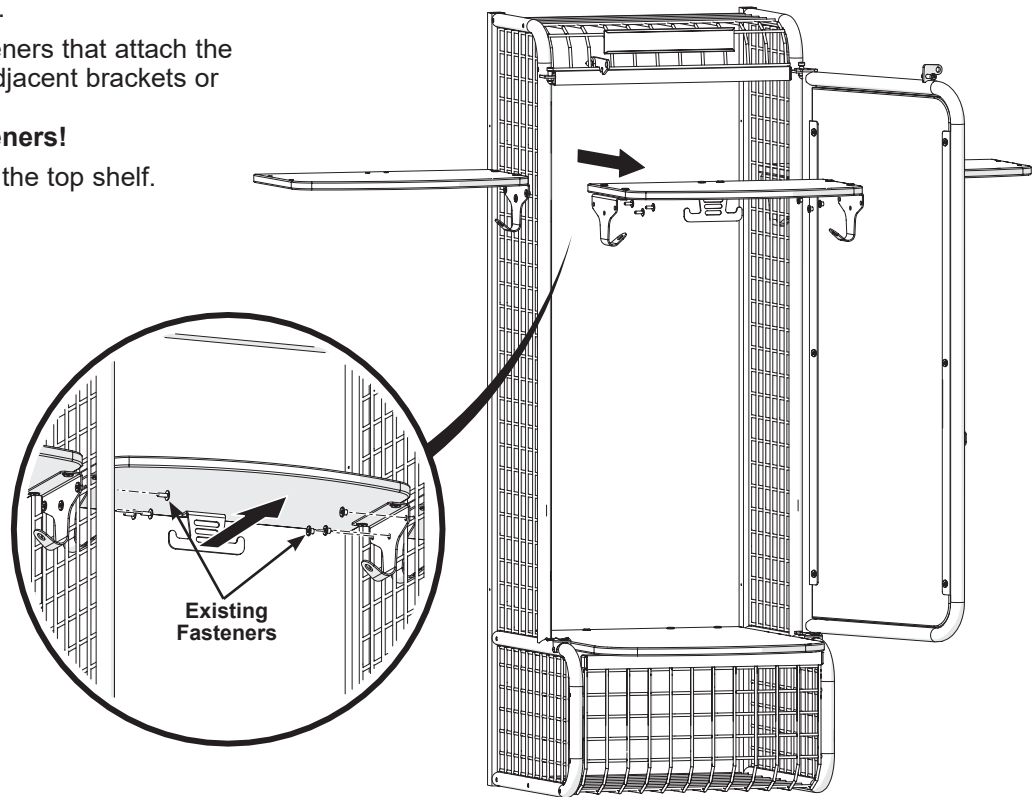

2. Secure hook plate covers (1) to the adjacent brackets or cover plates using the fasteners that were removed in the previous step.

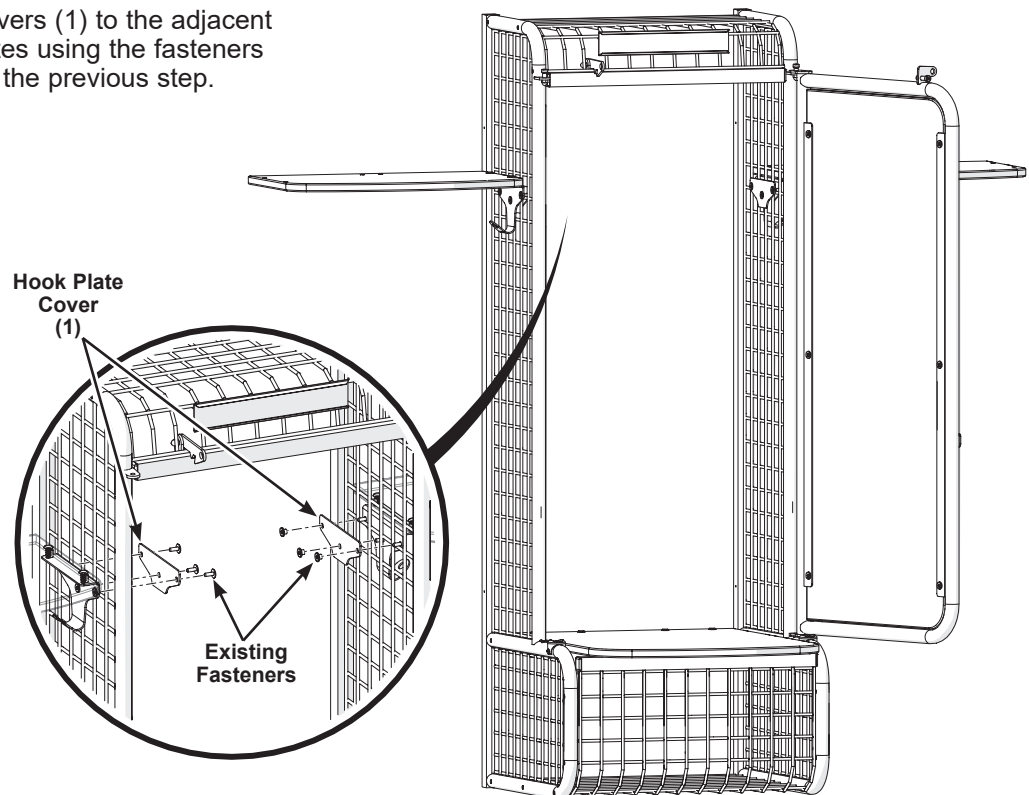

Upper Shelf Adjustment (continued)



**Steps 3 and 4 apply to grille door and wood door lockers only.
For no door lockers, skip ahead to step 5.**

3. Drill two 0.375" (9.5 mm) diameter holes through the top shelf to mount the lock tab as shown in the diagram.

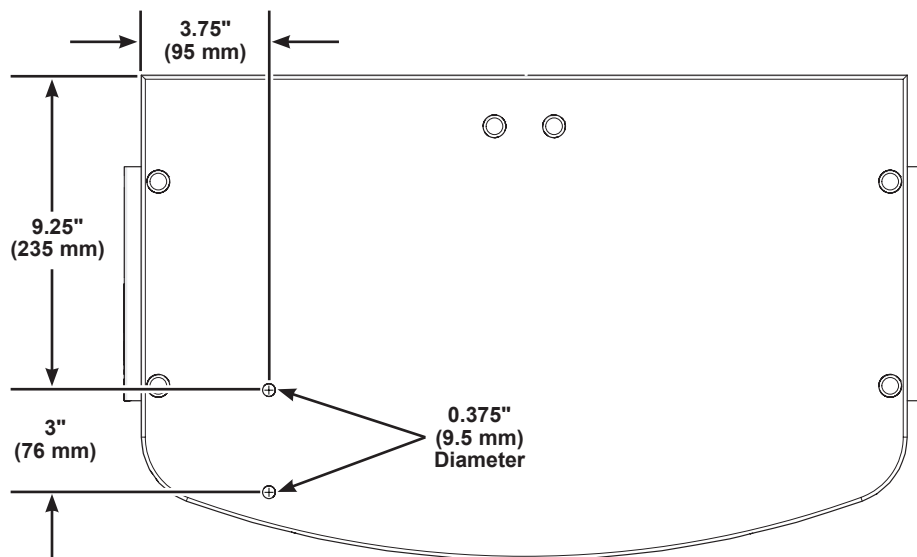

4. Attach the lock tab (3) and optional shims (2)* to the top shelf using two 1/4-20 x 0.875" machine screws (9) and 1/4-20 x 3/4" hex cap nuts (10) as shown.

**Shims can be added or subtracted to adjust the lock tab height.*

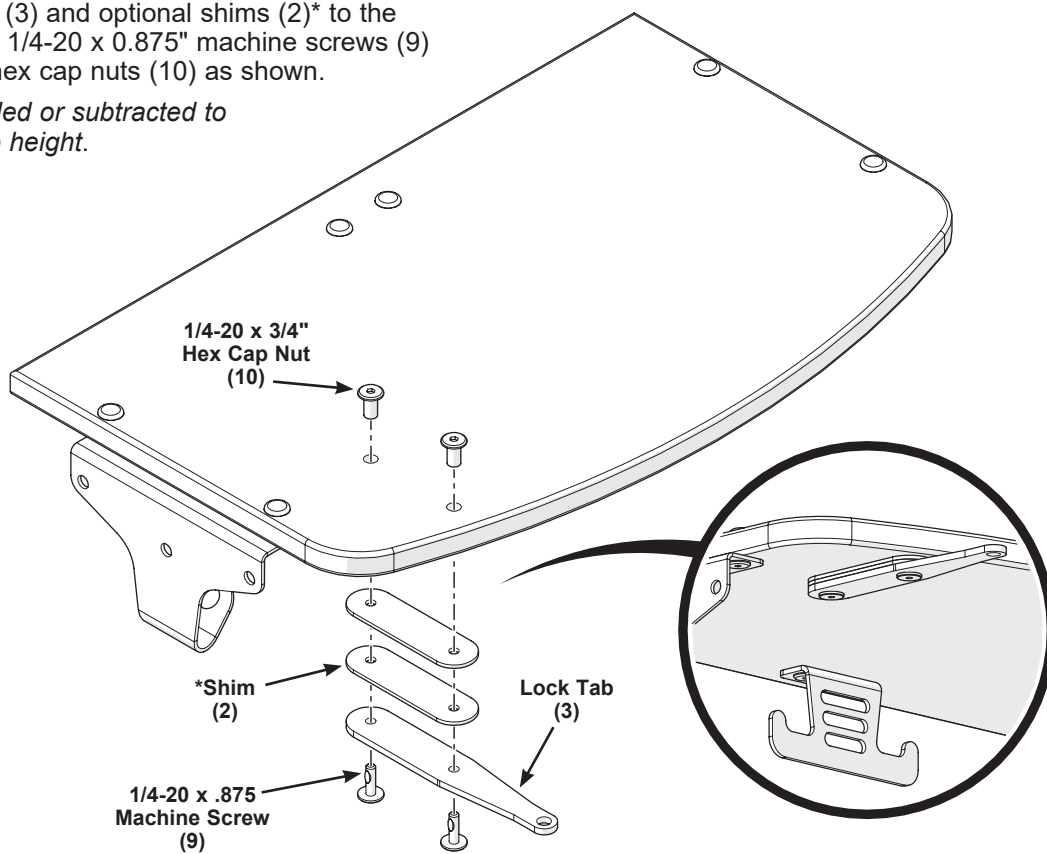

Upper Shelf Adjustment (continued)

5. Reattach the top shelf into the locker.
 - a. Locate the top of the shelf panel to be the ADA recommended height of 25" (635 mm) above the top of the seat panel.
 - b. Attach the shelf to the sides of the locker using one hook plate cover (1) and three 1/4-20 x 0.708" machine screws (7) and 1/4-20 x 3/8" hex cap nuts (8) on each side.

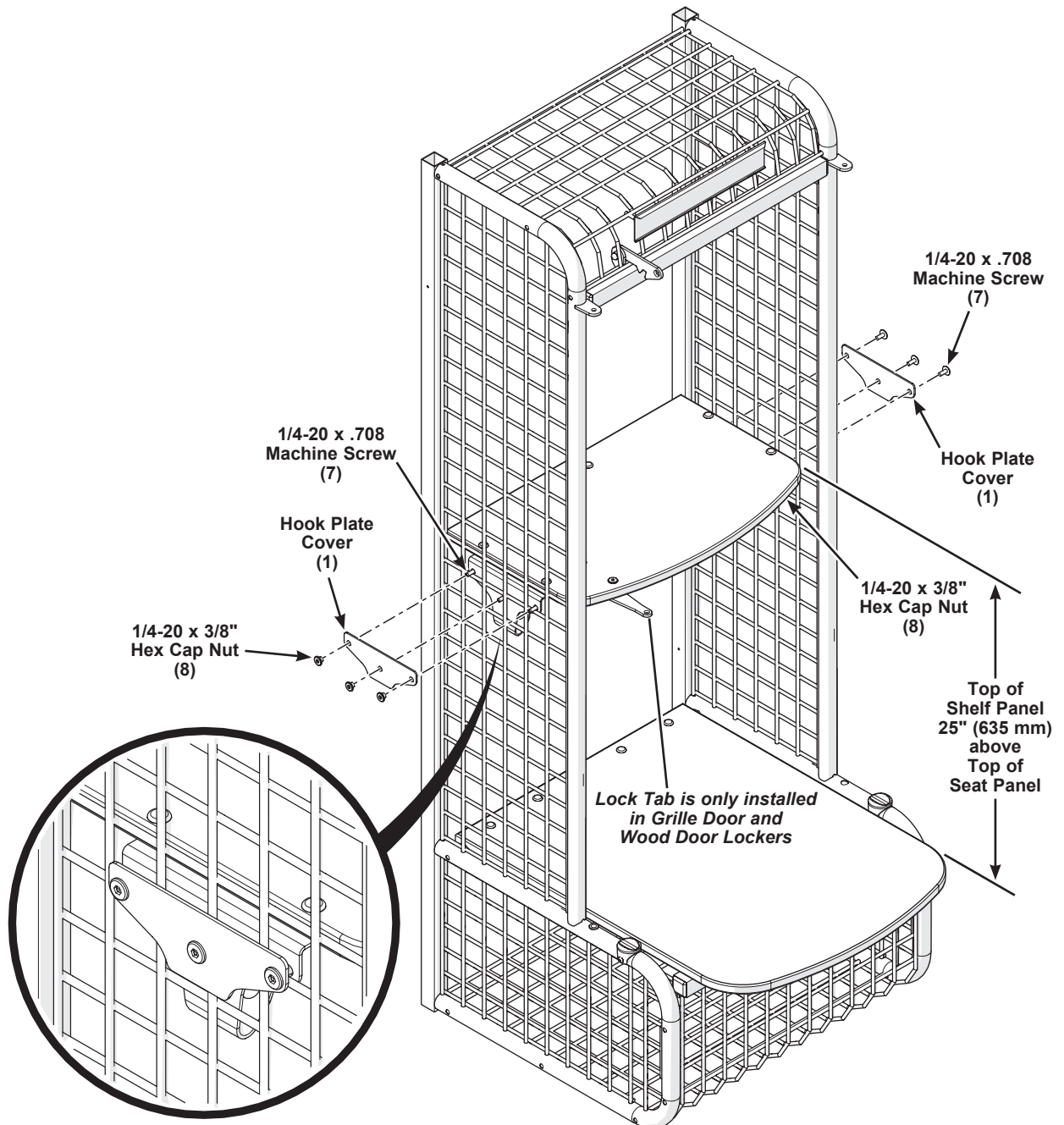

For no door lockers, installation is complete.

For grille door and wood door lockers, proceed to the next page.

For lower ADA shelf installation, go to page 15.

Grille Door Bracket Installation



***This procedure is for grille door bracket installation only.
For wood door bracket installation, go to the next page.
For lower ADA shelf installation, go to page 15.***

1. Attach the inner door plate (4) and outer door bracket (5) to the grille door using four 10-24 phillips head cap nuts (11) and #10-24 x 3/8" truss head machine screws (12).

Center the openings in the door plate and bracket to fit over the lock tab.

2. Attach the GearBoss decal (6) to the outer door bracket.
3. The attached shims (2) can be added or subtracted to adjust the lock tab height to the door opening.
4. Skip ahead to the "Final Installation for Lockers with Doors" procedure on page 14.

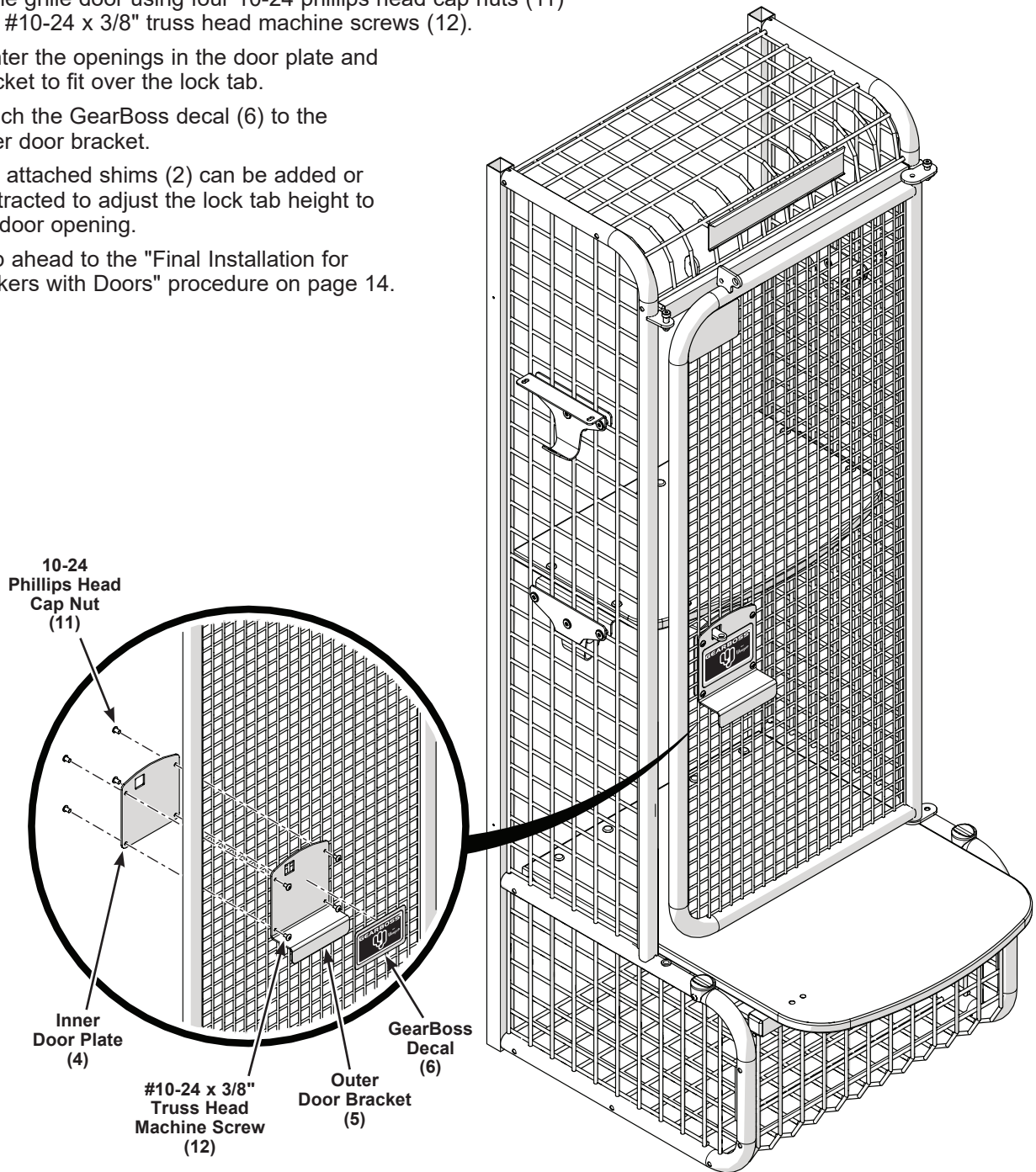

Wood Door Bracket Installation



***This procedure is for wood door bracket installation only.
For grille door bracket installation, go to the previous page.
For lower ADA shelf installation, go to page 15.***

1. Drill one 1-1/4" (32 mm) diameter hole through the wood door panel to mount the lock tab as shown in the diagram.

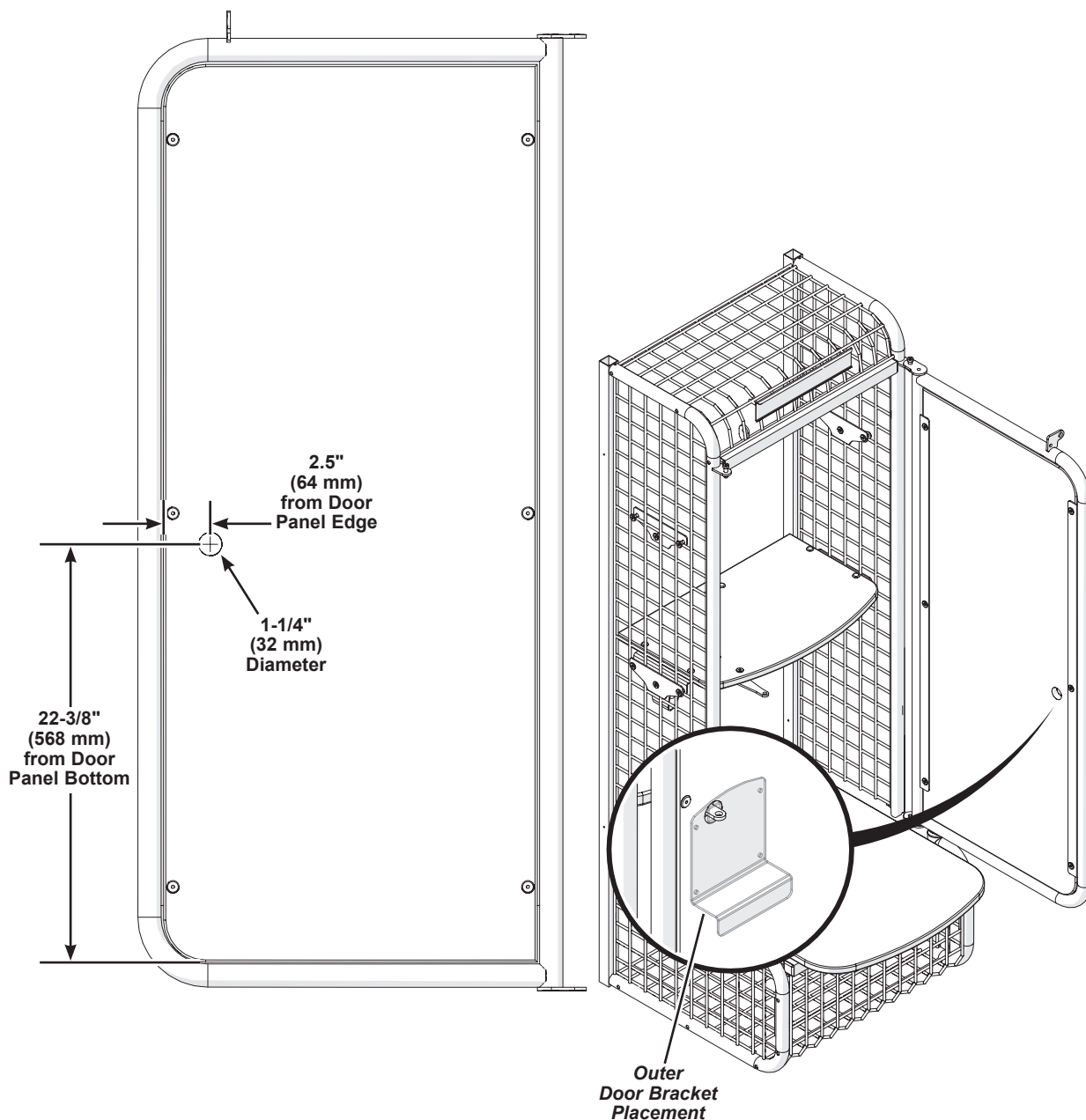

Wood Door Bracket Installation (continued)

- Using the outer door bracket (5) as a template, center the larger opening in the plate over the drilled hole.
- Mark the four smaller hole locations and drill 5/16" holes through the door.

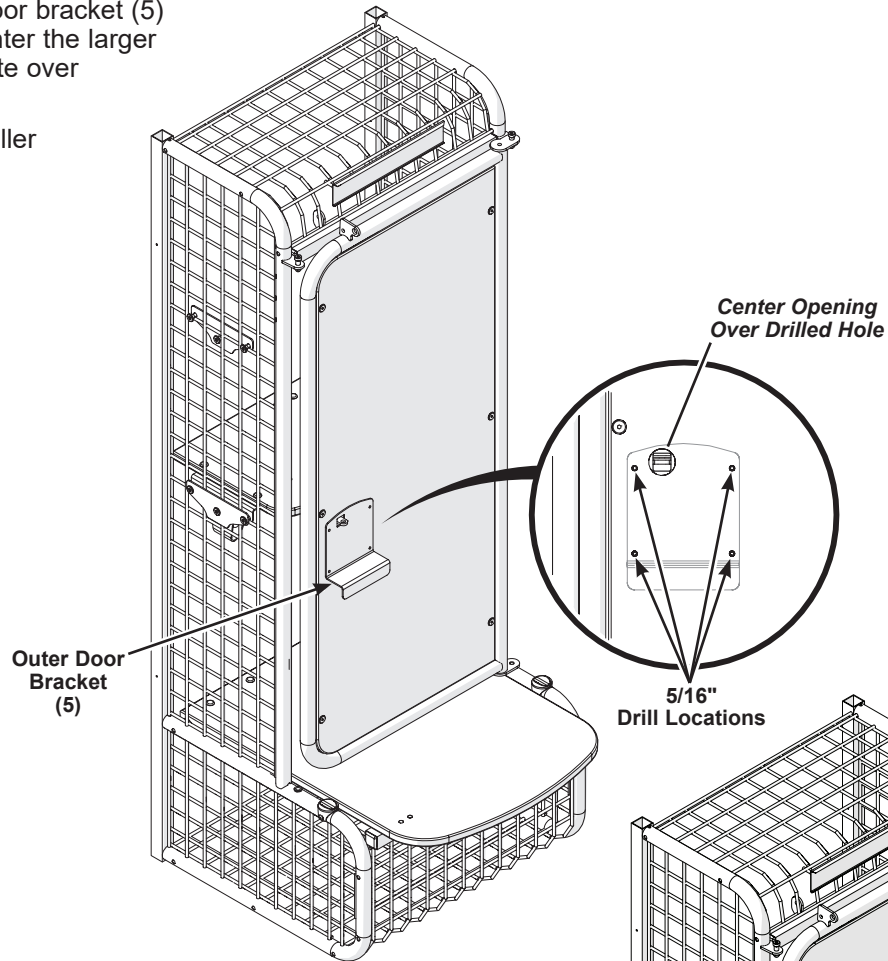

- Attach the inner door plate (4) and outer door bracket (5) to the 5/16" holes using four 1/4-20 x 5/8" hex cap nuts (15) and #10-24 x 5/8" pan head machine screws (13).

Fit the openings in the door plate and bracket over the center hole.

- Attach the GearBoss decal (6) to the outer door bracket.
- The shims (2) can be added or subtracted to adjust the lock tab height to the door opening.
- Skip ahead to the "Final Installation for Lockers with Doors" procedure on page 14.

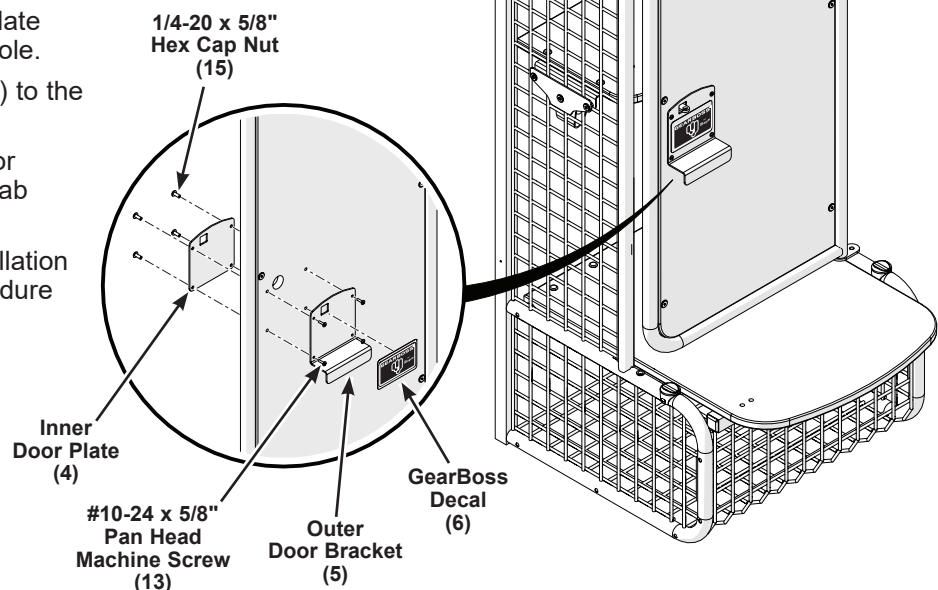

Final Installation for Lockers with Doors

1. For better accessibility to an ADA locker, remove the pivot plate, shoulder bolts and cap nuts from the top latch assembly.

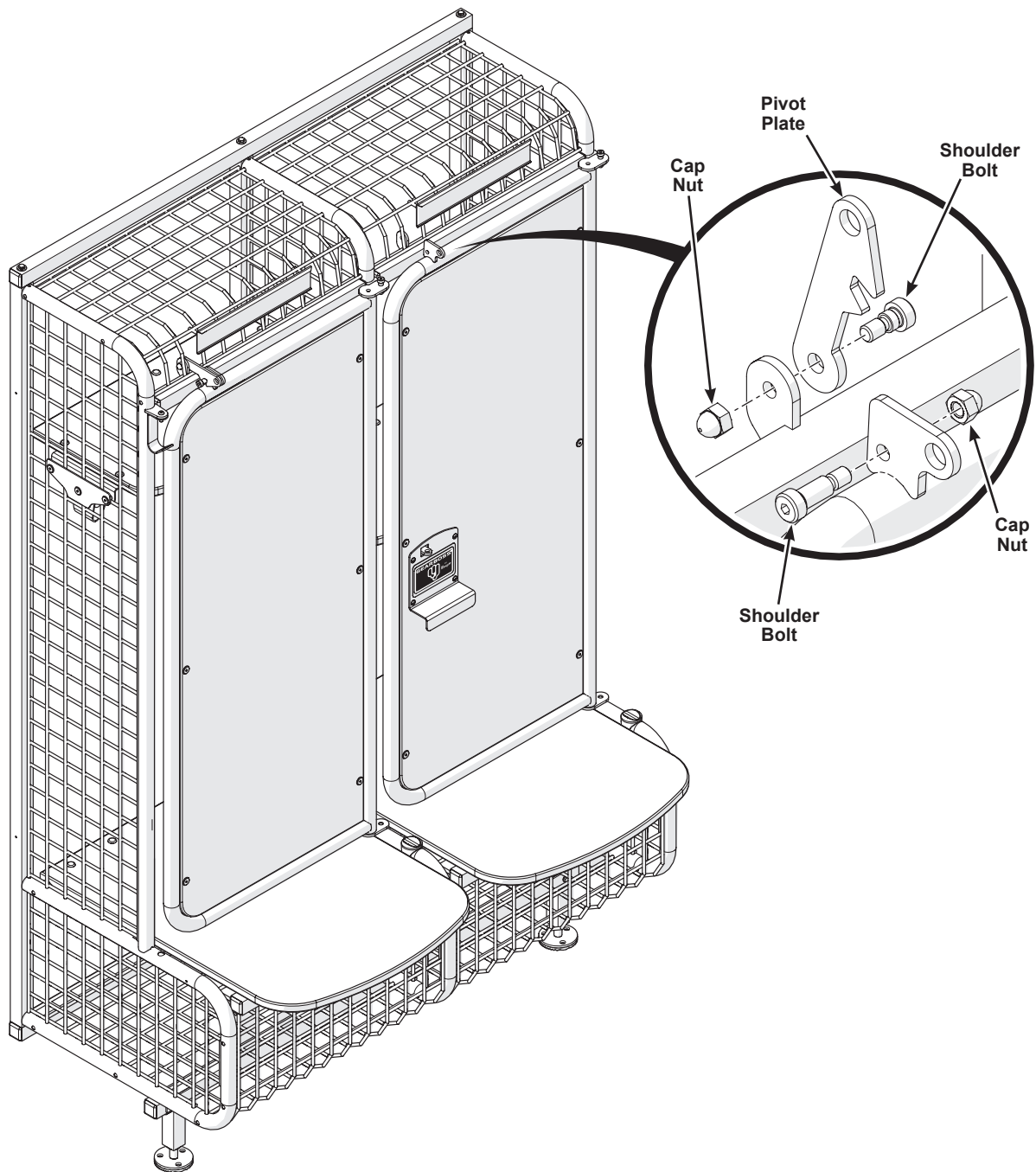

ADA Shelf Installation

1. Attach brackets to the lower locker compartment.
 - a. ADA recommendations state no reaching lower than 15" (381 mm) up from the floor. The ADA shelf is 3/4" (19 mm) thick, so locate the shelf lip of the ADA Shelf Bracket Assemblies (16) to be a minimum of 14-1/4" (362 mm) up from the floor
 - b. On both the left and right side, fit a bracket onto the wire grille as shown in Detail A. Both brackets must be at the same height.

Slightly stagger brackets in adjacent lockers as shown in Detail B.

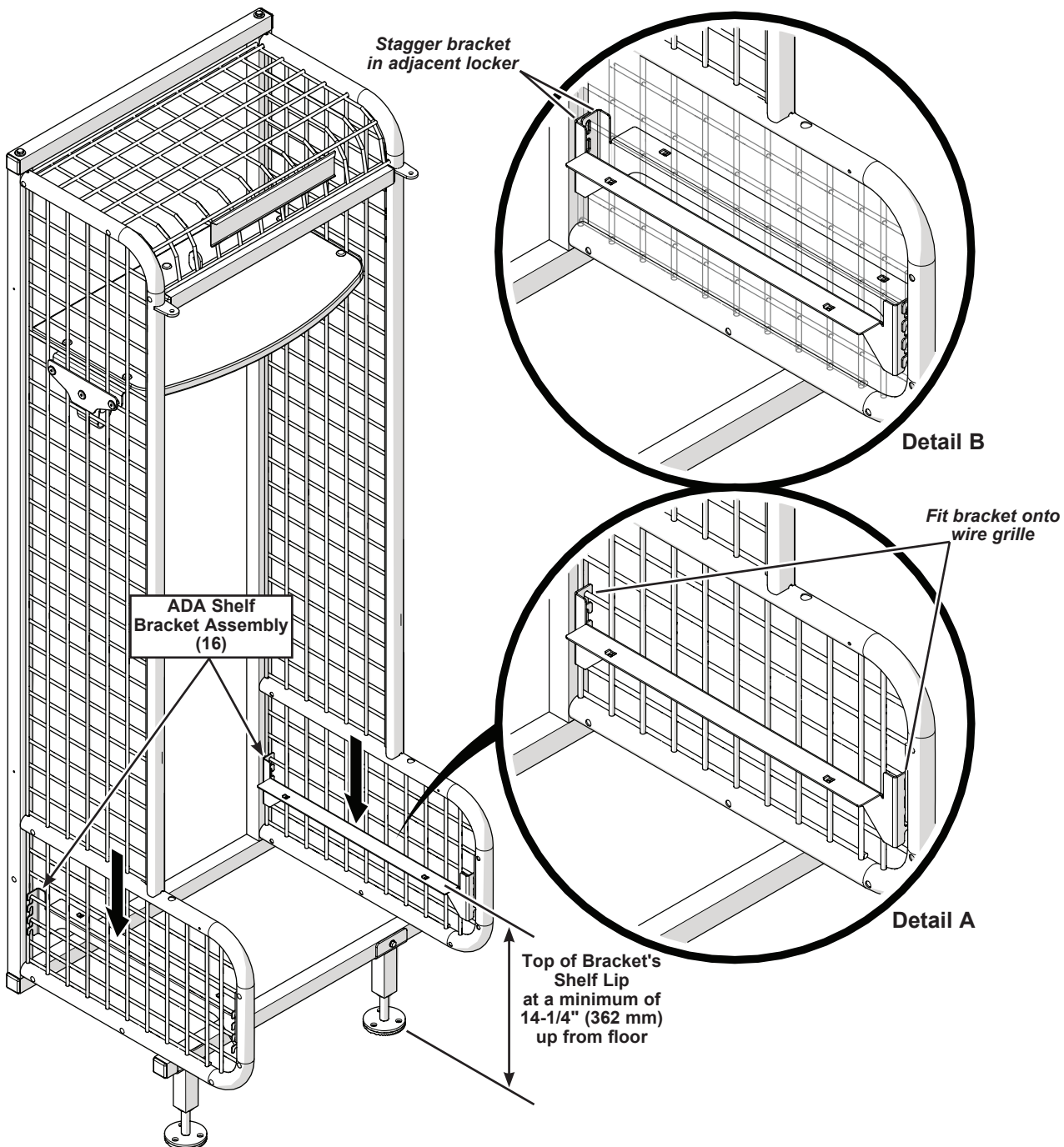

Some locker components are hidden for clarity.

ADA Shelf Installation (continued)

2. Attach the ADA Shelf.
 - a. Fit the ADA Shelf (15) onto the brackets.
 - b. Secure the shelf to the cage nuts of the bracket assemblies using four 1/4-20 x 1.38" hex head machine screws (14).

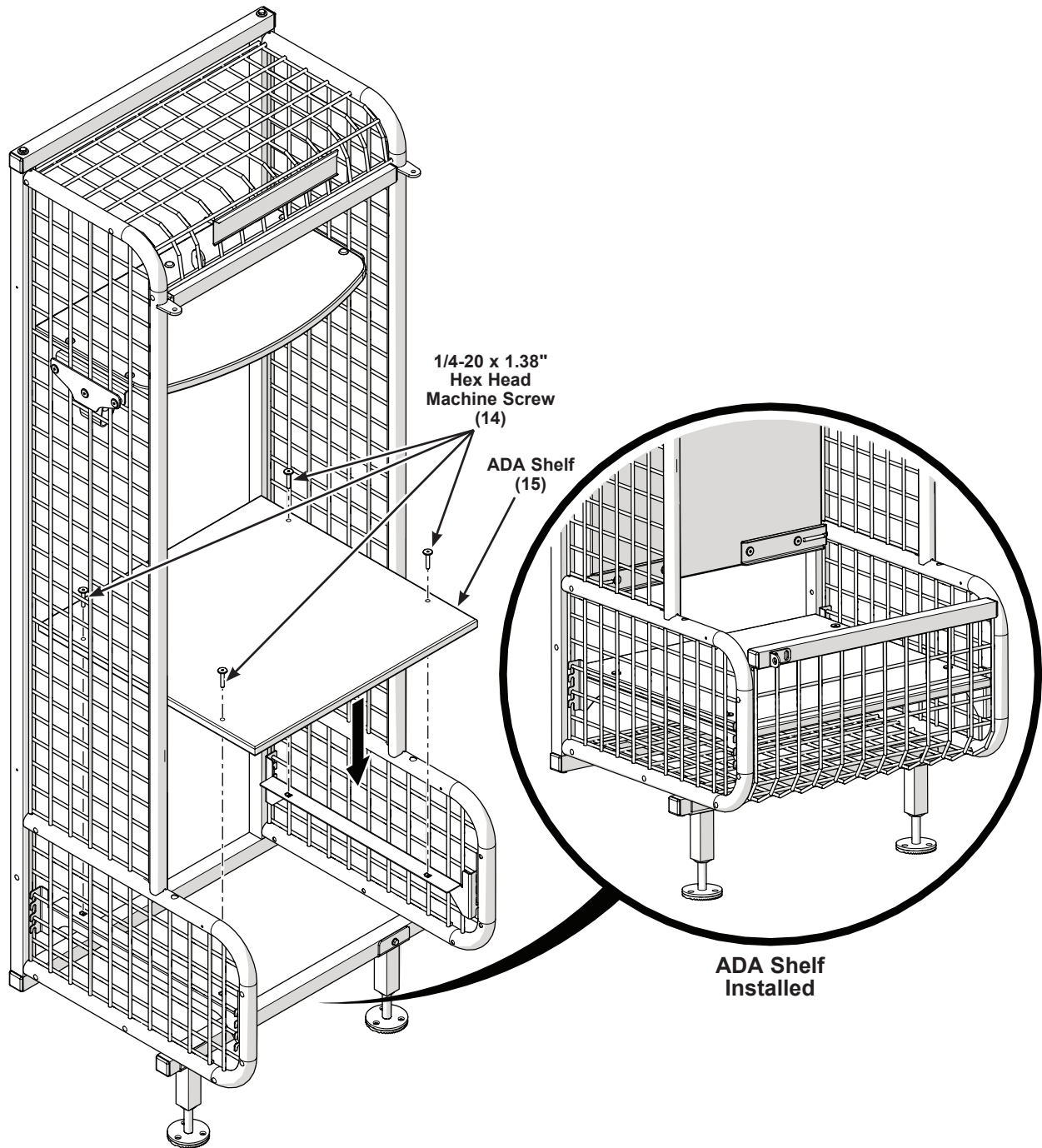

Some locker components are hidden for clarity.
