

Basic Instructions only!
 For more detailed product information, refer to the
 AirPro Locker Installation and Owner's Instructions 241A564.

⚠ CAUTION

Make sure anyone assembling, installing or using this product has read and understands these instructions.

⚠ CAUTION

Failure to comply with Warnings and Cautions in this document or on the equipment can result in damage to property or serious injury.

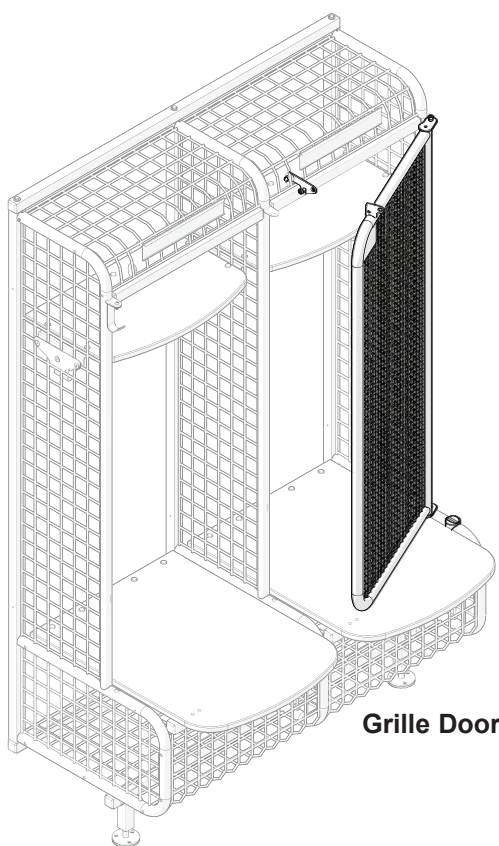

Grille Door

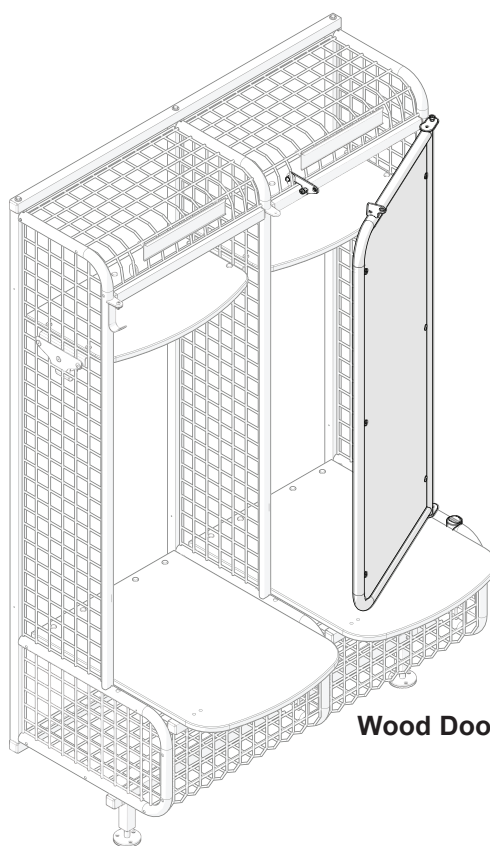

Wood Door

Contents

Required Tools	2	Grille Door Assembly	5
Supplied Hardware	2	Wood Door Assembly	8
Grille Door Accessory Components	3	Final Assembly	11
Wood Door Accessory Components	4		



Visit the GearBoss AirPro Locker web page at gearboss.com for more information.

Note: Please read and understand these instructions before assembling or setting up.
Note: If you need additional information, contact Wenger Corporation using the information below.

Required Tools

Depending upon which accessory is being installed, a combination of the following tools may be needed:

- 4 mm, 1/4" and 3/16" Hex wrench or drill with bits
- Mallet
- 1/2" Combination wrench

Supplied Hardware

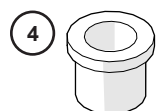

1/2" OD x 3/8" ID
Flange Bearing

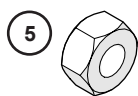

5/16-18
Lock Nut



5/16-18
Cap Hex Nut

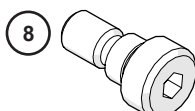

5/16-18 x 1/4"
Shoulder Bolt

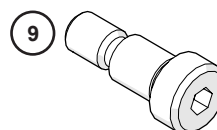

5/16-18 x 1/2"
Shoulder Bolt

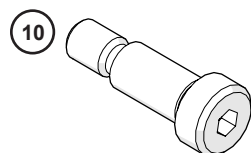

5/16-18 x 3/4"
Shoulder Bolt

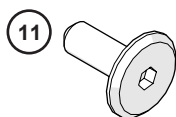

1/4-20 x .708
Machine Screw
(used on wood doors only)

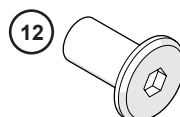

1/4-20 x .669
Hex Socket Cap Nut
(used on wood doors only)



#10 x 5/8"
Sheet Metal Screw

Hardware not shown to scale.

Reference the item description on the packaging as item numbers may vary.

Grille Door Accessory Components

Item	Qty	Description	Item	Qty	Description
1	1	Grille Door	8	1	5/16-18 x 1/4" Shoulder Bolt
4	1	1/2" OD x 3/8" ID Flange Bearing	9	1	5/16-18 x 1/2" Shoulder Bolt
5	1	5/16-18 Lock Nut	10	1	5/16-18 x 3/4" Shoulder Bolt
6	1	Door Lock Pivot Plate	13	2	#10 x 5/8" Sheet Metal Screw
7	2	5/16-18 Cap Hex Nut	14	1	Locker Door Stop

For the grille door accessory assembly procedure, go to page 5.

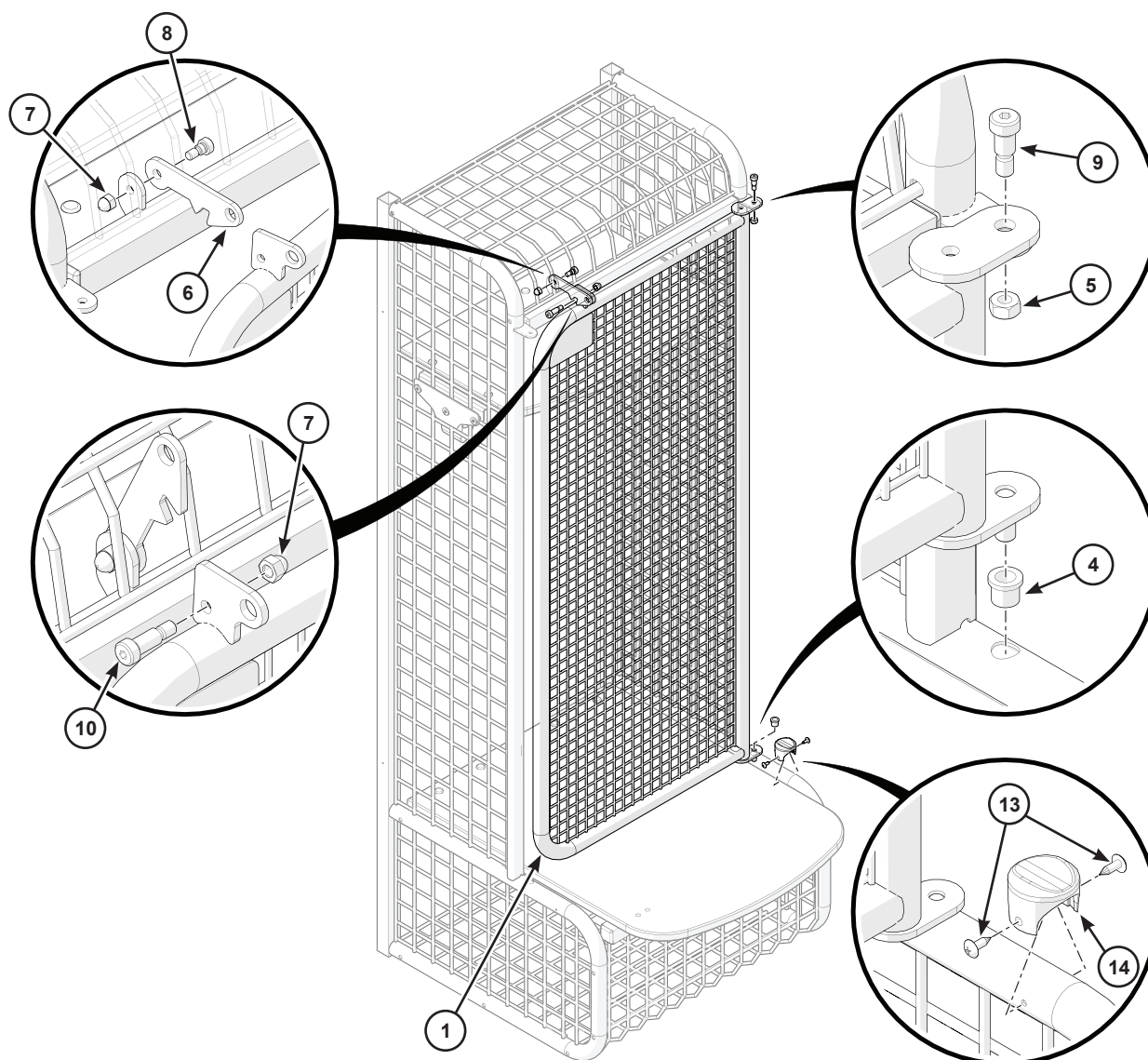

Reference the item description on the packaging as item numbers may vary.

Wood Door Accessory Components

Item	Qty	Description	Item	Qty	Description
2	1	Wood Door Frame	9	1	5/16-18 x 1/2" Shoulder Bolt
3	1	Wood Door Panel	10	1	5/16-18 x 3/4" Shoulder Bolt
4	1	1/2" OD x 3/8" ID Flange Bearing	11	6	1/4-20 x .708 Machine Screw (used on wood doors only)
5	1	5/16-18 Lock Nut	12	6	1/4-20 x .669 Hex Socket Cap Nut (used on wood doors only)
6	1	Door Lock Pivot Plate	13	2	#10 x 5/8" Sheet Metal Screw
7	2	5/16-18 Cap Hex Nut	14	1	Locker Door Stop
8	1	5/16-18 x 1/4" Shoulder Bolt			

For the wood door accessory assembly procedure, go to page 8.

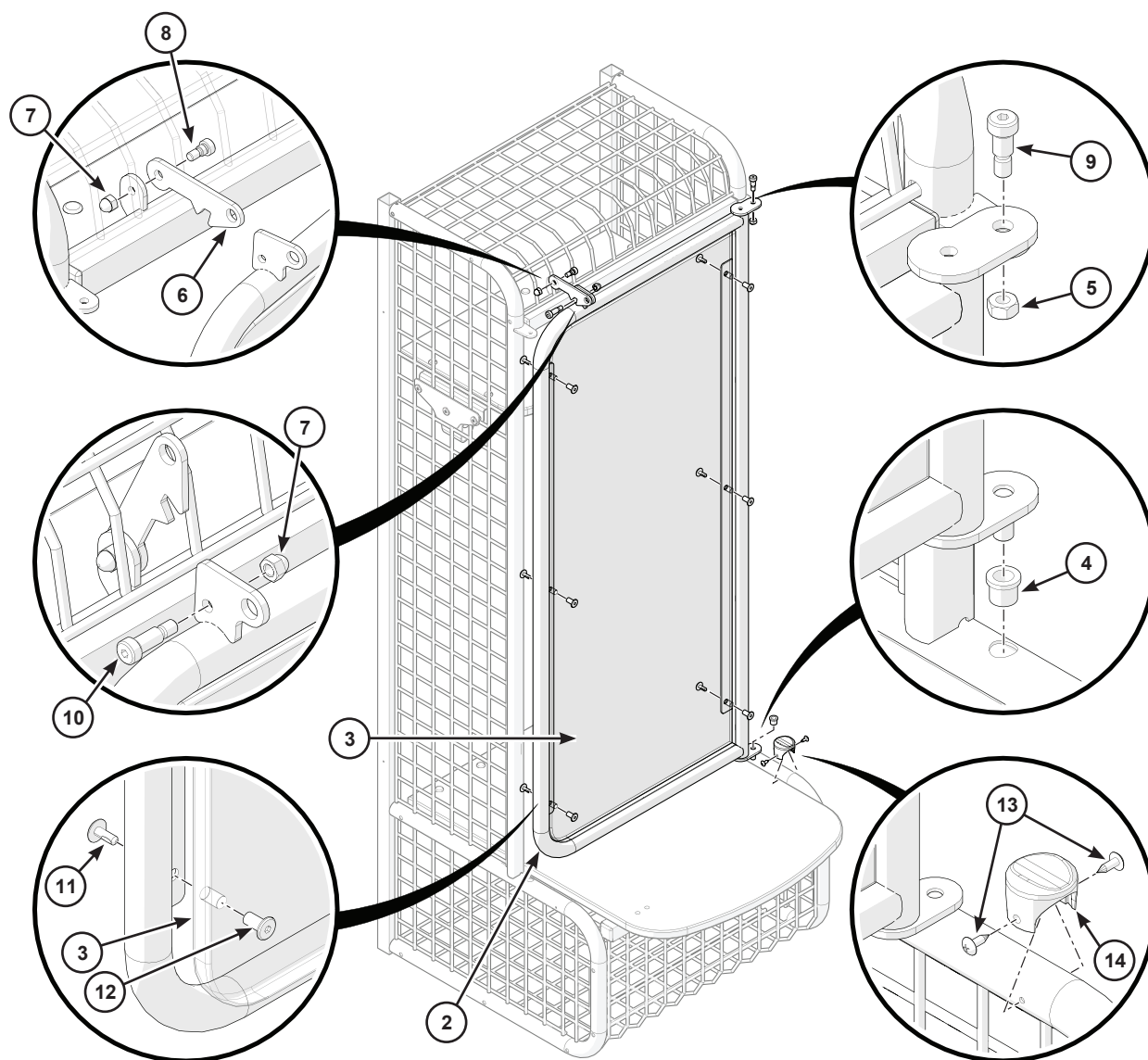

Reference the item description on the packaging as item numbers may vary.

Grille Door Assembly



*This procedure is for assembling the grille door.
For assembling the wood door, go to page 8.*

1. Insert a 1/2" OD x 3/8" ID flange bearing (4) into the pilot hole on the bottom-right of the locker frame.

The locker door will always be mounted on the right side of the locker.

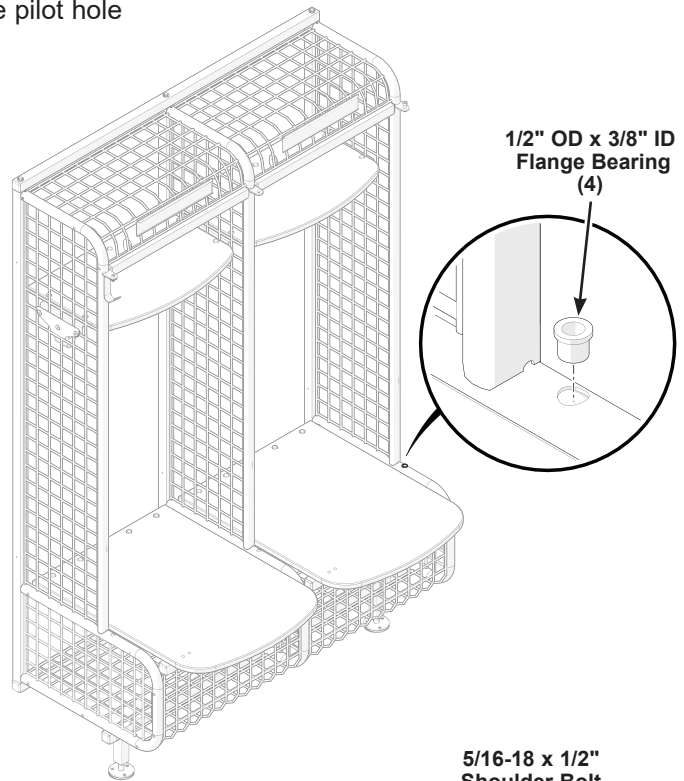

2. Attach the door to the locker.
 - a. Position the bottom-right of the grille door (1) onto the bottom-right of the locker frame, inserting the door frame pin into the previously installed flange bearing (4).
 - b. At the top of the door, align the right-side door frame weldment with the locker right-side frame weldment.
 - c. Insert a 5/16-18 x 1/2" shoulder bolt (9) through the top of the aligned weldment holes and secure using a 5/16-18 lock nut (5).

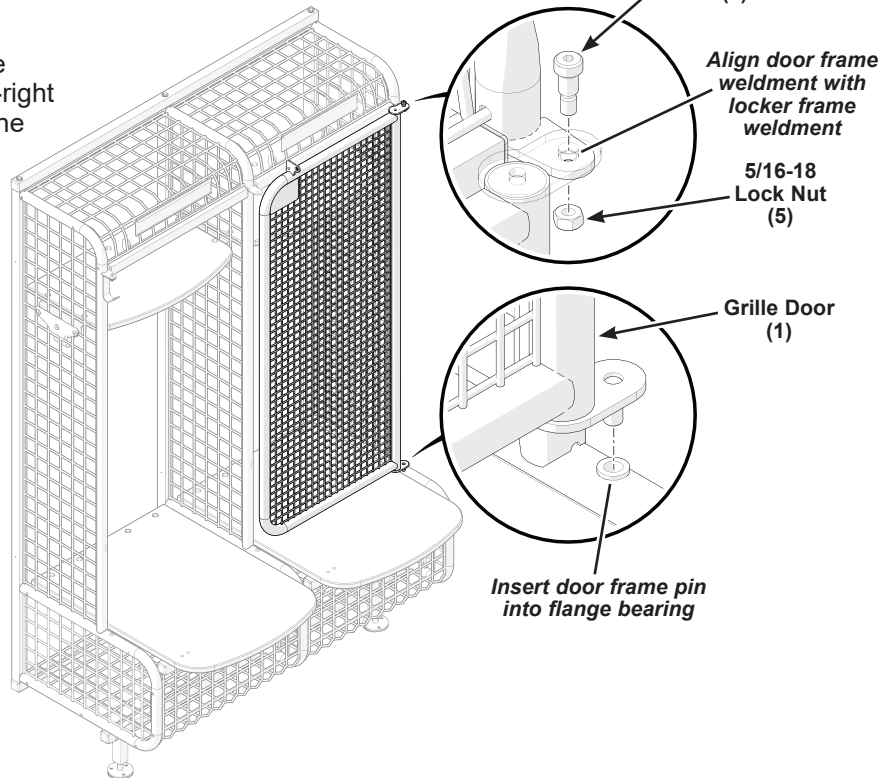

Grille Door Assembly (continued)

3. Attach the door lock to the locker frame.

- a. Align the hole in the narrower end of the door lock pivot plate (6) with the hole in the top grille weldment.

Be sure that the pivot plate is located on the right side of the weldment as shown.

- b. Attach the pivot plate to the weldment using a 5/16-18 x 1/4" shoulder bolt (8) and 5/16-18 cap hex nut (7).

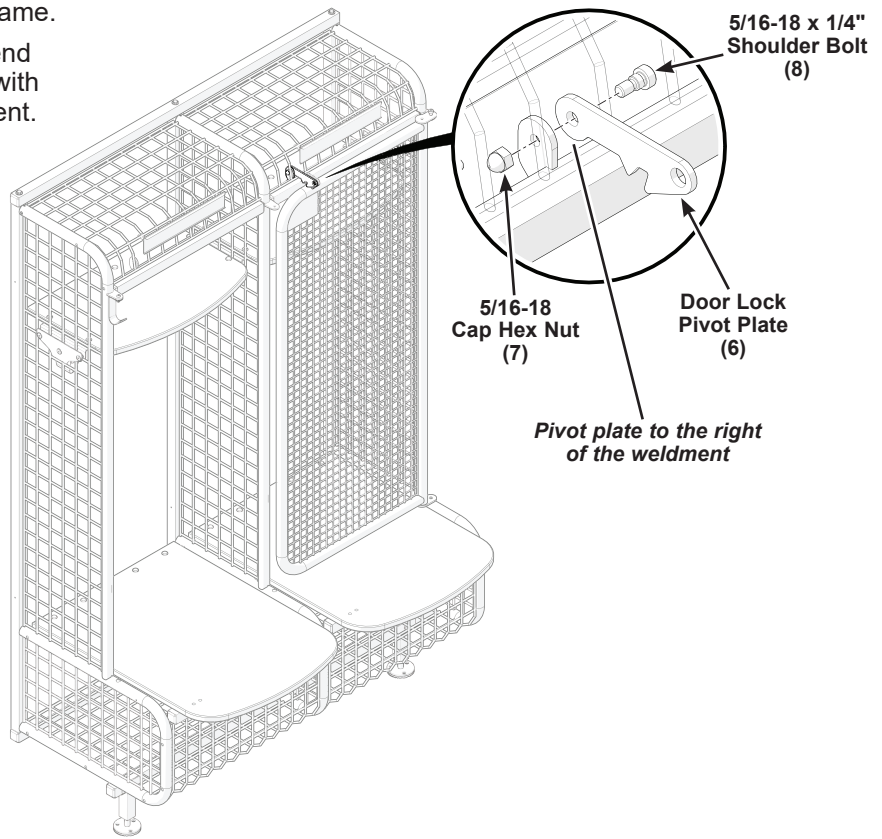

4. Attach the door lock bolt to the door frame.

- a. From the left-hand side, insert a 5/16-18 x 3/4" shoulder bolt (10) into the top door weldment as far as it will fit and secure the other side using a 5/16-18 cap hex nut (7).

Be sure that the shoulder bolt is inserted from the left side of the weldment as shown.

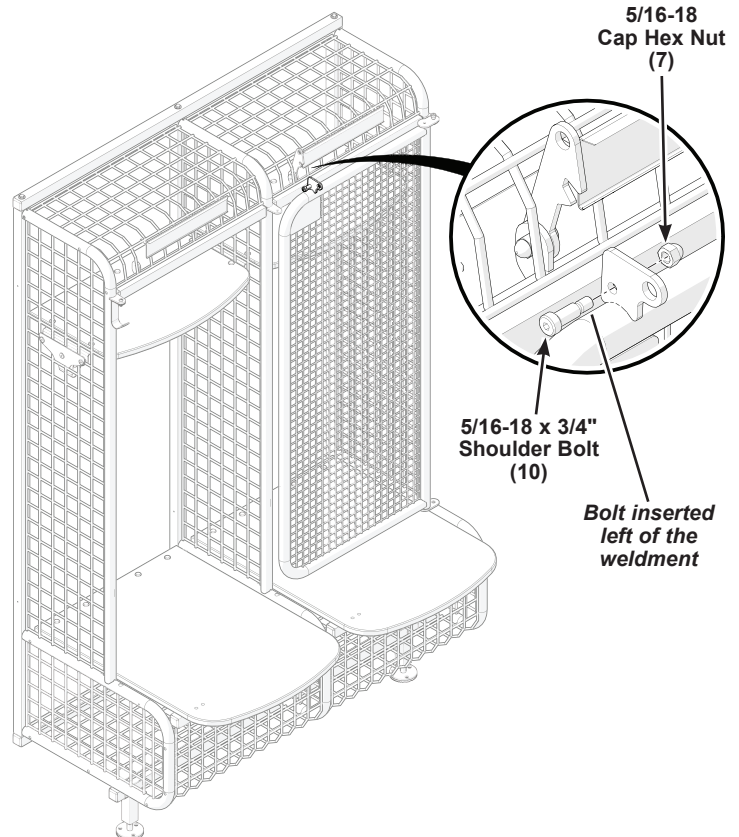

Grille Door Assembly (continued)

5. Lower the door lock pivot plate onto the shoulder bolt to secure the door closed and lift the pivot plate off the bolt to open the door.

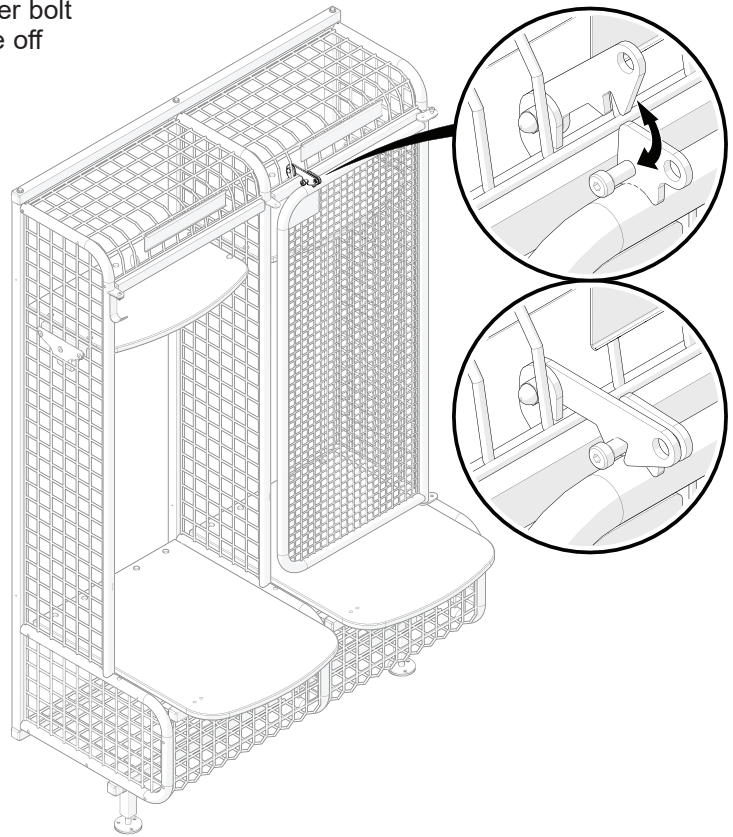

6. Skip to "Final Assembly" on page 11 to finish the assembly.

Wood Door Assembly



*This procedure is for assembling the wood door.
For assembling the grille door, go to page 5.*

1. Insert a 1/2" OD x 3/8" ID flange bearing (4) into the pilot hole on the bottom-right of the locker frame.

The locker door will always be mounted on the right side of the locker.

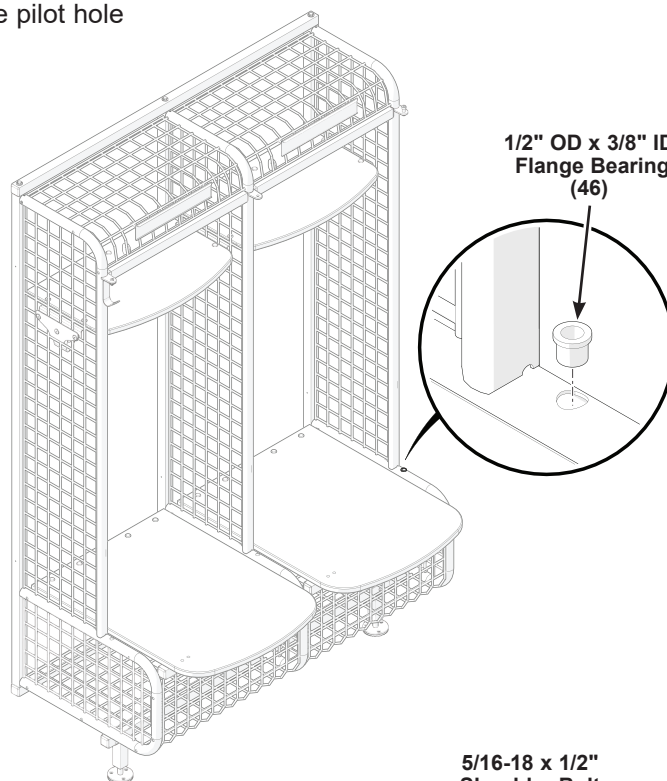

2. Attach the door to the locker.
 - a. Position the bottom-right of the wood door frame (2) onto the bottom-right of the locker frame, inserting the door frame pin into the previously installed flange bearing (4).
 - b. At the top of the door, align the right-side door frame weldment with the locker right-side frame weldment.
 - c. Insert a 5/16-18 x 1/2" shoulder bolt (9) through the top of the aligned weldment holes and secure using a 5/16-18 lock nut (5).

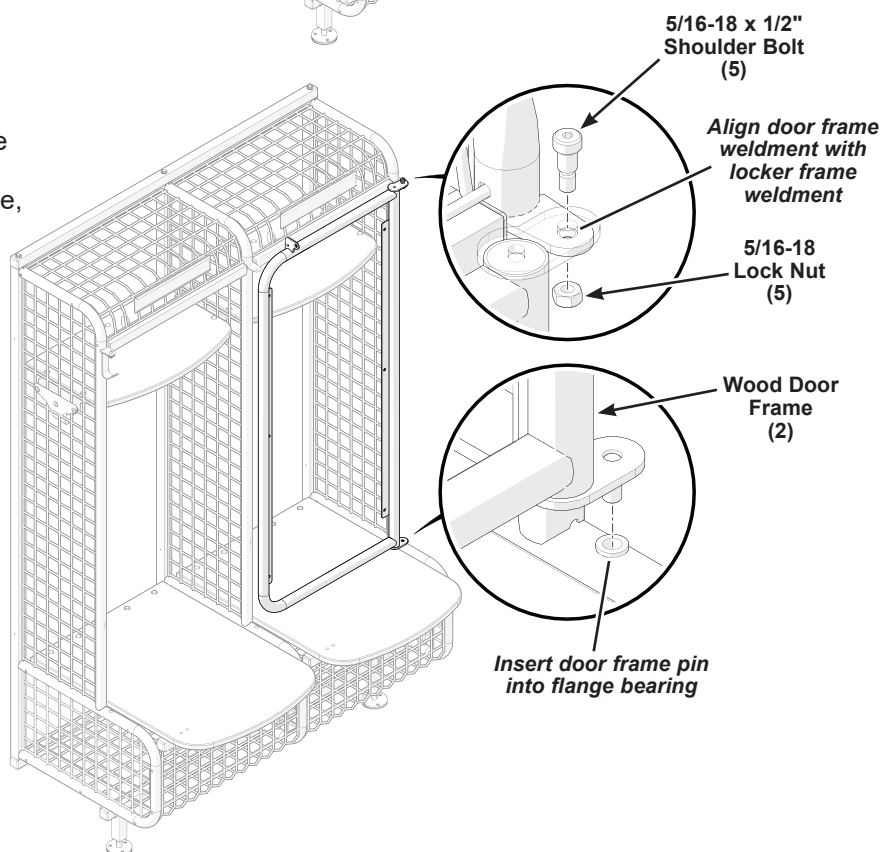

Wood Door Assembly (continued)

3. Attach the door lock to the locker frame.

- a. Align the hole in the narrower end of the door lock pivot plate (6) with the hole in the top grille weldment.

Be sure that the pivot plate is located on the right side of the weldment as shown.

- b. Attach the pivot plate to the weldment using a 5/16-18 x 1/4" shoulder bolt (8) and 5/16-18 cap hex nut (7).

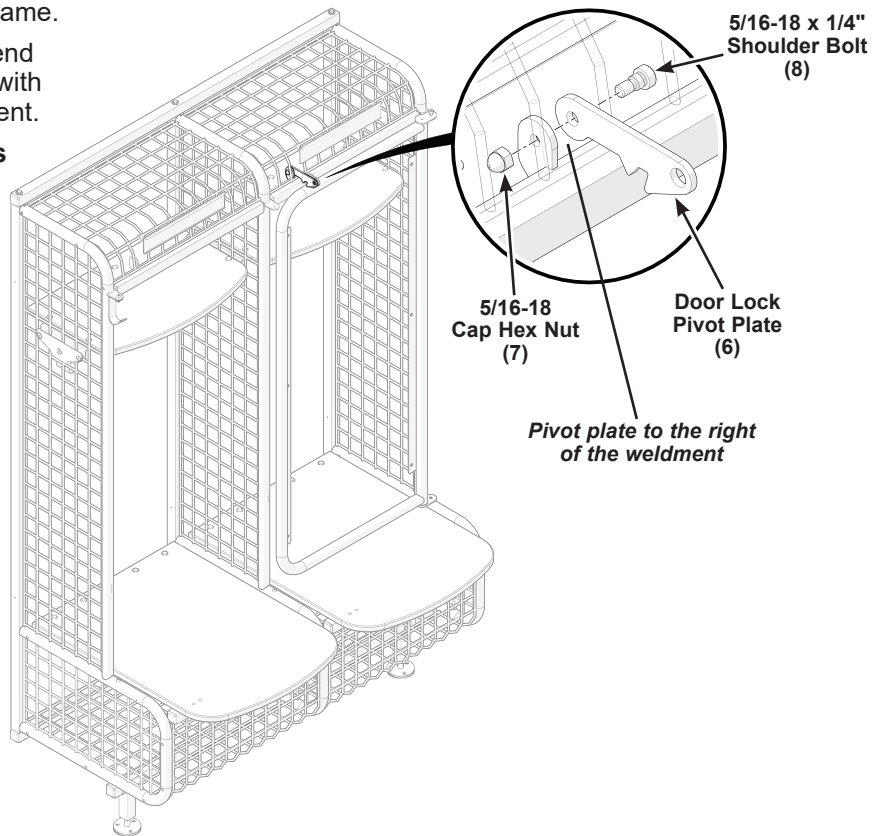

4. Attach the door lock bolt to the door frame.

- a. From the left-hand side, insert a 5/16-18 x 3/4" shoulder bolt (10) into the top door weldment as far as it will fit and secure the other side using a 5/16-18 cap hex nut (7).

Be sure that the shoulder bolt is inserted from the left side of the weldment as shown.

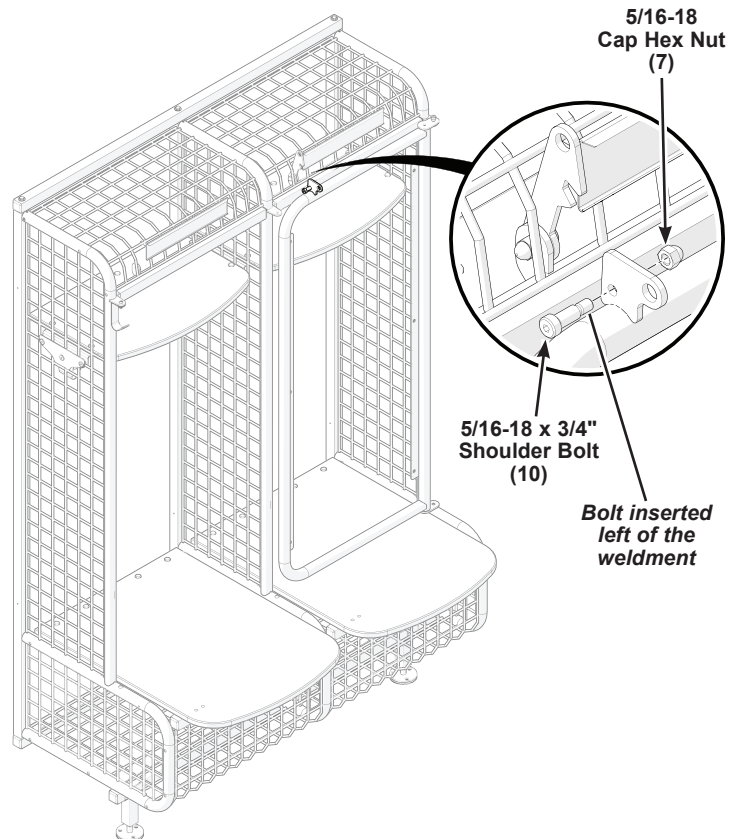

Wood Door Assembly (continued)

5. Lower the door lock pivot plate onto the shoulder bolt to secure the door closed and lift the pivot plate off the bolt to open the door.

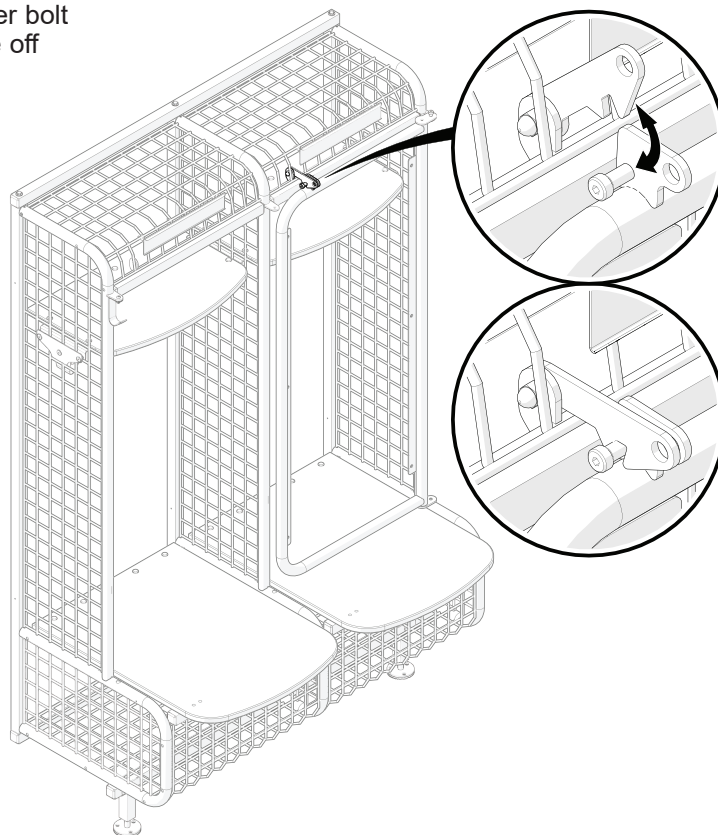

6. Attach the wood door panel to the door frame.

- a. Fit the door panel (3) onto the door frame and align the six holes in each.

- b. Attach the door panel to the door frame using six 1/4-20 x .708 machine screws (11) on the outside of the door panel and six 1/4-20 x .669 hex socket cap nuts (12) on the inside of the door frame.

7. Skip to "Final Assembly" on page 11 to finish the assembly.

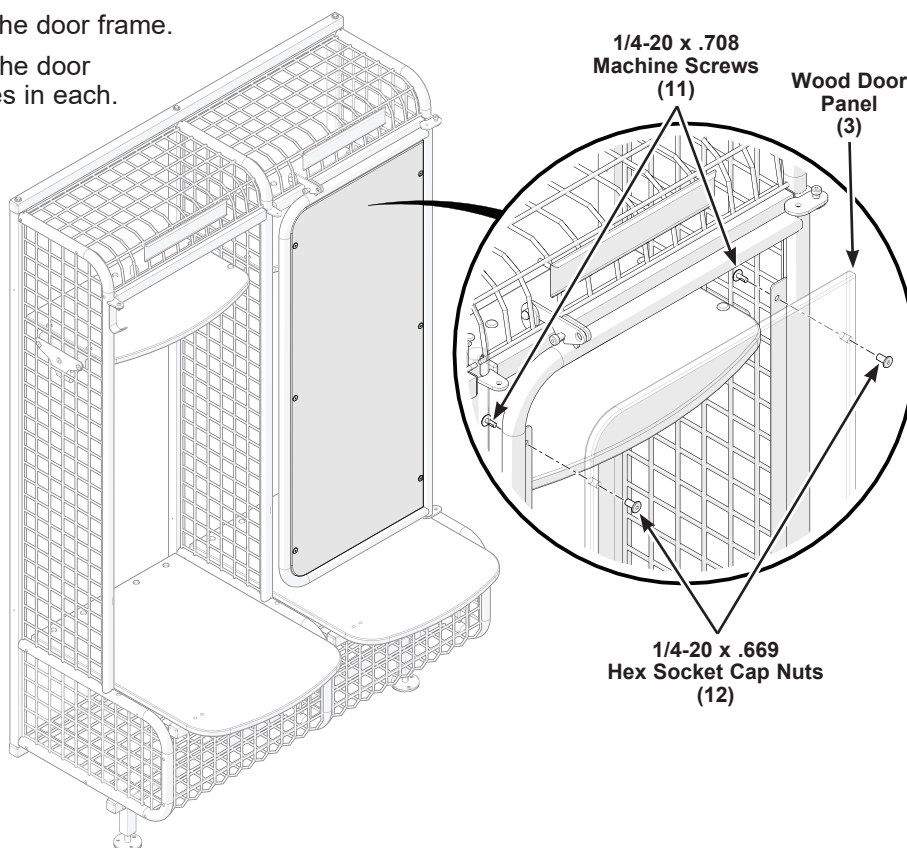

Final Assembly

1. Attach the locker door stop.
 - a. Open the locker door and tip the seat up for access, close and engage the door lock to prevent it from opening.
 - b. Attach a locker door stop (14) to the bottom-right of the locker frame using two #10 x 5/8" sheet metal screws (13).

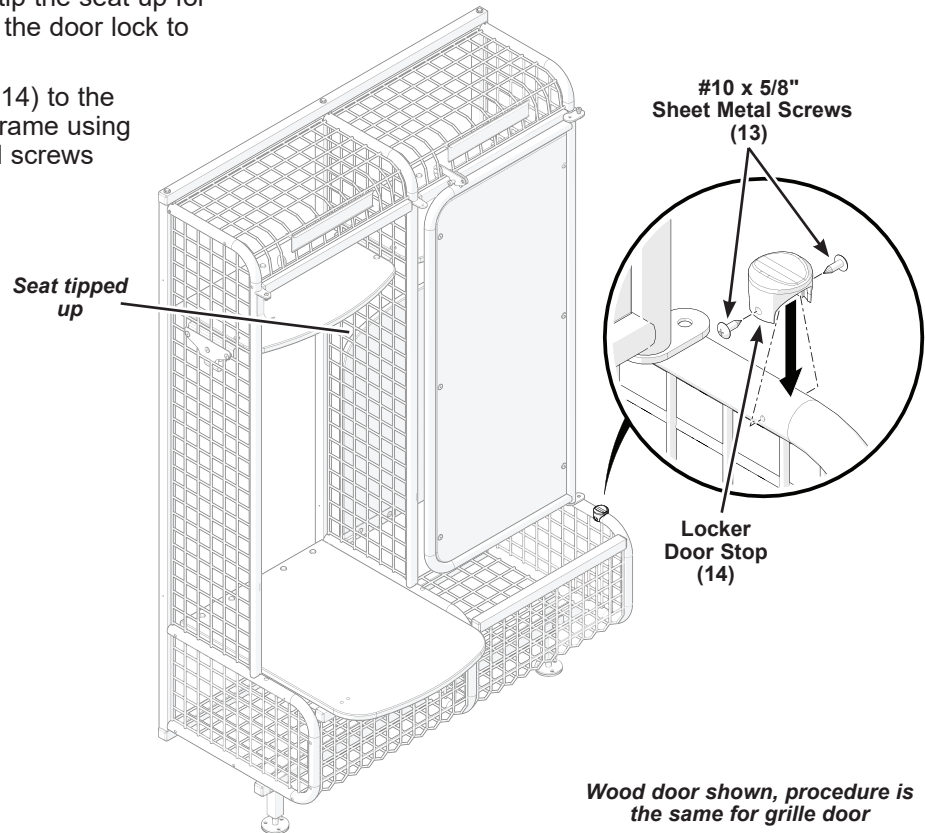

- c. The locker door frame should fit into the cradle of the locker door stop when the door is opened 90°.
2. Lower the seat and close the door, the locker door assembly is complete.

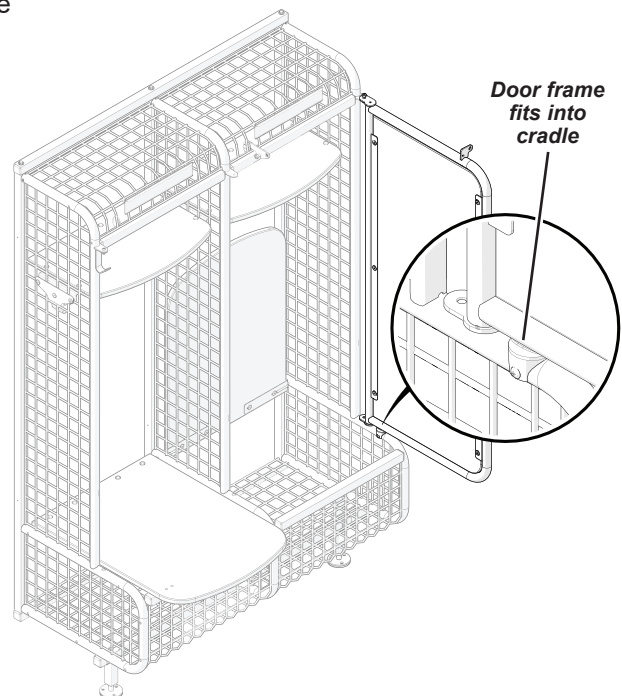

This page is intentionally blank.