

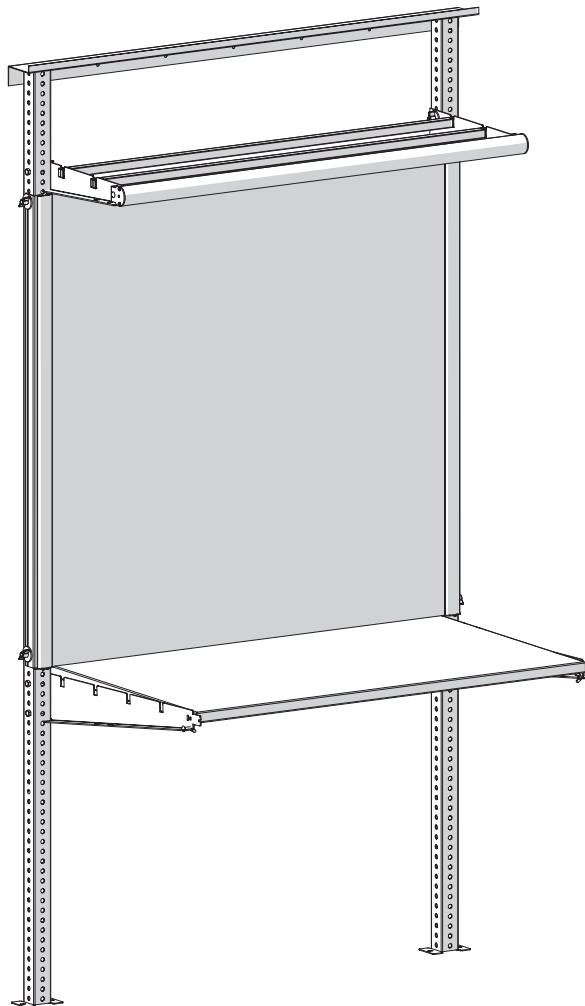

GEARBOSS®
by Wenger®

Installation Instructions Peg Board Option for the GearBoss® Shelving System



Contents

Important User Information	2	Safety Precautions	3
General	2	Supplied Hardware	3
Manufacturer	2	Component Identification	4
Intended Use	2	Installation	5
Warranty	2		



Visit the GearBoss web page at www.gearboss.com for more information.

Note: Please read and understand the instructions before starting the assembly or installation.
Note: If you need additional information, contact Wenger Corporation using the information below.

Important User Information

General

Copyright © 2016 by Wenger Corporation

All rights reserved. No part of the contents of this manual may be reproduced, copied, or transmitted in any form or by any means including graphic, electronic, or mechanical methods or photocopying, recording, or information storage and retrieval systems without the written permission of the publisher, unless it is for the purchaser's personal use.

Printed and bound in the United States of America.

The information in this manual is subject to change without notice and does not represent a commitment on the part of Wenger Corporation. Wenger Corporation does not assume any responsibility for any errors that may appear in this manual.

In no event will Wenger Corporation be liable for technical or editorial omissions made herein, nor for direct, indirect, special, incidental, or consequential damages resulting from the use or defect of this manual.

The information in this document is not intended to cover all possible conditions and situations that might occur. The end user must exercise caution and common sense when assembling or installing Wenger Corporation products. If any questions or problems arise, call Wenger Corporation at 1-800-887-7145.

Manufacturer

The Peg Board Option for the GearBoss® Shelving System is manufactured by:

Wenger Corporation
555 Park Drive
Owatonna, MN 55060
(800) 4WENGER (493-6437) • +1 (507) 455-4100
www.wengercorp.com

Intended Use

- This product is intended for use with GearBoss Shelving Systems only.
- This product is intended for indoor use in normal ambient temperature and humidity conditions — it must not be exposed to outside weather conditions.
- This product is intended to be assembled only as described in these instructions.

Warranty

The Peg Board Option for the GearBoss Shelving System is covered under a five year Limited Warranty offered to you, the initial purchaser. This Warranty runs from the date of shipment and warrants that the Wenger product will be free of defects in materials or craftsmanship during the warranty period. This Warranty is your sole and exclusive remedy for any claim against Wenger related to your purchase, use, or ownership of a Wenger product. This Warranty does not apply to damage caused by common carrier, misuse or abuse, alterations to products not expressly authorized by Wenger. Exact matching of color, grain, texture and lighting is not guaranteed as these features are prone to change and fade over time. Our warranty assures you of, at the discretion of our Customer Service Department, either a full refund, or the repair or replacement of the defective product without charge. Just call a Customer Service Representative at 1-800-887-7145 and state the reason you are dissatisfied. If return of a product is necessary, your representative will issue a return authorization.

Safety Precautions

Throughout this manual you may find cautions and warnings which are defined as follows:

- **WARNING** means that failure to follow the instruction may result in serious injury or death.
- **CAUTION** means that failure to follow the instruction may result in serious injury or damage to property.

Read all of these safety instructions before assembling and installing the AirPro Lockers.

 CAUTION	 CAUTION	 CAUTION
<i>Make sure anyone installing the Peg Board Option has read and understands these instructions.</i>	<i>Failure to comply with Warnings and Cautions in this document can result in damage to property or serious injury.</i>	<i>Never hang more than 40 lbs (18 kg) of total weight from the Peg Board.</i>

Always observe the Safety Precautions that apply to the original GearBoss Shelving System installation.

Supplied Hardware

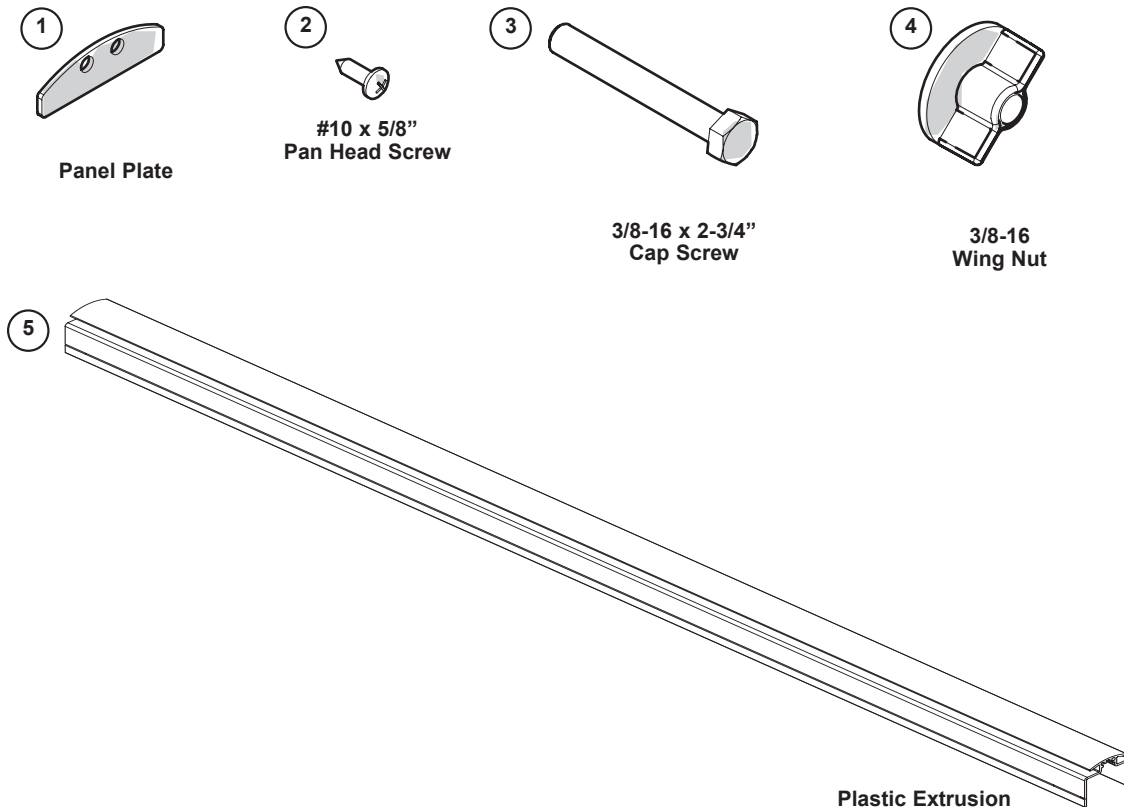

The 1/4" thick peg board material is not supplied by Wenger and must be purchased separately. See the Installation procedure for measurement requirements.

Component Identification

Item	Description
1	Panel Plate
2	#10 x 5/8" Pan Head Screw
3	3/8-16 x 2-3/4" Cap Screw
4	3/8-16 Wing Nut
5	Plastic Extrusion
6	Peg Board (not included) <i>Must be purchased separately</i>

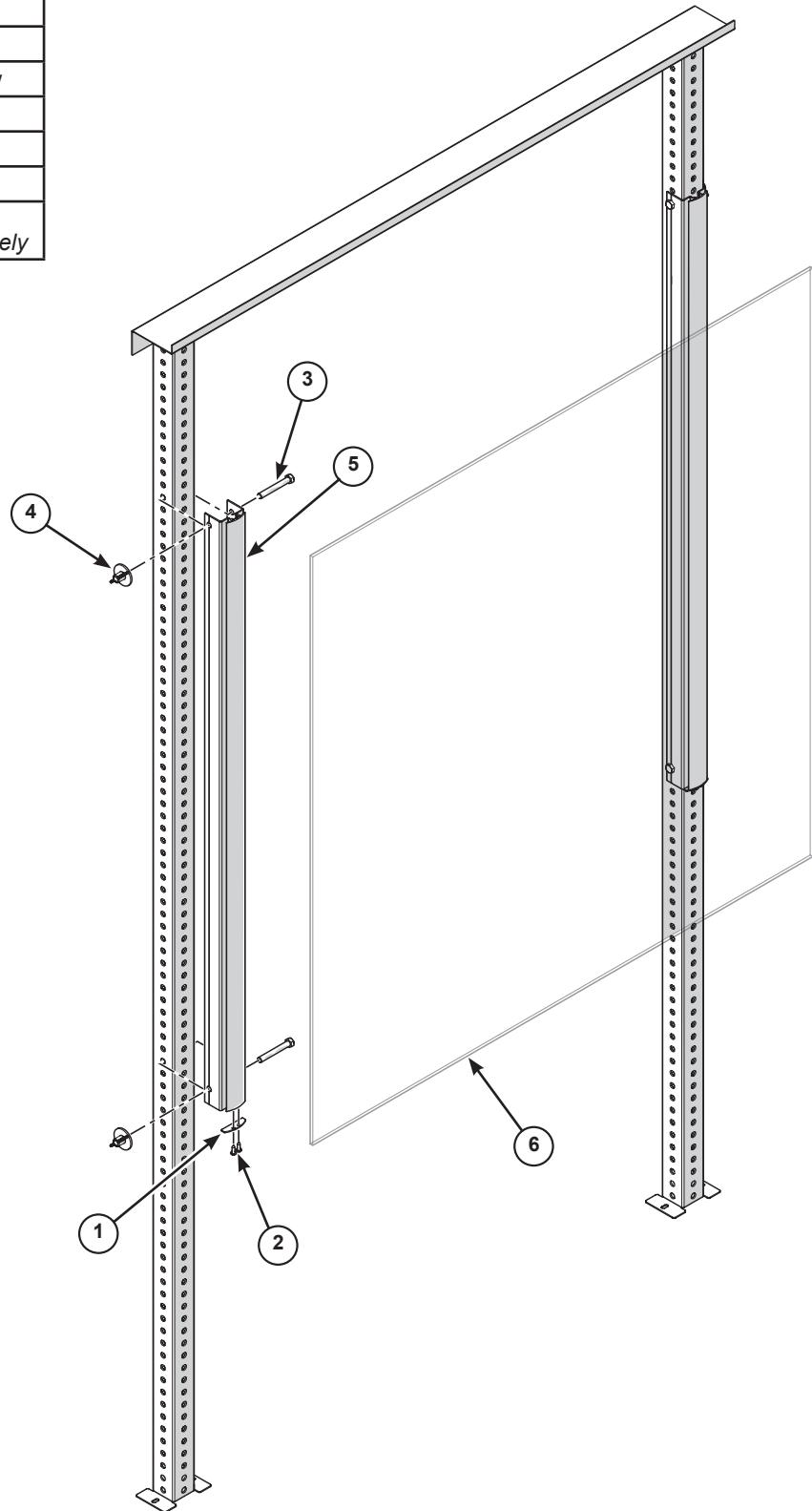

Installation

This product is designed for use with GearBoss Shelving Systems only.

1. The Plastic Extrusions (5) may need to be cut to fit between any components that are mounted to the Shelf Upright Tubes.
Measure and cut both Plastic Extrusions to fit onto the Shelf Upright Tubes as necessary.

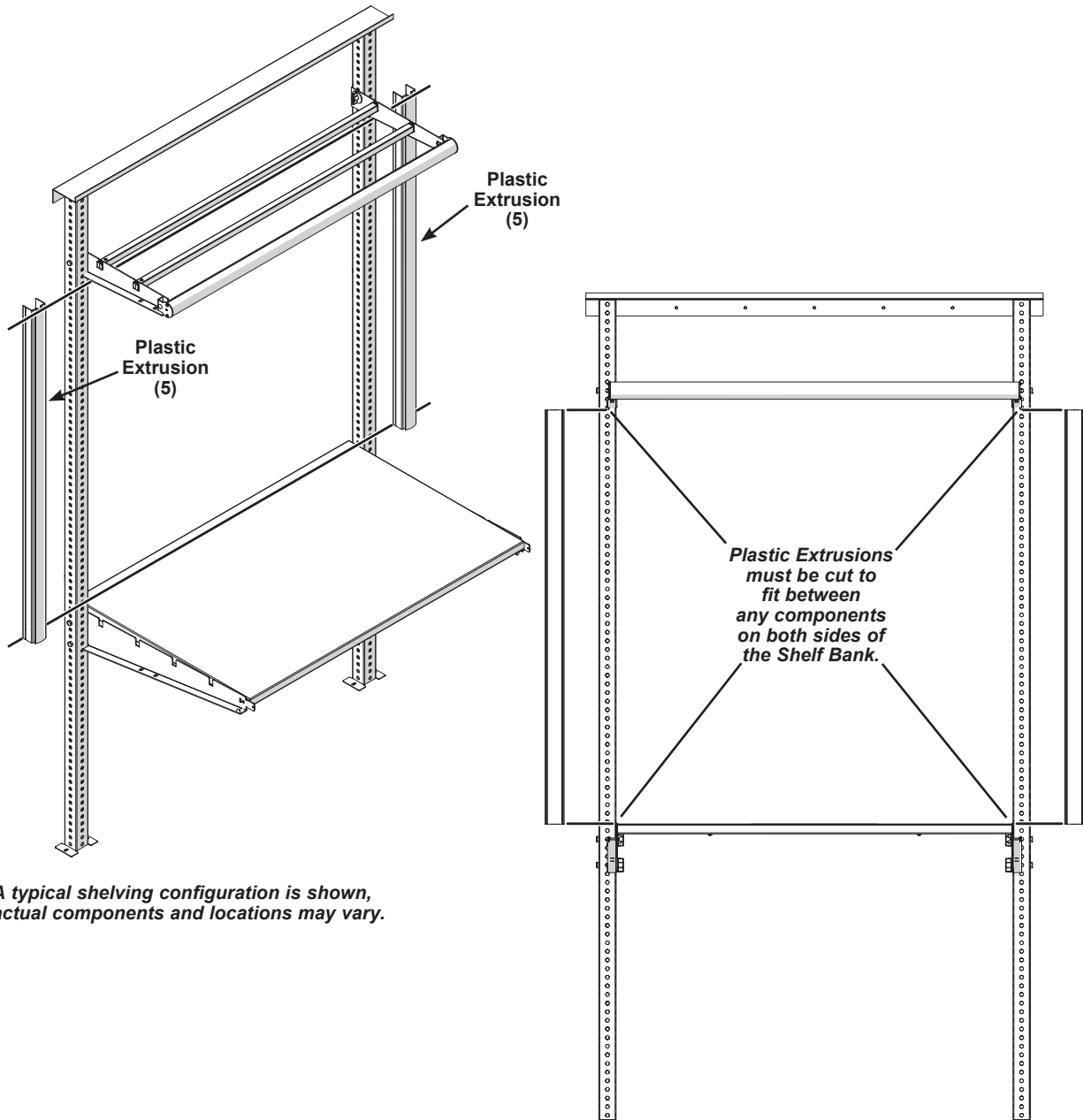

A typical shelving configuration is shown, actual components and locations may vary.

Installation (continued)

- 2. Attach one Panel Plate (1) to an end of each Plastic Extrusion using two #10 x 5/8" Pan Head Screws (2).

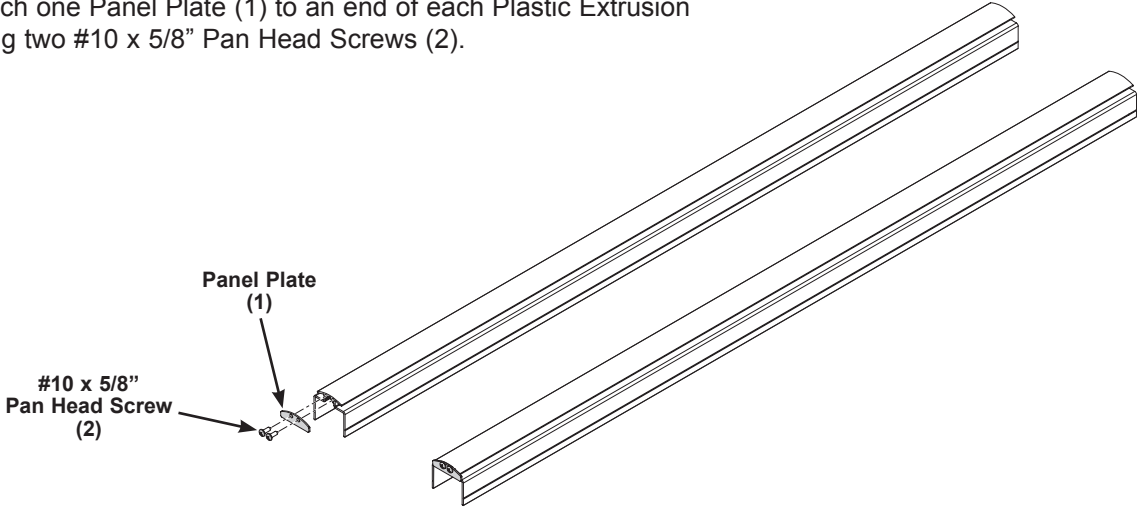

- 3. With the Panel Plate side down, push the Extrusion Assemblies onto the Shelf Upright Tubes.

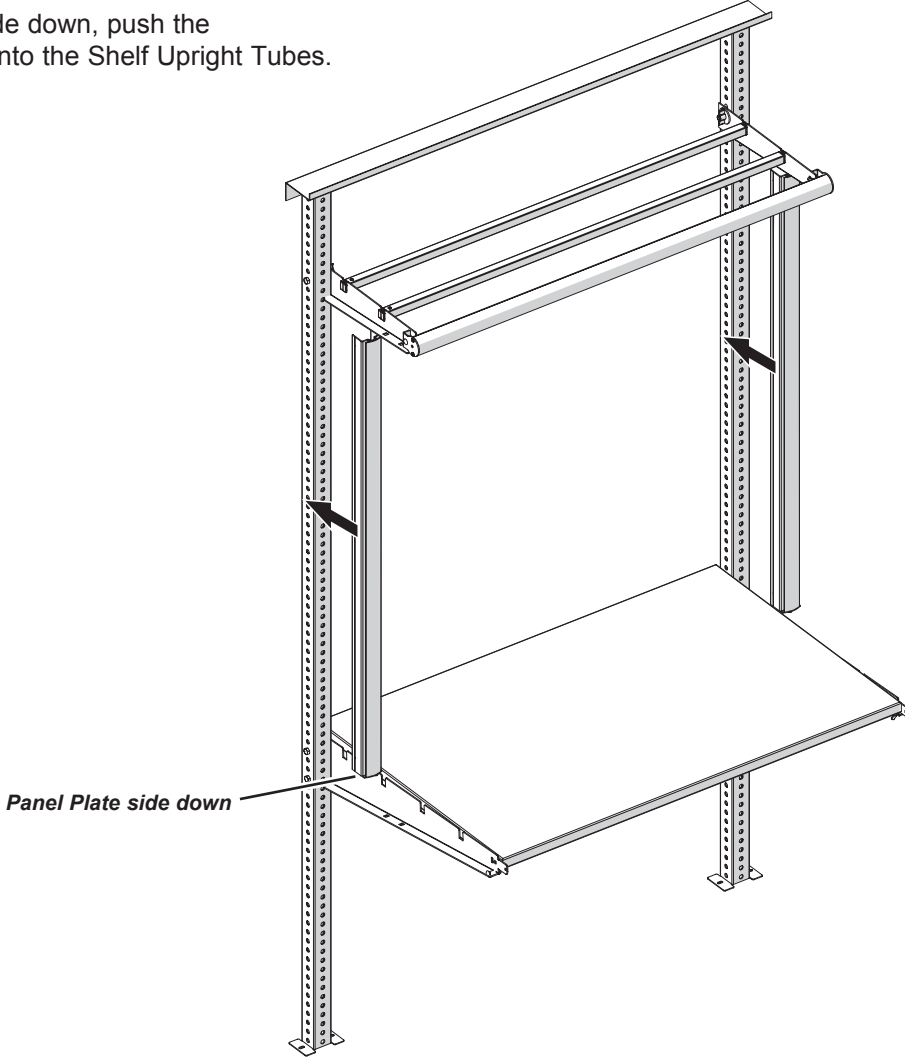

Installation (continued)

4. Drill a 3/8" hole near the bottom of each Extrusion Assembly. Horizontally center the hole over the crease in the Extrusion and vertically align the hole with an existing hole in the Shelf Upright Tube.
5. Attach the bottom of each Extrusion to the Upright using a 3/8-16 x 2-3/4" Cap Screw (3) and 3/8-16 Wing Nut (4).
6. Drill a 3/8" hole near the top of each Extrusion Assembly. Horizontally center the hole over the crease in the Extrusion and vertically align the hole with an existing hole in the Shelf Upright Tube.
7. Attach the top of each Extrusion to the Upright using a 3/8-16 x 2-3/4" Cap Screw (3) and 3/8-16 Wing Nut (4).

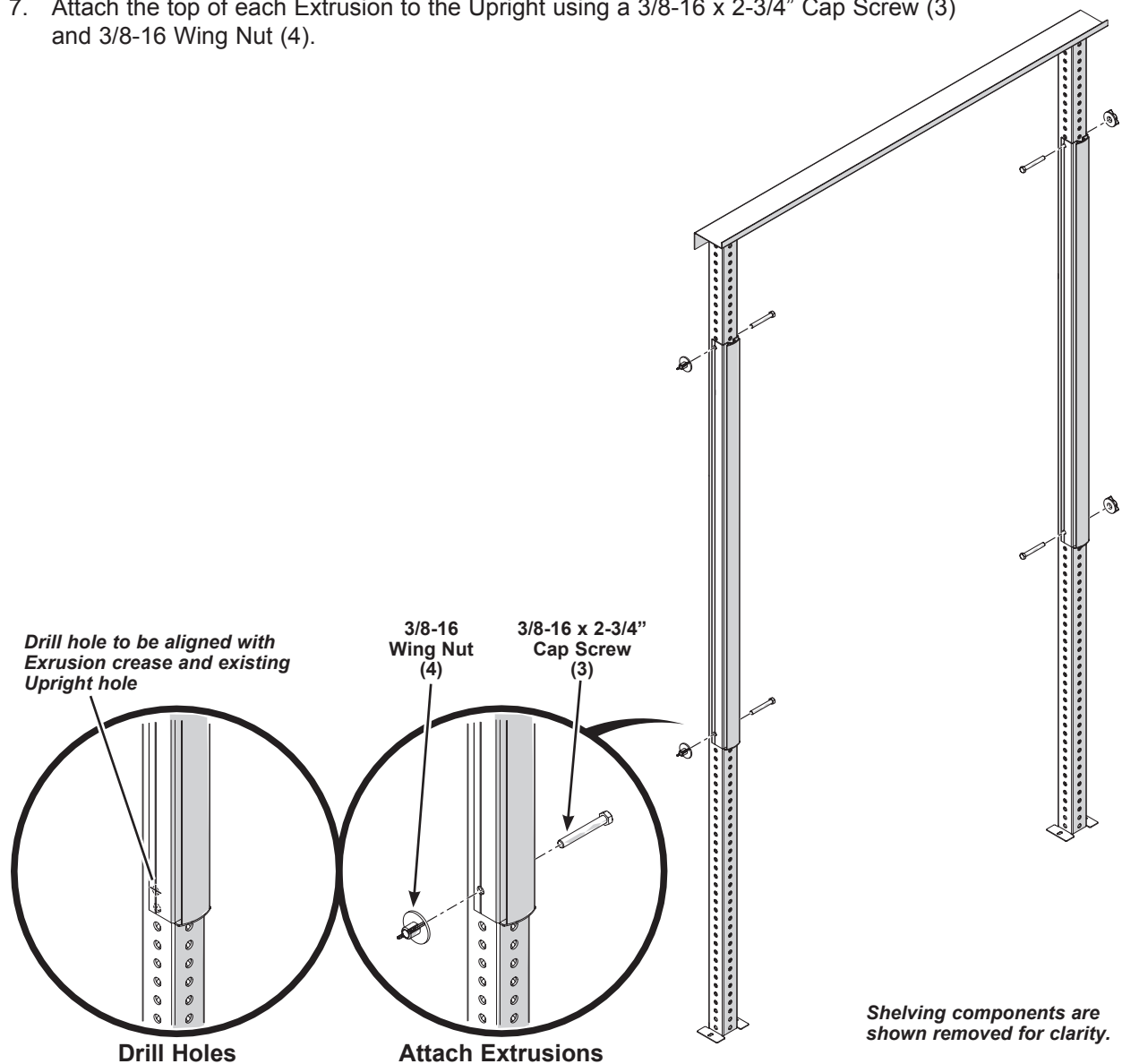

Installation (continued)

8. Insert a Peg Board (6) to fit within the Plastic Extrusions.
 - a. Cut a 1/4" thick Peg Board (not supplied) to fit the width within the side notches in both Plastic Extrusions.
 - b. Cut the Peg Board to match the height of the Plastic Extrusions.
 - c. Fit the Peg Board into the side notches of both Plastic Extrusions and to sit onto the Panel Plates.

