

Side Closure Accessory for GearBoss® X-Cart™ and Team Cart™

Basic Instructions only!
For more detailed product information, refer to the
GearBoss High-Density Storage System Owner's Manual 240A099.

⚠ CAUTION

Make sure anyone assembling, installing or using this product has read and understands these instructions.

⚠ CAUTION

Failure to comply with Warnings and Cautions in this document or on the equipment can result in damage to property or serious injury.

⚠ CAUTION

To help avoid damage, more than one person is needed for installation.

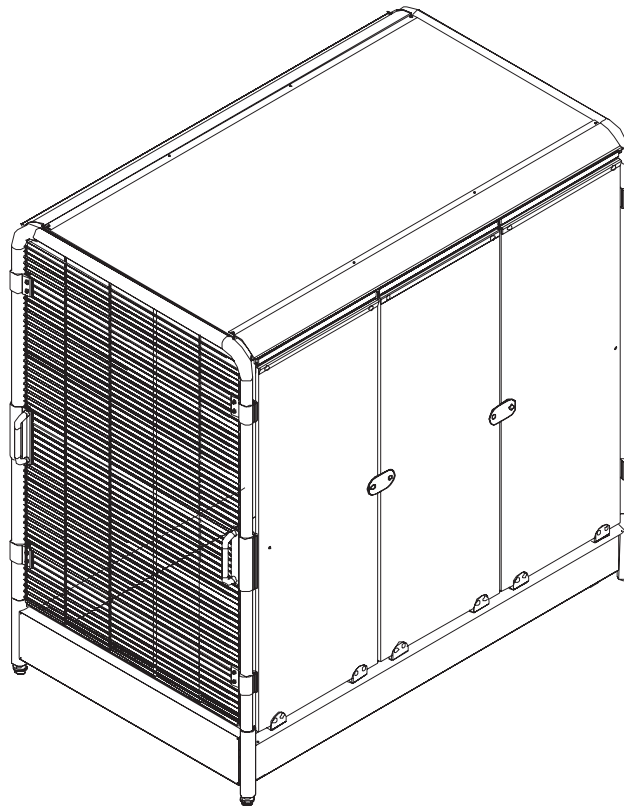

X-Cart with Side Closure

Contents

Required Tools 2	Side Closure Installation 3
Supplied Hardware 2	Replacement Parts 11
Parts List 2	



Visit the GearBoss High-Density Storage System web page at gearboss.com for more information.

Note: Please read and understand these instructions before proceeding.
Note: If you need additional information, contact Wenger Corporation using the information below.

Required Tools

Cordless drill
 9/16" Combination wrench

Supplied Hardware

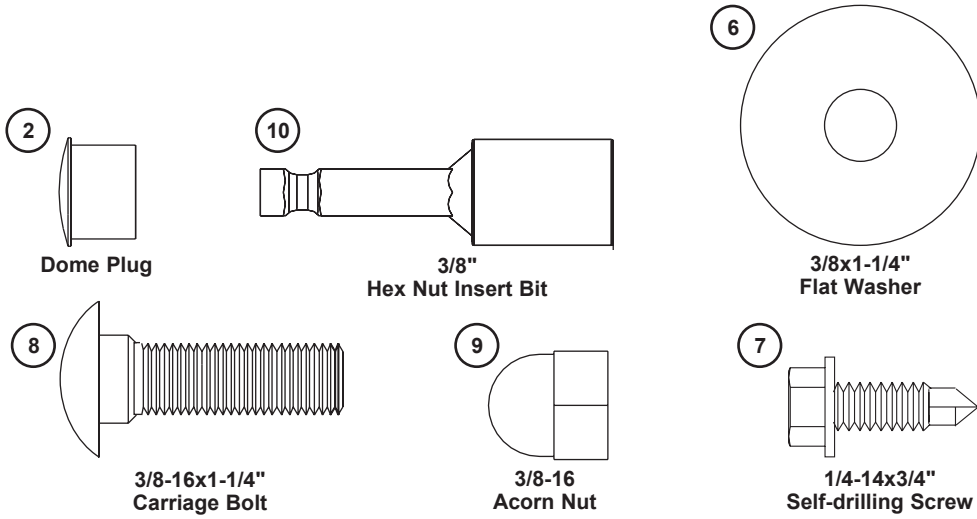

Parts List

Item	Qty	Description
1	3	Side Closure Panel
2	3	Dome Plug
3	3	Side Closure Top Bracket
4	6	Side Closure Outer Bracket
5	2	Side Closure Connector Plate
6	17	3/8 x 1-1/4" Flat Washer**
7	7	1/4-14 x 3/4" Self-drilling Screw**
8	23	3/8-16 x 1-1/4" Carriage Bolt**
9	23	3/8-16 Acorn Nut**
10	1	3/8" Hex Nut Drive Bit**
11	1	1" x 73" Velcro Tape

**Item is not shown, refer to Supplied Hardware

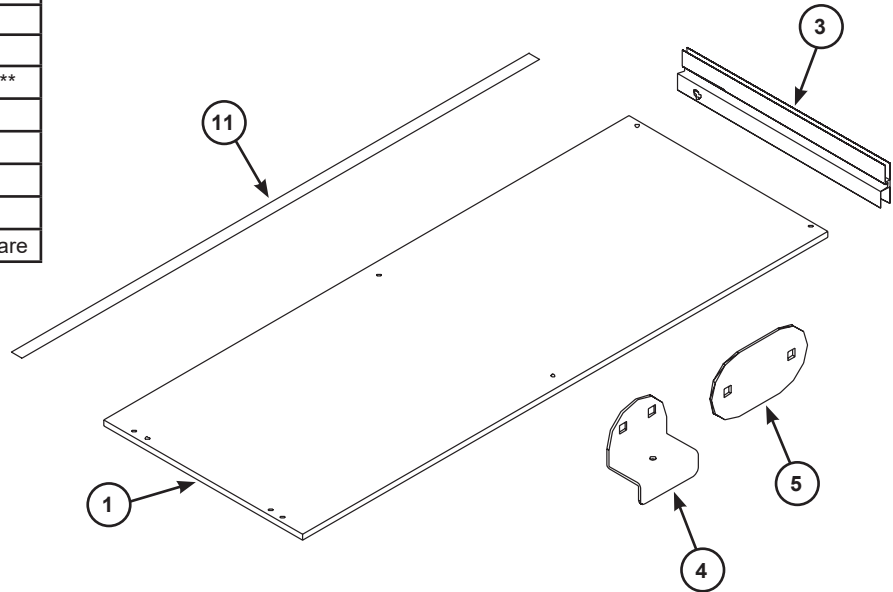

Side Closure Installation

NOTICE

The following Installation Instructions are the same for the side closure installation to a 32" (813 mm) X-Cart, a 48" (1219 mm) X-Cart, or a Team Cart.

Before Starting the Side Closure Installation

1. Move the side closure carton to the work area (it is best to use a work table).
2. Open the carton and inventory the contents. Make sure that all of the required items listed in the Parts List are present including the hardware items. Discard the packing materials and corrugated carton.

NOTICE

Not all hardware items packed in the carton may be needed. When the assembly is complete, discard any hardware items not used.

Attach the Top Brackets

1. Place one of the side closure panels onto the work surface with the two top bracket mounting holes at the top as shown below. The four outer bracket mounting holes will be at the bottom.

NOTICE

The side closure panel surface facing upward will be the outside surface after installation. If the connector plate mounting hole is on the right, the second side closure panel to be assembled in step 3 must be placed onto the work surface with the connector plate mounting hole on the left side.

2. Attach the top bracket to the side closure panel.
 - a. Insert the side closure panel top edge into the side closure top bracket lower channel with the flat side of the top bracket facing downward (refer to the illustrations).
 - b. Insert a 3/8-16 x 1-1/4" carriage bolt into each side closure top bracket mounting hole as shown.
 - c. Using a 9/16" combination wrench, attach a 3/8-16 acorn nut to each carriage bolt.
3. Repeat steps 1 to 2 with the other two side closure panels.

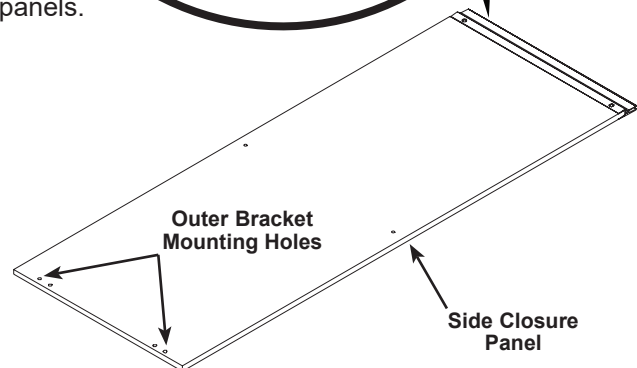
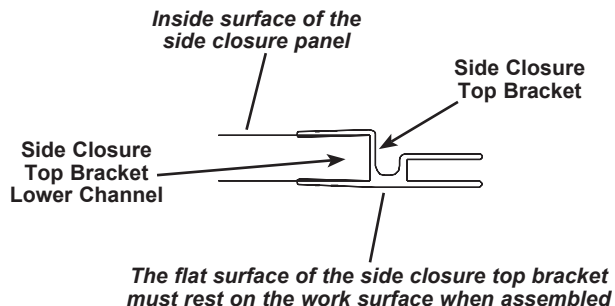
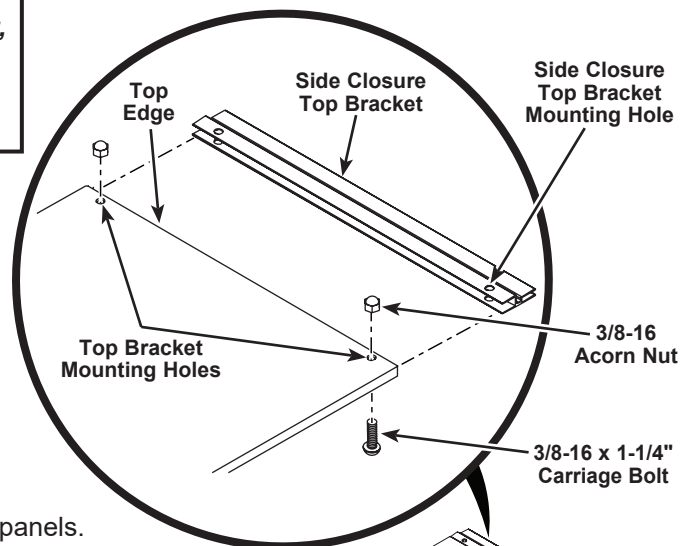

Side Closure Installation (continued)

Attach the Outer Brackets

1. Place one of the side closure panels onto the work surface with flat side of the top bracket facing downward as shown.
2. Insert two carriage bolts, 3/8-16 x 1-1/4", through the two clearance holes in the outer bracket and side closure panel.
3. Using a 9/16" combination wrench, attach two 3/8-16 acorn nuts and two 3/8 x 1-1/4" flat washers to the two carriage bolts as shown.
4. Attach a second outer bracket to the other side of the side closure panel in the same manner.
5. Repeat steps 1 to 4 with the other two side closure panels.

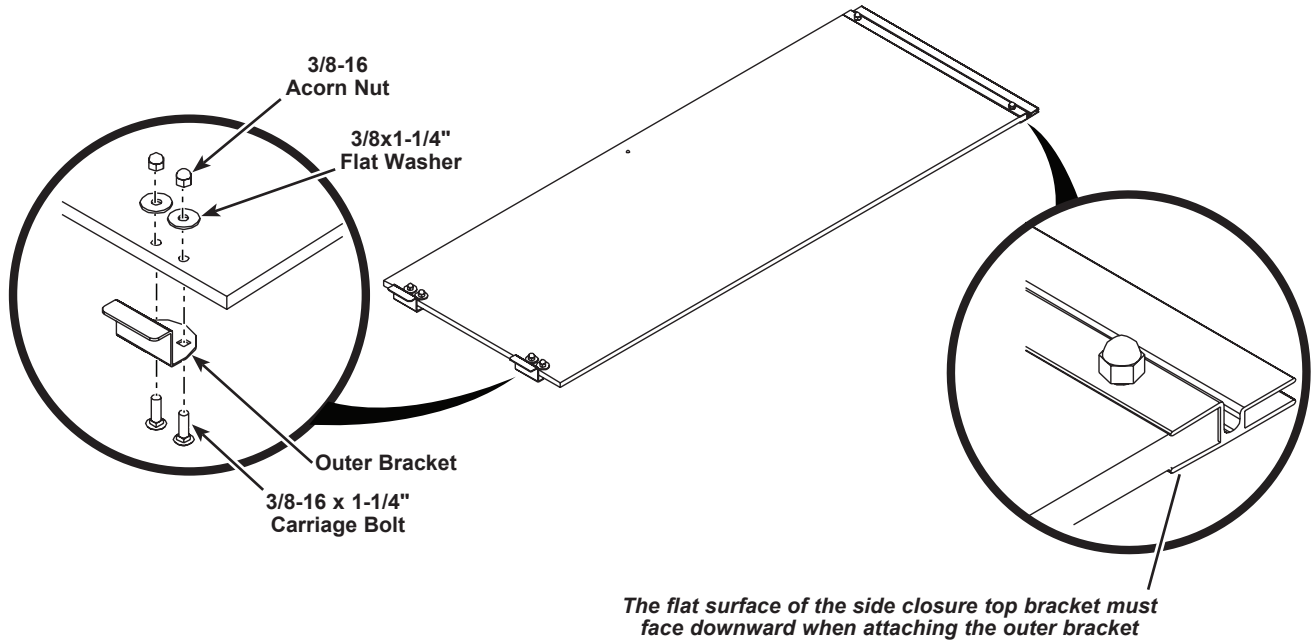

Side Closure Installation continued

Attach Velcro Tape to the Cart

1. Attach the Velcro tape to the top panel extrusion on the side that the side closure panels will be installed.
 - a. Peel about 12" of the protective liner from one end of the Velcro tape.
 - b. Press the end of the Velcro tape with the exposed adhesive onto the top panel extrusion outer leg with about one-half of the tape width hanging below the outer leg edge as shown below.
 - c. Continue to peel the protective liner from the Velcro tape and attach the Velcro tape to the entire length of the top panel extrusion.

NOTICE

It may be necessary to use a step stool to reach the top.

CAUTION

Never stand on the cart.

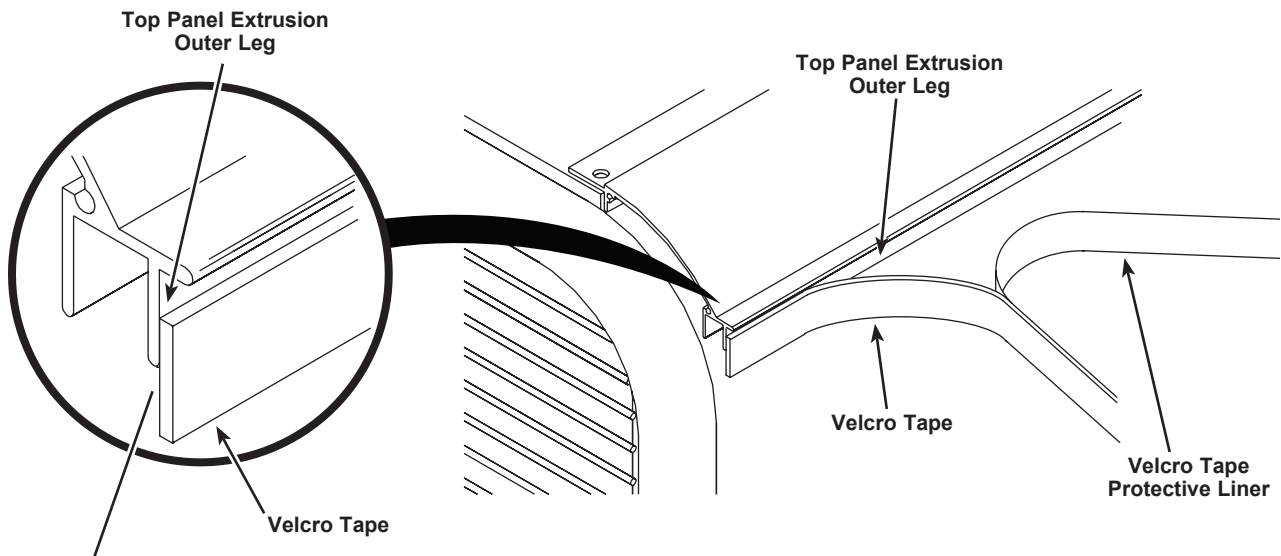

Only attach about half of the width of the tape to the top panel extrusion outer leg

2. Fold the Velcro tape around the top panel extrusion outer leg so that the tape is attached to the inside and outside surface of the outer leg. Make sure that the Velcro tape is firmly attached to the entire length of both sides of the top panel extrusion outer leg.

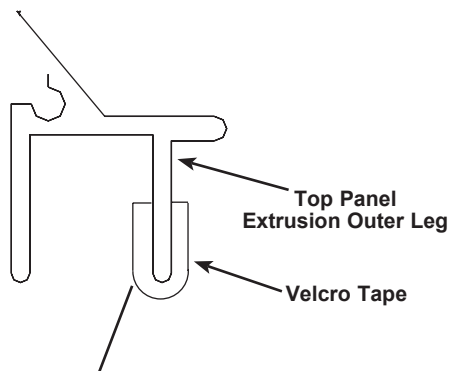

Make sure that the velcro tape is firmly attached to the entire length of both sides of the top panel extrusion outer leg

Side Closure Installation (continued)

Attach the Side Closure Panels to the Cart

1. Place the side closure panel into position in the cart.
 - a. Fit the top bracket upper channel onto the top panel extrusion outer leg as shown in the illustration below.
 - b. Place the bottom surface of the two outer brackets onto the top surface of the chassis side rail. Make sure that the vertical inside surface of the two outer brackets is pushed against the inside of the chassis side rail.

Outside View

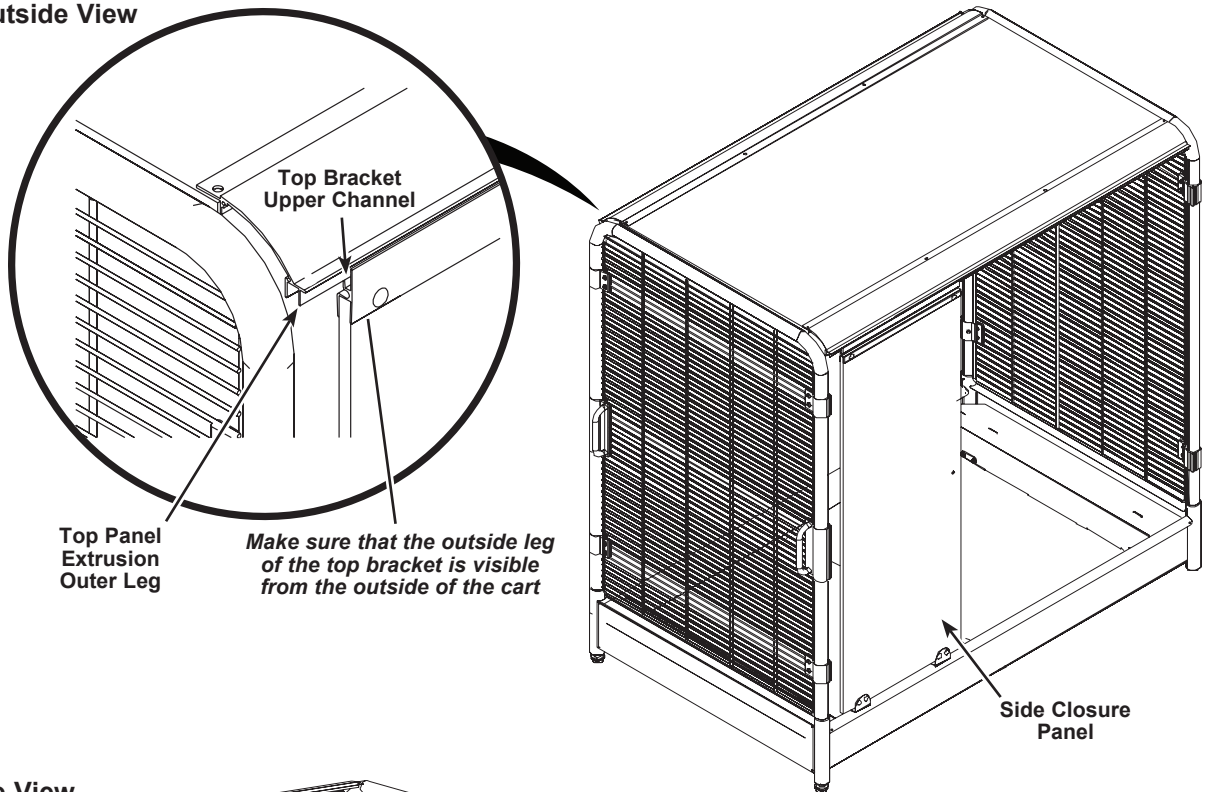

Inside View

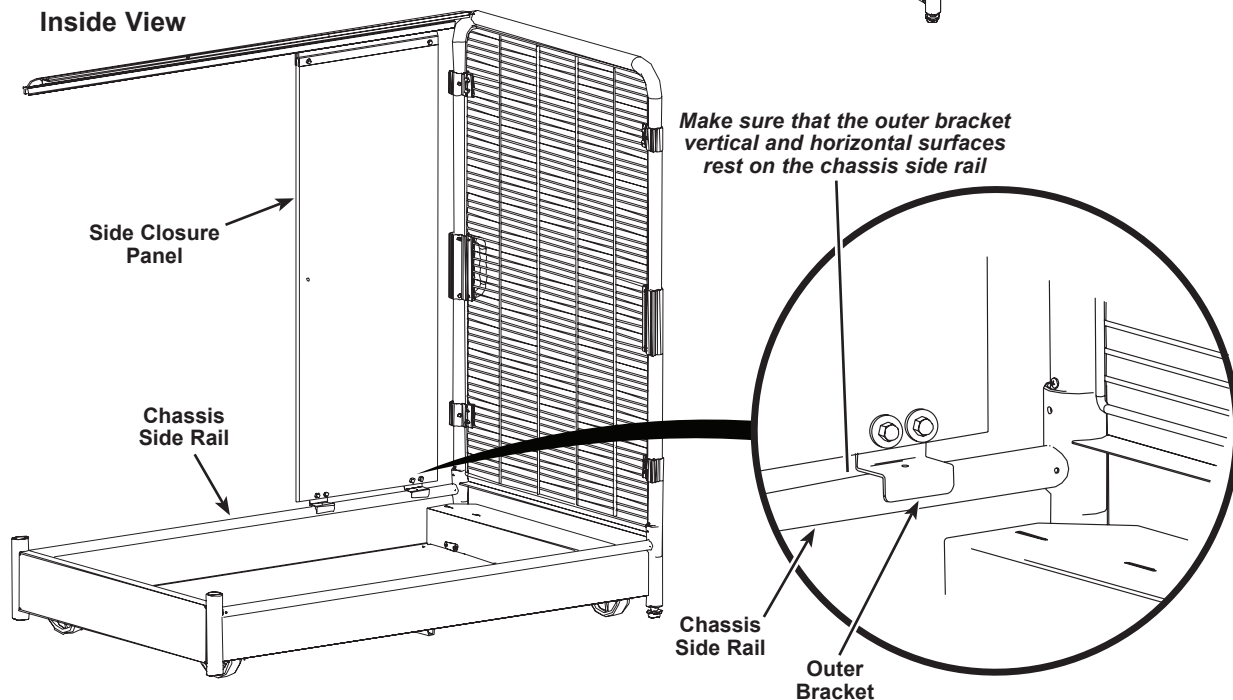

Side Closure Installation (continued)

2. Place the side closure panel into the cart.
 - a. Fit the top bracket upper channel onto the top panel extrusion outer leg.
 - b. Place the bottom surface of the two outer brackets onto the top surface of the chassis side rail. Make sure that the vertical inside surface of the two outer brackets is pushed against the inside of the chassis side rail.

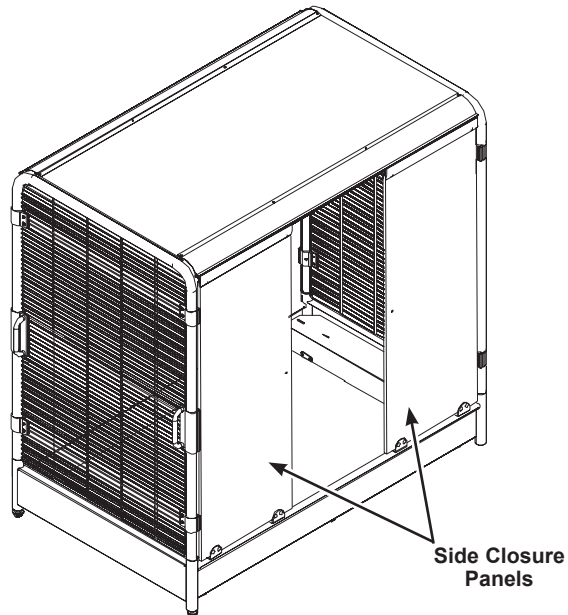

3. Place the side closure panel into the cart between the side closure panels in the same way as done in steps 1 and 2. It may be necessary to adjust the edge closure end panel positions to allow room for the middle side closure.

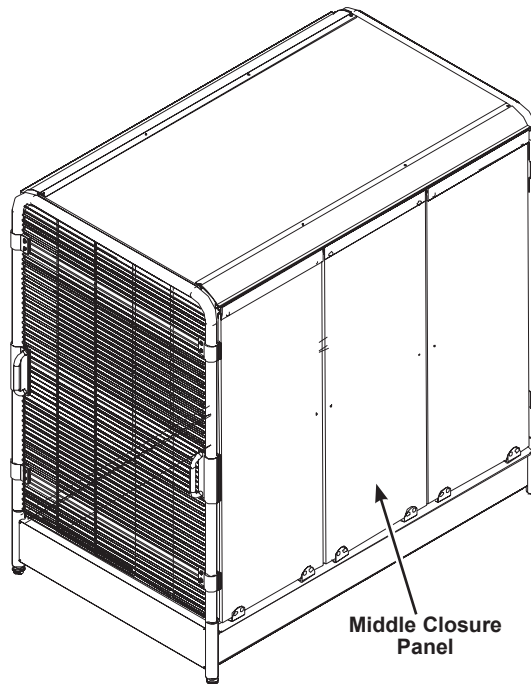

Side Closure Installation (continued)

Attach the Connector Plates

1. Assemble a connector plate to the right side closure panel and the middle side closure panel.
 - a. Align the connector plate clearance holes (square) to the connector plate mounting holes on the right side closure panel and the right side of the middle side closure panel.
 - b. Insert two 3/8-16 x 1-1/4" carriage bolts through the clearance and mounting holes. Push the square shoulder of each carriage bolt fully into the two connector plate clearance holes (square). It may be necessary to adjust the horizontal position of the two side closure panels to achieve alignment.
 - c. Using a 9/16" combination wrench, attach a flat washer and a 3/8-16 acorn nut to each carriage bolt. It may be necessary for two people to work together to prevent the carriage bolt from being pushed out of the holes.
2. Attach a second connector plate to the left side closure panel and the middle side closure panel in the same way as done steps 1a, 1b, and 1c.

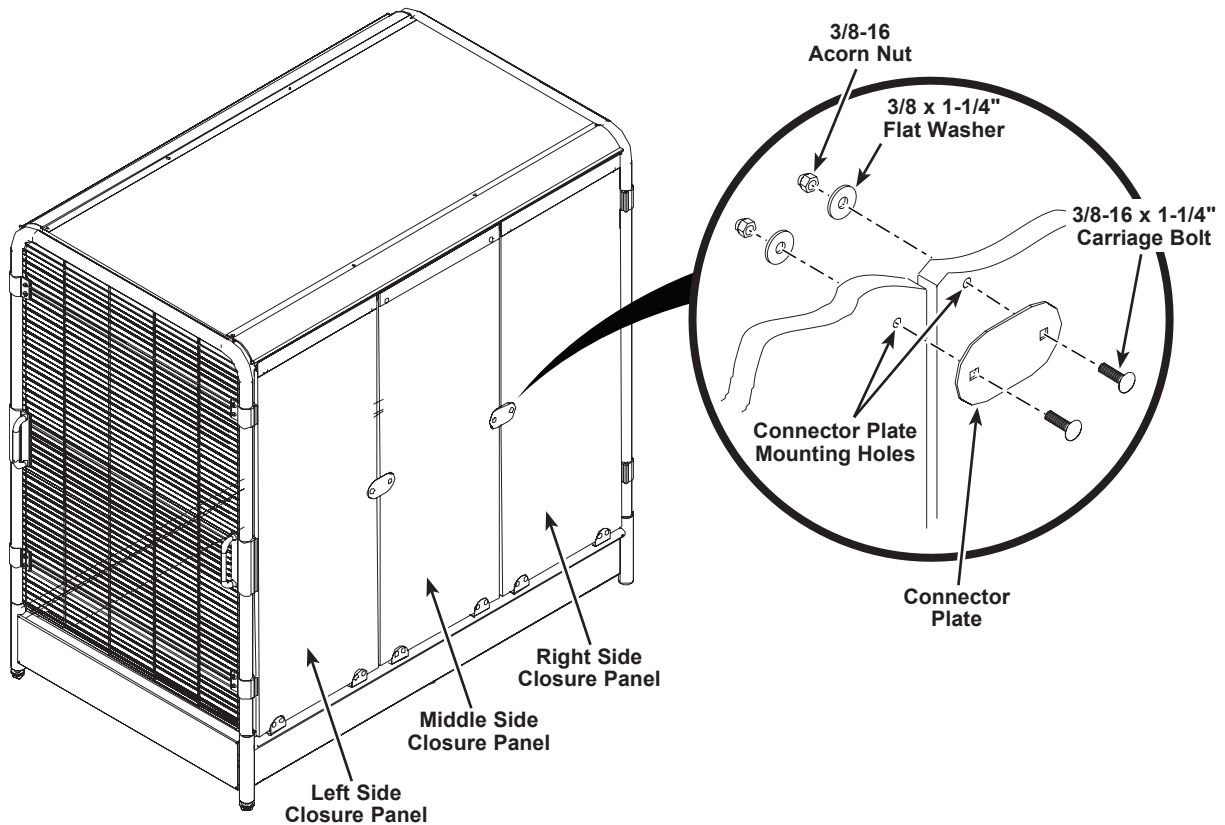

Side Closure Installation (continued)

Attach the Outer Brackets to the Cart

1. Using a cordless drill with a 3/8" hex nut drive bit, attach each of the six outer brackets to the chassis side rail with six 1/4-14x3/4" self-drive screws as shown below. Use the outer bracket pilot hole as a pilot when driving the screw into the chassis side rail.

NOTICE

Make sure that the side closure panel assembly is centered (left-to-right) on the cart.

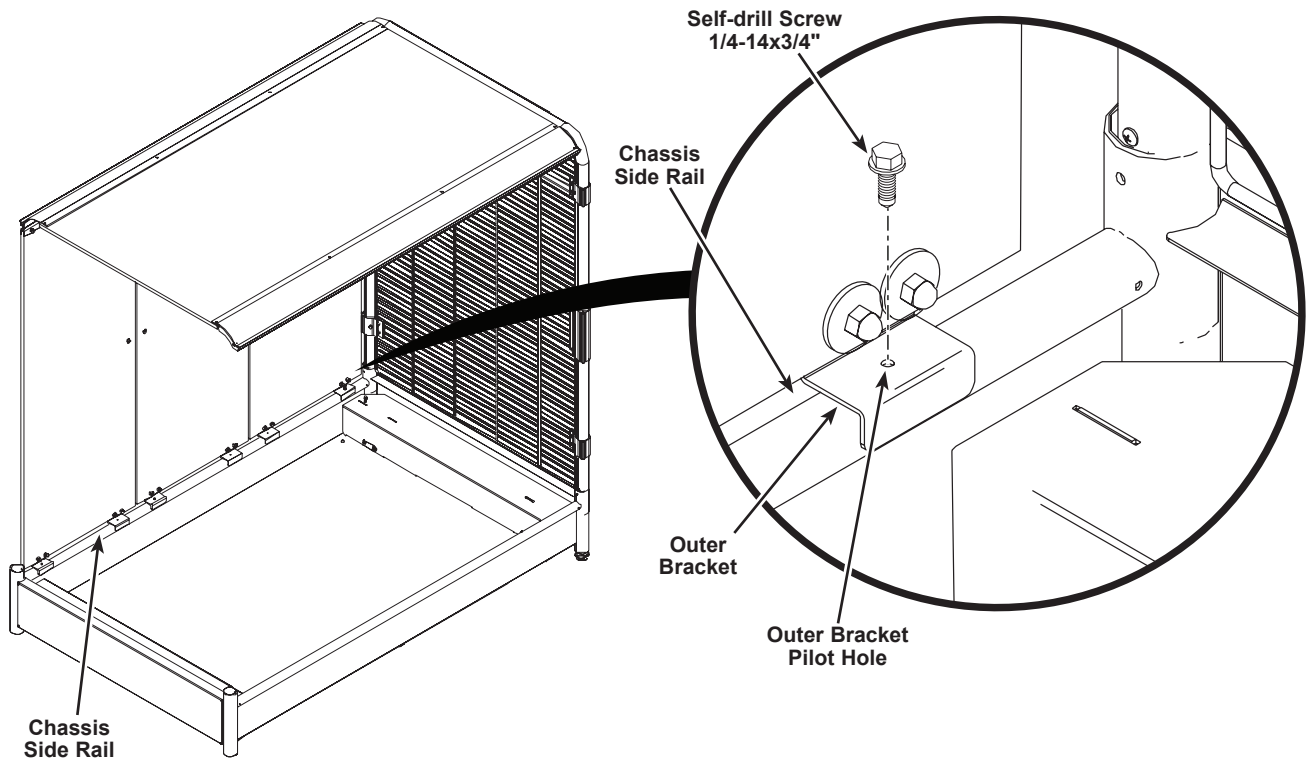

Side Closure Installation (continued)

Insert Dome Plugs

1. Insert a dome plug into each open hole on the outside surface of both the left and right side closure panels.

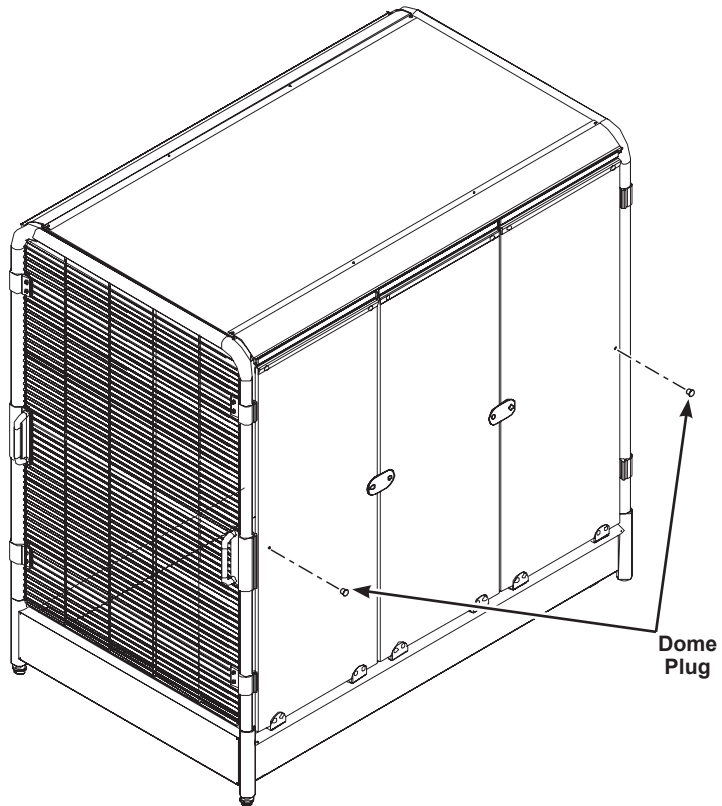

Replacement Parts

Item	Description
1	Side Closure Panel
3	Side Closure Outer Bracket
4	Side Closure Connector Plate
5	Side Closure Top Bracket
6	3/8-16 Acorn Nut
7	3/8 x 1-1/4" Flat Washer
8	1/4-14 x 3/4" Self-drilling Screw
9	3/8-16 x 1-1/4" Carriage Bolt
10	Dome Plug

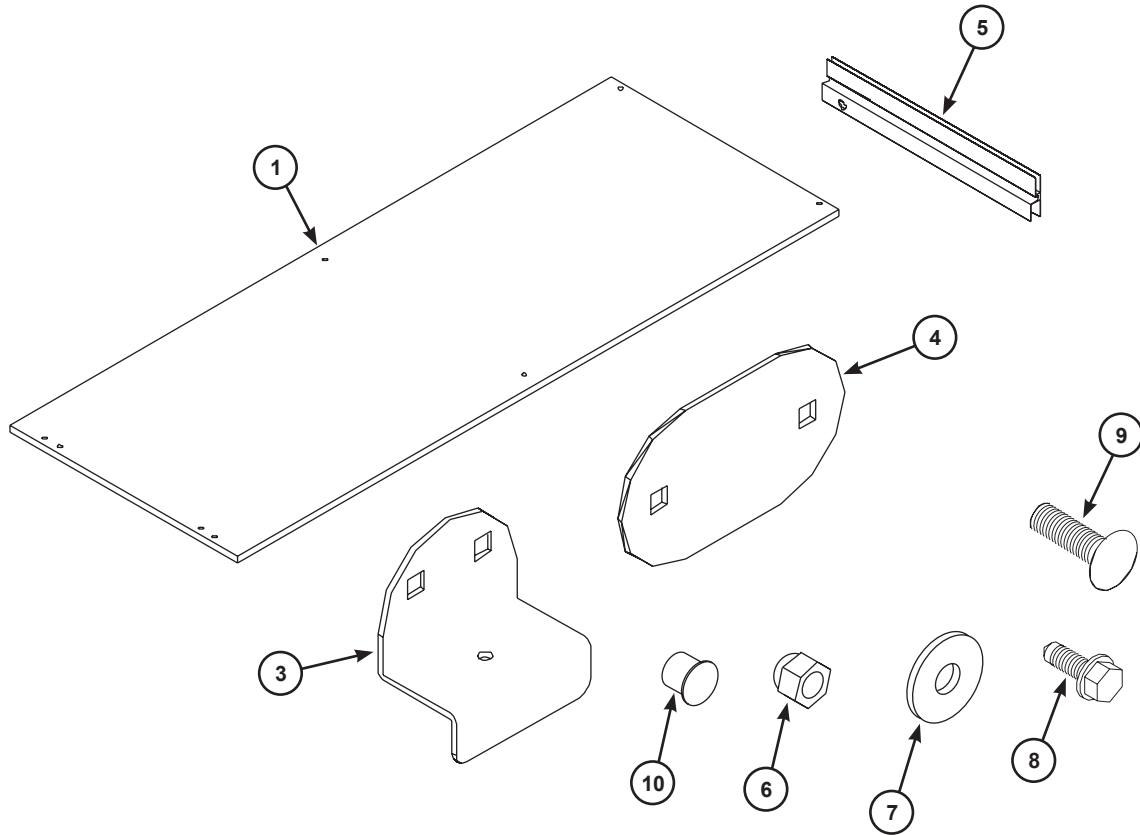

This page is intentionally blank.