

## Contents

Important User Information .....	2	Description .....	6
General .....	2	Assembly .....	7
Manufacturer .....	2	Remove Parts From the Carton .....	7
Installation .....	2	Attach the Casters .....	8
Intended Use .....	2	Assemble the End Frames .....	8
Warranty .....	2	Assemble the Wire-Grille End Panels .....	11
Safety .....	3	Assemble Handles .....	12
General .....	3	Top Panel Assembly .....	13
Installation .....	3	Parking Decals .....	14
General Use .....	3	Maintenance .....	14
Moving SportCarts .....	3	Replacement Parts .....	15
Required Tools .....	4	Chassis .....	15
Supplied Hardware .....	4	End Frame .....	15
Fasteners .....	4	Wire-Grille End Panel .....	16
Parts List .....	5	Top Panel Assembly .....	26



Visit the GearBoss SportCart web page at [gearboss.com](http://gearboss.com) for more information.

**Note:** Please read and understand these instructions before proceeding.

**Note:** If you need additional information, contact Wenger Corporation using the information below.

# ***Important User Information***

---

## ***General***

Copyright © 2024 by Wenger Corporation

All rights reserved. No part of the contents of this manual may be reproduced, copied, or transmitted in any form or by any means including graphic, electronic, or mechanical methods or photocopying, recording, or information storage and retrieval systems without the written permission of the publisher, unless it is for the purchaser's personal use.

Printed and bound in the United States of America.

The information in this manual is subject to change without notice and does not represent a commitment on the part of Wenger Corporation. Wenger Corporation does not assume any responsibility for any errors that may appear in these instructions.

In no event will Wenger Corporation be liable for technical or editorial omissions made herein, nor for direct, indirect, special, incidental, or consequential damages resulting from the use or defect of these instructions. The manufacturer reserves the right to change this product at any time.

The information in this document is not intended to cover all possible conditions and situations that might occur. The end user must exercise caution and common sense when assembling or installing Wenger Corporation products. If any questions or problems arise, call the Wenger Corporation at (800) 4WENGER (493-6437) or +1-507-455-4100 worldwide.

## ***Manufacturer***

The GearBoss SportCart™ is manufactured by:

Wenger Corporation  
555 Park Drive  
Owatonna, MN 55060  
(800) 4WENGER (493-6437) • +1 (507) 455-4100  
wengercorp.com

## ***Intended Use***

- This product is intended for indoor use in normal ambient temperature and humidity conditions — it must not be exposed to prolonged outside weather conditions.
- This product is designed to be installed only as described in these instructions.

## ***Warranty***

Warranty information is available at [wengercorp.com](http://wengercorp.com).

## Safety Precautions

---

Throughout this document you may find cautions and warnings which are defined as follows:

- **WARNING:** Failure to follow the instruction could result in serious injury or damage to property.
- **CAUTION:** Failure to follow the instruction could result in minor injury or damage to property.

Read all of these safety instructions before assembly, installation or use.

### General

#### **⚠ CAUTION**

*Make sure anyone assembling, installing or using this product has read and understands these instructions.*

#### **⚠ CAUTION**

*Failure to comply with Warnings and Cautions in this document or on the equipment can result in damage to property or injury.*

### Installation

#### **⚠ WARNING**

*Using the SportCart on floor surfaces that are not level or that have rough and uneven areas can result in a system not performing correctly. Failure to observe this caution can result in SportCart not remaining in place, not being stable, and possibly not being safe when moving.*

#### **⚠ CAUTION**

*Some assembly steps require that two or more persons work together. Some components are heavy and are difficult to handle alone.*

#### **⚠ CAUTION**

*Never stand on a SportCart.*

### General Use

#### **⚠ WARNING**

*Do not place more than a 150 lb (68 kg) uniform load onto shelves. Placing a larger load or concentrating the load can cause permanent deformation or a total collapse of the shelf. Failure to observe this warning can result in damage to property or serious injury.*

#### **⚠ WARNING**

*Do not place more than a 150 lb (68 kg) uniform load onto the SportCart Top Panel. Failure to observe this warning can result in a structural failure and inability to open and close the swing door.*

### Moving SportCart

#### **⚠ CAUTION**

*When moving the SportCart, never allow people to ride on it.*

#### **⚠ CAUTION**

*Never move the SportCart faster than a normal walking speed.*

#### **⚠ CAUTION**

*Do not place feet in the SportCart pathway, pinch points can occur.*

#### **⚠ CAUTION**

*Always move the SportCart slowly up or down an inclined ramp. Use two people to move the SportCart up or down a steep ramp or over rough surfaces.*

#### **⚠ CAUTION**

*Always move the SportCart slowly through narrow doorways. Pinch points can occur between SportCart and doorways.*

## Required Tools

---

- Electric drill
- 9/16" Combination wrench
- Mallet

## Supplied Hardware

---

### Fasteners

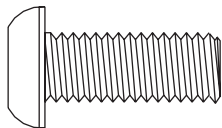

3/8-16 x 7/8"  
Button Head Screw

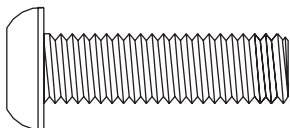

3/8-16 x 1-1/4"  
Button Head Screw

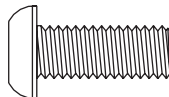

1/4-20 x 3/4"  
Button Head Screw

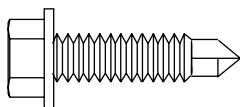

1/4-20 x 1"  
Self-drilling Screw

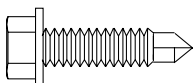

1/4-14 x 3/4"  
Self-drilling Screw

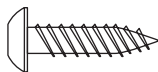

#10-16 x 3/4"  
Self-drilling Screw

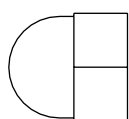

3/8-16  
Acorn Nut

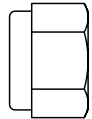

3/8-16  
Lock Nut

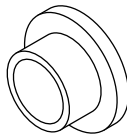

Hole Plug

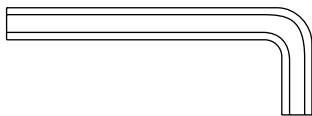

5/32"  
Allen Wrench

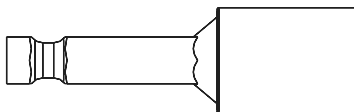

3/8"  
Hex Nut Driver Bit

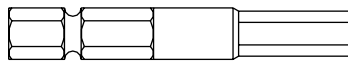

7/32"  
Hex Insert Bit

### NOTICE

*Not all hardware items packed in the carton may be needed.  
When the assembly is complete, discard any hardware items not used.*

## Parts List

### Cart

Item	Qty	Description	Item	Qty	Description
1	2	End Frame Assembly	5	2	Wire-grille End Panel
2	1	Chassis	6	4	Caster
3	3	Top Panel Extrusion Assembly	7	2	Floor Parking Decal (not shown)
4	1	Roof Panel			

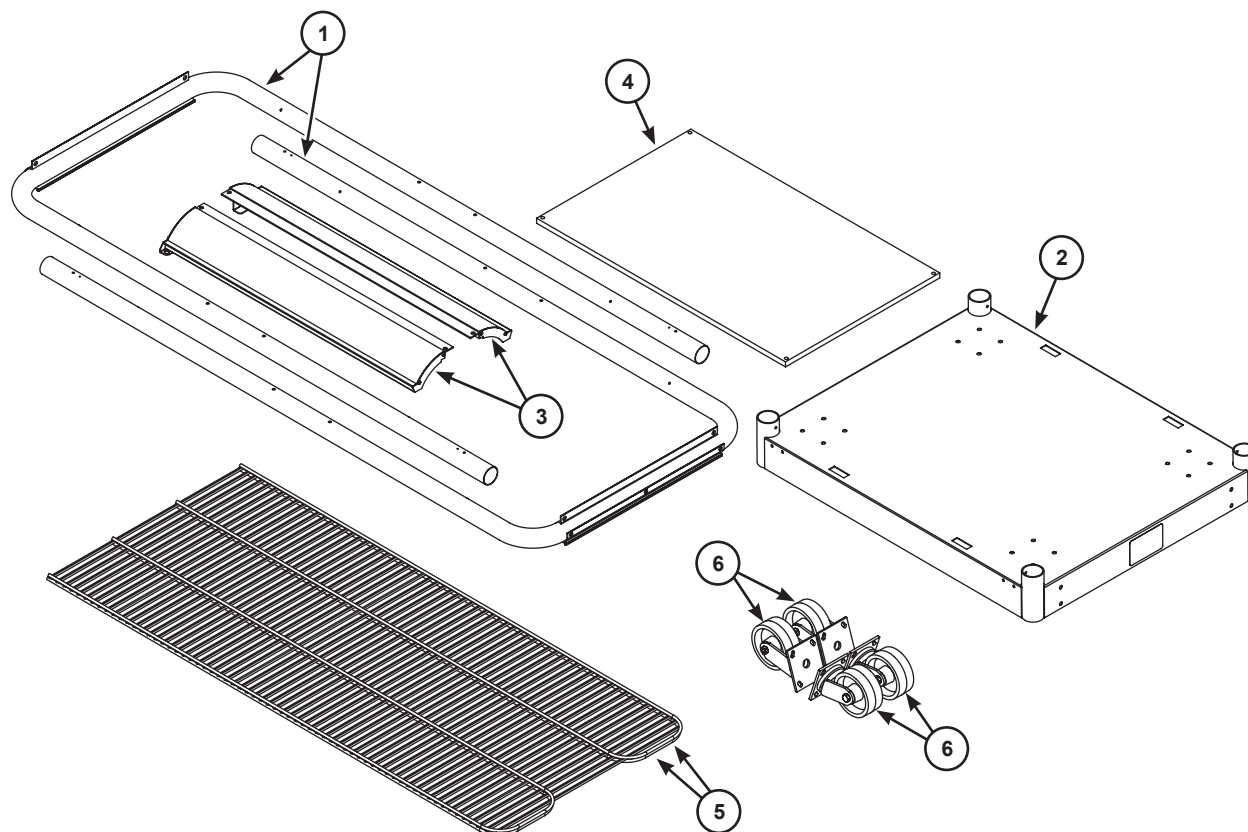

### Hardware Pack

Item	Qty	Description
1	2	Handle
2	8	Inside Half Knuckle Bracket
3	8	Outside Half Knuckle Bracket
4	5	1/4-20 x 1" Self-drilling Screw**
5	21	3/8-16** Acorn Nut
6	5	3/8-16 x 1-1/4" Button Head Screw**
7	1	3/8 Nutsetter Socket**
8	17	3/8-16 x 7/8" Button Head Screw**
9	1	Hex Insert Bit, 7/32***
10	5	1/4-20 x 3/4" Button Head Screw**
11	1	5/32" Allen Wrench**
12	4	Hole Plug**

\*\*Item is not shown, refer to Fasteners

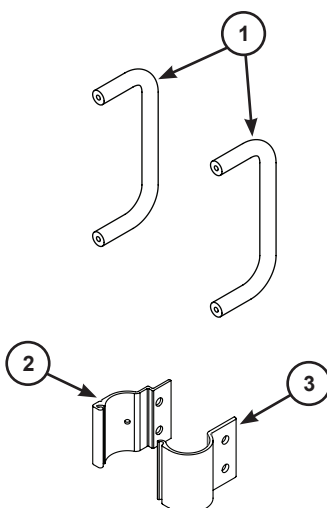

## Description

---

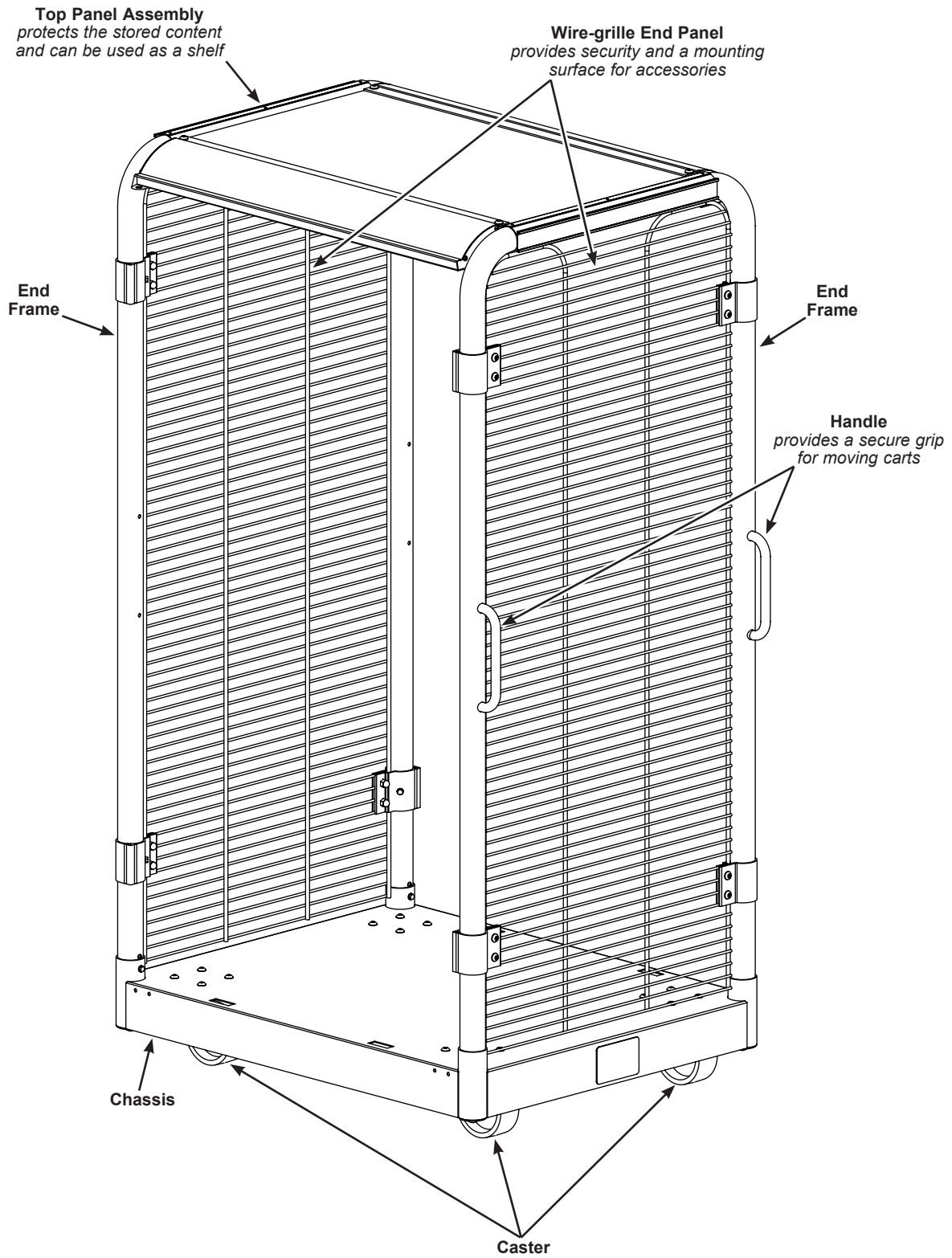

# Assembly

---

## Remove Parts From the Carton

1. Using a wheeled dolly, move the carton to the installation site or to an area where the SportCart will be assembled.

### NOTICE

***Always use a wheeled dolly to move the carton.***

2. Cut the plastic banding, remove the carton top, and discard the packing material. The carton top can be used as a work surface on the floor or on a table to prevent scratching components during assembly.
3. Remove the chassis as follows:
  - a. With two people working together, lift the chassis from the carton.
  - b. Place the chassis onto the floor upside down with the flat side resting on the floor surface.
4. Remove and inventory the hardware pack. Refer to the Parts Lists on the previous page for a list of items and part quantities.

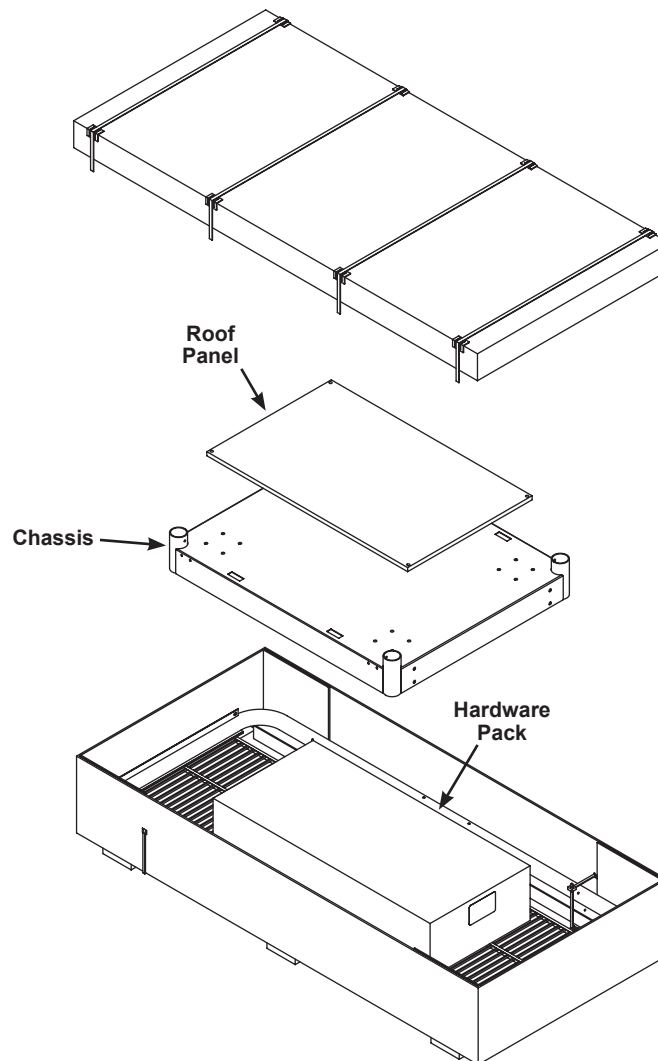

## Assembly (continued)

### Attach the Casters

1. With the chassis upside down, attach all four casters using four 3/8-16 x 7/8" button head screws and 3/8-16 lock nuts as shown.

The button head screws are inserted through the top of the chassis.

2. Turn the chassis over to rest on the casters.

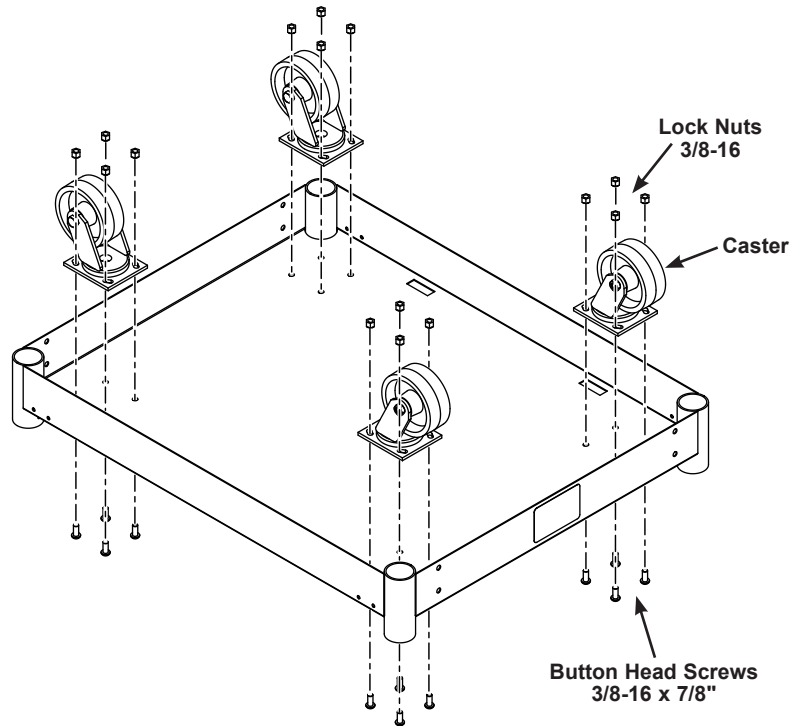

### Assemble the End Frames

1. Install a #10-16 x 3/4" pan head screw in the upper smaller hole at the inside of each end frame leg (four total) as shown.

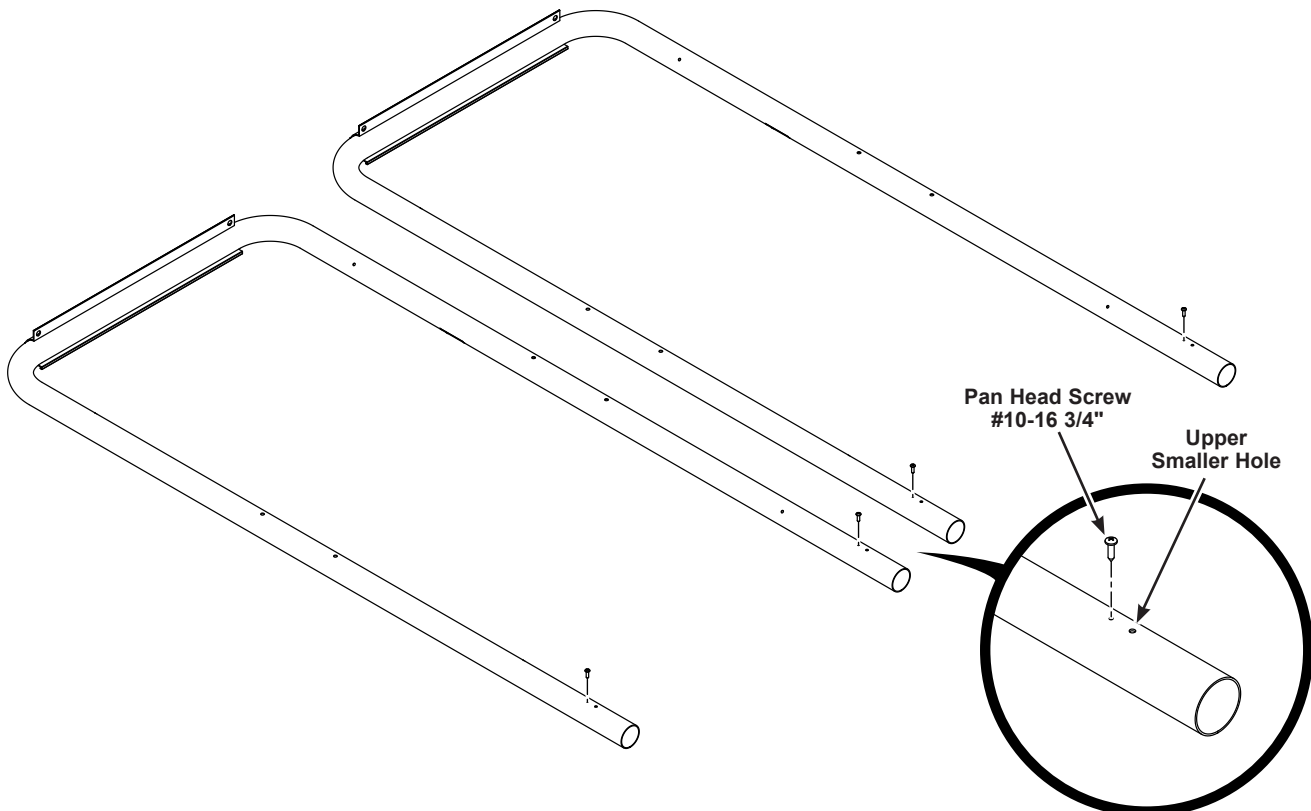



## Assembly (continued)

### Assemble the End Frames (continued)

2. Insert one end frame into the two rear chassis end frame posts.

#### **⚠ CAUTION**

***A dangerous pinch point develops when inserting an end frame into the chassis. Always take care to keep fingers from the point of insertion.***

- a. Make sure that the two screw heads on the lower part of the end frame face the inside and are pushed down onto the chassis end frame posts. The tabs on both top brackets will also face the inside.
  - b. Using a 3/8" hex nut drive bit and a drill, attach two 1/4-20 x 1" self-drilling screws to the chassis and end frame as shown below.
3. Insert the other end frame into the two front chassis end frame posts.
  - a. Make sure that the two screw heads on the lower part of the end frame face the inside and are pushed down onto the chassis end frame posts.
  - b. Using a 3/8" hex nut drive bit and a drill, attach two 1/4-20 x 1" self-drilling screws to the chassis and end frame as shown below.

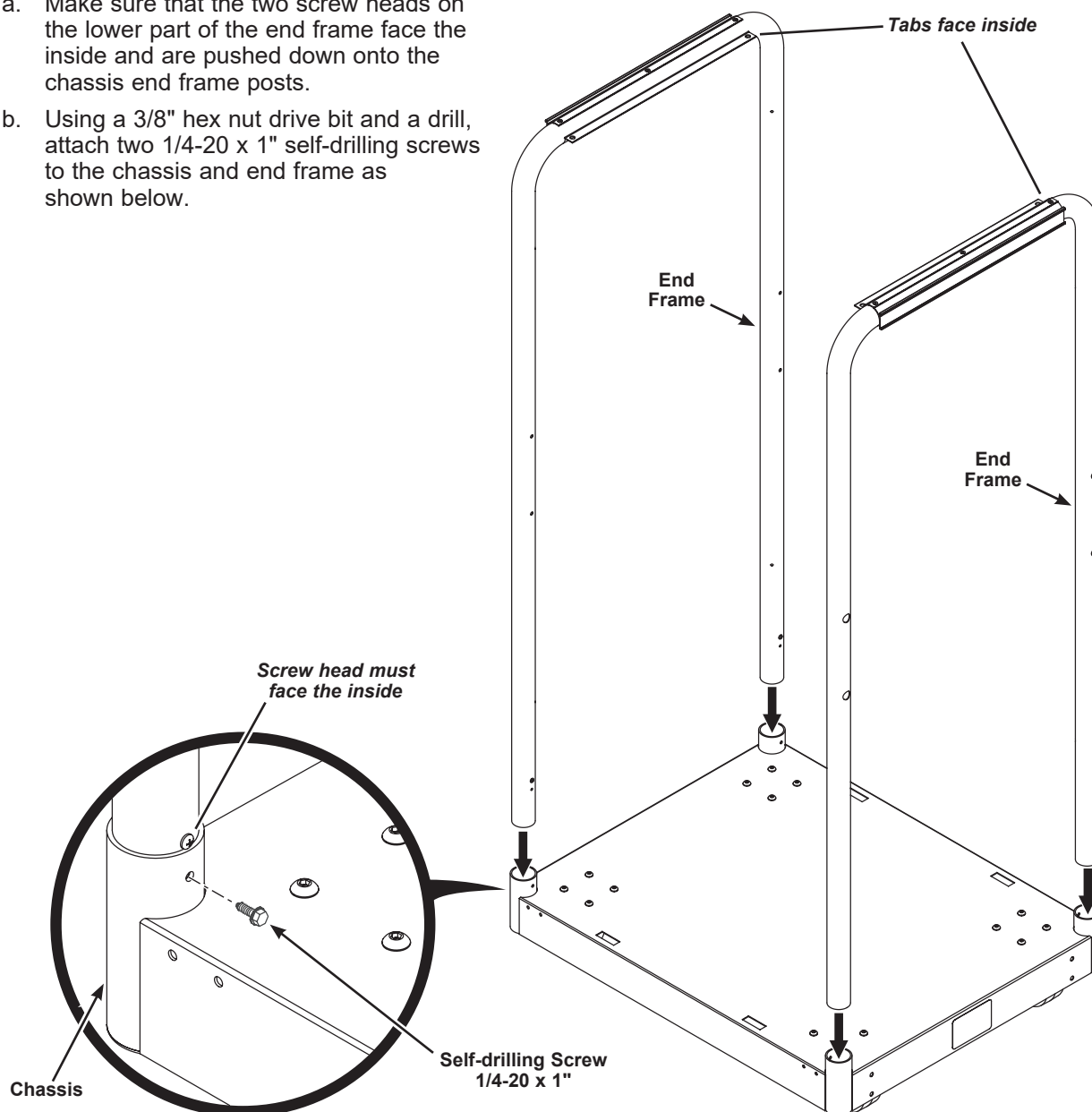

## ***Assembly (continued)***

---

### ***Assemble the End Frames (continued)***

4. Attach four inside knuckle brackets to the inside of each end frame with a 1/4-14 x 3/4" self-drilling screw as shown.

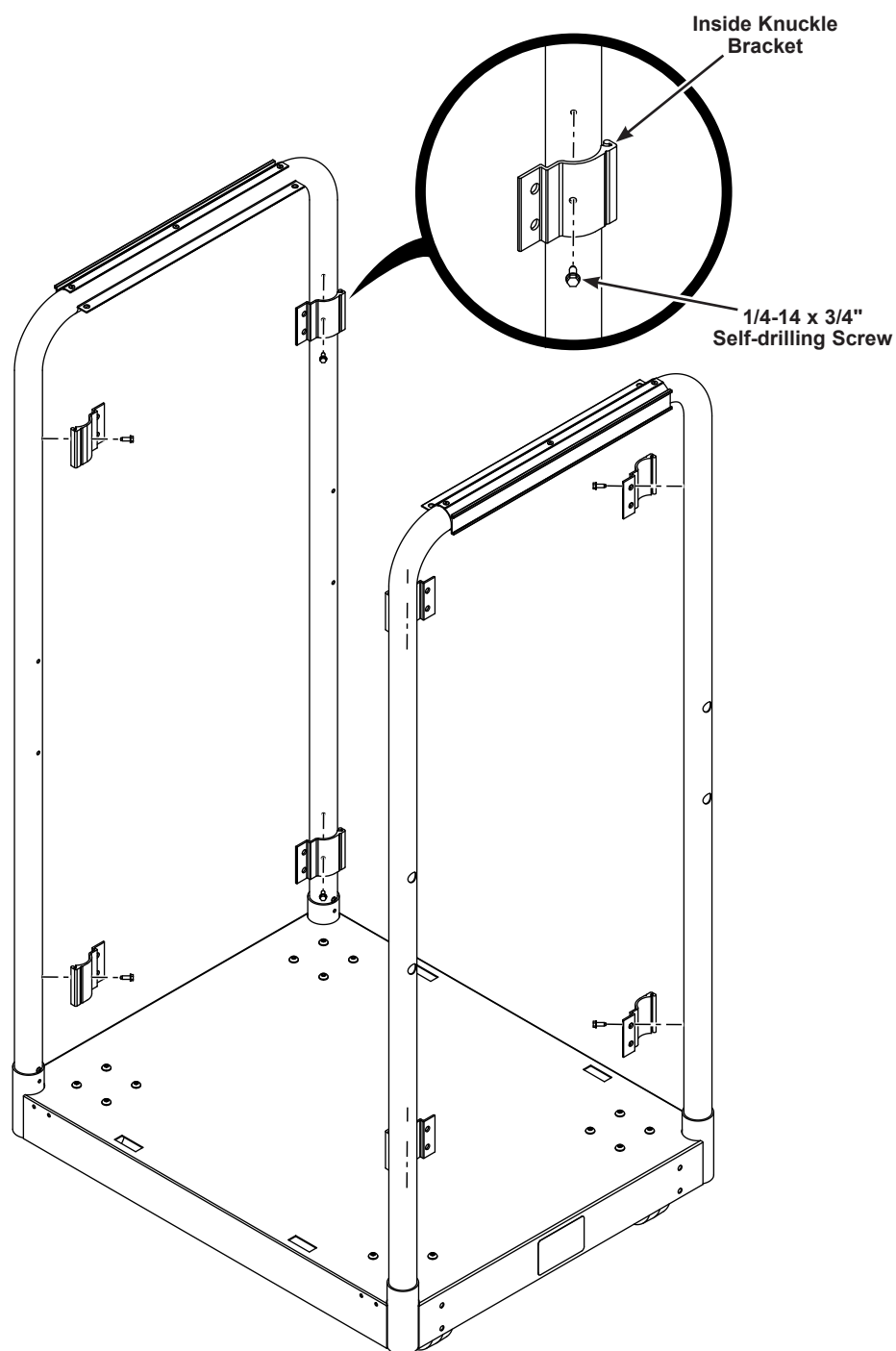

## Assembly (continued)

### Assemble the Wire-Grille End Panels

1. In the open position, rotate an outside knuckle bracket into each of the fixed upper inside knuckle brackets at the top of one of the end frames (see detail A).
2. Hold a wire-grille end panel against the upper inside knuckle brackets and lower inside knuckle brackets. Make sure that the horizontal wires face the outside of the end frame. The top wire of the wire-grille end panel should be about 1/4" from the end frame horizontal tube when correctly positioned (see detail B). Rotate the outside knuckle bracket closed.
3. With another person holding the wire-grille end panel in place, attach to the upper knuckle brackets with two 3/8-16 x 7/8" button head screws and two 3/8-16 acorn nuts in each. Make sure that the horizontal wires are aligned above and below the holes before inserting the button head screws.
4. Repeat step 1 for the bottom knuckle brackets.
5. Attach the wire-grille end panel to the lower knuckle brackets with two button head screws and two acorn nuts in each.
6. Repeat steps 1-5 to attach the wire-grille end panel to the other end frame.

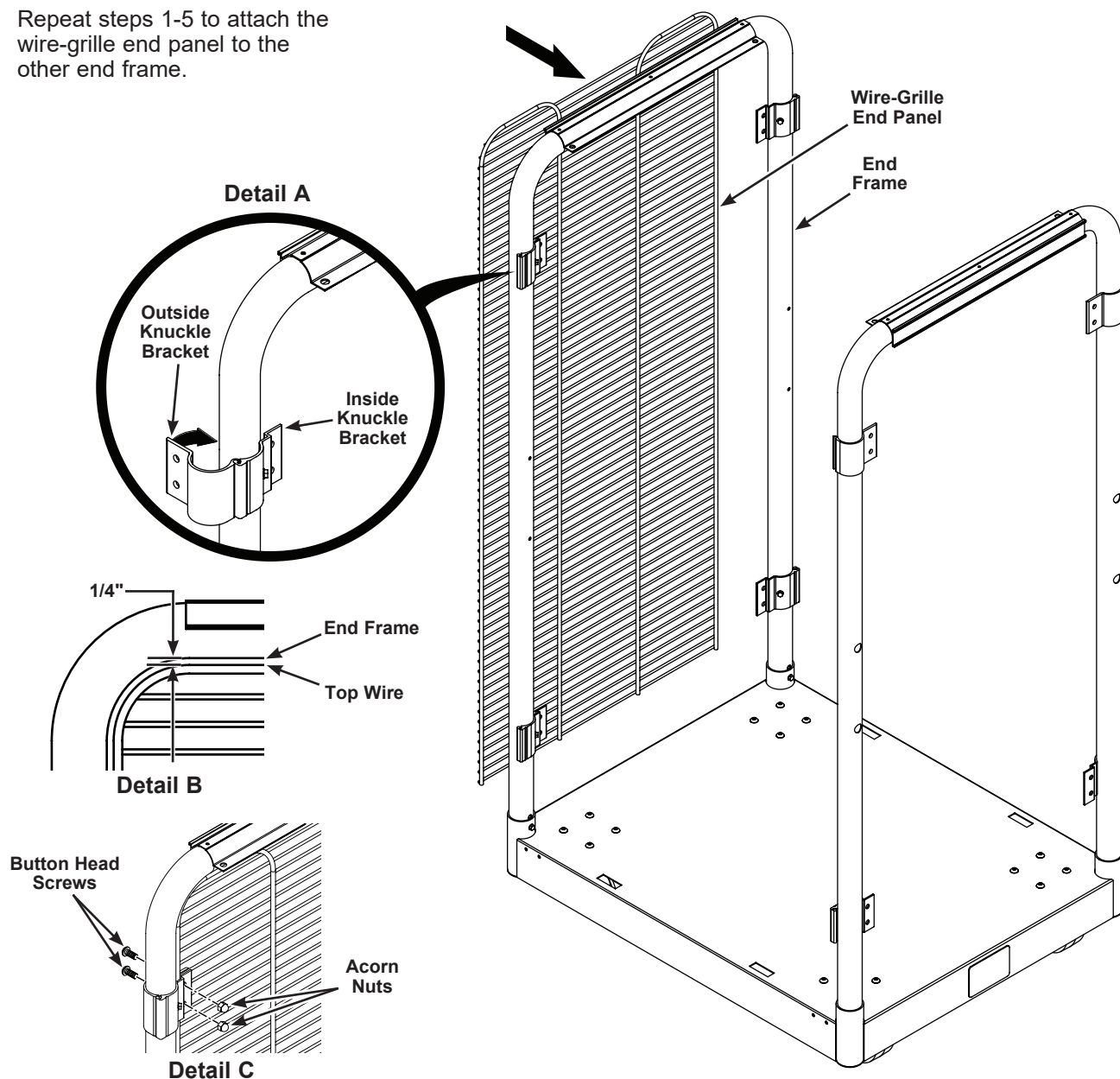

## Assembly (continued)

### Assemble Handles

1. Insert the handles into the larger holes in the outside of the end frame at the front of the SportCart.

#### NOTICE

*The front of the SportCart is the end that has the GearBoss decal attached.*

2. Secure each handle with two 1/4-20 x 3/4" button head screws.
3. Insert a plug in each of the four holes in the outside of the rear end frame.

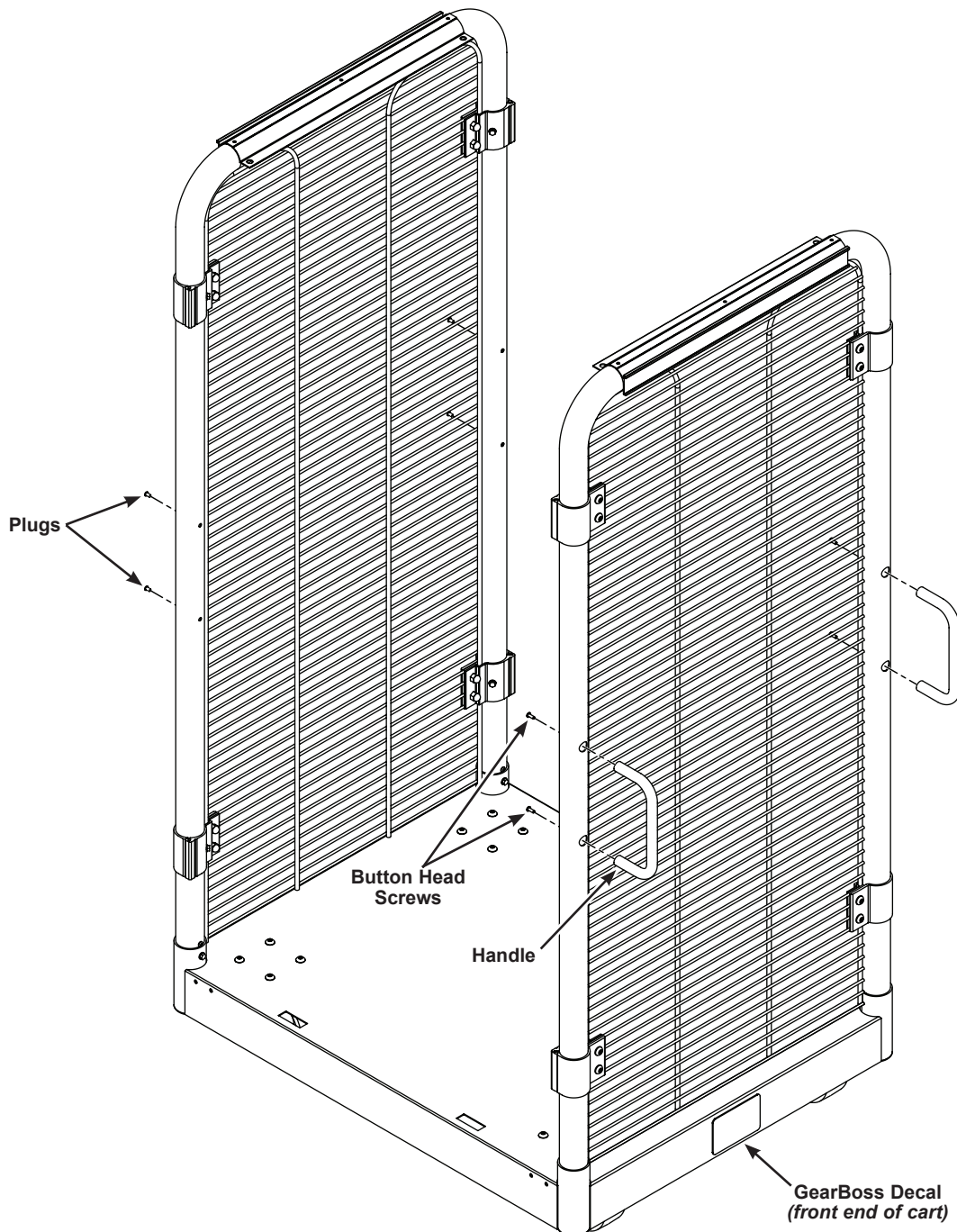

## Assembly (continued)

### Top Panel Assembly

1. With two people working together, lift the top panel and place it onto the top of the front and rear end frame support brackets. Make sure that the clearance holes in the top panel and the end frame support brackets are aligned.

#### NOTICE

*It may be necessary to use a step stool to reach the screws.*

#### CAUTION

*Never stand on the SportCart.*

2. With the door eyelets facing the rear end of the SportCart, lift each of the extrusion panels onto the top panel. Make sure that the clearance holes in the extrusion panels and the top panel are aligned.
3. Using a drill with a 7/32" hex bit and a 9/16" combination wrench, attach a 3/8-16 x 11/4" button head screw and a 3/8-16 acorn nut on each end of both extrusion panels as shown.
4. Make sure that all fasteners are tight.

The cart assembly is now complete.

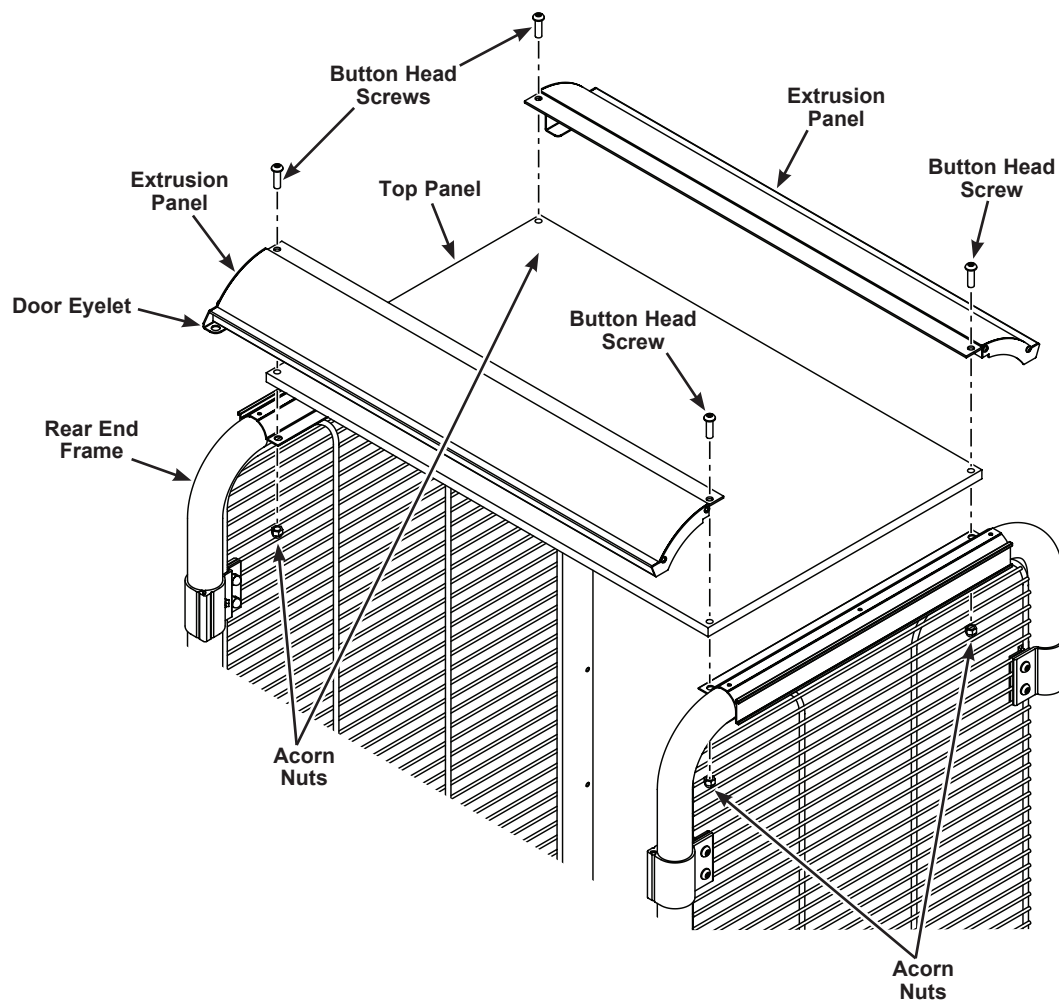

## ***Assembly (continued)***

---

### ***Parking Decals***

1. Two parking decals are included. They can be attached to a floor surface to mark a determined parking position.

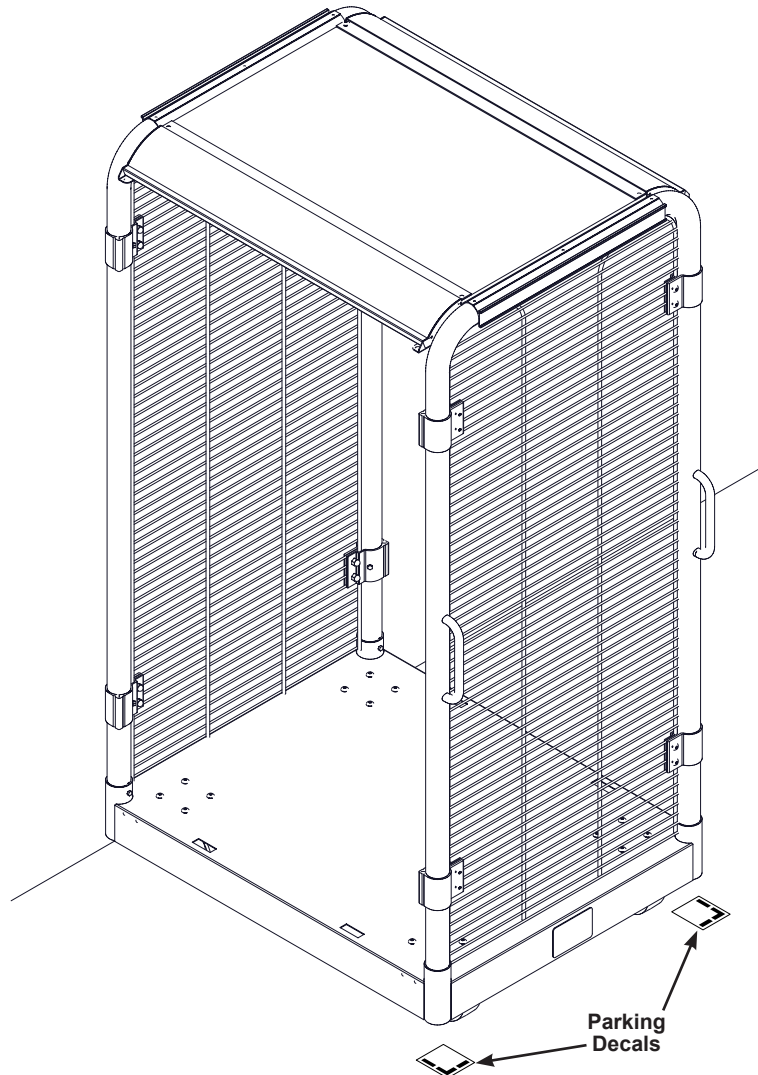

## ***Maintenance***

---

1. Keep the floor area clear of dirt and trash.
2. Clean the surfaces with a mild detergent. Do not use harsh abrasive cleaning products.
3. Make sure that all fasteners are tight.
4. Replace any damaged parts such as wheels, casters, or fasteners immediately.

# Replacement Parts

## Chassis

Item	Description
1	Chassis
2	Button Head Screw, 3/8-16 x 3/4"
3	Self-drilling Screw, 1/4-20 x 1"
4	Caster
5	Hex Nut, 3/8-16

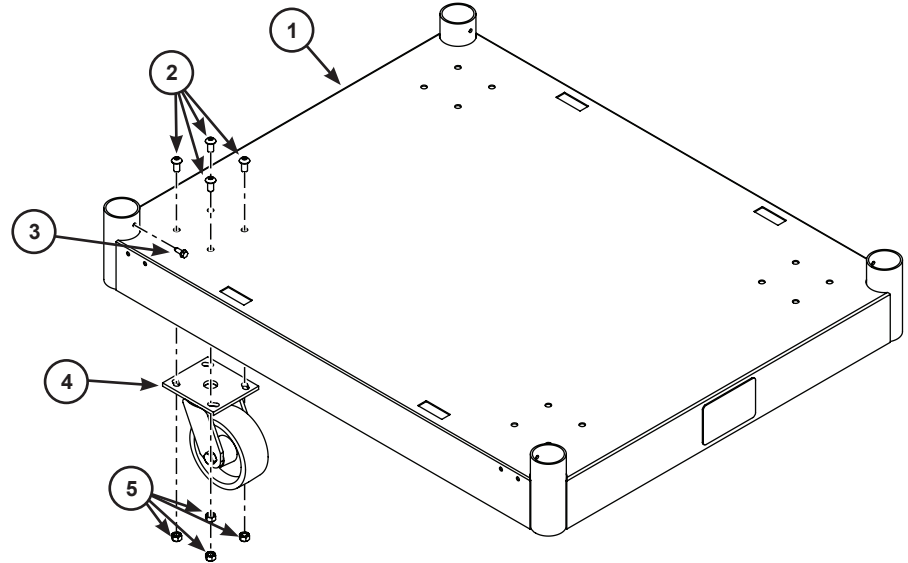

## End Frame

Item	Description
1	End Frame
2	Handle
3	1/4-20 x 3/4" Button Head Screw
4	3/8-16 x 7/8" Button Head Screw
5	Outside Bracket
6	Inside Bracket
7	3/8-16 Acorn Nut
8	1/4-14 x 1" Self-drilling Screw
9	Top Extrusion
10	Plug

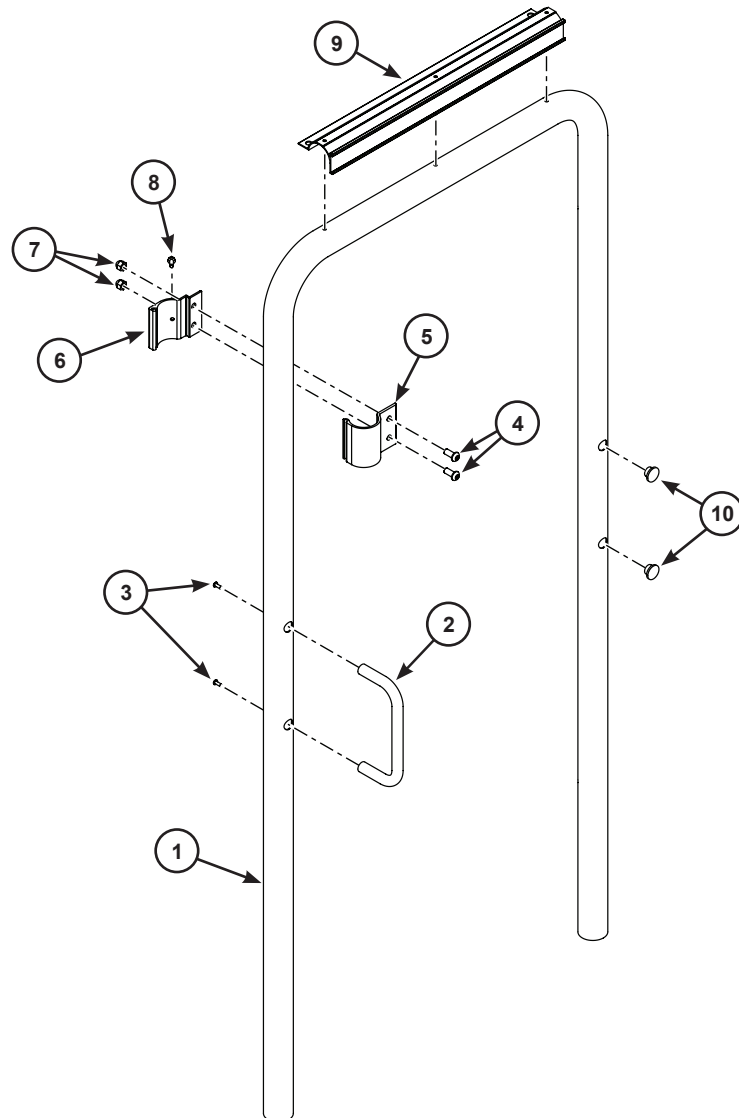

# Replacement Parts (continued)

## Wire-Grille End Panel

Item	Description
1	Wire-Grille End Panel

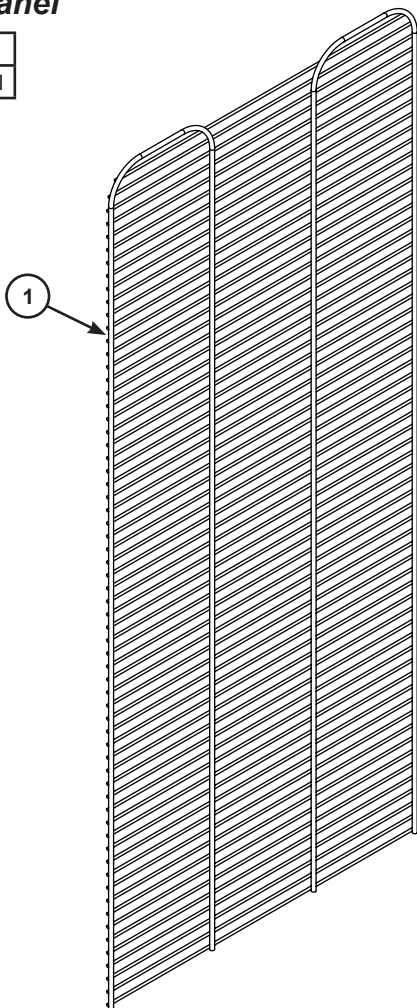

## Top Panel Assembly

Item	Description
1	Top Panel
2	Top Panel Extrusion Assembly
3	3/8-16 x 1-1/4" Button Head Screw
4	3/8-16 Acorn Nut

