

Light Duty Blocks

- For use in light duty applications such as supporting fire lines.
- 3" (76 mm) diameter steel sheaves with ball bearing.
- Formed steel base allows vertical or horizontal mounting.
- Available with 3/8" (9.5 mm) or 1/8" (3.175 mm) groove.



Light Duty Block
013-175

Dimensions

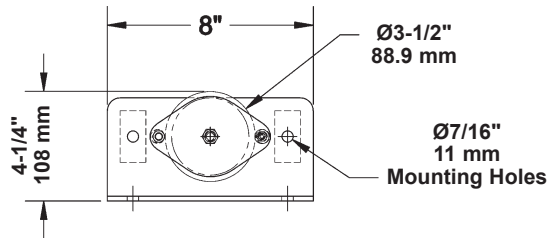
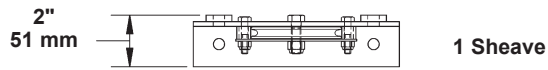
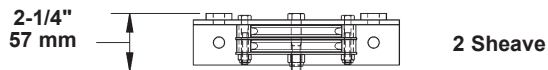
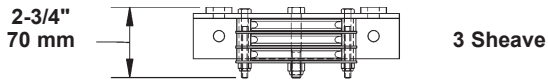

Order Information

Number	Description	RWL	Weight
Grooved for 3/8" (9.5 mm) Rope			
013-175	3" (76 mm, 1 Sheave for 3/8" (9.5 mm) Rope	50 lbs. (27.6 kg)	3.5 lbs. (1.6 kg)
013-275	3" (76 mm, 2 Sheave for 3/8" (9.5 mm) Rope	100 lbs. (45.3 kg)	3.5 lbs. (1.6 kg)
013-375	3" (76 mm, 3 Sheave for 3/8" (9.5 mm) Rope	150 lbs. (68 kg)	3.5 lbs. (1.6 kg)
Grooved for 1/8" (3.175 mm) Rope			
013-176	3" (76 mm, 1 Sheave for 1/8" (3 mm) Rope	50 lbs. (27.6 kg)	3.5 lbs. (1.6 kg)
013-276	3" (76 mm, 2 Sheave for 1/8" (3 mm) Rope	100 lbs. (45.3 kg)	3.5 lbs. (1.6 kg)
013-376	3" (76 mm, 3 Sheave for 1/8" (3 mm) Rope	150 lbs. (68 kg)	3.5 lbs. (1.6 kg)
RWL: RWL is maximum load that can be applied to a block which is in "like new" condition and has been properly installed, maintained, and operated.			



© 2017 Wenger Corporation
USA/2017-12/W

