

Shackles

- Drop forged anchor shackles meet the performance requirement of Federal Specification RR-C-271D type IVA.
- Shackles have a hot galvanized finish.

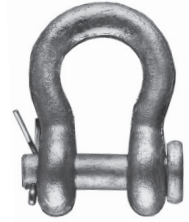

Round Pin,
Anchor Shackle

Dimensions

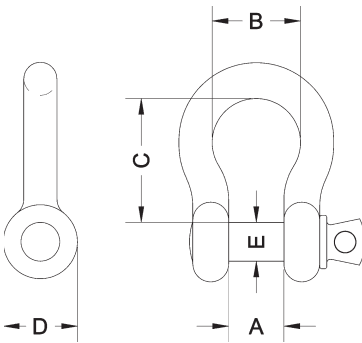

Number	Dim. A	Dim. B	Dim. C	Dim. D	Dim. E
019-A187	3/16" (4.76 mm)	9/16" (14.3 mm)	7/8" (22.2 mm)	5/8" (15.8 mm)	1/4" (6.35 mm)
019-A250	15/32" (11.9 mm)	3/4" (19 mm)	1-1/8" (28.5 mm)	3/4" (19 mm)	5/16" (7.9 mm)
019-A312	17/32" (13.5 mm)	15/16" (23.8 mm)	1-1/4" (31.75 mm)	7/8" (22.2 mm)	3/8" (9.5 mm)
019-A375	21/32" (16.67 mm)	1-1/8" (28.5 mm)	1-7/16" (36.5 mm)	1" (25.4 mm)	7/16" (11.1 mm)

Order Information

Number	Description	RWL	Weight
Round Pin Shackles			
019-A187R	3/16" (4.76 mm) Round Pin Forged Anchor Shackle	666 lbs. (302 kg)	0.07 lb. (0.03 kg)
019-A250R	1/4" (6.35 mm) Round Pin Forged Anchor Shackle	1000 lbs. (454 kg)	0.14 lb. (0.06 kg)
019-A312R	5/16" (7.9 mm) Round Pin Forged Anchor Shackle	1500 lbs. (680 kg)	0.22 lb. (0.09 kg)
019-A375R	3/8" (9.5 mm) Round Pin Forged Anchor Shackle	2000 lbs. (907 kg)	0.33 lb. (0.15 kg)
Screw Pin Shackles			
019-A187S	3/16" (4.76 mm) Screw Pin Forged Anchor Shackle	666 lbs. (302 kg)	0.07 lb. (0.03 kg)
019-A250S	1/4" (6.35 mm) Screw Pin Forged Anchor Shackle	1000 lbs. (454 kg)	0.14 lb. (0.06 kg)
019-A312S	5/16" (7.9 mm) Screw Pin Forged Anchor Shackle	1500 lbs. (680 kg)	0.22 lb. (0.09 kg)
019-A375S	3/8" (9.5 mm) Screw Pin Forged Anchor Shackle	2000 lbs. (907 kg)	0.33 lb. (0.15 kg)
RWL is based on the manufacturer's 6:1 safety factor.			



© 2017 Wenger Corporation
USA/2017-12/W

