

Turnbuckles

- Used for batten trimming or tensioning lines.
- Drop forged turnbuckles meeting the requirements of ASTM F1145-92, Type 1, Grade 1, made in the U.S.
- Hot galvanized finish.
- Other types and sizes are available on special order.

Dimensions

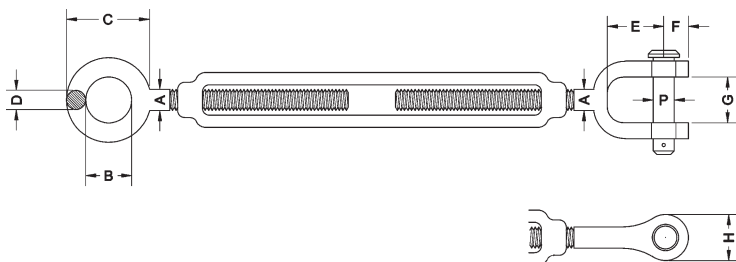

Turnbuckle
032-221J&E

Number	Dim. A	Dim. B	Dim. C	Dim. D	Dim. E	Dim. F	Dim. G	Dim. H	Dim. P	Closed Length
032-220J&E	5/16" (7.9 mm)	5/8" (15.875 mm)	1-1/4" (31.75 mm)	9/32" (7.1 mm)	7/8" (22 mm)	5/16" (7.9 mm)	15/32" (11.9 mm)	5/8" (15.87 mm)	1/4" (6 mm)	9-1/8" (232 mm)
032-221J&E	3/8" (9.5 mm)	3/4" (19 mm)	1-1/2" (38 mm)	11/32" (8.7 mm)	1" (25 mm)	13/32" (10 mm)	1/2" (12.7 mm)	13/16" (20.6 mm)	5/16" (7.9 mm)	11-1/2" (292 mm)
032-221J&J	3/8" (9.5 mm)	—	—	—	1" (25 mm)	13/32" (10 mm)	1/2" (12.7 mm)	13/16" (20.6 mm)	5/16" (7.9 mm)	11-1/2" (292 mm)
032-222J&E	1/2" (12.7 mm)	1" (25 mm)	2" (50.8 mm)	7/16" (11 mm)	1-9/32" (32.5 mm)	1/2" (12.7 mm)	5/8" (15.87 mm)	1" (25 mm)	7/16" (11 mm)	13-1/4" (337 mm)
032-223J&E	1/2" (12.7 mm)	1" (25 mm)	2" (50.8 mm)	7/16" (11 mm)	1-9/32" (32.5 mm)	1/2" (12.7 mm)	5/8" (15.87 mm)	1" (25 mm)	7/16" (11 mm)	19-1/4" (489 mm)
032-224J&E	5/8" (15.875 mm)	1-1/4" (31.75 mm)	2-5/16" (58.73 mm)	17/32" (13.5 mm)	1-21/32" (42 mm)	21/32" (16.67 mm)	7/8" (22 mm)	1-5/16" (33 mm)	1/2" (12.7 mm)	14-5/8" (371 mm)

Order Information

Number	Description	RWL	Weight
032-220J&E	5/16" x 4-1/2" (7.9 mm x 114 mm) Jaw & Eye Turnbuckle	800 lbs. (362 kg)	0.5 lb. (0.2 kg)
032-221J&E	3/8" x 6" (9.5 mm x 152 mm) Jaw & Eye Turnbuckle	1200 lbs. (544 kg)	1 lb. (0.45 kg)
032-221J&J	3/8" x 6" (9.5 mm x 152 mm) Jaw & Eye Turnbuckle	1200 lbs. (544 kg)	1 lb. (0.45 kg)
032-222J&E	1/2" x 6" (12.7 mm x 152 mm) Jaw & Eye Turnbuckle	2200 lbs. (1000 kg)	2 lbs. (0.9 kg)
032-223J&E	1/2" x 12" (12.7 mm x 305 mm) Jaw & Eye Turnbuckle	2200 lbs. (1000 kg)	2 lbs. (0.9 kg)
032-224J&E	5/8" x 6" (15.875 mm x 152 mm) Jaw & Eye Turnbuckle	3500 lbs. (1587 kg)	2.6 lbs. (1.18 kg)

RWL is based on the manufacturer's 5:1 safety factor.



© 2017 Wenger Corporation
USA/2017-12/W



WENGER CORPORATION Phone 800.4WENGER (493-6437) Worldwide +1.507.455.4100 | Fax 507.455.4258 Worldwide +1.507.774.8576
Parts & Service 800.887.7145 | Canada Office 800.268.0148 | Web wengercorp.com | 555 Park Drive, PO Box 448 | Owatonna | MN 55060-0448

JR CLANCY Phone 800.836.1885 Worldwide +1.315.451.3440 | Fax 877.836.1885 Worldwide +1.315.451.1766 | Web jrclancy.com
7041 Interstate Island Road | Syracuse | NY 13209-9713

GEARBOSS Phone 800.493.6437 | email gearboss@wengercorp.com | Web gearboss.com | 555 Park Drive, PO Box 448 | Owatonna | MN 55060-0448