



Height Adjustment Instructions Conductor's Chair

Height Adjustment Instructions only!
For more detailed product information, refer to the
Conductor's Chair Assembly Instructions 157C002.

7/16" Open-end wrench and 1/8" Allen wrench required.

1. Lay the chair on its side and separate the seat from the base.
Set all loose components aside for reassembly.

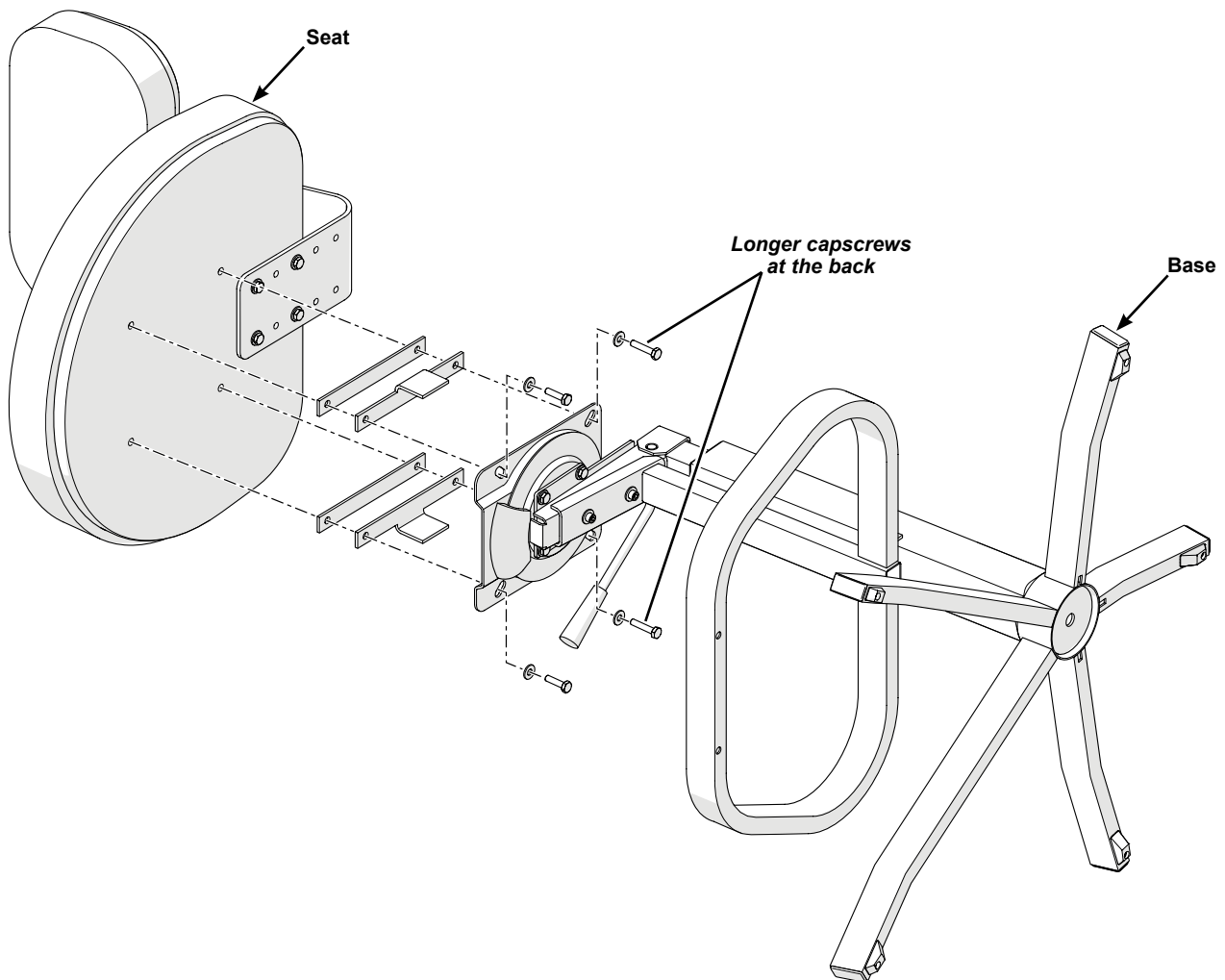

Note: Please read and understand these instructions before adjusting.

Note: If you need additional information, contact Wenger Corporation using the information below.

2. Tip the base upright and locate the adjustment screw.
3. Use a 1/8" allen wrench to turn the adjustment screw.
Turn the screw clockwise to allow less adjustment lever movement.
Turn the screw counter-clockwise to allow more adjustment lever movement.
4. Test the height adjustment lever for proper operation and reattach the seat to the base.
Be sure that the longer capscrews are attached at the back of the seat.

