

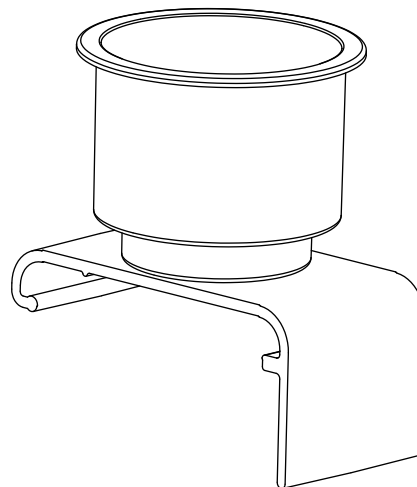

Assembly Instructions Cupholder Accessory for Flex® TechBridge

**Basic Instructions to be used with the Cupholder Accessory for Flex® TechBridge only!
For othe component information, refer to the Flex TechBridge Owner's Manual 236A153.**



**Cupholder
Accessory**

Parts List

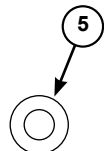
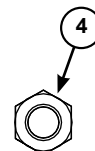
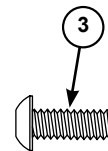
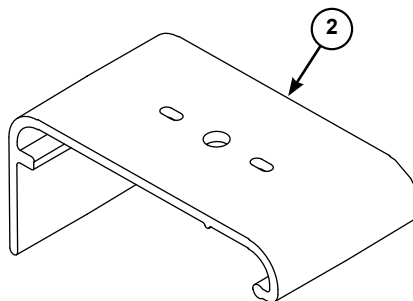
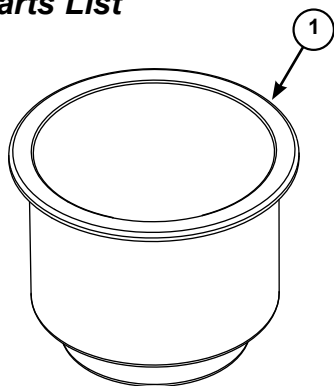

Item	Qty	Description	Item	Qty	Description
1	1	Cupholder	4	2	Nylon Lock Nut, #10-24
2	1	Bridge Clip	5	2	Flat Washer, 0.188 ID x 0.734 OD"
3	2	Machine Screw, #10-24 x 5/8"			

Note: Please read and understand these instructions before assembling.

Note: If you need additional information, contact Wenger Corporation using the information below.

Assembly

1. Attach the cupholder (1) to the bridge clip (2) using two #10-24 x 5/8" machine screws (3), two 0.188 ID x 0.734 OD flat washers (5) and two #10-24 nylon lock nuts (4) as shown.

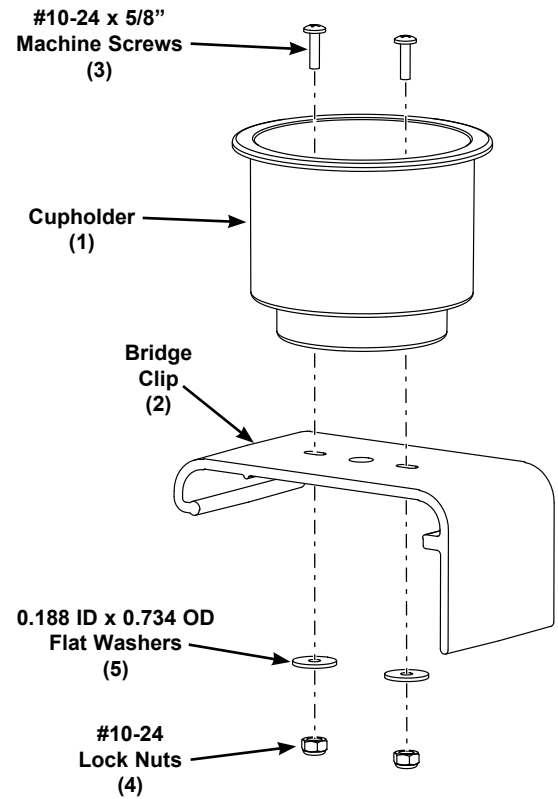

2. Attach the assembled cupholder to the bridge extrusion by inserting the short side of the bridge clip into the outside groove. Press down to snap the long side of the bridge clip into place.
3. To reposition or remove the cupholder, release the bridge clip by pulling on the release handle (long side of the clip) and rotate forward.

