

7-Shelf Oblique Unit is shown.
6-Shelf Oblique Unit assembly is the same.

Contents

Required Tools	2
Hardware Parts List	2
Oblique File System Components	3
Oblique File System Unit Assembly	4



Visit the Music Library System web page at www.wengercorp.com for more details.

Note: Please read and understand the instructions before starting the assembly or installation.
Note: If you need additional information, contact Wenger Corporation using the information below.

Assemble the Guide Frames as indicated in “Guide Frame Assembly” of the original instructions before assembling the Shelf Units with the Oblique File System Accessory.

When finished, refer back to the last page of “Final System Assembly” in the original instructions to finish assembling the Music Library System.

These Assembly Instructions detail a 7-Shelf Oblique Unit assembly. The assembly of a 6-Shelf Oblique Unit is the same.

Required Tools

- Phillips Screwdriver or Drill Bit
- 7/16” Open End Wrench
- Hammer
- Power Drill with 1/8” Drill Bit
- 5/32” Hex Insert Bit (included in Hardware Pack)

Hardware Parts List

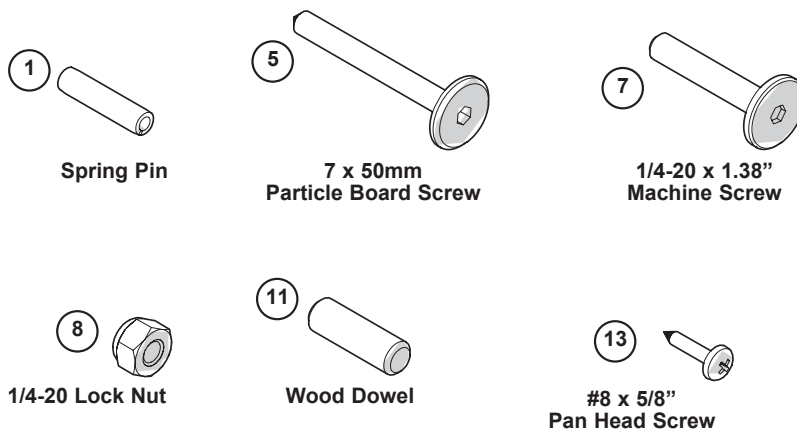

***Fasteners applied to the Front Panel may be colored to match the edge banding of the system.**

Shelf Unit Components

Item	Description
2	Side Panel
3	Top Panel
4	Back Panel
6	Corner Gusset
9	Front Panel
10	Base Assembly
12	Oblique File Support Frame

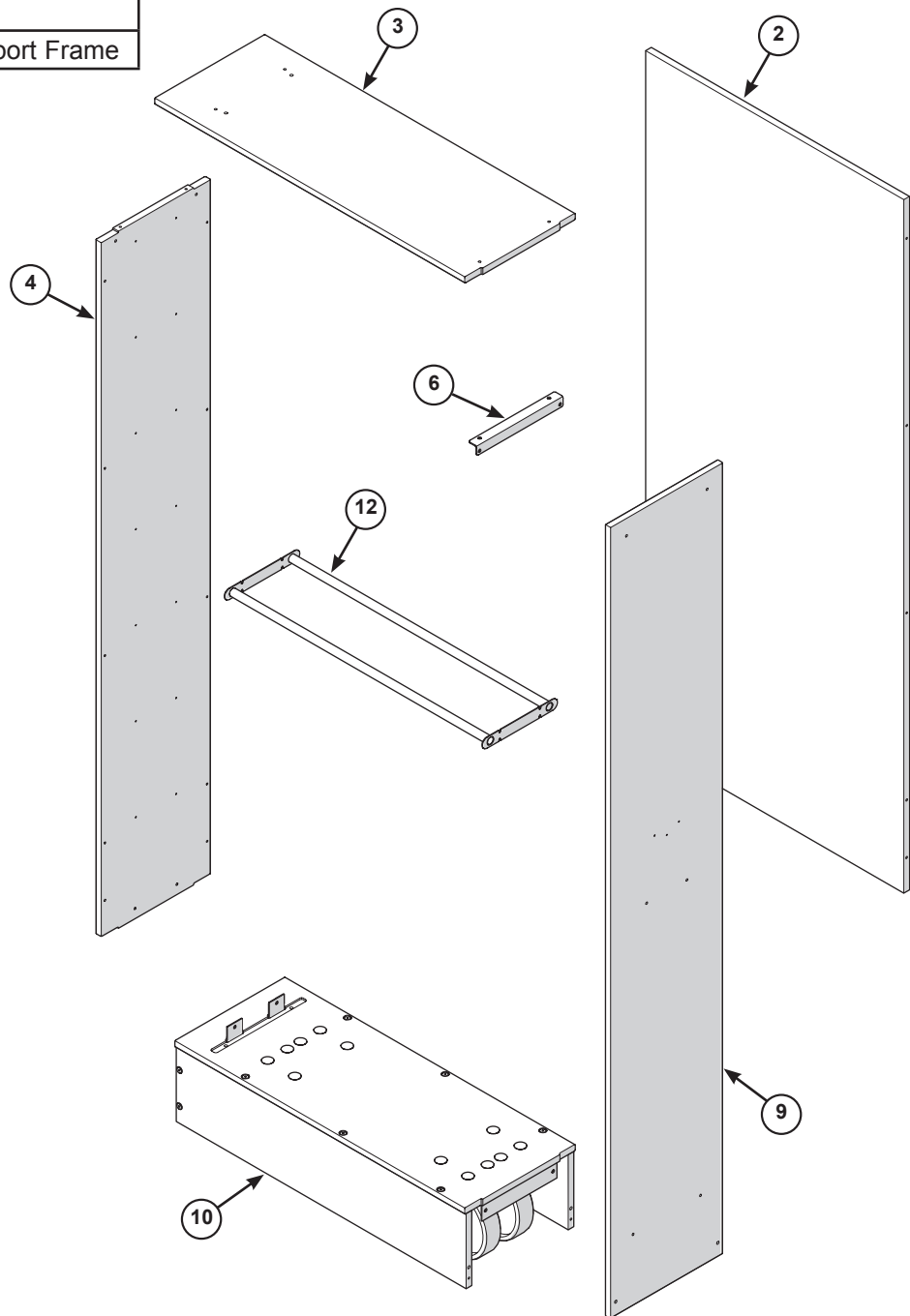

Oblique File System Unit Assembly Assembly

1. Install five Spring Pins (1) into both sides of the Side Panel (2).
The bottom of the Side Panel has two Spring Pins closer together.

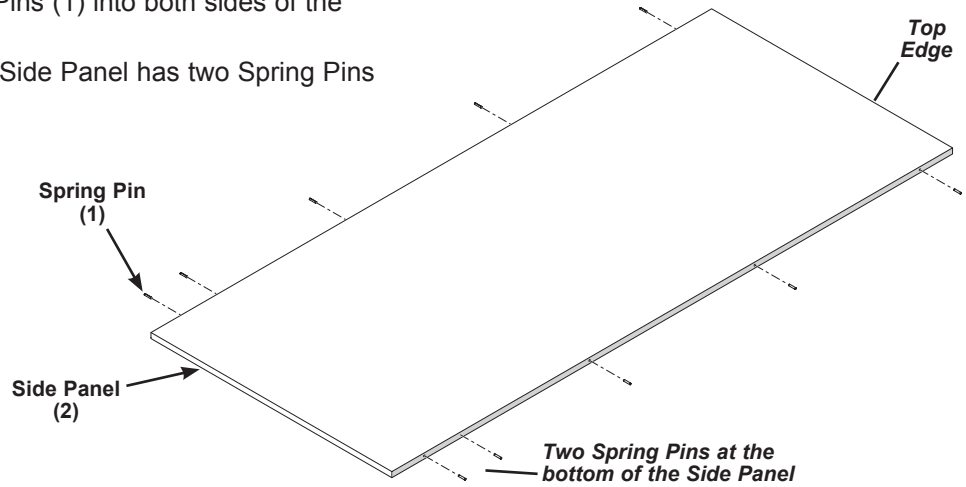

2. Attach the Top Panel (3) to the Back Panel (4) using two 7 x 50mm Particle Board Screws (5).
The notch at the top of the Back Panel fits into the cutout in the Top Panel.

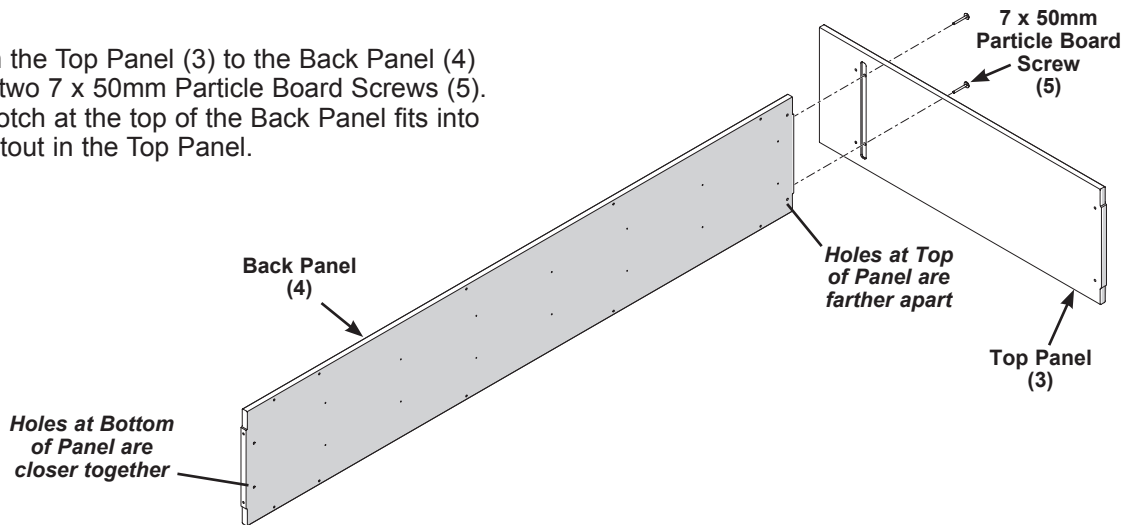

3. Attach a Corner Gusset (6) to the Top and Back Panels using four 1/4-20 x 1.38" Machine Screws (7) and 1/4-20 Lock Nuts (8).

Note that Lock Nuts all face each other.

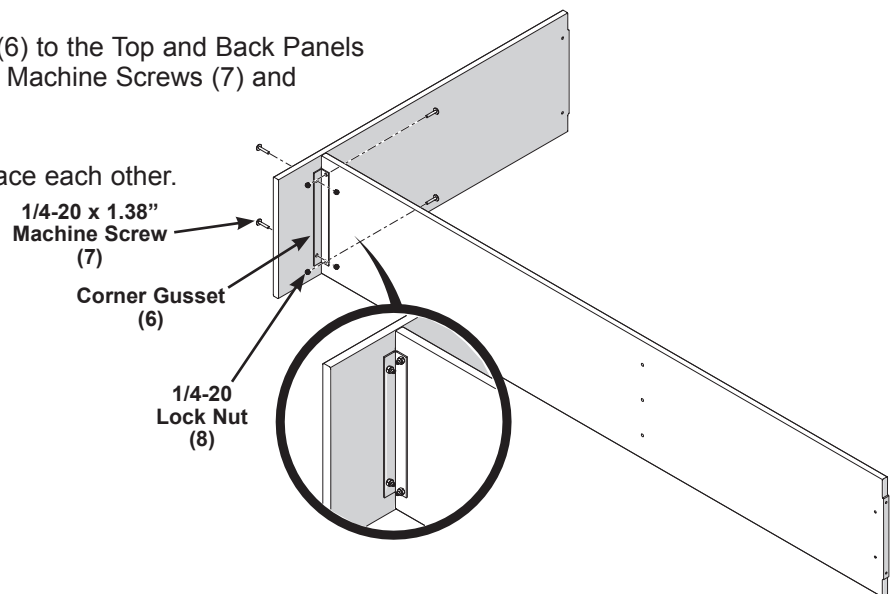

Oblique File System Unit Assembly (continued)

4. Determine if the Shelf Unit will be assembled for either Left Side Access or Right Side Access.

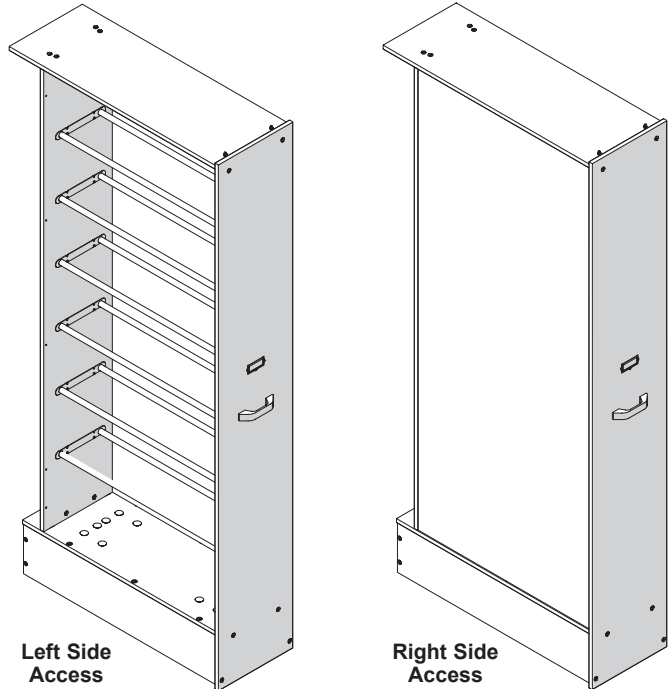

5. Align the double set of Spring Pins in the Side Panel with the double set of holes in the Back Panel and slide them together until all panels are touching.
- Cardboard from the packaging may be placed under the Side Panel to elevate it high enough to align the Spring Pins with the holes in the Front Panel. Slide the Spring Pins in the Side Panel into the holes in the Back Panel until all panels are touching.

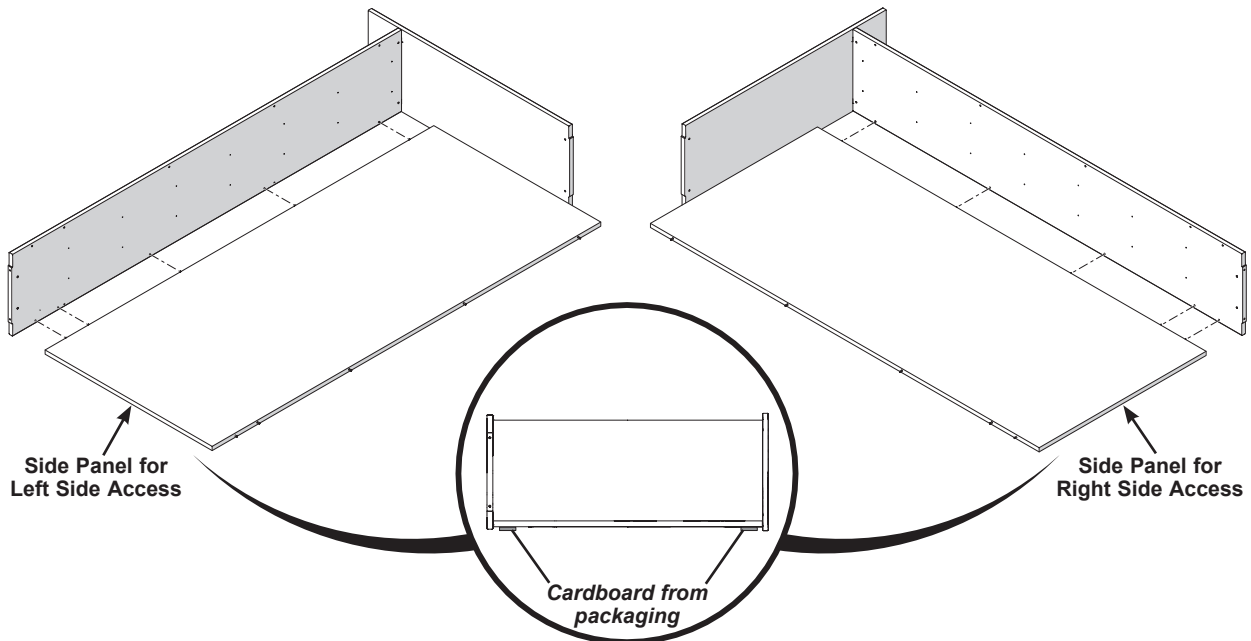

The remaining instructions detail the assembly for left side access. Right side access assembly is identical, just on the reverse side.

Oblique File System Unit Assembly (continued)

6. Attach the Front Panel (9) to the Side Panel by aligning the double set of Spring Pins in the Side Panel with the double set of holes in the Front Panel.

Cardboard from the packaging may be placed under the Side Panel to elevate it high enough to align the Spring Pins with the holes in the Front Panel.

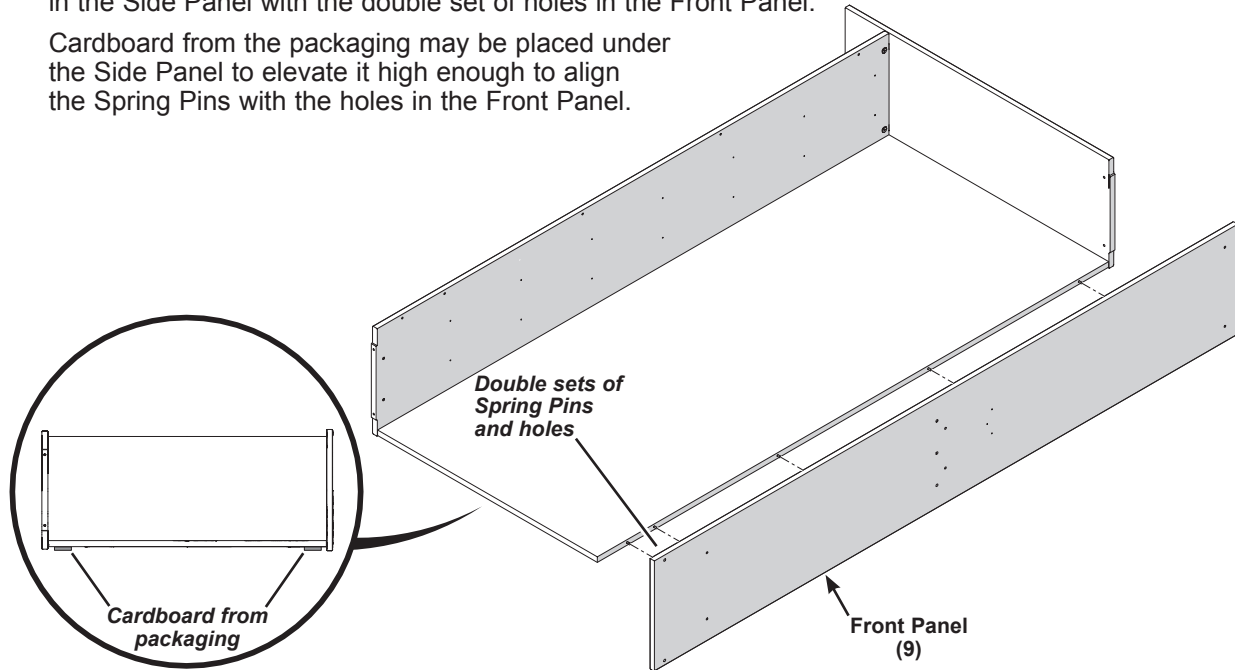

7. Attach a Corner Gusset (6) to the Top and Front Panels using four 1/4-20 x 1.38" Machine Screws (7) and 1/4-20 Lock Nuts (8).

Note that Lock Nuts face inside on the Front Panel and face outside on the Top Panel.

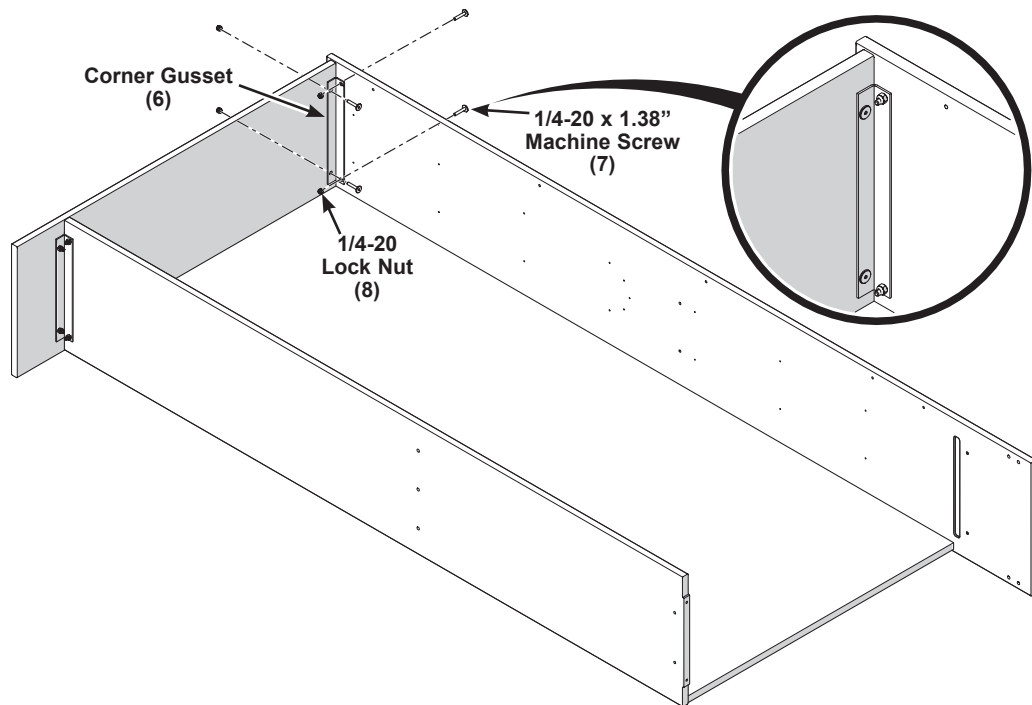

Oblique File System Unit Assembly (continued)

8. Attach the Base Assembly (10) to the Front Panel.
 - a. Use two Wood Dowels (11).

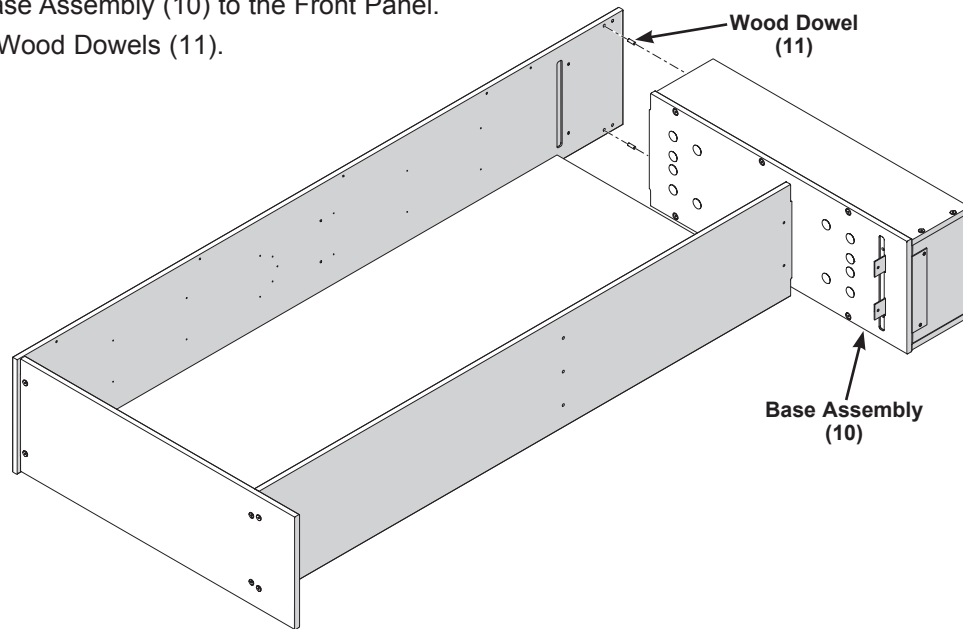

- b. Attach the Base Assembly to the Front Panel using two 7 x 50mm Particle Board Screws (5) and two 1/4-20 x 1.38" Machine Screws (7) with 1/4-20 Lock Nuts (8).
 - c. Attach the Base Assembly to the Back Panel using two 7 x 50mm Particle Board Screws (5) and two 1/4-20 x 1.38" Machine Screws (7) with 1/4-20 Lock Nuts (8).

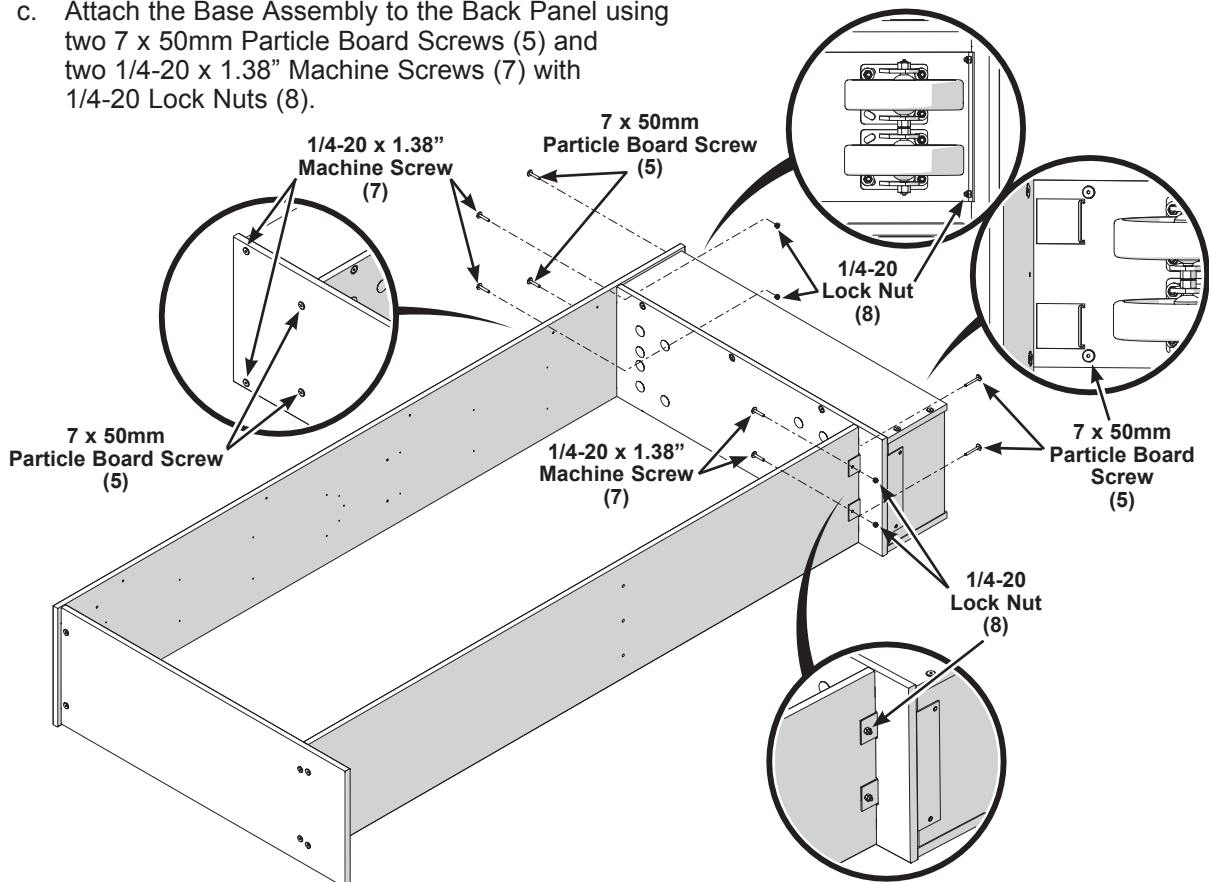

Oblique File System Unit Assembly (continued)

9. Attach the Oblique File Support Frames (12) to the Front and Back Panels using two #8 x 5/8" Pan Head Screws (13) in each side.

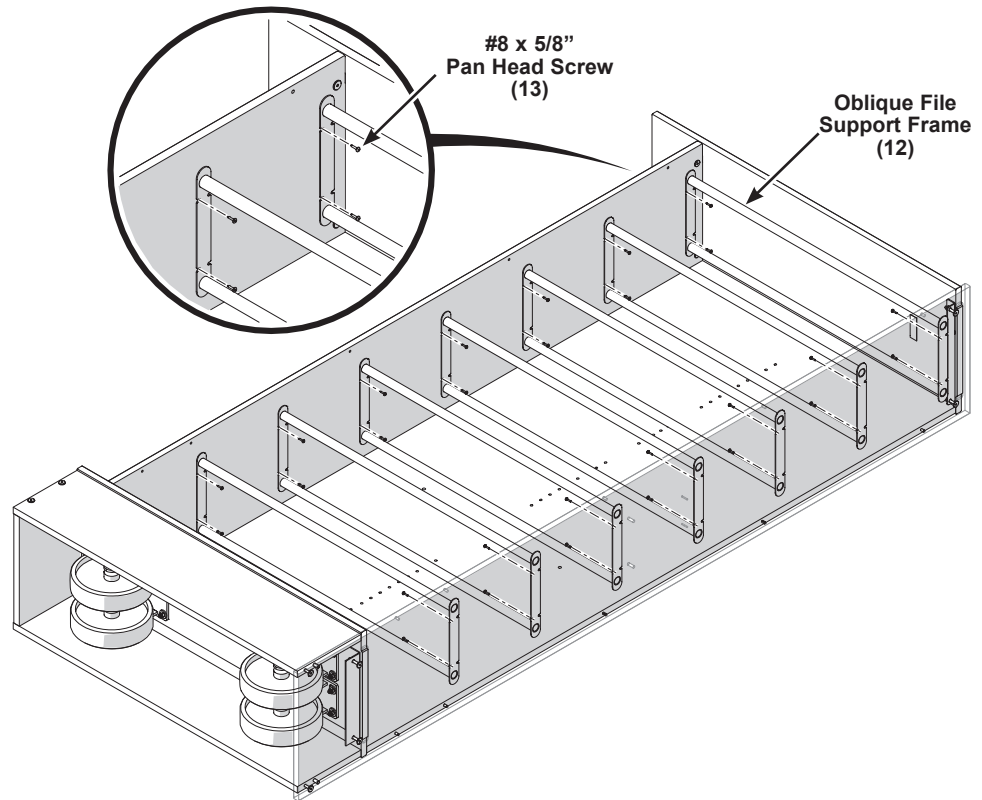

When finished, refer back to "Final System Assembly" in the original instructions to finish assembling the Music Library System.