

# OnBoard® Speaker Cart

- 210A017 OnBoard Speaker Cart, two-pack, 174 lbs. (79 kg).
- Ideal for transporting speakers onto field for marching band competitions.
- Designed to fit into trailers, semi-trailers, and trucks.
- Moves heavy-duty speakers up to 14" deep x 24" wide (356 x 610 mm).
- Supports one speaker up to 50 lbs (23 kg).
- Cart tilts speakers into performance position at 0, 15, 30, and 45 degree angle.
- Support tray constructed of 1/4" (6 mm) thick steel plate with 14-gauge, 1-1/2" (38 mm) round steel tubing.
- Fits through 28" (711 mm) door opening.
- Rolls on two rigid and two locking swivel 8" (203 mm) pneumatic wheels.
- Tow bar included for pulling by hand or by small garden tractor.
- Durable black powder-coat paint finish.
- Available with optional battery tray to hold power packs.
- Dimensions: 25-1/2" wide x 39" long x 27" high (648 x 991 x 686 mm).
- UL GREENGUARD Certified - Product certified for low chemical emissions: [ul.com/gg](http://ul.com/gg) - UL 2818.
- Environmental attributes and LEED compliance for this product can be found at [www.wengercorp.com/GREEN](http://www.wengercorp.com/GREEN) or by contacting your Wenger representative.
- Five-year warranty.
- Shipped unassembled.

## Accessories

- 210A015 Battery Tray, 8 lbs. (3.6 kg).
- Holds battery power packs.
- Dimensions:  
16-1/4" wide x 13-1/2" deep x 1-1/4" high  
(413 x 343 x 32 mm).

OnBoard Speaker Cart shown with Optional Battery Tray.

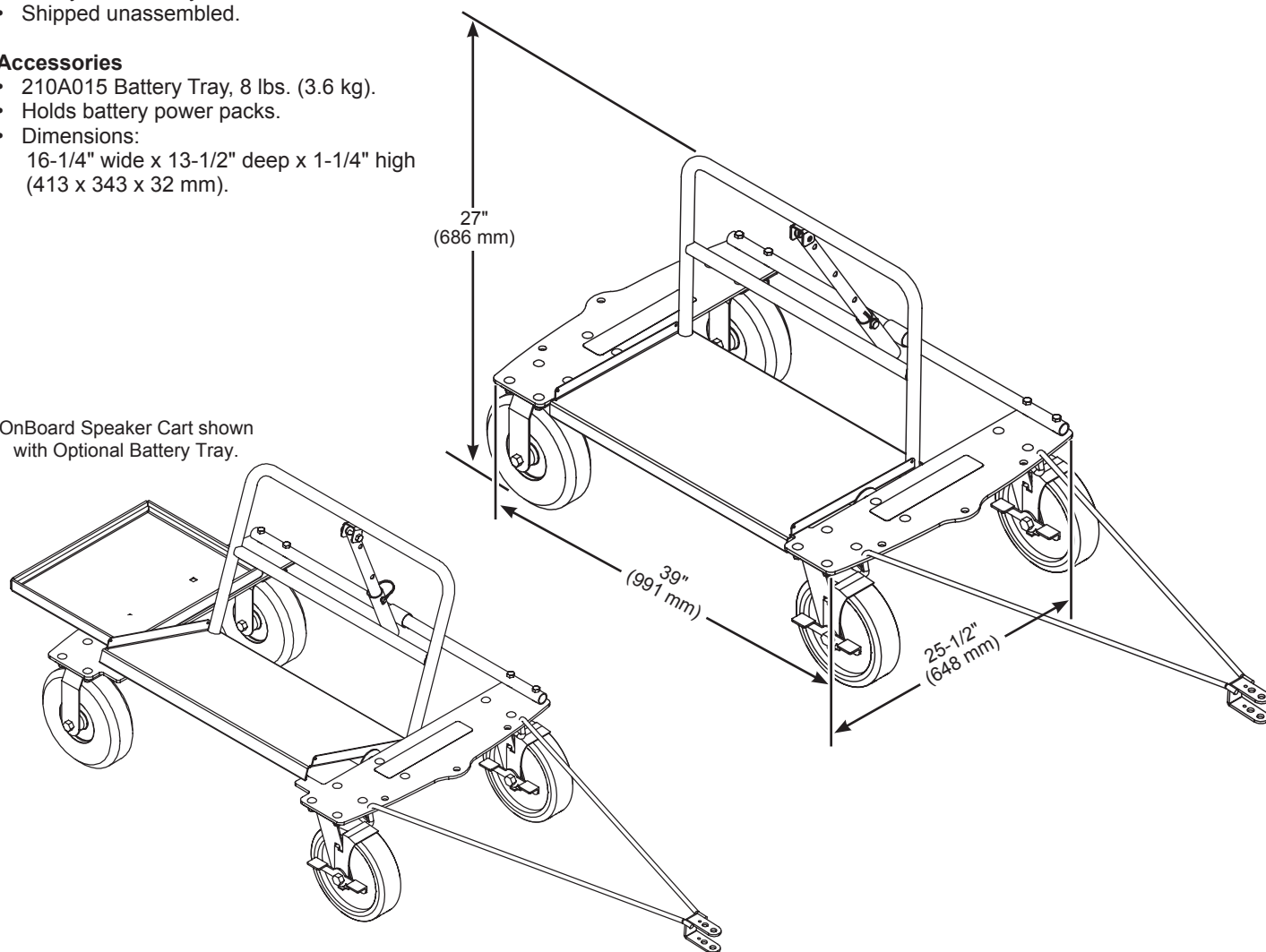

© 2017 Wenger Corporation  
USA/2017-12/W

