

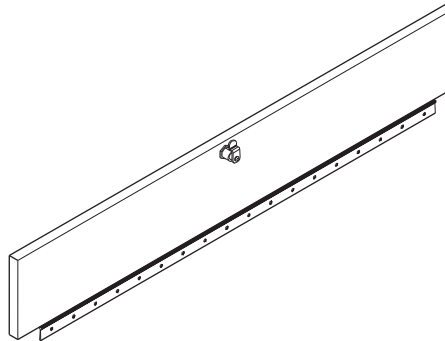

Your Performance Partner

Assembly Instructions Rehearsal Resource Center Upper Lock Door Option

Model 121



Upper Lock Door Option

CONTENTS

Warranty	3
Important User Information	3
General	3
Manufacturer	3
Intended Use	3
Required Tools	4
Fasteners	4
Part List	4
Assembly	4

Note: Please read and understand the Rehearsal Resource Center Upper Door Lock Option Assembly Instructions before assembling the parts.

Note: Remove all items from the shipping carton and arrange them in their approximate final position. Refer to the illustrations on the following pages. If you need additional information, contact the Wenger Corporation using the information below.

WARRANTY

The Rehearsal Resource Center Upper Lock Door Option Model 121 is guaranteed free of defects in materials and workmanship for five full years.

Our guarantee assures you of either a full refund or repair or replacement of the defective materials or workmanship without charge, at the discretion of our Customer Service Department. Just call a Customer Service Representative at 1-800-733-0393 and state the reason you are dissatisfied. If a product return is necessary, your representative will issue a return authorization. This is your sole remedy for breach of this warranty.

Should you have a question or problem with any Wenger product, don't hesitate to call, even if the product is past warranty. It's important to us that all our customers be satisfied.

This is the sole warranty made by Wenger. Wenger disclaims all other warranties, including the warranties of merchantability and fitness for a particular purpose, as well as all liability for incidental, consequential, special, and indirect damage. Wenger liability for direct damages shall be limited to the amount you paid for the product involved. Wenger reserves the right to make product changes without obligation to incorporate such changes into products previously sold.

Some states do not allow the exclusion or limitation of damages or warranties, so the above may not apply to you. This warranty gives you specific legal rights. You may also have other rights which vary from state to state.

IMPORTANT USER INFORMATION

GENERAL

Copyright © 2011 by Wenger Corporation

All rights reserved. No part of the contents of this manual may be reproduced, copied, or transmitted in any form or by any means including graphic, electronic, or mechanical methods or photocopying, recording, or information storage and retrieval systems without the written permission of the publisher, unless it is for the purchaser's personal use.

Printed and bound in the United States of America.

The information in this manual is subject to change without notice and does not represent a commitment on the part of Wenger Corporation. Wenger Corporation does not assume any responsibility for any errors that may appear in this manual.

In no event will Wenger Corporation be liable for technical or editorial omissions made herein, nor for direct, indirect, special, incidental, or consequential damages resulting from the use or defect of this manual.

The information in this document is not intended to cover all possible conditions and situations that might occur. The end user must exercise caution and common sense when assembling or installing Wenger Corporation products. If any questions or problems arise, call Wenger Corporation at 1-800-733-0393.

MANUFACTURER

The Rehearsal Resource Center Upper Lock Door Option Model 121 is manufactured by:

Wenger Corporation
555 Park Drive
Owatonna, MN 55060
1-507-455-4100 • 1-800-733-0393
www.wengercorp.com

INTENDED USE

- This product is intended for indoor use in normal ambient temperature and humidity conditions — it must not be exposed to prolonged outside weather conditions.
 - This product is intended to be assembled only as described in these instructions.
-

REQUIRED TOOLS

Tools required for assembly are a phillips screwdriver, a short phillips screwdriver, a $\frac{5}{8}$ " and a $\frac{7}{8}$ " open end wrench, and a mallet. **The use of a power driver is not recommended.**

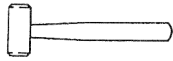

Mallet

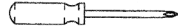

Phillips Screwdriver



Short Phillips
Screwdriver

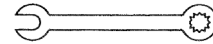

$\frac{5}{8}$ " and $\frac{7}{8}$ " Open End Wrench
(adjustable wrench is optional)

FASTENERS



(1) Press-in Insert,
8-32

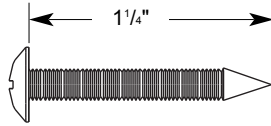

(2) Truss Head Screw,
8-15 x $1\frac{1}{4}$ "

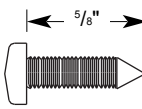

(3) Pan Head Screw,
8 x $\frac{5}{8}$ "

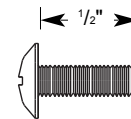

(4) Truss Head Screw,
8-32 x $\frac{1}{2}$ "

PART LIST

Item	Description	Part Number	Item	Description	Part Number
1	Press-in Insert, 8-32	222A027	5	Hinge	121B144
2	Truss Head Screw, 8-15x1-1/4"	146K423_	6	Door, Lock, Upper	121B142
3	Pan Head Screw, 8x5/8"	X000045	7	Lock Bracket	147A214
4	Truss Head Screw, 8-32x1/2"	X002232	8	Lock Assembly, 180°, X0001	X003469
			9	Cam, Off-Set, Lock	X003475

ASSEMBLY

Before starting the Upper Lock Door Option assembly, do the following:

1. Read and understand this assembly instruction.
2. Remove all items from the shipping cartons. Make sure that all parts are present. Item numbers refer to the Part List above.
3. Inventory the hardware package and make sure that all required hardware is present. Discard any items not used during the assembly.

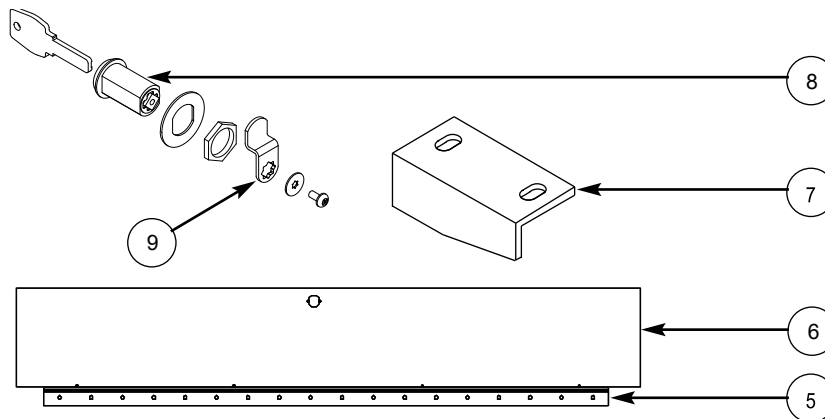

ASSEMBLY (CONTINUED)

1. Attach the Hinge (5) to the Upper Lock Door (6).
 - a. Lay the Upper Lock Door (6) on a horizontal surface with the Upper Door Lock Hole offset toward the curved end of the Unit Assembly. The outside surface is up.

Note: To install the Optional Upper Lock Door on a Drawer Unit Assembly, make sure that the Pilot Holes are facing down and the Lock Hole is offset to the **Right**, as shown below. The Lock Hole is offset to the **Left** on a Stereo Unit Assembly.

- b. Align the Hinge (5) to the Pilot Holes on the Bottom Edge of the Upper Lock Door (6) as shown below. **Make sure that the barrel of the Hinge (5) faces away from the bottom edge of the Upper Lock Door (6) and that the screws do not align with screw holes used to mount the door to the Unit Assembly.**
- c. Using a Phillips Screwdriver, screw four Truss Head Screws (2) through the Clearance Holes in the Hinge (5) into the four Upper Lock Door Pilot Holes (6).

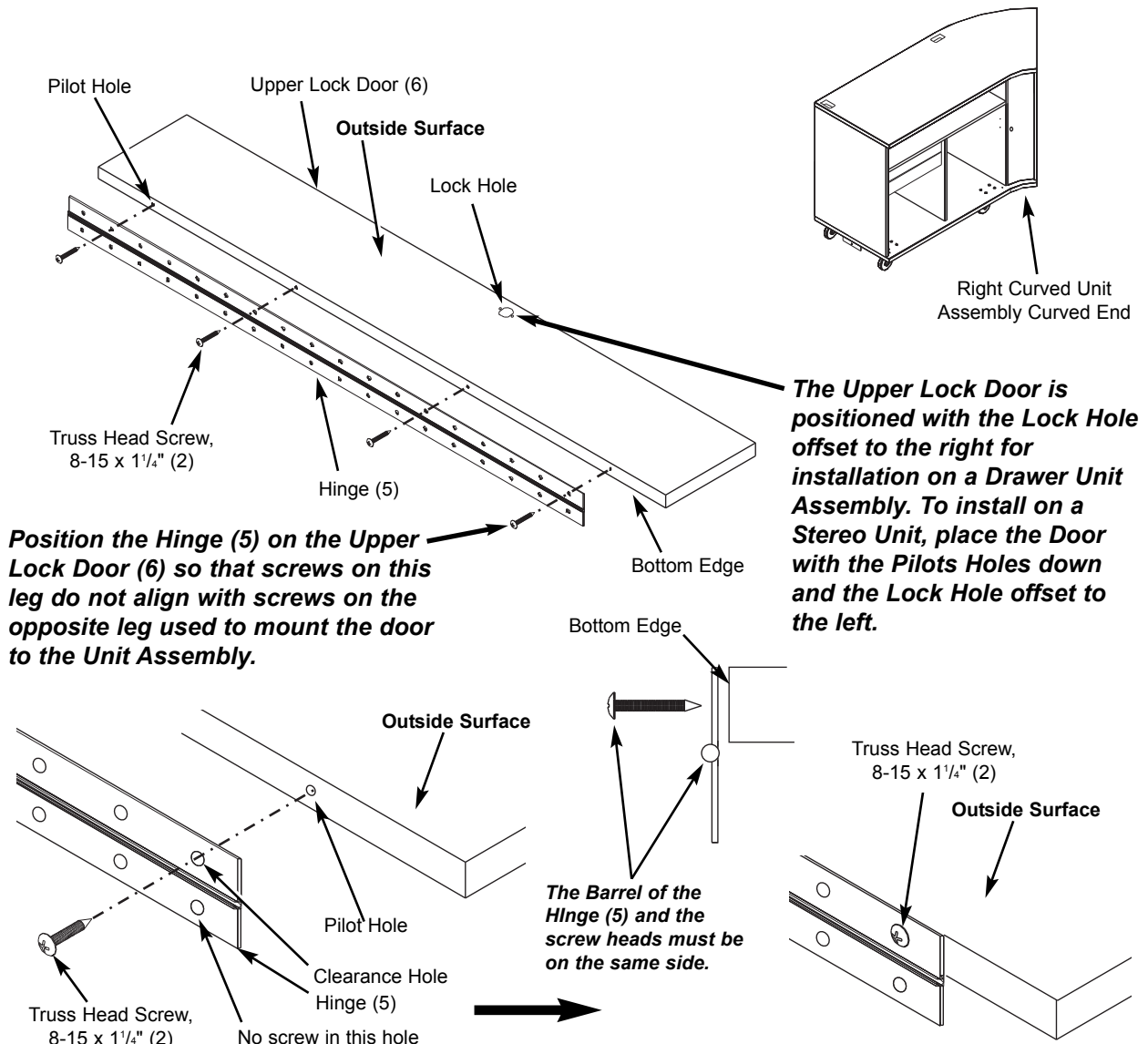

ASSEMBLY (CONTINUED)

2. Assemble the Lock Assembly (8) to the Upper Lock Door (6).
 - a. Position the Lock Housing so that the flat sides are parallel with the sides of the Upper Lock Door (6).
 - b. Insert the Lock Housing into the outside of the Lower Lock Door Hole (6).
 - c. On the inside surface of the door, slide the Locking Thrust Washer over the end of the Lock Housing.
 - d. Fasten the Hex Nut to the Lock Housing. Do not allow the Lock Housing to rotate.
 - e. Hold the threaded end of the lock with a $\frac{5}{8}$ " open end wrench and tighten the Hex Nut with a $\frac{7}{8}$ " open end wrench or adjustable wrench.

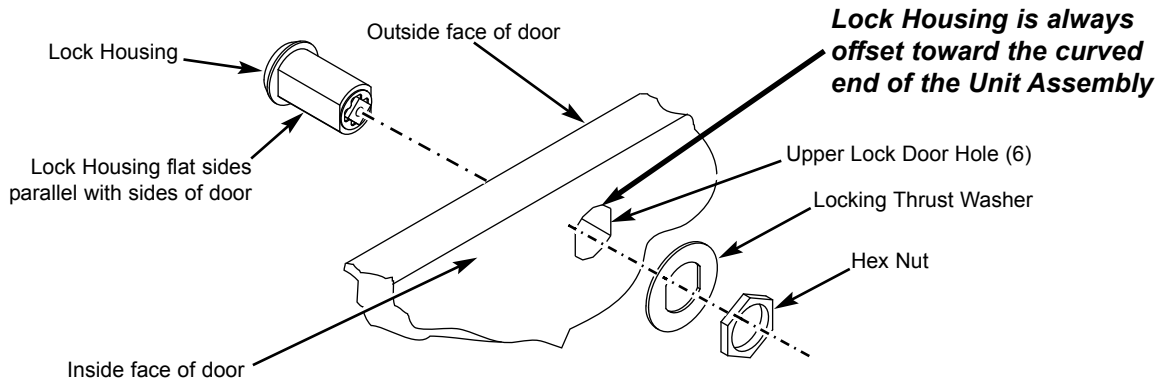

3. Assemble the Offset Cam to the Door Lock Assembly.
 - a. Slide the Offset Cam onto the end of the lock assembly.
 - b. Slide the Washer onto the end of the lock assembly.
 - c. Fasten the Machine Screw to the end of the lock assembly and tighten.
 - d. Insert the key and make sure that turning the key clockwise rotates the Offset Cam to the vertical position as shown below. If the Offset Cam is not vertical, loosen the Machine Screw and reposition the Offset Cam. Then tighten the Machine Screw.

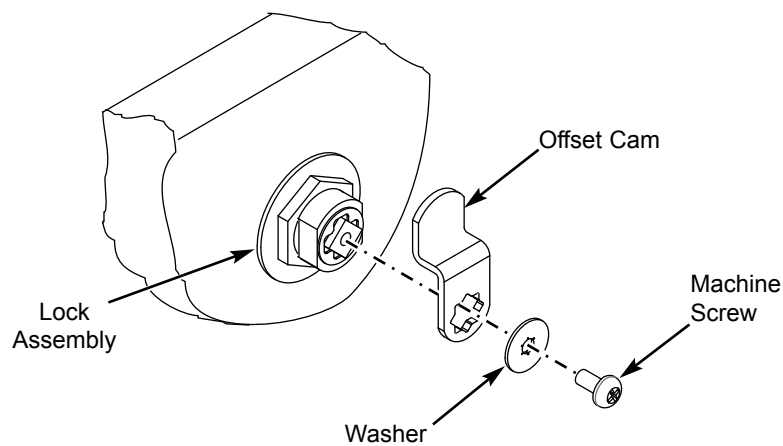

ASSEMBLY (CONTINUED)

4. Using the mallet, tap five brass Press-in Inserts (1) into the Pilot Holes in the Mid-shelf (slotted end enters Pilot Hole first). Pinch the slotted end together with pliers to make it easier to engage the hole.
5. Attach the Lock Bracket (7) with two Pan Head Screws (3) to the pair of pilot holes on the underneath side of the Unit top panel. **The Lock Bracket (7) may require adjustment for the Offset Cam to engage the Lock Bracket .**
6. Use five Pan Head Screws (3) and attach the Upper Lock Door to the Unit Assembly as shown in the illustration below. Make sure that screws on the opposite leg of the Hinge are offset so that the Hinge can fold 180-degrees.
7. Insert the key into the Lock Assembly and turn it counterclockwise (unlocking the lock).
8. Close the Door and turn the key clockwise (locking the door). The Door will not stay closed unless it is locked.

