

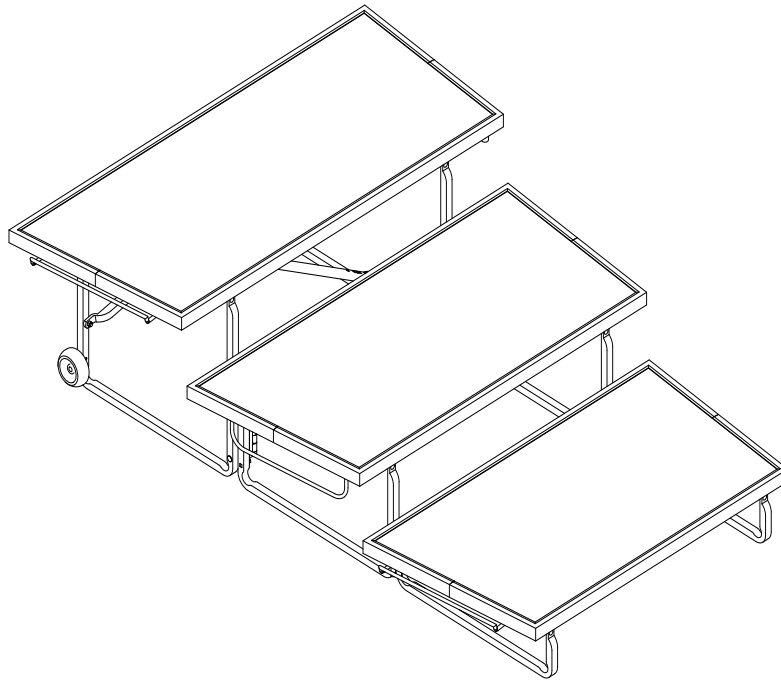

Your Performance Partner

Assembly Manual Tourmaster 3-Step Riser



Note: Shade variations may be present from step to step due to the nap of the carpet.

CONTENTS

| | |
|--------------------------------------|-----|
| Safety Precautions | 2 |
| Warranty | 2 |
| Important User Information | 3 |
| General | 3 |
| Manufacturer | 3 |
| Intended Use | 3 |
| Introduction | 3 |
| Preparation for Assembly | 4 |
| Tools Required | 4 |
| Setup | 4 |
| Fastener and Parts List | 4 |
| Assembly | 5-7 |
| Maintenance | 8 |
| Replacement Parts List | 8 |

Note: Please read and understand these instructions before starting the assembly.
Note: If you need additional information, contact Wenger Corporation using the information below.

SAFETY PRECAUTIONS

GENERAL

Throughout this manual you will find **CAUTIONS** and **WARNINGS** which are defined as follows.

- **WARNING** means that failure to follow the instruction may result in serious injury or death.
- **CAUTION** means that failure to follow the instruction may result in serious injury or damage to property.

Read all of these safety instructions before assembling or using the Tourmaster 3-Step Riser.

| |
|--|
|  CAUTION |
| <i>Make sure that anyone working with the Tourmaster 3-Step Riser has read and understands these instructions.</i> |

| |
|--|
|  CAUTION |
| <i>Failure to comply with Warnings and Cautions in this document can result in damage to property or serious injury.</i> |

| |
|--|
|  CAUTION |
| <i>Some steps require two people to avoid injury.</i> |

WARRANTY

The Tourmaster 3-Step Riser is guaranteed free of defects in materials and workmanship for fifteen full years. Shade variations may be present from step to step due to the nap of the carpet.

Our guarantee assures you of either a full refund or repair or replacement of the defective materials or workmanship without charge, at the discretion of our Customer Service Department. Just call a Customer Service Representative at 1-800-887-7145 and state the reason you are dissatisfied. If a product return is necessary, your representative will issue a return authorization. This is your sole remedy for breach of this warranty.

Should you have a question or problem with any Wenger product, don't hesitate to call, even if the product is past warranty. It's important to us that all our customers be satisfied.

This is the sole warranty made by Wenger. Wenger disclaims all other warranties, including the warranties of merchantability and fitness for a particular purpose, as well as all liability for incidental, consequential, special, and indirect damage. Wenger liability for direct damages shall be limited to the amount you paid for the product involved. Wenger reserves the right to make product changes without obligation to incorporate such changes into products previously sold.

Some states do not allow the exclusion or limitation of damages or warranties, so the above may not apply to you. This warranty gives you specific legal rights. You may also have other rights which vary from state to state.

IMPORTANT USER INFORMATION

GENERAL

Copyright © 2011 by Wenger Corporation

All rights reserved. No part of the contents of this manual may be reproduced, copied, or transmitted in any form or by any means including graphic, electronic, or mechanical methods or photocopying, recording, or information storage and retrieval systems without the written permission of the publisher, unless it is for the purchaser's personal use.

Printed and bound in the United States of America.

The information in this manual is subject to change without notice and does not represent a commitment on the part of Wenger Corporation. Wenger Corporation does not assume any responsibility for any errors that may appear in this manual.

In no event will Wenger Corporation be liable for technical or editorial omissions made herein, nor for direct, indirect, special, incidental, or consequential damages resulting from the use or defect of this manual.

The information in this document is not intended to cover all possible conditions and situations that might occur. The end user must exercise caution and common sense when assembling or installing Wenger Corporation products. If any questions or problems arise, call Wenger Corporation at 1-800-733-0393.

MANUFACTURER

The Tourmaster 3-Step Riser is manufactured by:

Wenger Corporation
555 Park Drive
Owatonna, MN 55060
1-507-455-4100 • 1-800-733-0393
www.wengercorp.com

INTENDED USE

- This product is designed to be an elevation step for vocal groups.
- This product is intended for indoor use in normal ambient temperature and humidity conditions — it must not be exposed to prolonged outside weather conditions.
- This product is intended to be installed only as described in these instructions.

INTRODUCTION

Tourmaster 3-Step Riser

- This product is available in:
 - 18" step in lengths of 4' or 6'
 - 24" step in length of 4'

PREPARATION FOR ASSEMBLY

TOOLS REQUIRED

- Two 1/2" open-end or socket wrenches

SETUP

1. Make sure there is enough room for the assembly of the riser(s).
2. Plan the layout of the risers if immediate setup is being completed.

FASTENER LIST

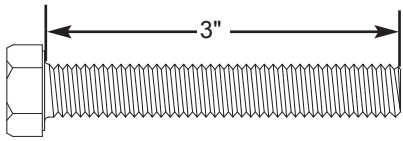

5/16-18x3" Capscrew (2)

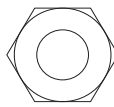

Lock Nut (2)

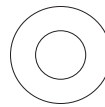

Washer (6)

PARTS LIST

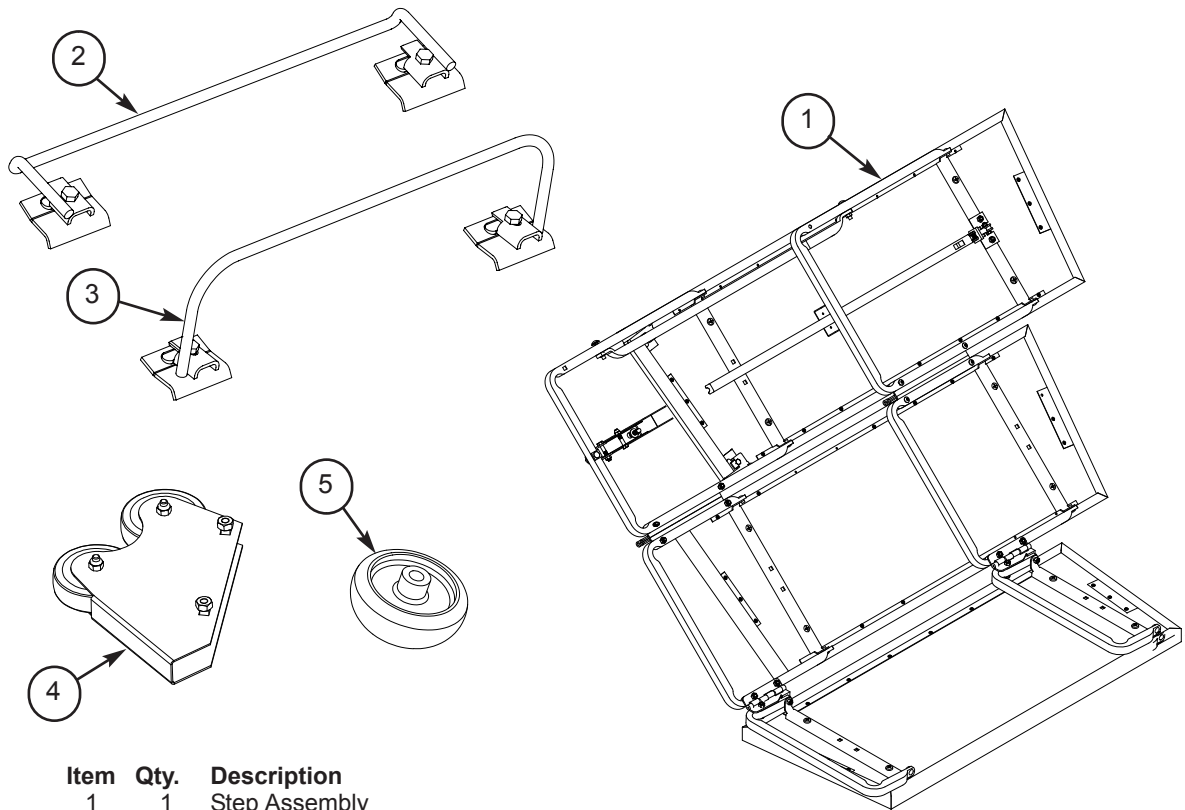

| Item | Qty. | Description |
|------|------|-----------------------------|
| 1 | 1 | Step Assembly |
| 2 | 2 | Unit to Unit Clamp Assembly |
| 3 | 1 | Leg Assembly |
| 4 | 2 | Caster Assembly |
| 5 | 2 | Positioning Wheels |

ASSEMBLY

1. Unfold the riser so the carpeted side is down. (Detail A)

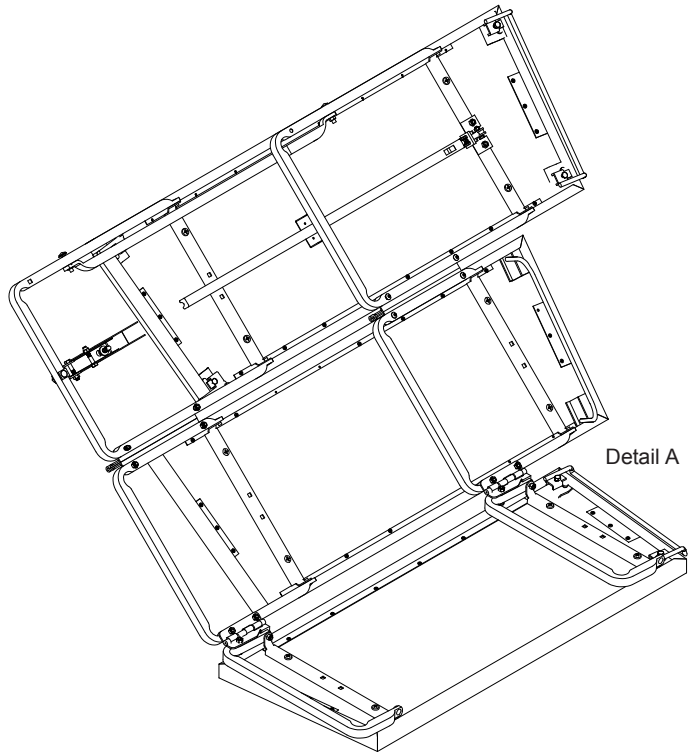

2. Attach the wheels on the outside of the rear legs, as shown, using the washer and nut. Tighten securely. (Detail B)

Note: If wheel assembly is not assembled correctly unit will not roll in folded position.

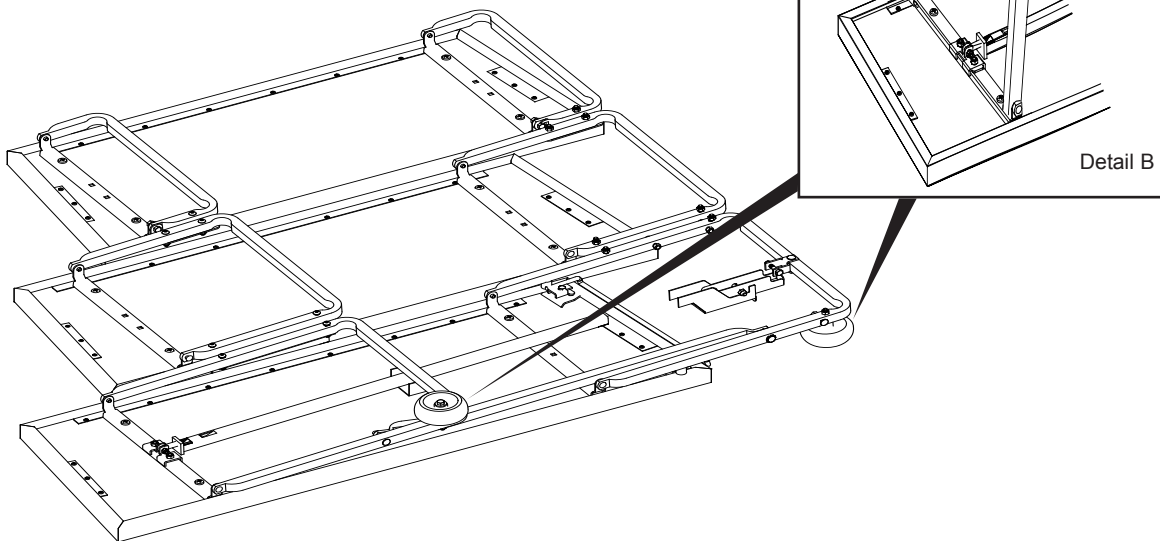

ASSEMBLY (CONTINUED)

3. With your fingers, loosen the screws on the unit-to-unit connector (#2) as far as they will go.

Insert one of the clamp's brackets under the lip of the first step (#1). Hold the bracket in position with your finger, and finger-tighten the screw. Attach the other end of the clamp the same way. (Detail C)

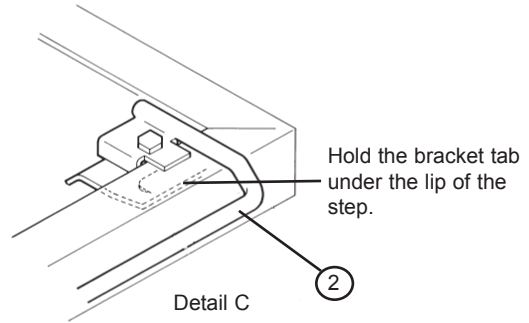

4. Re-check that the tab on both clamp brackets is fully caught under the lip of the step.
5. Center the clamp on the step (side-to-side), and tighten the screws securely.
6. Repeat steps 3-4 attaching the unit-to-unit connector (#2) to the third step.
7. Repeat steps 3-4 attaching the leg (#3) to the second step. (Shown in Detail D)

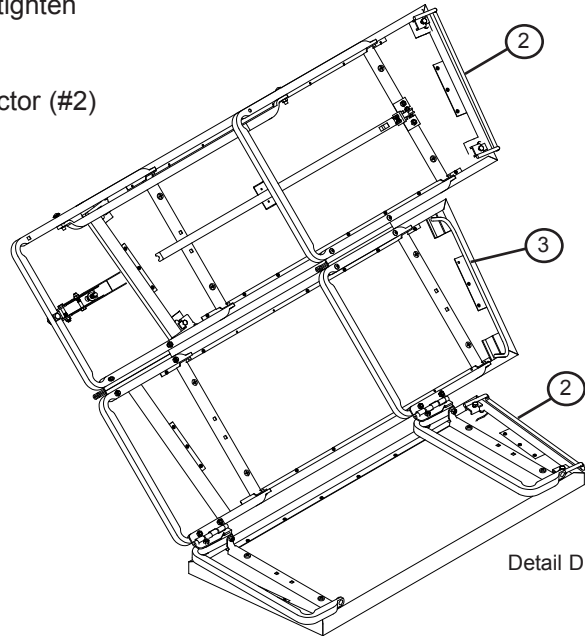

8. Partially fold the riser to provide easy access to the rear leg. (Detail E)

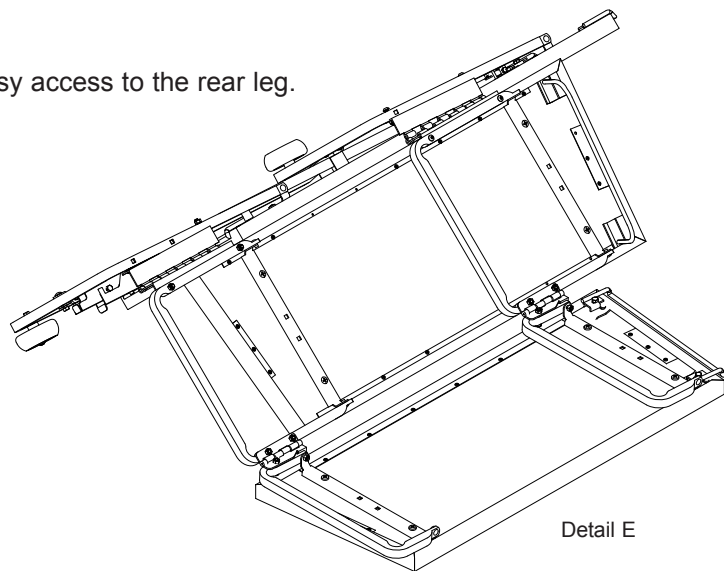

ASSEMBLY (CONTINUED)

9. On the side opposite the rear cross tube, install a caster assembly (4) over the rear leg. Tighten the lock nuts securely. (Detail F)

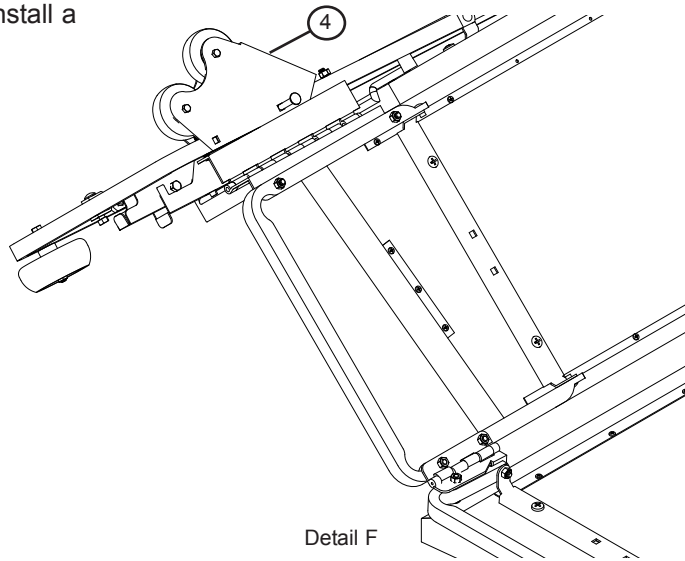

10. Remove the 1-3/4" carriage bolt and washers that attach the cross tube to the leg. Loosen the bolt at the other end of the cross tube. (Detail G)

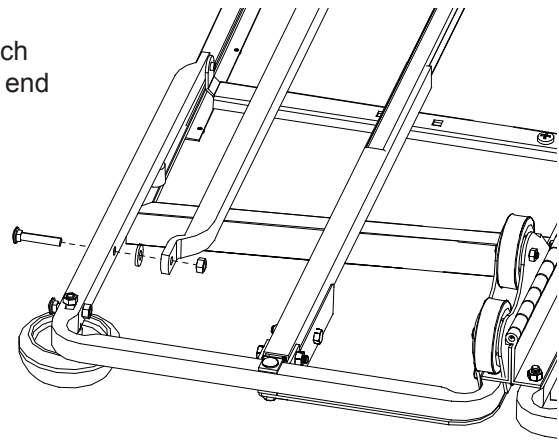

11. Place the remaining caster assembly over the leg. Attach the wheel end to the leg with a 1-1/2" carriage bolt; attach the other end to the leg and cross tube with the 1-3/4" carriage bolt and washers that were removed in the previous step. Tighten the fasteners, then back them off a 1/2 turn. (Detail H)

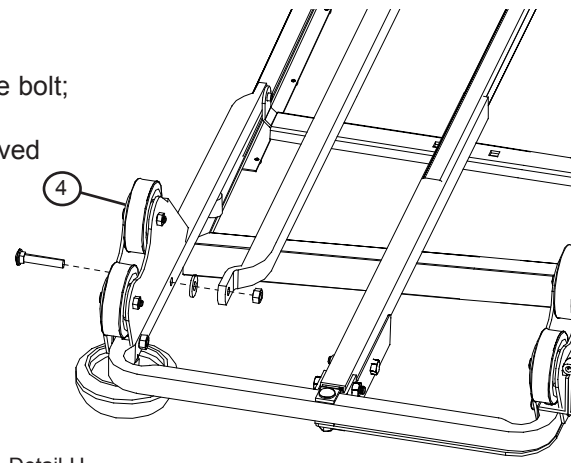

REPLACEMENT PARTS LIST

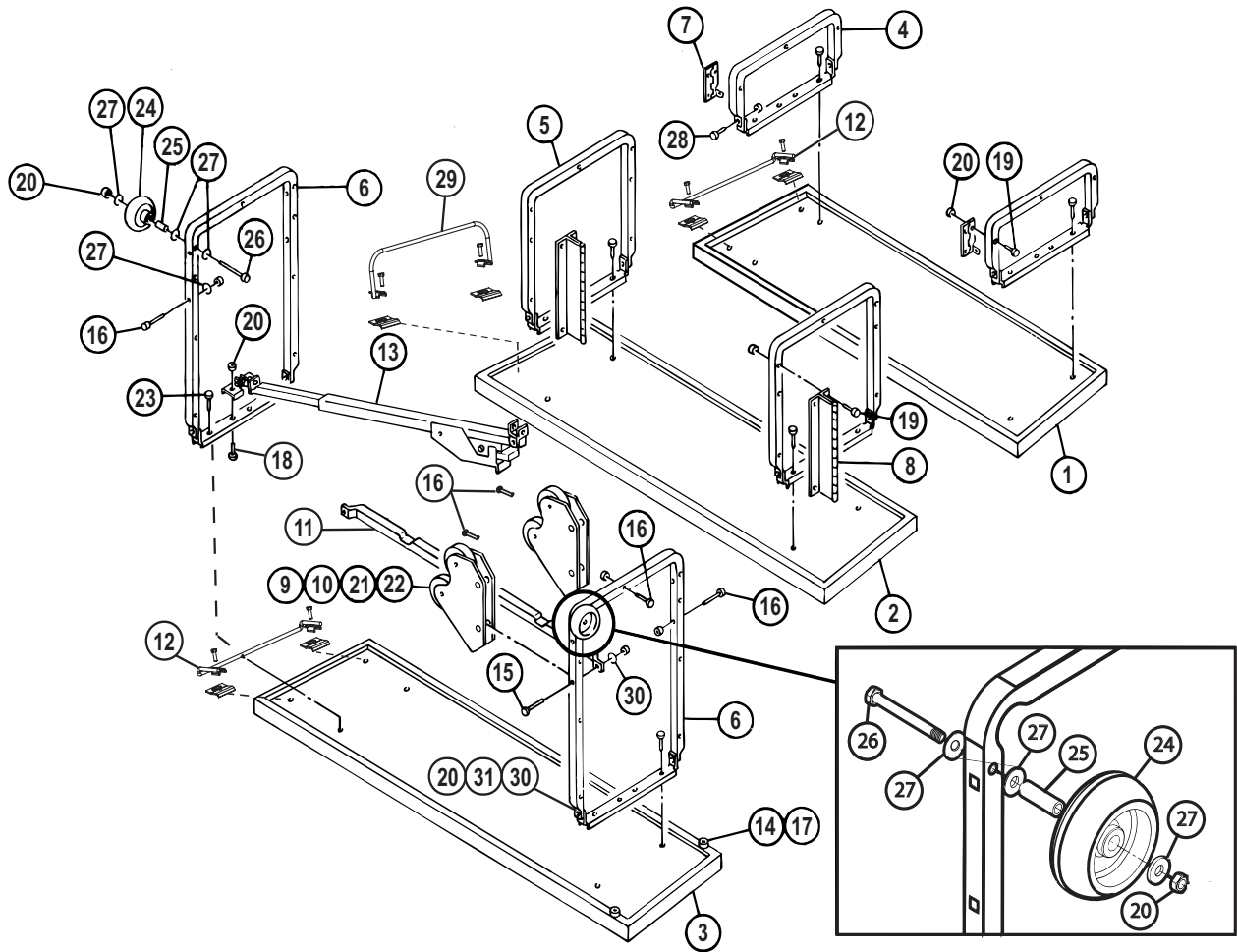

| Item | Description | Qty. | Item | Description | Qty. |
|------|------------------------------------|------|------|---------------------------------|------|
| 1 | Step Assembly, 1st | 1 | 16 | Carriage Bolt, 5/16-18 x 1-1/2" | 6 |
| 2 | Step Assembly, 2nd | 1 | 17 | Bumper, Recess | 2 |
| 3 | Step Assembly, 3rd | 1 | 18 | Carriage Bolt, 5/16-18 x 3/4" | 2 |
| 4 | Leg Assembly, 1st Step | 2 | 19 | Carriage Bolt, 5/16-18 x 1 1/4" | 13 |
| 5 | Leg Assembly, 2nd Step | 2 | 20 | Lock Nut, 5/16-18 | 36 |
| 6A | Leg Assembly, 3rd Step, Left-Hand | 1 | 21 | Lock Nut, 1/4-20 | 4 |
| 6B | Leg Assembly, 3rd Step, Right-Hand | 1 | 22 | Capscrew, 1/4-20 x 1-1/2" | 4 |
| 7 | Hinge, Short | 2 | 23 | SEMS Capscrew, 5/16-18 x 1" | 12 |
| 8 | Hinge, Long | 2 | 24 | Wheel, Positioning | 2 |
| 9 | Bracket, Caster | 2 | 25 | Bushing, Wheel | 2 |
| 10 | Wheel | 4 | 26 | Capscrew, 5/16-18 x 3" | 2 |
| 11 | Cross Tube, Rear | 1 | 27 | Washer, 5/16" ID | 6 |
| 12 | Clamp Assembly, Unit-to-Unit | 2 | 28 | Carriage Bolt, 5/16-18 x 1" | 2 |
| 13 | Slide Lock Assembly | 1 | 29 | Leg Assembly | 1 |
| 14 | Rivet, Pop | 2 | 30 | Nylon Washer, 5/16" ID | 14 |
| 15 | Carriage Bolt, 5/16-18 x 1-3/4" | 1 | 31 | Capscrew, 5/16-18 x 1" | 10 |