

BEFORE YOU BEGIN

Read the complete assembly procedure before you start to assemble the cart.

Remove all items from the shipping carton, and lay them out approximately in their final position. Refer to the exploded drawings below and on the other side of the sheet.

TOOLS REQUIRED

Two 9/16" open-end or socket wrenches; two 1/2" open-end or socket wrenches; one 3/8" open-end or socket wrench

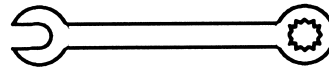

FASTENERS USED

⑤ Capscrew:

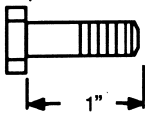

⑥ Standard Nut:



⑩ Self-tapping Screw:

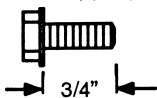

⑪ Capscrew:

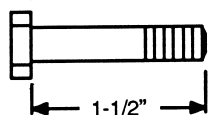

⑫ Wing Nut:

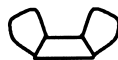

⑬ Lock Washer:



⑮ Capscrew:

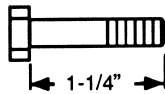

⑯ Lock Nut:



REPLACEMENT PARTS

Item Description

- 1 Caster mount, left-hand (qty: 2)
- 2 Caster mount, right-hand (qty: 2)
- 3 Caster, swivel (qty: 2)
- 4 Caster, rigid (qty: 2) [not shown]
- 5 Capscrew, 3/8-16x1" (qty: 16)
- 6 Standard nut, 3/8-16 (qty: 16)
- 7 Splice tube, 3/4" (qty: 2)
- 8 Handle, left-hand
- 9 Handle, right-hand

Item Description

- 10 Screw, self-tapping, 1/4-20x3/4" (qty: 2)
- 11 Capscrew, 3/8-16x1-1/2" (qty: 2)
- 12 Wing nut, 3/8-16 (qty: 2)
- 13 Lock washer, 3/8" (qty: 16)
- 14 Splice tube, 7/8"
- 15 Capscrew, 5/16-18x1-1/4" (qty: 4)
- 16 Lock nut, 5/16-18 (qty: 4)
- 17 Handle, clamp (4)
- 18 Strap, tie-down [not shown]

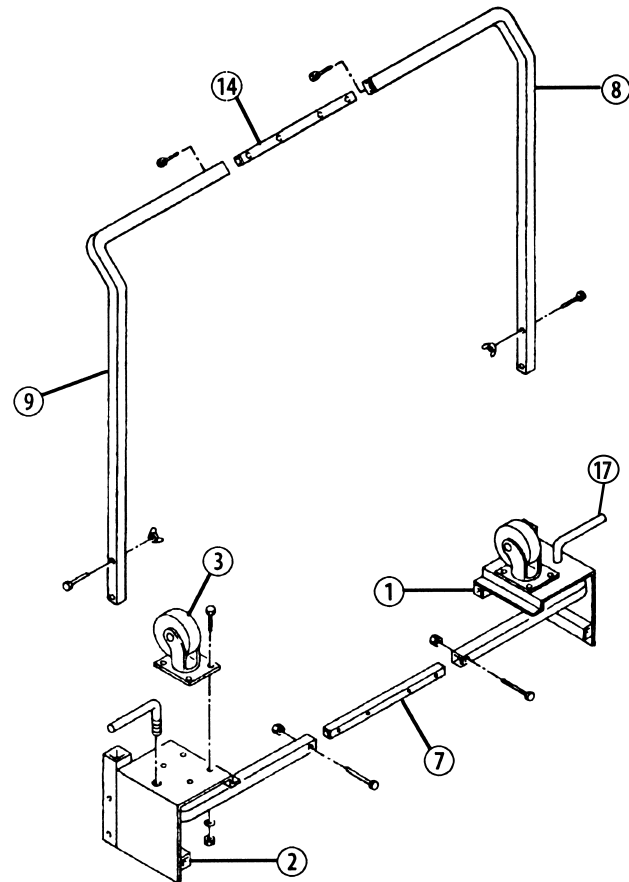

ASSEMBLY

1. Screw the levers partway into the caster mounts.
2. Attach a swivel caster (3) to one of the left-hand caster mounts (1). Attach the other swivel caster to a right-hand caster mount (2).
3. Attach the rigid casters (4) to the other two caster mounts.

4. Insert a 3/4" splice tube (7) into the tubes on one pair of caster mounts.
The splice tube has two pairs of holes, for 3' or 4' wide stages. Secure using the appropriate holes.
5. Repeat step 4 with the other caster mounts.

6. Install the 7/8" splice tube (14) into the left- and right-hand handles (8, 9), using the appropriate pair of holes.

7. Loosely install the fasteners.
8. Refer to the Versalite Owner's Manual to install the caster mount assemblies and handle on the stage.